

9:26 a.m. APRIL 1988  
 30 EC  
 1000 g  
 20  
 CHAD CO Planning Dept Sheet 4 of 7

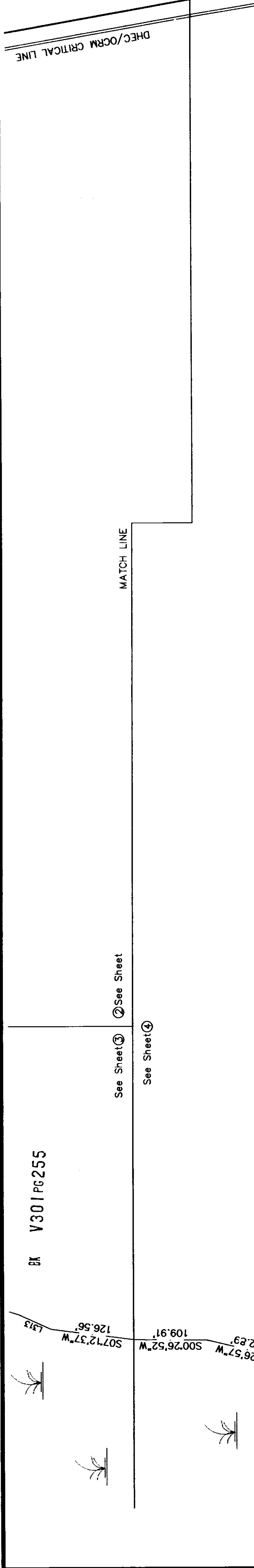

**NOTES:**  
 1.) THE PRESENCE OR ABSENCE OF U.S. ARMY CORP OF ENGINEERS JURISDICTIONAL WETLANDS IS UNDETERMINED AS OF THE DATE OF THIS SURVEY. THIS PLAT REPRESENTS A SURVEY BASED ON THE LISTED REFERENCES ONLY, AND IS NOT THE RESULT OF A TITLE SEARCH.

**REFERENCES:**  
 1.) 032-00-00-002  
 2.) PLAT BY H. EXO HILTON DATED JUNE 1973 PLAT BOOK AC, PAGE 52 RMC, CHARLESTON COUNTY  
 3.) PLAT BY STS ENGINEERING, INC. DATED 1-14-76 PLAT BOOK AG, PAGE 16 RMC, CHARLESTON COUNTY

**LEGEND**

⊕	IRON OLD FOUND (SIZE & TYPE NOTED)
⊙	CONCRETE MONUMENT OLD
○	IRON NEW (5/8" ROD)
⊖	MARSH
⊗	FENCE
◊	PROPERTY CORNER (NO IRON SET)

**APPROVED FINAL PLAT**  
 CLERK CHARLESTON COUNTY S.C.  
 APRIL 21 1998  
 10# 17 387  
 SHEET 4 OF 7

**PLAT OF THE SUBDIVISION OF A 543 AC. TRACT TO CREATE TRACT A (484.49 AC.) OWNED BY: W.E. APPEGATE, III & ARTHUR H. APPEGATE**  
 LITTLE EDISTO ISLAND  
 CHARLESTON COUNTY, S.C.

MARCH 19, 1998  
 SCALE: 1" = 100'  
 100 50 0 100 200 300  
 SCALE IN FEET

**THOMAS & HUTTON ENGINEERING CO.**  
 PO BOX 1522, 288 W. COLEMAN BOULEVARD, SUITE 1-C, MT. PLEASANT, S.C. 29465-1522 (803) 884-1111  
 835 HURSTON WOODWORTH BOULEVARD, SUITE 100, MT. PLEASANT, S.C. 29465-0000  
 3 COLEMAN PROFESSIONAL BLDG., SUMMERHAY, GA. 31145 (478) 355-5300  
 Job# 11523/88-057 F.B.# DC Name: FRE Pages: 1

**TRACT A TOTAL**  
 21,117,488 sq.ft.  
 484.49 acres  
 HIGHLAND  
 8,321,287 sq.ft.  
 189.05 acres

**Critical Area**  
 14,638 sq.ft.  
 0.34 acres

**BANKS H. GOOD**  
 TMS# 032-00-00-001

**THE AREA SHOWN ON THIS PLAT IS GENERAL REPRESENTATION OF THE SUBJECT PROPERTY. THIS PLAT IS NOT TO BE USED TO CHANGE OVER TIME BY GENERALY DELINEATING THE PERMIT AUTHORITY OF THE DHEC/OCRM. THE OFFICE OF OCRM IN NO WAY WAIVES THE RIGHT TO ASSERT PERMIT JURISDICTION AT ANY TIME IN ANY CRITICAL AREA ON THE SUBJECT PROPERTY, WHETHER SHOWN HEREIN OR NOT.**

**THIS (THESE) LOT(S) DOES NOT MEET MINIMUM HEALTH DEPARTMENT REQUIREMENTS. HOWEVER A SITE WAS APPROVED FOR AN EXPERIMENTAL SYSTEM (FOR TRACT A).**

**THE AREA SHOWN ON THIS PLAT IS GENERAL REPRESENTATION OF THE SUBJECT PROPERTY. THIS PLAT IS NOT TO BE USED TO CHANGE OVER TIME BY GENERALY DELINEATING THE PERMIT AUTHORITY OF THE DHEC/OCRM. THE OFFICE OF OCRM IN NO WAY WAIVES THE RIGHT TO ASSERT PERMIT JURISDICTION AT ANY TIME IN ANY CRITICAL AREA ON THE SUBJECT PROPERTY, WHETHER SHOWN HEREIN OR NOT.**

**THE CRITICAL LINE SHOWN ON THIS PLAT IS VALID FOR THREE YEARS FROM THE DATE OF THIS SIGNATURE, SUBJECT TO THE CAUTIONARY LANGUAGE ABOVE.**

**THOMAS & HUTTON ENGINEERING, CO.**  
 REG. NO. 10292  
 No. 000285  
 PROFESSIONAL LAND SURVEYOR  
 STATE OF SOUTH CAROLINA

**THOMAS & HUTTON ENGINEERING, CO.**  
 REG. NO. 10292  
 No. 000285  
 PROFESSIONAL LAND SURVEYOR  
 STATE OF SOUTH CAROLINA

**THOMAS & HUTTON ENGINEERING, CO.**  
 REG. NO. 10292  
 No. 000285  
 PROFESSIONAL LAND SURVEYOR  
 STATE OF SOUTH CAROLINA

**THOMAS & HUTTON ENGINEERING, CO.**  
 REG. NO. 10292  
 No. 000285  
 PROFESSIONAL LAND SURVEYOR  
 STATE OF SOUTH CAROLINA

**THOMAS & HUTTON ENGINEERING, CO.**  
 REG. NO. 10292  
 No. 000285  
 PROFESSIONAL LAND SURVEYOR  
 STATE OF SOUTH CAROLINA

**THOMAS & HUTTON ENGINEERING, CO.**  
 REG. NO. 10292  
 No. 000285  
 PROFESSIONAL LAND SURVEYOR  
 STATE OF SOUTH CAROLINA

**General Property Survey**  
 I. F. Elliott Quinn, III, a Registered Professional Land Surveyor in the State of South Carolina, certify to owners(s) shown herein that this survey shown herein was made in accordance with the requirements of the Minimum Standards Manual for the Practice of Land Surveying in South Carolina, and meets or exceeds the requirements for a Class 2, special purpose survey.

**F. Elliott Quinn, III, R.L.S.**  
 S.C. Registration Number 10292  
 This is not a true valid copy of this document unless bearing an original signature and a raised embossed seal of the surveyor.

**F. Elliott Quinn, III, R.L.S.**  
 S.C. Registration Number 10292  
 This is not a true valid copy of this document unless bearing an original signature and a raised embossed seal of the surveyor.

**F. Elliott Quinn, III, R.L.S.**  
 S.C. Registration Number 10292  
 This is not a true valid copy of this document unless bearing an original signature and a raised embossed seal of the surveyor.

**F. Elliott Quinn, III, R.L.S.**  
 S.C. Registration Number 10292  
 This is not a true valid copy of this document unless bearing an original signature and a raised embossed seal of the surveyor.

**F. Elliott Quinn, III, R.L.S.**  
 S.C. Registration Number 10292  
 This is not a true valid copy of this document unless bearing an original signature and a raised embossed seal of the surveyor.

**F. Elliott Quinn, III, R.L.S.**  
 S.C. Registration Number 10292  
 This is not a true valid copy of this document unless bearing an original signature and a raised embossed seal of the surveyor.

**F. Elliott Quinn, III, R.L.S.**  
 S.C. Registration Number 10292  
 This is not a true valid copy of this document unless bearing an original signature and a raised embossed seal of the surveyor.

**F. Elliott Quinn, III, R.L.S.**  
 S.C. Registration Number 10292  
 This is not a true valid copy of this document unless bearing an original signature and a raised embossed seal of the surveyor.

**F. Elliott Quinn, III, R.L.S.**  
 S.C. Registration Number 10292  
 This is not a true valid copy of this document unless bearing an original signature and a raised embossed seal of the surveyor.

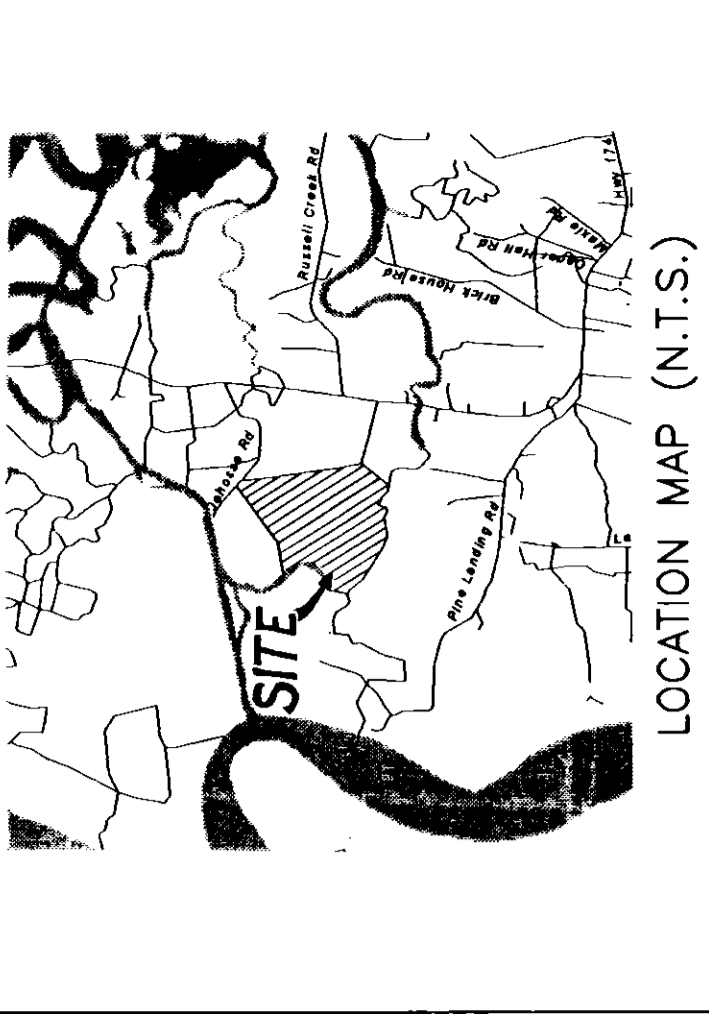

9.26 0' 30" 30' 30" 98"  
 APRIL 21, 1998  
 CHAD CO Planning Dept Sheet 4 of 7

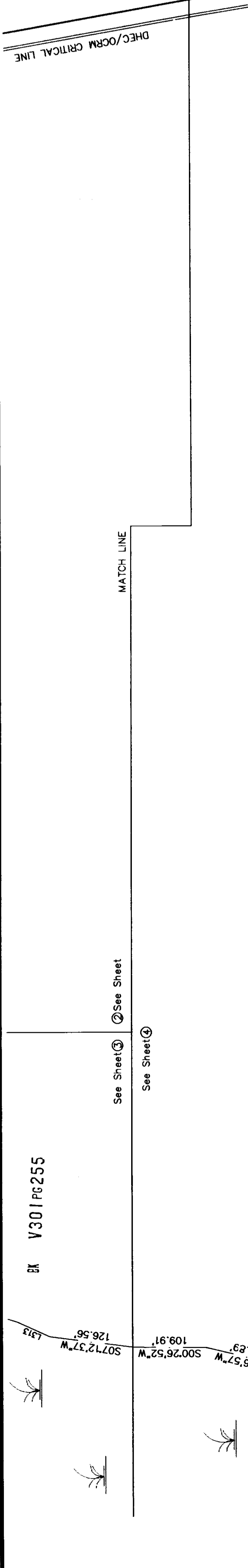

See Sheet ②  
 See Sheet ④



**NOTES:**

- 1) THE PRESENCE OR ABSENCE OF U.S. ARMY CORP OF ENGINEERS JURISDICTIONAL WETLANDS IS UNDETERMINED AS OF THE DATE OF THIS SURVEY. THIS PLAT REPRESENTS A SURVEY BASED ON THE BEST AVAILABLE DATA AND IS NOT THE RESULT OF A TITLE SEARCH.

**REFERENCES:**

- 1) 032-00-00-002
- 2) PLAT BY H. EXO HILTON DATED JUNE 29, 1978 PAGE 52 PLAT BOOK 146 PAGE 16 RMC, CHARLESTON COUNTY
- 3) PLAT BY STS ENGINEERING, INC. DATED 11/14/76 PAGE 16 PLAT BOOK 146 PAGE 16 RMC, CHARLESTON COUNTY

**LEGEND**

□	IRON OLD FOUND (SIZE & TYPE NOTED)
■	CONCRETE MONUMENT OLD
○	IRON NEW (3/8" ROD)
⊖	MARSH
⊗	FENCE
○	PROPERTY CORNER (NO IRON SET)

APPROVED FINAL PLAT  
 CLERK CHARLESTON COUNTY COUNCIL  
 APRIL 21, 1998  
 PB# 17387  
 SHEET 4 OF 7

PLAT OF THE SUBDIVISION OF A 543 AC. TRACT TO CREATE TRACT A (484.49 AC.) OWNED BY:

W.E. APPELEGATE, III & ARTHUR H. APPELEGATE  
 LITTLE EDISTO ISLAND  
 CHARLESTON COUNTY, S.C.



MARCH 19, 1998

**THOMAS & HUTTON ENGINEERING CO.**  
 PO BOX 1522, 288 W. COLEMAN BOULEVARD, SUITE 1-C, MT. PLEASANT, S.C. 29485-1522 (803) 884-1111

BANKS H. GOOD  
 TMS# 032-00-00-001

TRACT A TOTAL  
 21,117,488 sq. ft.  
 484.49 acres  
 8,321,287 sq. ft.  
 191.03 acres

THIS THESE LOTS DOES NOT MEET MINIMUM HEALTH DEPARTMENT REQUIREMENTS. HOW EVER, THE SITE WAS APPROVED FOR AN EXPERIMENTAL SYSTEM (FOR TRACT A).

THE AREA SHOWN ON THIS PLAT IS GENERAL REPRESENTATION OF DHEC/OCRM PERMIT AUTHORITY ON THE SUBJECT PROPERTY. CRITICAL AREAS, BY THEIR NATURE, ARE DYNAMIC AND SUBJECT TO CHANGE OVER TIME. BY GENERALLY DELINEATING THE PERMIT AUTHORITY OF THE DHEC/OCRM, THE OFFICE OF OCRM IN NO WAY WAIVES THE RIGHT TO ASSERT PERMIT JURISDICTION AT ANY TIME IN ANY CRITICAL AREA ON THE SUBJECT PROPERTY, WHETHER SHOWN HEREIN OR NOT.

Signature: [Signature]  
 DATE: 4-9-98

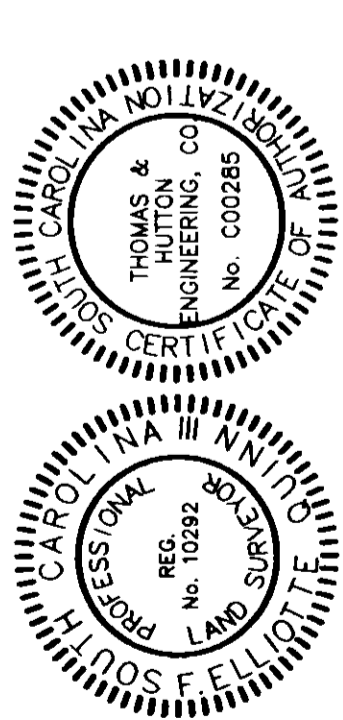

General Property Survey  
 I, F. Elliott Quinn, III, a Registered Professional Land Surveyor in the State of South Carolina, certify to owner(s) shown herein that this survey was made in accordance with the Minimum Standards Manual for the Practice of Land Surveying in South Carolina, and meets or exceeds the requirements for a Class 'A' survey as specified therein.  
 Date: 4/20/98  
 F. Elliott Quinn, III, R.L.S.  
 S.C. Registration Number 10292  
 This is not a true, valid copy of this document unless bearing an original signature and a raised embossed seal of the surveyor.