

# Soils Map

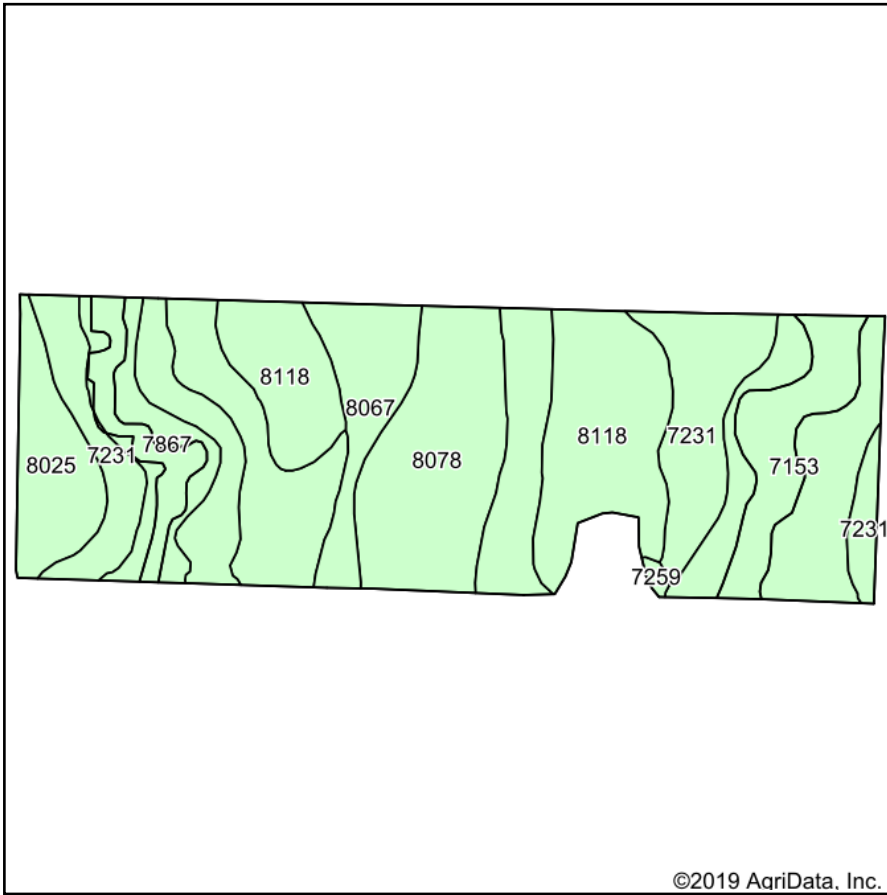

Soils data provided by USDA and NRCS.

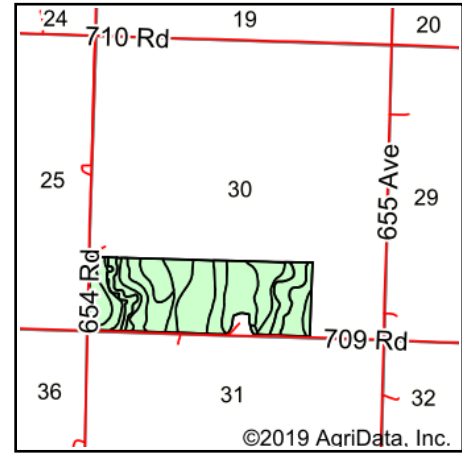

State: **Nebraska**  
 County: **Richardson**  
 Location: **30-2N-17E**  
 Township: **Arago**  
 Acres: **116.73**  
 Date: **2/18/2019**

Maps Provided By:  
  
 CUSTOMIZED ONLINE MAPPING  
 © AgriData, Inc. 2019 www.AgriDataInc.com



**Area Symbol: NE147, Soil Area Version: 17**

Code	Soil Description	Acres	Percent of field	Non-Irr Class *c	Irr Class *c	SRPG	Alfalfa hay	Corn	Grain sorghum	Soybeans	Winter wheat	*n NCCPI Soybeans
8078	Monona silt loam, 6 to 11 percent slopes	25.12	21.5%	IIIe	IVe	69						84
7231	Judson silt loam, 2 to 6 percent slopes	21.80	18.7%	Ile		79						68
8118	Pohocco silt loam, 6 to 11 percent slopes, eroded	20.19	17.3%	IIIe	IVe	69	5	96	89	30	33	61
7153	Kennebec silt loam, rarely flooded	19.39	16.6%	Iw		83						86
8067	Monona silt loam, 1 to 6 percent slopes	13.79	11.8%	Ile	IIIe	76						87
7867	Nodaway silt loam, channeled, frequently flooded	8.76	7.5%	VIw		61						40
8025	Marshall silty clay loam, 6 to 11 percent slopes, eroded	7.37	6.3%	IIIe	IVe	74						59
7259	Deroin silty clay loam, 6 to 11 percent slopes, severely eroded	0.31	0.3%	IVe	IVe	71	4	72	74		28	45
<b>Weighted Average</b>						<b>73.7</b>	<b>0.9</b>	<b>16.8</b>	<b>15.6</b>	<b>5.2</b>	<b>5.8</b>	<b>*n 72.7</b>

\*n: The aggregation method is "Weighted Average using major components"

\*c: Using Capabilities Class Dominant Condition Aggregation Method

Soils data provided by USDA and NRCS.