

I, W. GAILLARD, a registered surveyor of the State of South Carolina, do hereby certify that I have surveyed the property shown hereon, that this plat shows the true dimensions of the property, that all necessary markers have been installed, and the precision is one: 3684 *W.S. Gaillard*

BOOK **G100** PAGE **198**

Charleston, South Carolina
 Office of Registrar Means Conveyance
 Plat recorded this *10th* day of *October*, 1972.
 1105' close in lot Book K Page 7, and tracing cloth copy filed in Case # *10466*, Folio 38, Instrument No. *10466*... (initials) ...
W.S. Gaillard
 Registrar Means Conveyance

The approval of this plat in no way obligates the County of Charleston to accept for continued maintenance any of the roads or easements shown hereon.

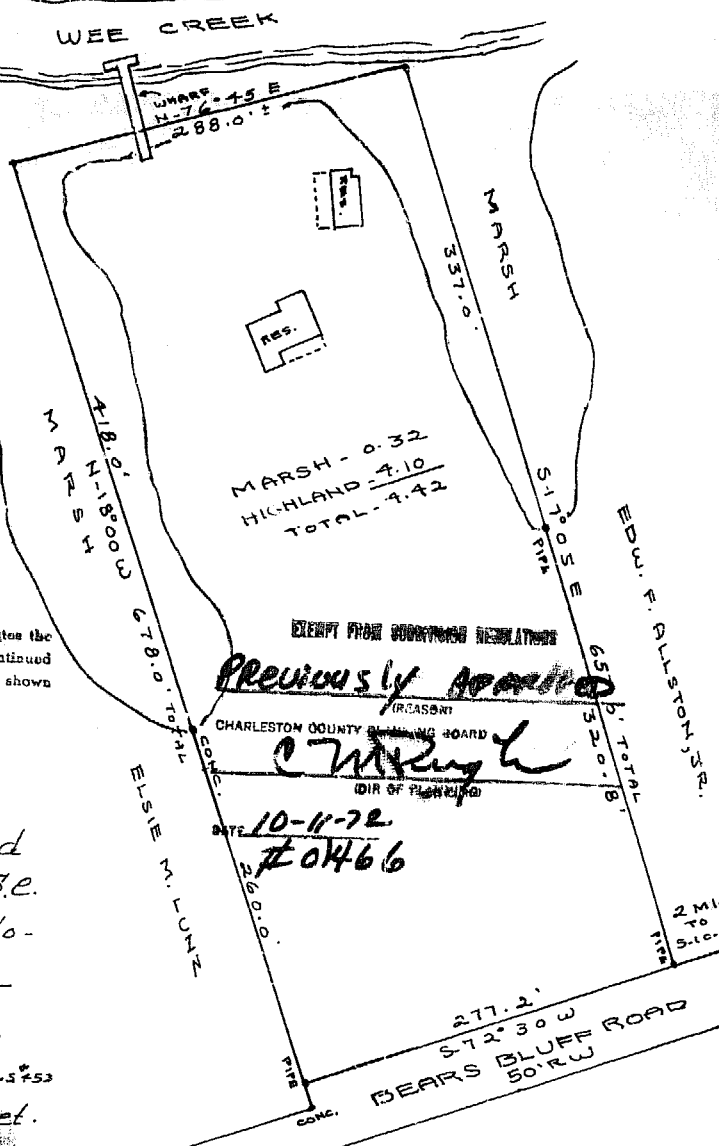

Plat of Property on
 Wadmataw Island
 Charleston County, S.E.
 about to be conveyed to -
 Bert-Styn Corp.

Surveyed Oct. 6, 1972
 By - *W.S. Gaillard*, R.S. #53
 Scale - 1" = 100 feet.

50' ROAD
 (PREVIOUSLY APPROVED)
 (APPL. No 3872
 AS CORRECTED PLAT BOOK AA,
 PAGE 74, R.M.C.O.)

NOTE: WITHIN PROPERTY IS EXISTING BY APPROVED PLAT RECORDED IN PLAT BOOK- AA, PG. 79, R.M.C.O.