

Soils Map

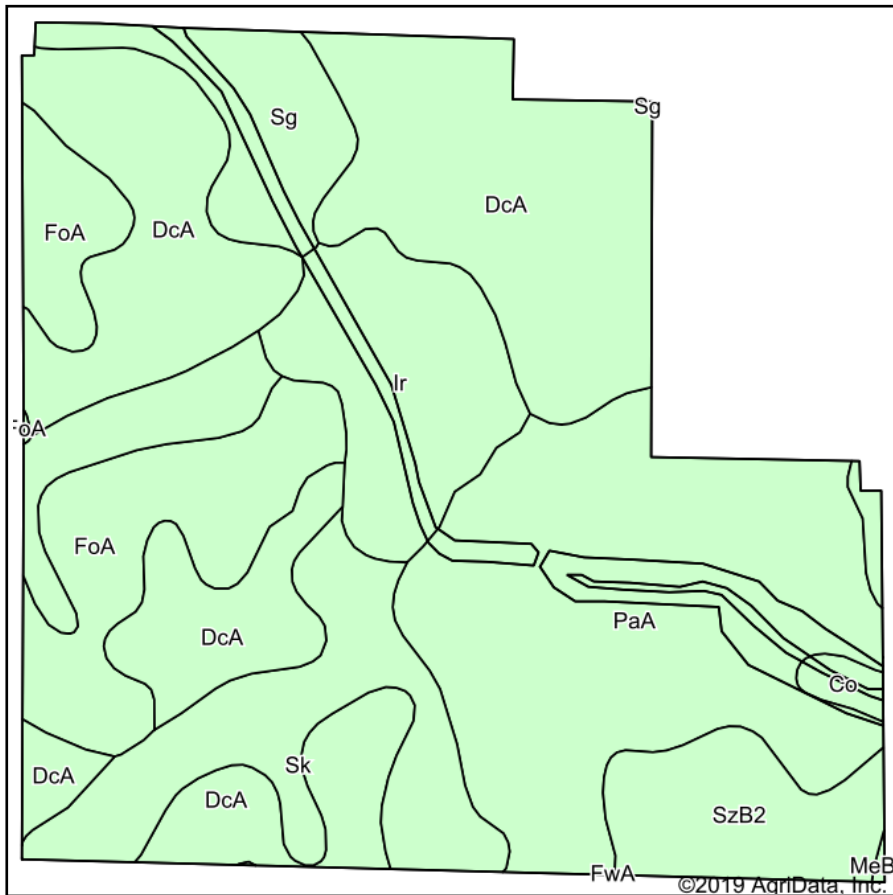

Soils data provided by USDA and NRCS.

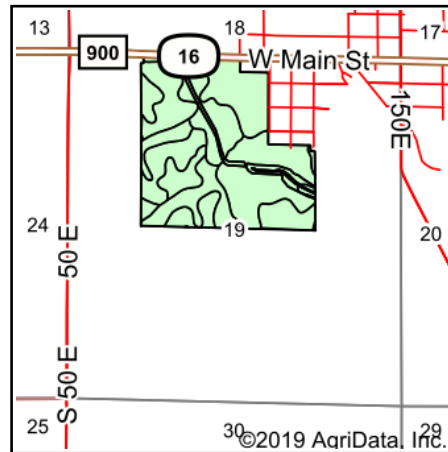

State: **Indiana**
 County: **Newton**
 Location: **19-28N-8W**
 Township: **Iroquois**
 Acres: **135.07**
 Date: **8/26/2019**

Maps Provided By:

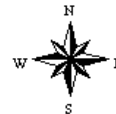

Area Symbol: IN111. Soil Area Version: 23												
Code	Soil Description	Acres	Percent of field	Non-Irr Class *c	Grass legume hay	Corn	Pasture	Soybeans	Winter wheat	Grass legume pasture	Oats	*n NCCPI Soybeans
DcA	Darroch silt loam, 0 to 2 percent slopes	44.09	32.6%	Iw	5	153		50	60	8	79	78
PaA	Papineau fine sandy loam, 0 to 1 percent slopes	32.68	24.2%	IIw	5	150	10	46	68			62
Sk	Selma silty clay loam, till substratum	16.93	12.5%	IIw	6	175	12	49	70			75
FoA	Foresman silt loam, 0 to 2 percent slopes	14.93	11.1%	I	5	145	9	48	66			82
Ir	Iroquois fine sandy loam	11.36	8.4%	IIw	6	170	11	47	68			70
SzB2	Swygert variant-Simonin complex, 2 to 6 percent slopes, eroded	7.39	5.5%	IIIe	4	130	9	43	59			30
Sg	Selma loam, 0 to 2 percent slopes	6.75	5.0%	IIw	6	154		50	60	10	78	77
Co	Comfrey loam, frequently flooded, undrained	0.86	0.6%	VIw								20
MeB2	Martinsville-Williamstown complex, 2 to 6 percent slopes, eroded	0.08	0.1%	IIe	5	128	8	45	62			52
Weighted Average					5.2	153.4	6.3	47.7	64.1	3.1	29.7	*n 70.5

*n: The aggregation method is "Weighted Average using major components"

*c: Using Capabilities Class Dominant Condition Aggregation Method

Soils data provided by USDA and NRCS.