

PREPARED FOR:
H & B WILSON INTERESTS, LTD. (SELLER)
BRETT STAFFORD (BUYER)

% PRESIDIO TITLE
7373 BROADWAY, SUITE 105
SAN ANTONIO, TEXAS 78209

PURPOSE:
CONVEYANCE

NOTE:
CONVEYANCE AND AREA SHOWN ARE BASED UPON THE DATA COORDINATE SYSTEM NORTH AMERICAN DATUM 1983 TEXAS SOUTH ZONE AND WERE DETERMINED BY SURVEY GRADE GLOBAL POSITIONING NOT ALL IMPROVEMENTS ARE SHOWN ON PLAT

WARNING: UNAUTHORIZED ALTERATION OF CERTIFIED MATERIAL IS FORGERY.

J. G. Smyth & Co., Inc.

1022 GARNER FIELD RD.
SUITE D 78801
LUALABE, TEXAS
PHONE 830/591-0858

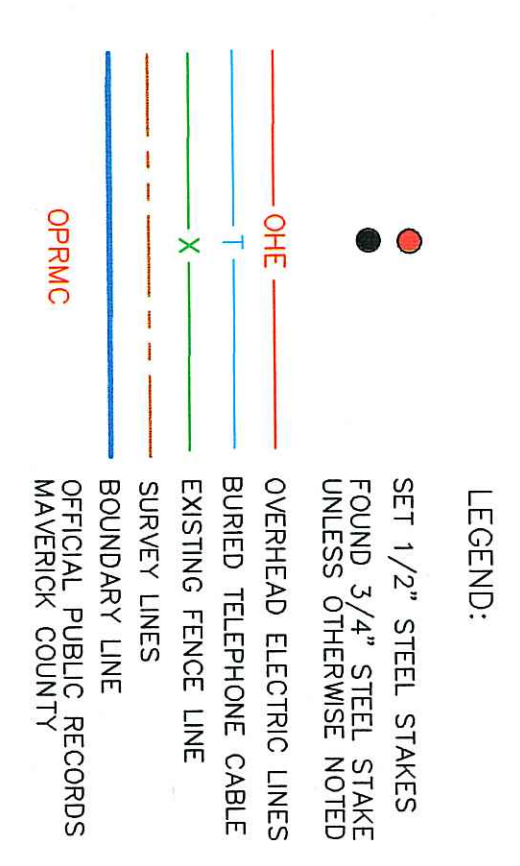

PLAT SHOWING:
Severance Survey Of A 3250.00 Acre Tract Of Land, Lying In Maverick County, Texas, Being Out Of And A Part Of That Same Certain 5997 Acre Parent Tract Described In Conveyance To H & B Wilson Interests, Ltd. And Recorded In Volume 553, Pages 359-363 And That Same Certain 351.22 Acre Tract Of Land Described In Conveyance To H & B Wilson Interests, Ltd. And Recorded In Volume 1005, Pages 285-291 Of The Official Public Records Of Maverick County, Texas And Being Out Of And Parts Of The Following Surveys:

SURVEY	GRANTEE	ABSTRACT
25	JOHN BELL	A-71
26	ELIZA BELL	A-72
26 1/2	I. H. EVANS	A-1276
28	HAYDEN BELL	A-73
31	J.W. RIDDLE & F.H. HARTZ	A-1168
32	F. H. HARTZ	A-1065
31	A. B. & M.	A-30
58 1/2	I & G. N. R. R.	A-888
59	I & G. N. R. R.	A-267
76	I & G. N. R. R.	A-278
79	I & G. N. R. R.	A-281
94	I & G. N. R. R.	A-296
95	I & G. N. R. R.	A-297
96	I & G. N. R. R.	A-298
97	I & G. N. R. R.	A-299

ITEMS C & D NOTED ON PLAT ARE IN REFERENCE TO TITLE COMMITMENT FILE NO. 88388.

CERTIFICATE
I, J. G. Smyth, do hereby certify that this PLAT was prepared from an original survey made by me or under my supervision and that the same is a true and correct copy of the original survey and that I am a duly licensed Surveyor in the State of Texas. My commission expires on the 15th day of February, 2008.

STATE OF TEXAS:
COUNTY OF UVALDE:
J. G. SMYTH
REGISTERED SURVEYOR, LAND SURVEYOR
REGISTRATION NO. 2866
PROJECT NO. 08-3434

THE SURVEYOR EXPRESSLY STATES THAT THE INFORMATION CONTAINED HEREIN IS THE PROPERTY OF THE SURVEYOR AND IS NOT TO BE REPRODUCED OR TRANSMITTED IN ANY FORM OR BY ANY MEANS, ELECTRONIC OR MECHANICAL, INCLUDING PHOTOCOPYING, RECORDING, OR BY ANY INFORMATION STORAGE AND RETRIEVAL SYSTEM, WITHOUT THE WRITTEN PERMISSION OF THE SURVEYOR. THE SURVEYOR ASSUMES NO LIABILITY FOR LOSS OF OR DAMAGE TO ORIGINAL RECORDS OR INSTRUMENTS. THE SURVEYOR'S LIABILITY IS LIMITED TO THE PERFORMANCE OF THE SURVEYING SERVICES PROVIDED BY HIMSELF OR HIS EMPLOYEES OR AGENTS. THE SURVEYOR'S LIABILITY IS LIMITED TO THE PERFORMANCE OF THE SURVEYING SERVICES PROVIDED BY HIMSELF OR HIS EMPLOYEES OR AGENTS. THE SURVEYOR'S LIABILITY IS LIMITED TO THE PERFORMANCE OF THE SURVEYING SERVICES PROVIDED BY HIMSELF OR HIS EMPLOYEES OR AGENTS.

