

# Soils Map

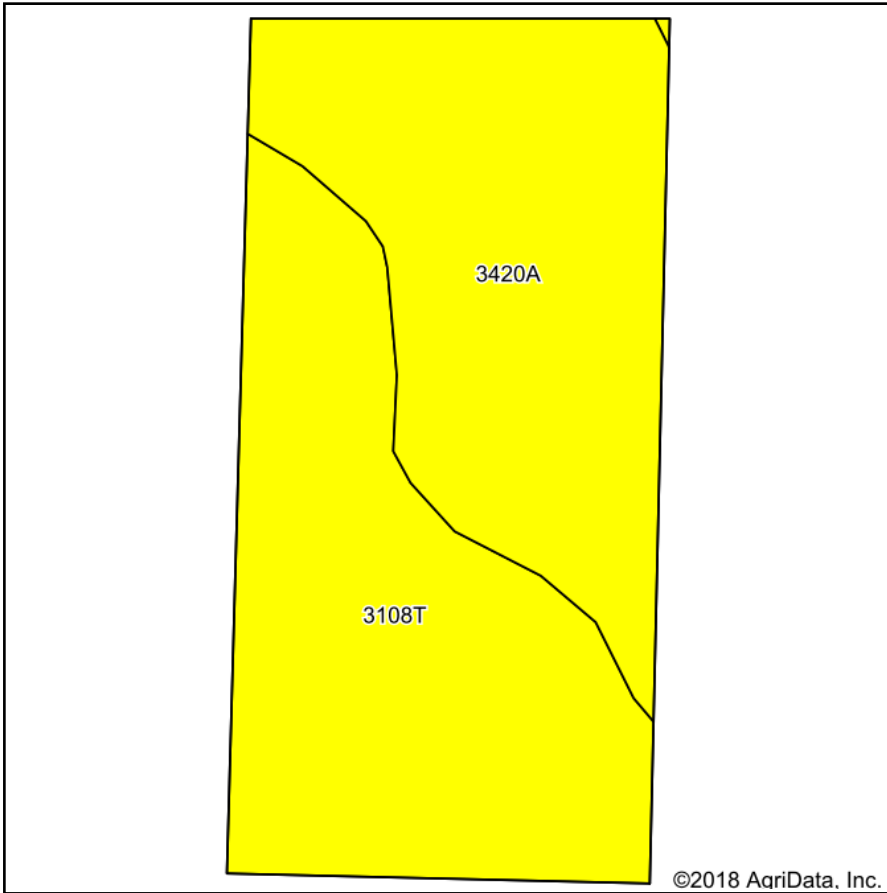

Soils data provided by USDA and NRCS.

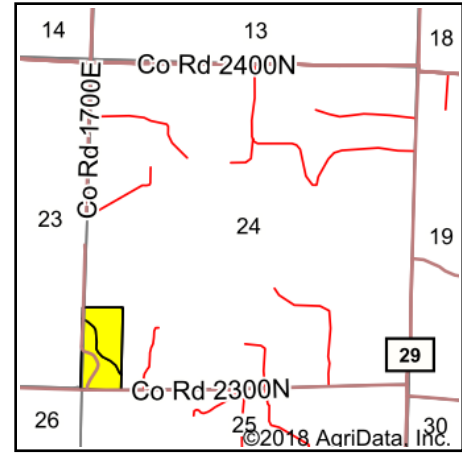

State: **Illinois**  
 County: **Wayne**  
 Location: **24-2N-7E**  
 Township: **Keith**  
 Acres: **20.05**  
 Date: **11/24/2018**

Maps Provided By:  
  
 CUSTOMIZED ONLINE MAPPING  
 © Agridata, Inc. 2018 www.AgridataInc.com



Area Symbol: IL191, Soil Area Version: 16

Code	Soil Description	Acres	Percent of field	Il. State Productivity Index Legend	Corn Bu/A	Soybeans Bu/A	Wheat Bu/A	Crop productivity index for optimum management
3108T	Bonnie silt loam, sodic, 0 to 2 percent slopes, frequently flooded	10.35	51.6%		149	49	59	111
3420A	Piopolis silty clay loam, 0 to 2 percent slopes, frequently flooded	9.70	48.4%		142	48	59	108
<b>Weighted Average</b>					<b>145.6</b>	<b>48.5</b>	<b>59</b>	<b>109.5</b>

**Table: Optimum Crop Productivity Ratings for Illinois Soil by K.R. Olson and J.M. Lang, Office of Research, ACES, University of Illinois at Champaign-Urbana.** Version: 1/2/2012 Amended Table S2 B811

Crop yields and productivity indices for optimum management (B811) are maintained at the following NRES web site: <http://soilproductivity.nres.illinois.edu/>

\*\* Indexes adjusted for slope and erosion according to Bulletin 811 Table S3

Soils data provided by USDA and NRCS. Soils data provided by University of Illinois at Champaign-Urbana.

\*c: Using Capabilities Class Dominant Condition Aggregation Method