

CND

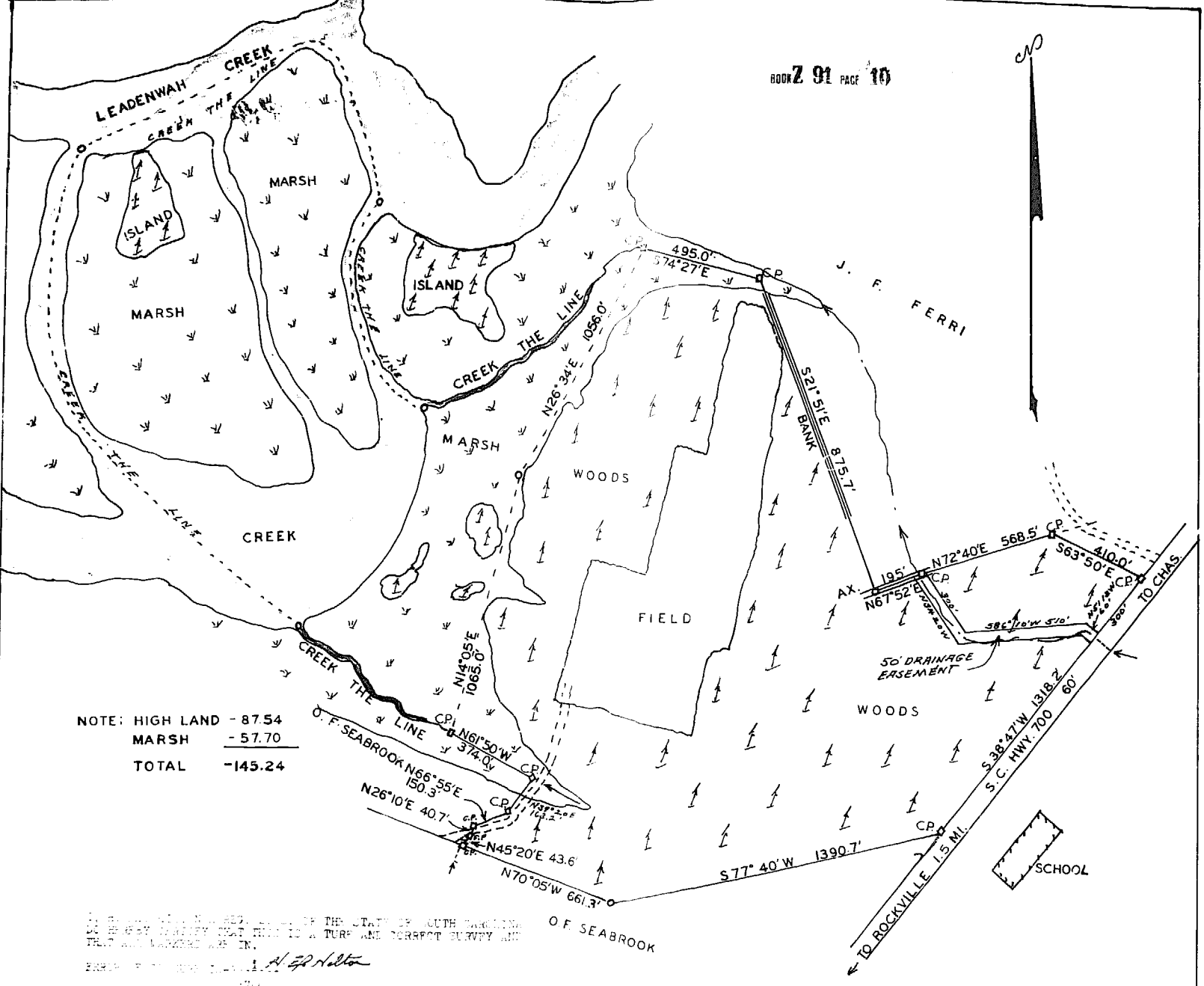

NOTE: HIGH LAND - 87.54
 MARSH - 57.70
 TOTAL - 145.24

BEFORE ME, Notary Public for the State of South Carolina, on this 10th day of February, 1969, at Charleston, South Carolina, personally appeared O. F. Seabrook, who being duly sworn, depose and say that he is a true and correct surveyor and that the foregoing is in accordance with the true and correct survey of the above described land.

Witness my hand and seal this 10th day of February, 1969.

10 Feb 69
 1240 4 49
 25 2 2 17
 white
 Charleston County Planning Board

PLAT OF 145.24 ACRES
PROPERTY OF O. F. SEABROOK
ABOUT TO BE CONVEYED TO
CORRIE F. BILBRO & WALTER BILBRO
WADMALAW ISLAND, CHARLESTON CO. S. C.
SCALE: 1" = 300' JAN. 1969
H. E. O. Hilton, B. L. S.
H. EXO HILTON REG. L. S. NO. 2552

2670

Caroline H. Sigmund
 H. Exo

2-5-69

BY THE RECORDING OF THIS PLAT I, O. F. Seabrook
 HEREBY DEDICATE ALL RIGHTS OF WAYS AND DRAINAGE EASEMENTS
 TO THE USE OF THE PUBLIC FOREVER.

NO

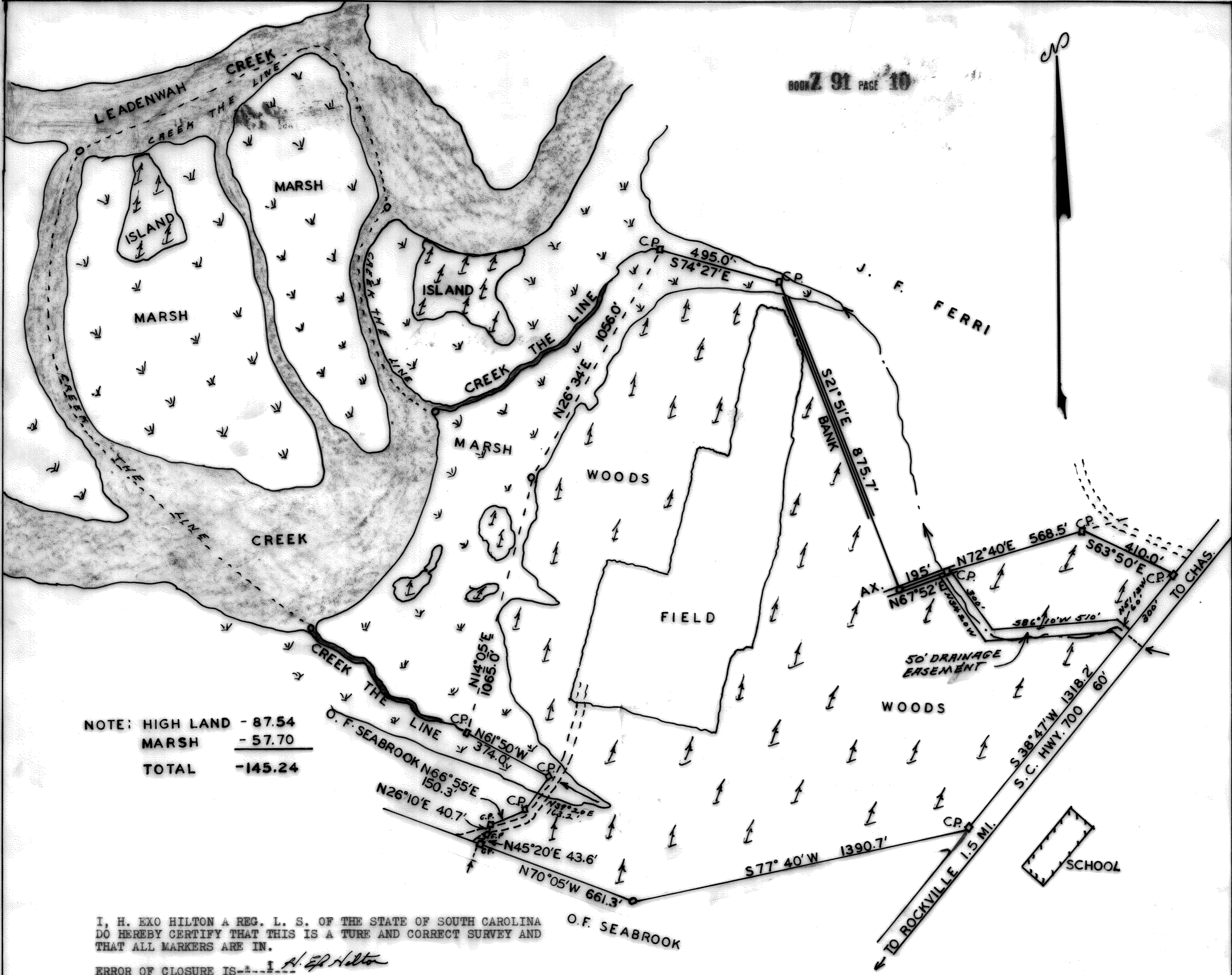

NOTE: HIGH LAND - 87.54
 MARSH - 57.70
 TOTAL - 145.24

I, H. EXO HILTON A REG. L. S. OF THE STATE OF SOUTH CAROLINA DO HEREBY CERTIFY THAT THIS IS A TRUE AND CORRECT SURVEY AND THAT ALL MARKERS ARE IN.

ERROR OF CLOSURE IS ± 1.1 *H. Exo Hilton*
 3744

Charleston, South Carolina
 Office of Register Mesne Conveyance
 Plat recorded this 10 day of Feb. 1969. at
 12:40 o'clock in Plat Book 91 Page 10, and tracing cloth
 copy filed in File 2, Drawer 2, Folder 17, Drawing
 No. 25. Original plat (white print) delivered
 to Charleston County Planning Board

PLAT OF 145.24 ACRES
PROPERTY OF O. F. SEABROOK
ABOUT TO BE CONVEYED TO
CORRIE F. BILBRO & WALTER BILBRO
WADMALAW ISLAND, CHARLESTON CO. S. C.
 SCALE: 1" = 300' JAN. 1969

Arthur H. Burtov
 Register Mesne Conveyance

H. Exo Hilton, R. L. S.
 H. EXO HILTON REG. L. S. NO. 2552

2670

APPROVED FOR PLAT
Caroline H. Fugham
 CLERK, CHARLESTON COUNTY COUNCIL
H. Eason
 DIRECTOR OF PLANNING
 CHARLESTON COUNTY PLANNING BOARD
 DATE 2-5-69

BY THE RECORDING OF THIS PLAT I, *O. F. Seabrook*
 HEREBY DEDICATE ALL RIGHTS OF WAYS AND DRAINAGE EASEMENTS
 TO THE USE OF THE PUBLIC FOREVER.