

# Soils Map

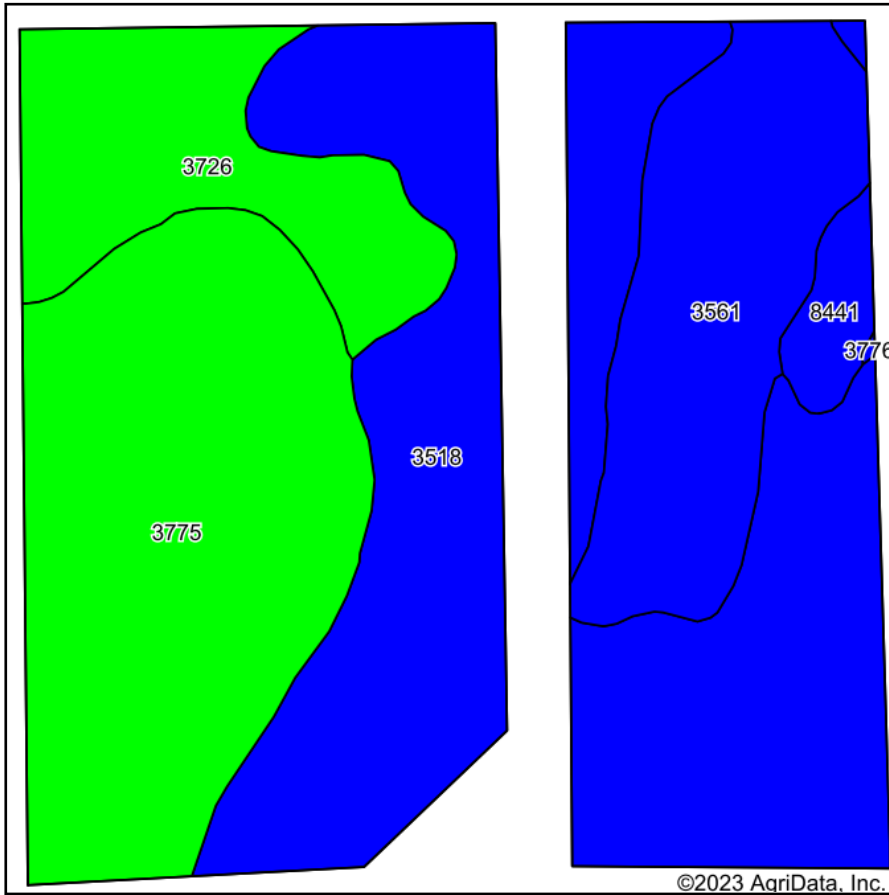

Soils data provided by USDA and NRCS.

©2023 AgriData, Inc.

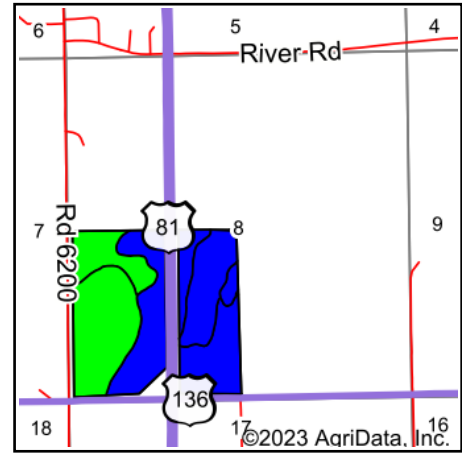

State: **Nebraska**  
 County: **Thayer**  
 Location: **8-2N-2W**  
 Township: **Hebron 2**  
 Acres: **132.12**  
 Date: **3/14/2023**



© AgriData, Inc. 2023

www.AgriDataInc.com

Area Symbol: NE169, Soil Area Version: 19

Code	Soil Description	Acres	Percent of field	Non-Irr Class Legend	Non-Irr Class *c	Irr Class *c	Range Production (lbs/acre/yr)	SRPG	Corn Bu	Corn Irrigated Bu	*n NCCPI Soybeans
3518	Lamo silty clay loam, occasionally flooded	56.39	42.7%	Blue	IIw	IIw	5445	53	101	124	69
3775	Muir silt loam, rarely flooded	36.77	27.8%	Green	Iw	Iw	4045	75			82
3561	Hobbs silt loam, occasionally flooded	20.75	15.7%	Blue	IIw	IIw	4235	71			80
3726	Detroit silt loam, 0 to 1 percent slopes	15.37	11.6%	Green	I	I	3600	73			66
8441	Cass very fine sandy loam, rarely flooded	2.84	2.1%	Blue	IIw	IIw	4851	51	91	159	48
<b>Weighted Average</b>					<b>1.61</b>	<b>1.61</b>	<b>4637.9</b>	<b>64.2</b>	<b>45.1</b>	<b>56.3</b>	<b>*n 73.5</b>

\*n: The aggregation method is "Weighted Average using all components"

\*c: Using Capabilities Class Dominant Condition Aggregation Method

Soils data provided by USDA and NRCS.