



FARMLAND /
POTENTIAL FOR INDUSTRIAL
DEVELOPMENT

Updated 4/24/23

KNAFF FARMS LAND

LA SALLE, ILLINOIS

Price: \$5,083,000

TABLE OF CONTENTS

DISCLAIMERS AND DISCLOSURES	3
Aerial Map with parcels identified	4
Property Summary	5
Property Photos	6
Drone footage instructions	9
Location Maps	10
Regional Map	11
Demographics	12
Soil Report - Parcel 1	13
Soil Report - Parcel 2	19
Soil Report - Parcel 3	23
Parcel 2 Property Disclosure	27
Parcel 2 Lead Paint Disclosure	31
Parcel 2 Radon Disclosure	32

DAVID SCHWALB

PRESIDENT

O: (312) 573-0770

C: (312) 282-1060

david@schwalb.com

DISCLAIMERS

These materials were prepared by Schwalb Realty Group, Inc. ("SRG") and contain selected information pertaining to the subject property (the "Property"), and do not purport to be all-inclusive or to contain all of the information which a prospective purchaser or user may need to pursue a transaction for the Property. Additional information and an opportunity to inspect the Property may be made available upon request. Neither the Owner nor SRG nor any of their respective directors, officers, employees, shareholders or affiliates have made any representation or warranty, express or implied, as to the accuracy or completeness of the information contained herein, and no legal commitment or obligation shall arise by reason of any presentation of information. While SRG has obtained the information above from sources believed to be reliable, SRG has not verified the occupancy and makes no guaranty, warranty or representation about it. All information provided is subject to the possibility of errors, corrections, change of price, or withdrawal without notice. Any included projections, opinions, assumptions, or estimates are for the purpose of example only, and may not represent current or future performance of the Property. You, your tax, and legal advisers should conduct your own investigations of the Property and any proposed transaction.

The Property may be subject to various property disclosures mandated by law, but may not necessarily be included with the information herein.

AGENCY DISCLOSURE

Schwalb Realty Group, Inc. ("SRG") has previously entered into an agreement with the owner of the Property (the "Owner") to provide certain real estate brokerage services through one or more brokers who each act as the Owner's designated agent. As a result, the designated agents of SRG will not be acting as your agent but solely as agents of the Owner. Any prospective purchasers of the Property are entitled to be represented by their own designated licensed brokers should they desire to do so.

AERIAL MAP WITH PARCELS IDENTIFIED

Knaff Farms LAND 1 of 2
2878 East 5th Road | La Salle, IL 61301



PROPERTY SUMMARY

Knaff Farms LAND 1 of 2
2878 East 5th Road | La Salle, IL 61301



Property Summary

Asking Price	\$5,083,000
Total Acres +/-	231
Per Acre Price	\$22,000
<hr/>	
Parcel 1 PIN	18-11-201-000
Parcel 1 Acres	158.89
Parcel 1 Taxes	\$5,210
<hr/>	
Parcel 2 PIN	18-12-103-000
Parcel 2 Acres	43.68
Parcel 2 Taxes	\$5,229
<hr/>	
Parcel 3 PIN	18-01-301-000
Parcel 3 Acres	28.50
Parcel 3 Taxes	\$1,079

Property Overview

1 of 2 Land Portfolios. Updated Pricing as of 4/24/23.

Farmland including buildings. In the path of future development. Near new industrial development occurring south of Interstate 80. Parcels subject to annual leases.

Highly productive agricultural land for soybeans and corn. Includes parcels that have been in the same family since the 1860's.

Plats of Survey, drone video and additional information available for review.

Location Overview

Due south of junction of Interstate 80 and Interstate 39 in La Salle County, Illinois. Just north of US-6 exit off of Interstate 39. Parts of the property are adjacent to Rotary Park in La Salle, Illinois.



Parcel 1



PROPERTY PHOTOS

Knaff Farms LAND 1 of 2
2878 East 5th Road | La Salle, IL 61301



Parcel 2



PROPERTY PHOTOS

Knaff Farms LAND 1 of 2
2878 East 5th Road | La Salle, IL 61301

08



Parcel 3

Drone footage for each of the Parcels can be downloaded from the following links:

Parcel 1:

https://www.dropbox.com/s/obg3syaoc5mux9u/DJI_0500.MP4?dl=0

https://www.dropbox.com/s/3cy2nw4a1u0tfo9/DJI_0506.MP4?dl=0

Parcel 2:

https://www.dropbox.com/s/q8yb4mh7fb6ph8q/DJI_0489.MP4?dl=0

Parcel 3:

https://www.dropbox.com/s/1npull575actdp8/DJI_0508.MP4?dl=0

If you have any issues with downloading the footage, please contact Dmytro Lakhman (dlakhman@schwalb.com / 847.630.1337)

LOCATION MAPS

Knaff Farms LAND 1 of 2
2878 East 5th Road | La Salle, IL 61301

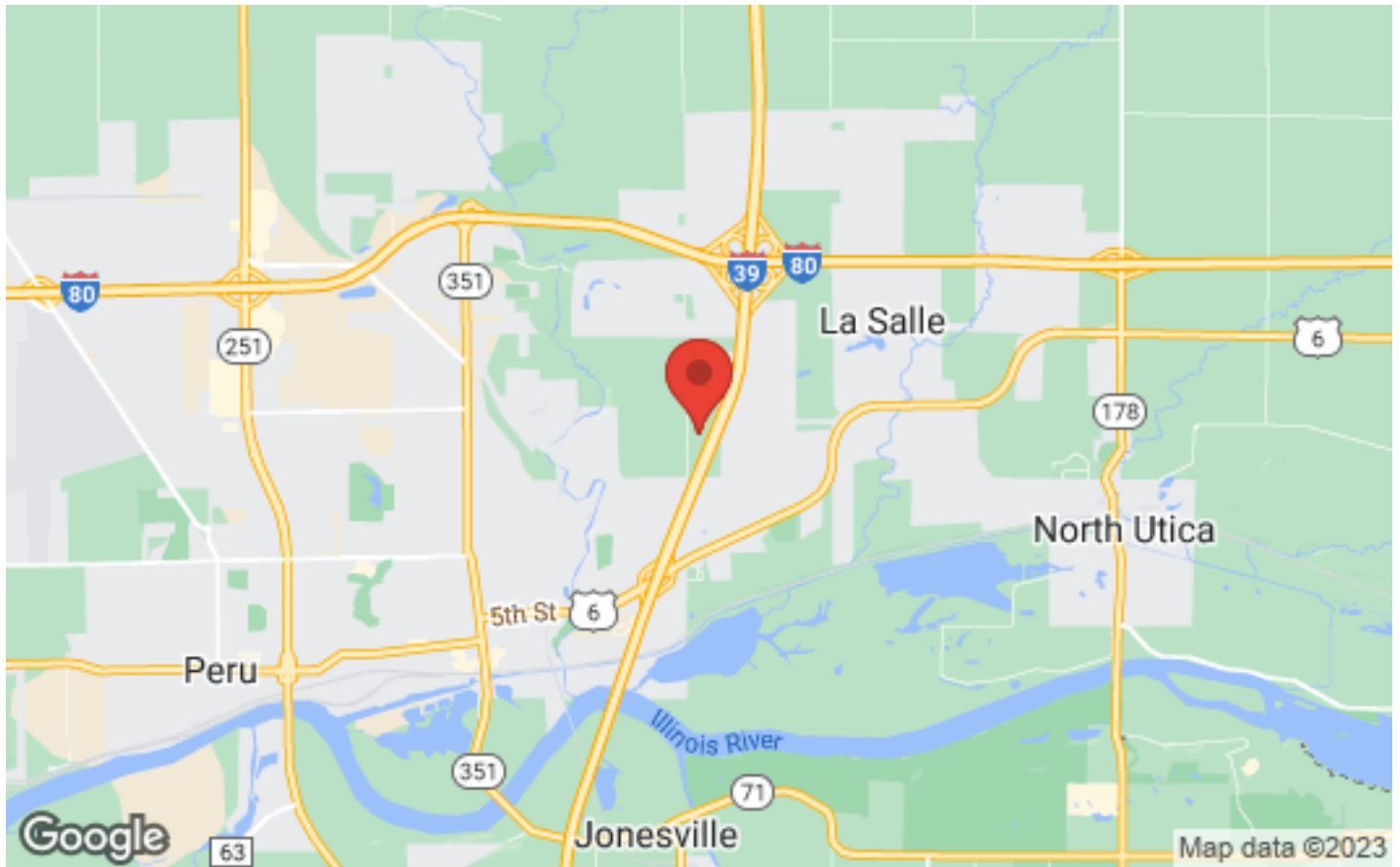
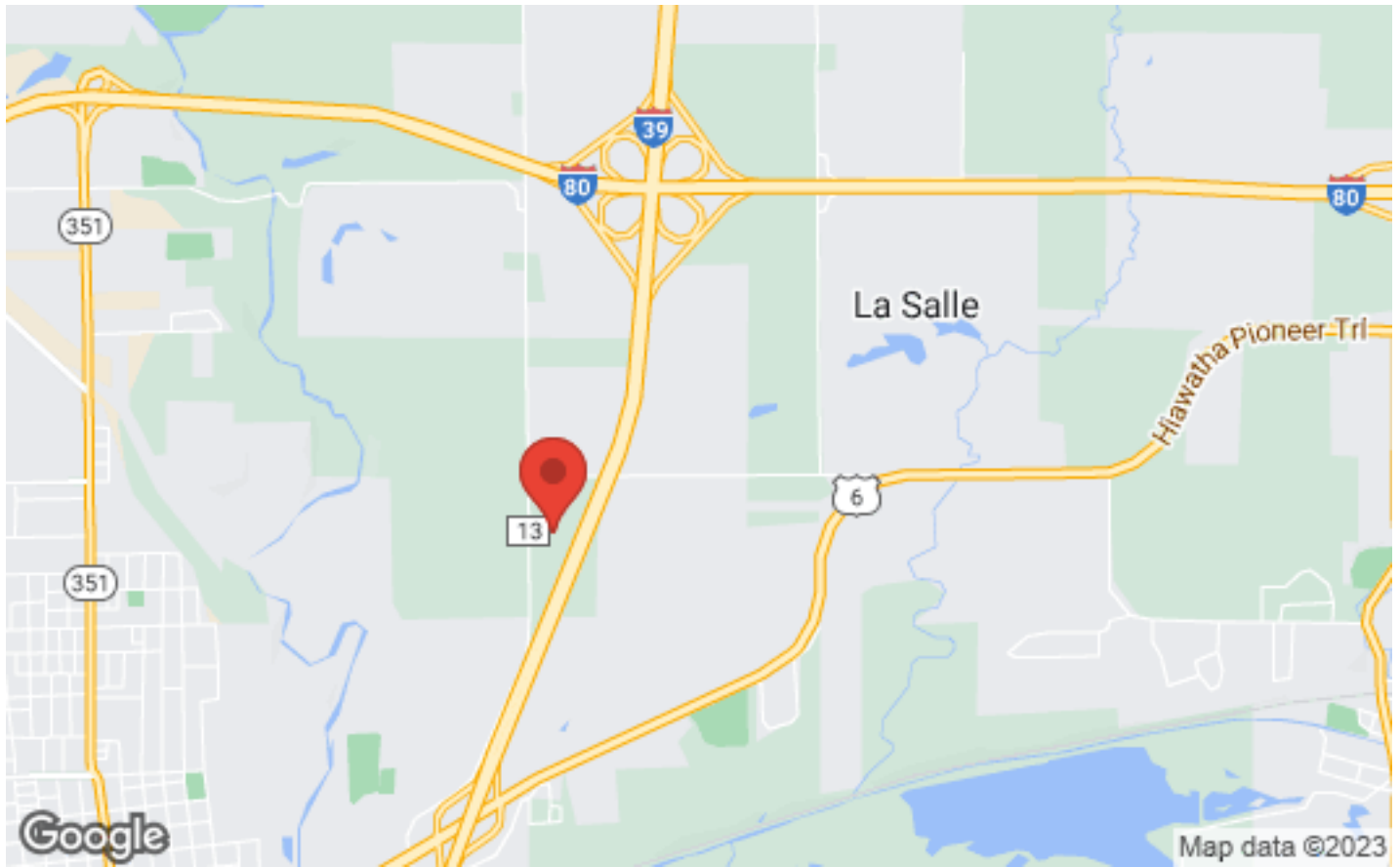

REGIONAL MAP

Knaff Farms LAND 1 of 2
2878 East 5th Road | La Salle, IL 61301

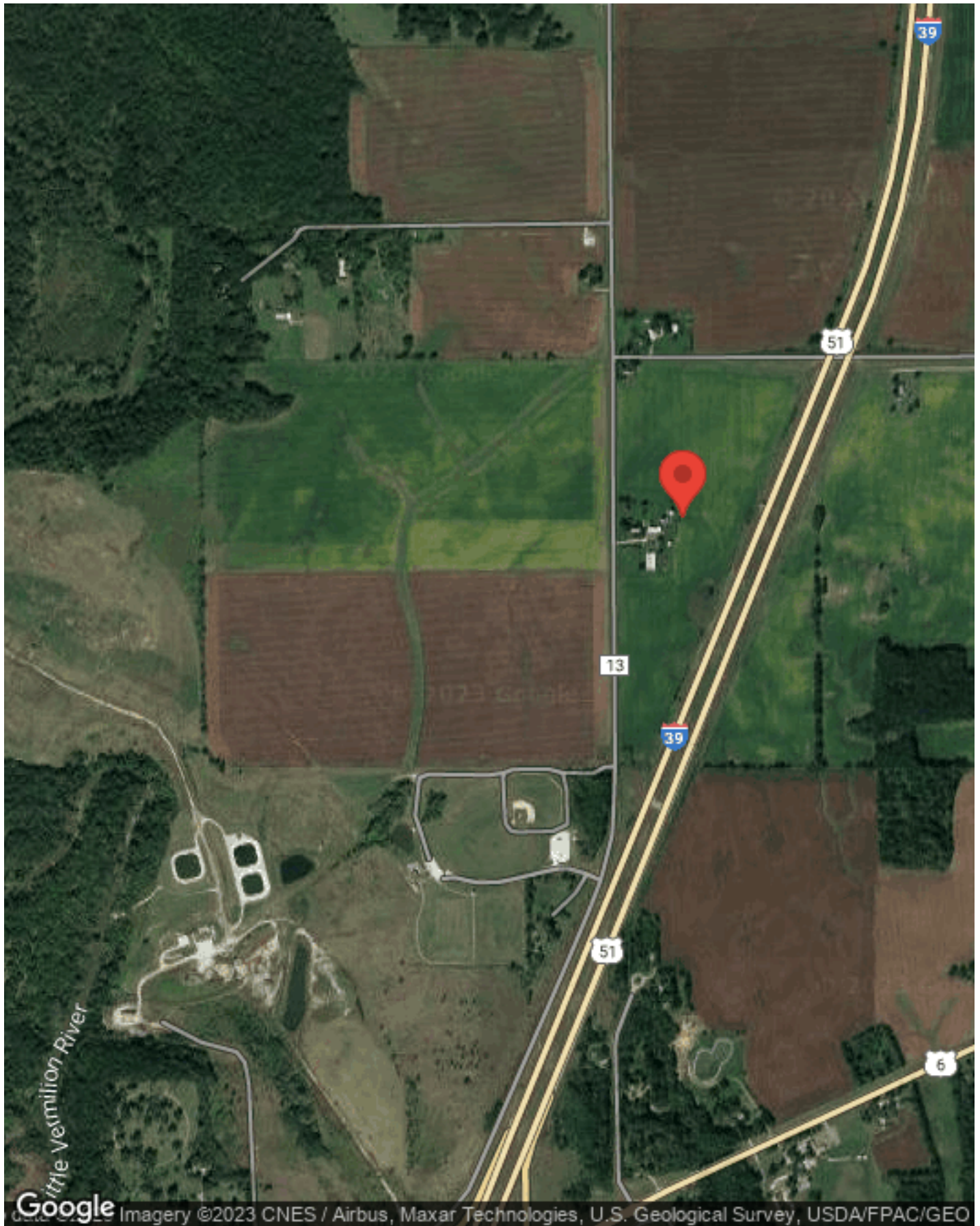

DEMOGRAPHICS

Knaff Farms LAND 1 of 2
2878 East 5th Road | La Salle, IL 61301

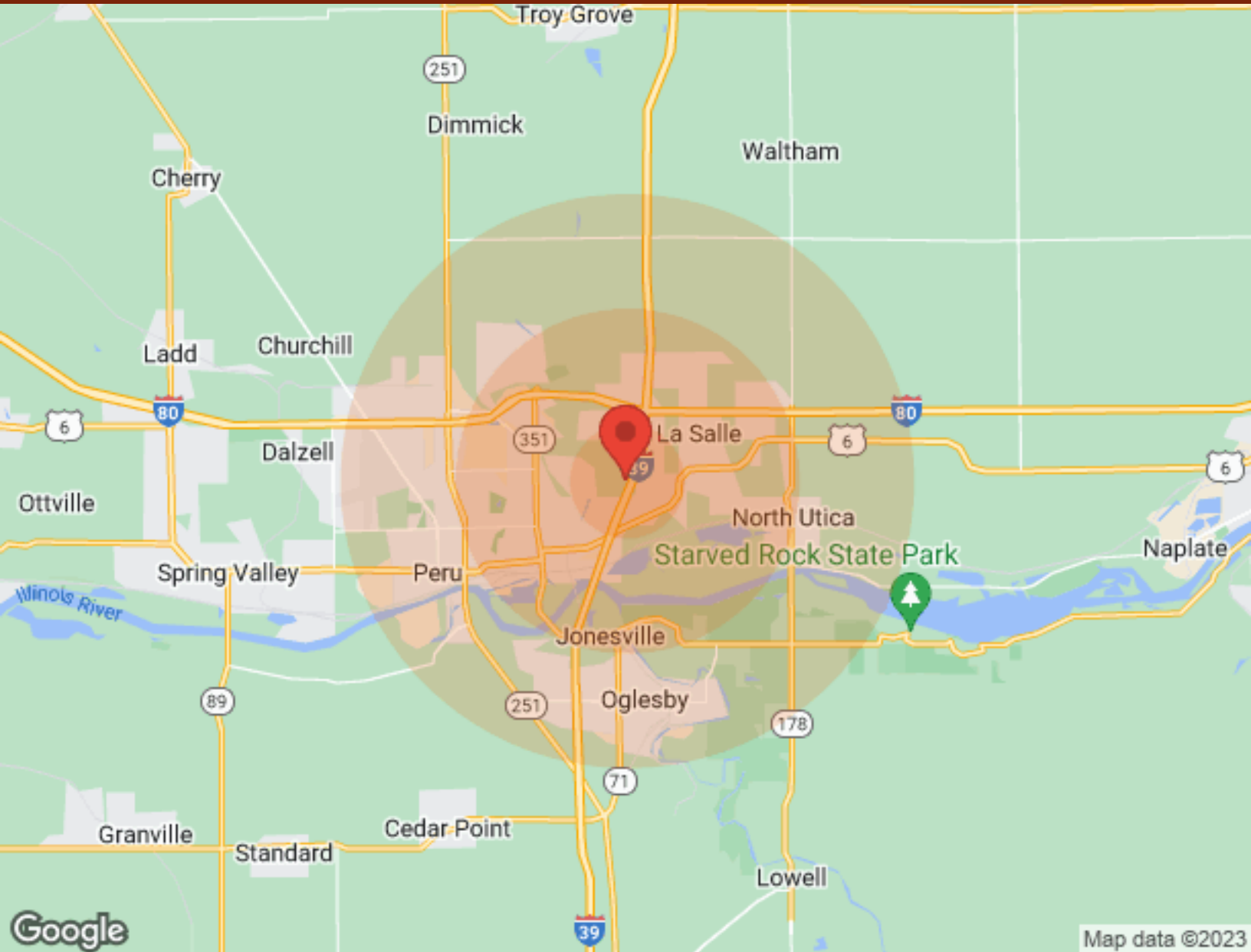

Population	1 Mile	3 Miles	5 Miles
Male	717	7,117	12,680
Female	667	7,394	13,606
Total Population	1,384	14,511	26,286
Age	1 Mile	3 Miles	5 Miles
Ages 0-14	304	2,704	4,804
Ages 15-24	220	1,881	3,339
Ages 55-64	155	1,914	3,472
Ages 65+	218	2,518	4,724
Race	1 Mile	3 Miles	5 Miles
White	1,214	13,701	25,316
Black	31	91	93
Am In/AK Nat	N/A	N/A	3
Hawaiian	N/A	N/A	N/A
Hispanic	227	1,299	1,623
Multi-Racial	276	1,292	1,574

Income	1 Mile	3 Miles	5 Miles
Median	\$26,876	\$42,471	\$48,441
< \$15,000	163	1,012	1,623
\$15,000-\$24,999	62	529	1,149
\$25,000-\$34,999	74	861	1,458
\$35,000-\$49,999	29	787	1,438
\$50,000-\$74,999	137	1,242	2,505
\$75,000-\$99,999	64	678	1,265
\$10,000-\$149,999	12	679	1,183
\$150,000-\$199,999	N/A	83	221
> \$200,000	2	149	195

Housing	1 Mile	3 Miles	5 Miles
Total Units	632	6,922	12,572
Occupied	583	6,278	11,496
Owner Occupied	396	4,197	8,266
Renter Occupied	187	2,081	3,230
Vacant	49	644	1,076

SOIL REPORT - PARCEL 1

Knaff Farms LAND 1 of 2
2878 East 5th Road | La Salle, IL 61301



108 South Crystal Lane · PO Box 226
Fairbury, IL 61739
Ph: (815) 692-2626 · Fx: (815) 692-4483

Follow us!   @UnitedSoilsInc



Location: **Grainco Fs, Inc. Mendota**
Grower: **Mark Knaff**
Farm:
Field: **1**
Test Packages: **S1**

Workorder #: **N/A**
Lab Batch ID: **22-006108**
Alternate ID: **N/A**
Order Date: **2022-08-22**
Test Date: **2022-08-25**

Soil Nutrient Results

Sample	pH	pHb	P lbs/ac	K lbs/ac	OM % Color	Ca	Mg	CEC	Base Saturation			Micro Nutrients						
									Ca	Mg	K	S	Zn	B	Fe	Mn	Cu	
1	5.8	--	59.8	256.7	2.4	--	--	--	--	--	--	--	--	--	--	--	--	--
2	5.8	--	53.1	272.5	2.8	--	--	--	--	--	--	--	--	--	--	--	--	--
3	5.4	--	39.1	194.8	2.7	--	--	--	--	--	--	--	--	--	--	--	--	--
4	5.8	--	93.0	288.4	2.6	--	--	--	--	--	--	--	--	--	--	--	--	--
5	6.9	--	99.2	353.1	2.9	--	--	--	--	--	--	--	--	--	--	--	--	--
Average	5.9	--	68.8	273.1	2.7	--	--	--	--	--	--	--	--	--	--	--	--	--

SOIL REPORT - PARCEL 1

Knaff Farms LAND 1 of 2
2878 East 5th Road | La Salle, IL 61301

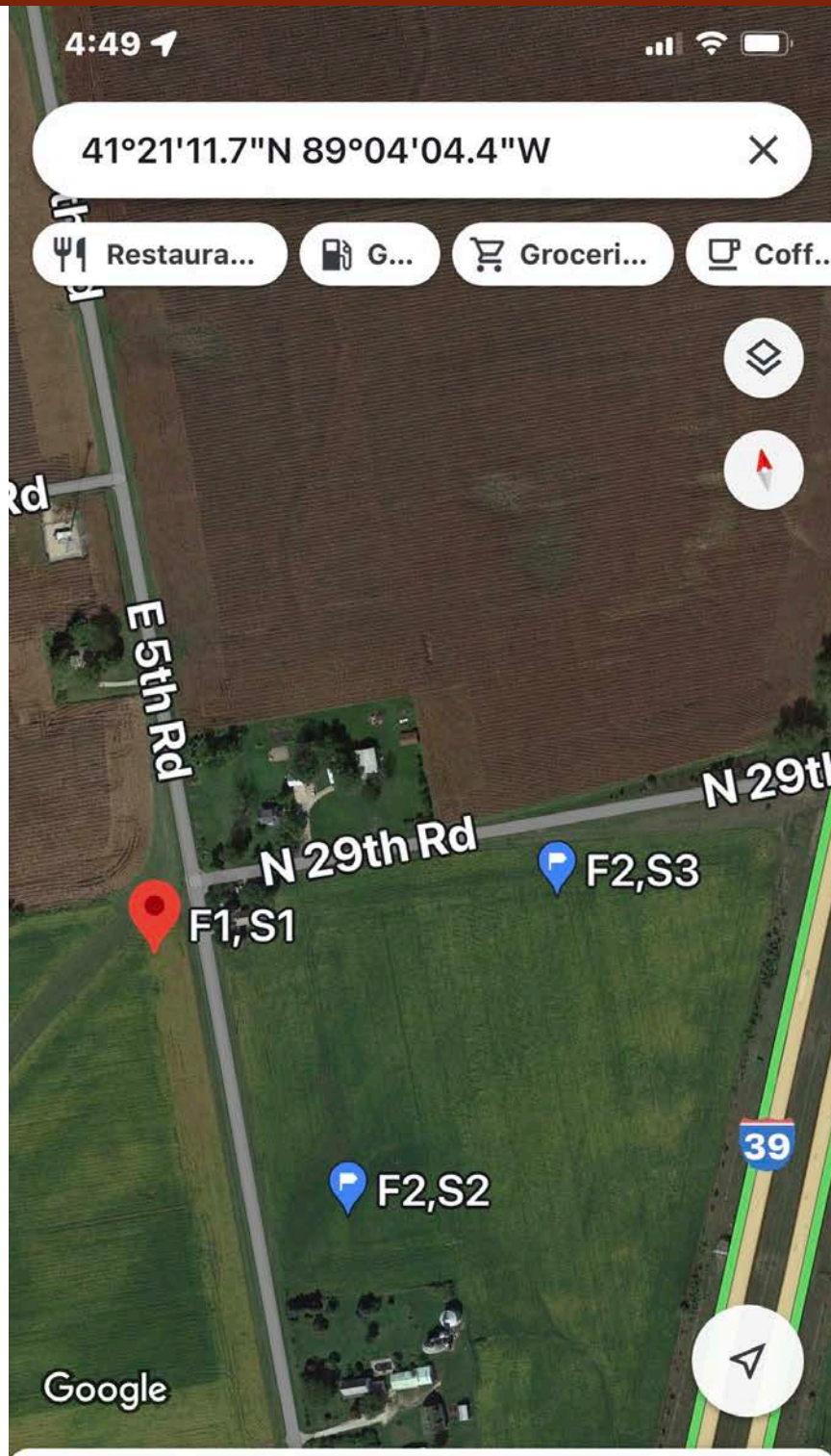

F1, S1

41.353238, -89.067875

🚗 7 min

- Directio...
- St...
- Sa...
- E

SOIL REPORT - PARCEL 1

Knaff Farms LAND 1 of 2
2878 East 5th Road | La Salle, IL 61301

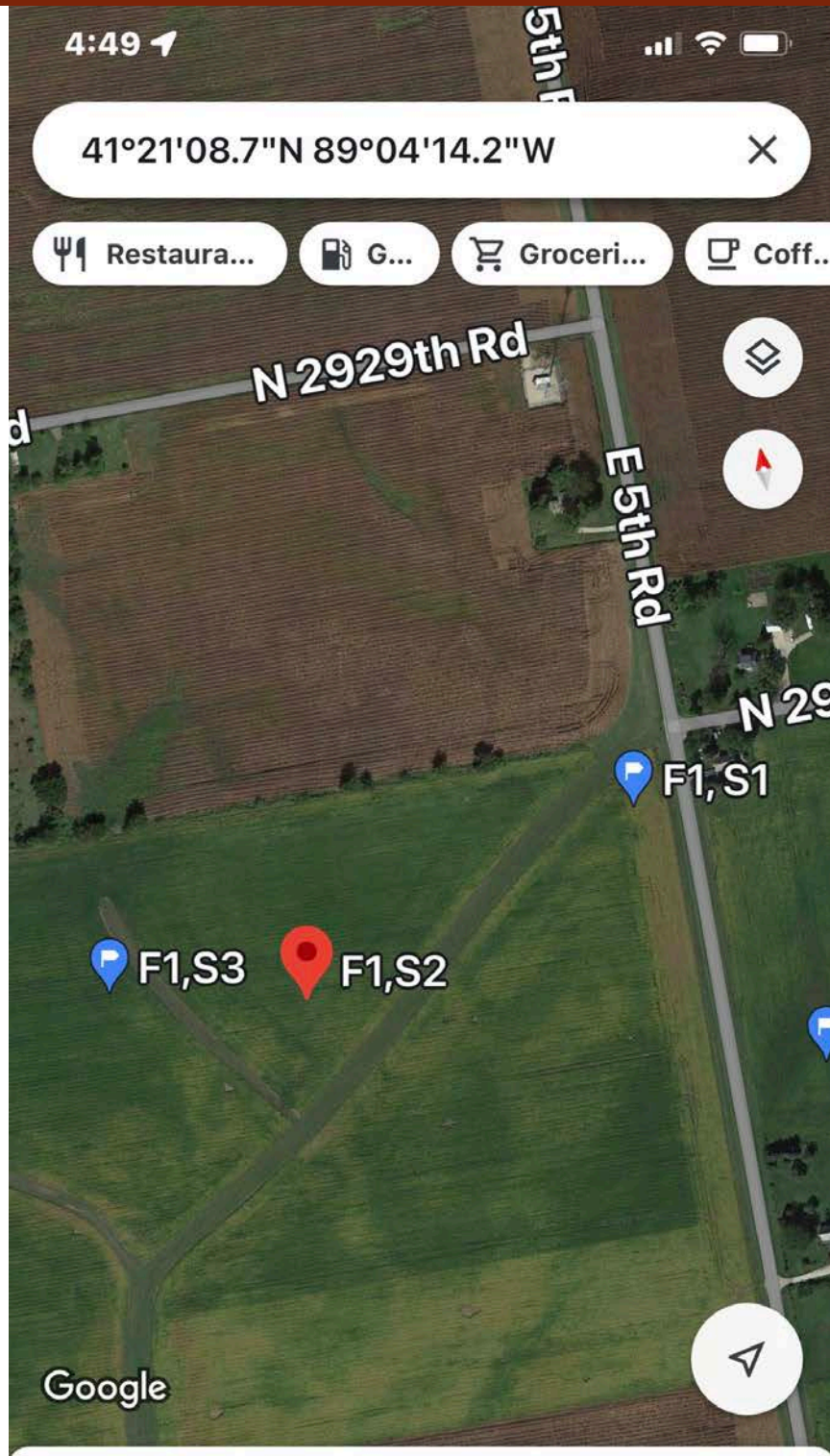

F1,S2

41.352421, -89.070618

🚗 7 min

- 📍 Directio...
- 📍 St...
- 📖 Sa...
- 🚩 E

SOIL REPORT - PARCEL 1

Knaff Farms LAND 1 of 2
2878 East 5th Road | La Salle, IL 61301

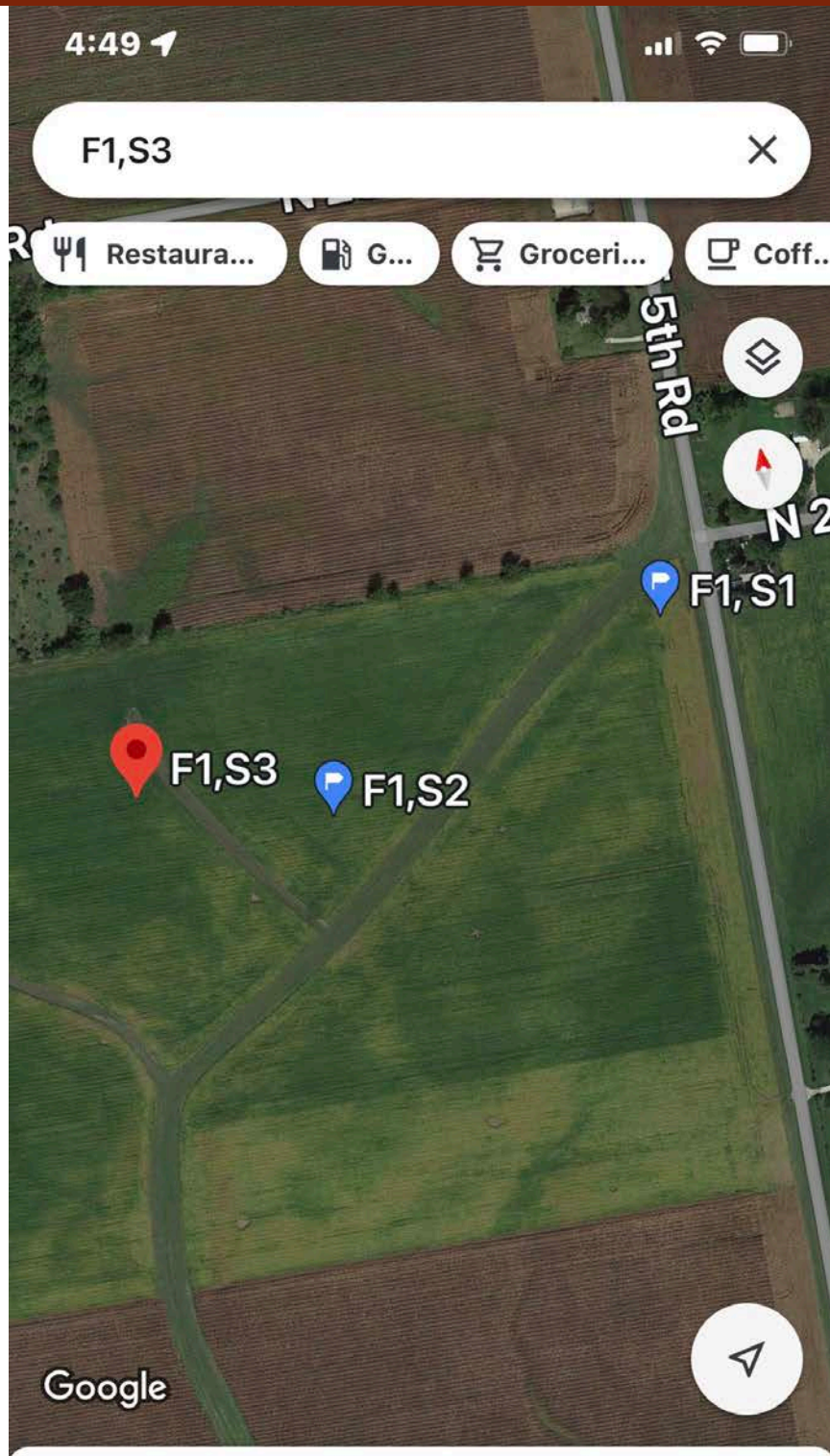

F1,S3

41.352686, -89.072099

🚗 8 min

- Directio...
- St...
- Sa...
- E

SOIL REPORT - PARCEL 1

Knaff Farms LAND 1 of 2
2878 East 5th Road | La Salle, IL 61301

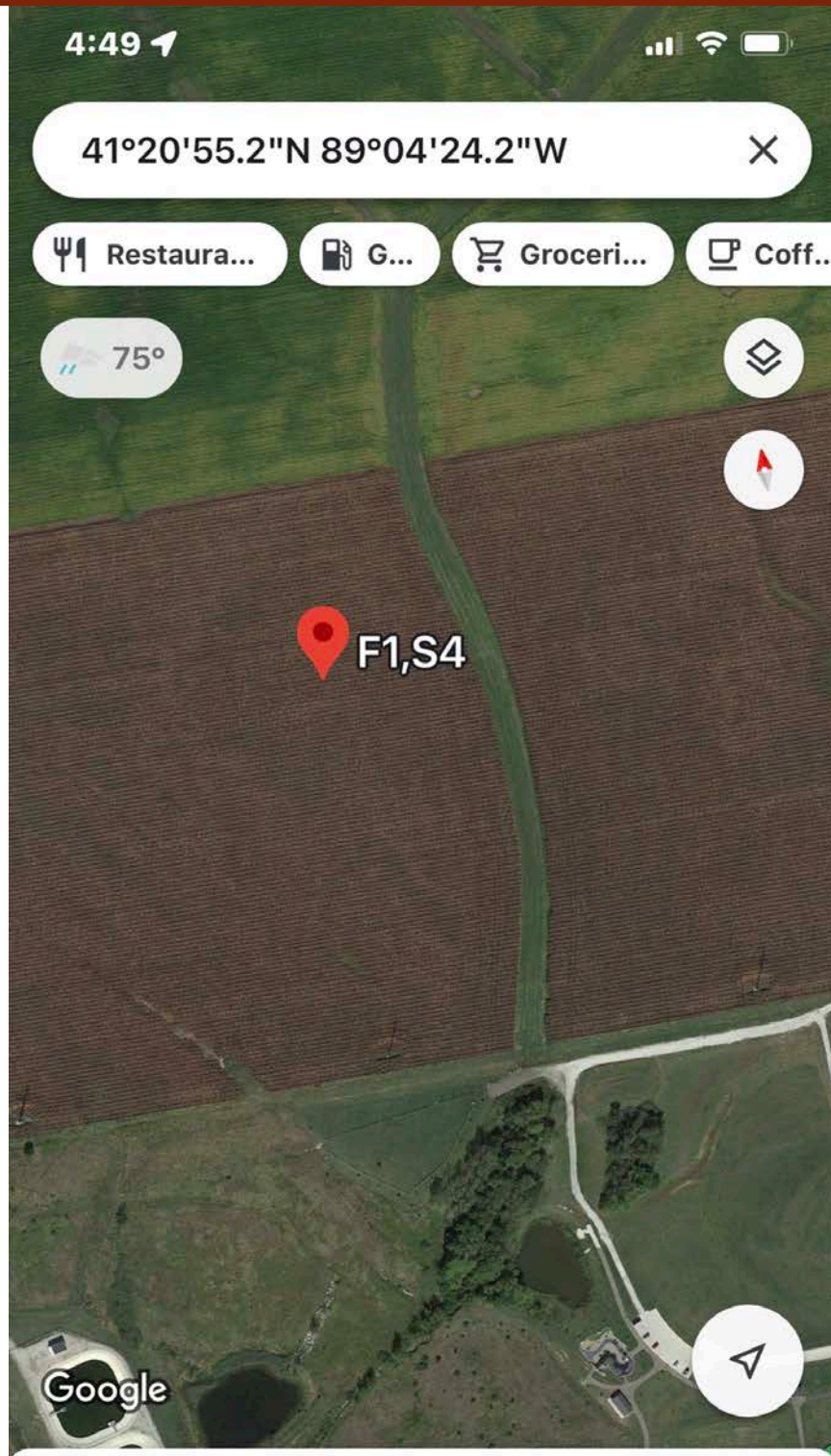

F1,S4

41.348667, -89.073382

🚗 7 min

- 📍 Directio...
- 📍 St...
- 📖 Sa...
- 🚩 E

SOIL REPORT - PARCEL 1

Knaff Farms LAND 1 of 2
2878 East 5th Road | La Salle, IL 61301

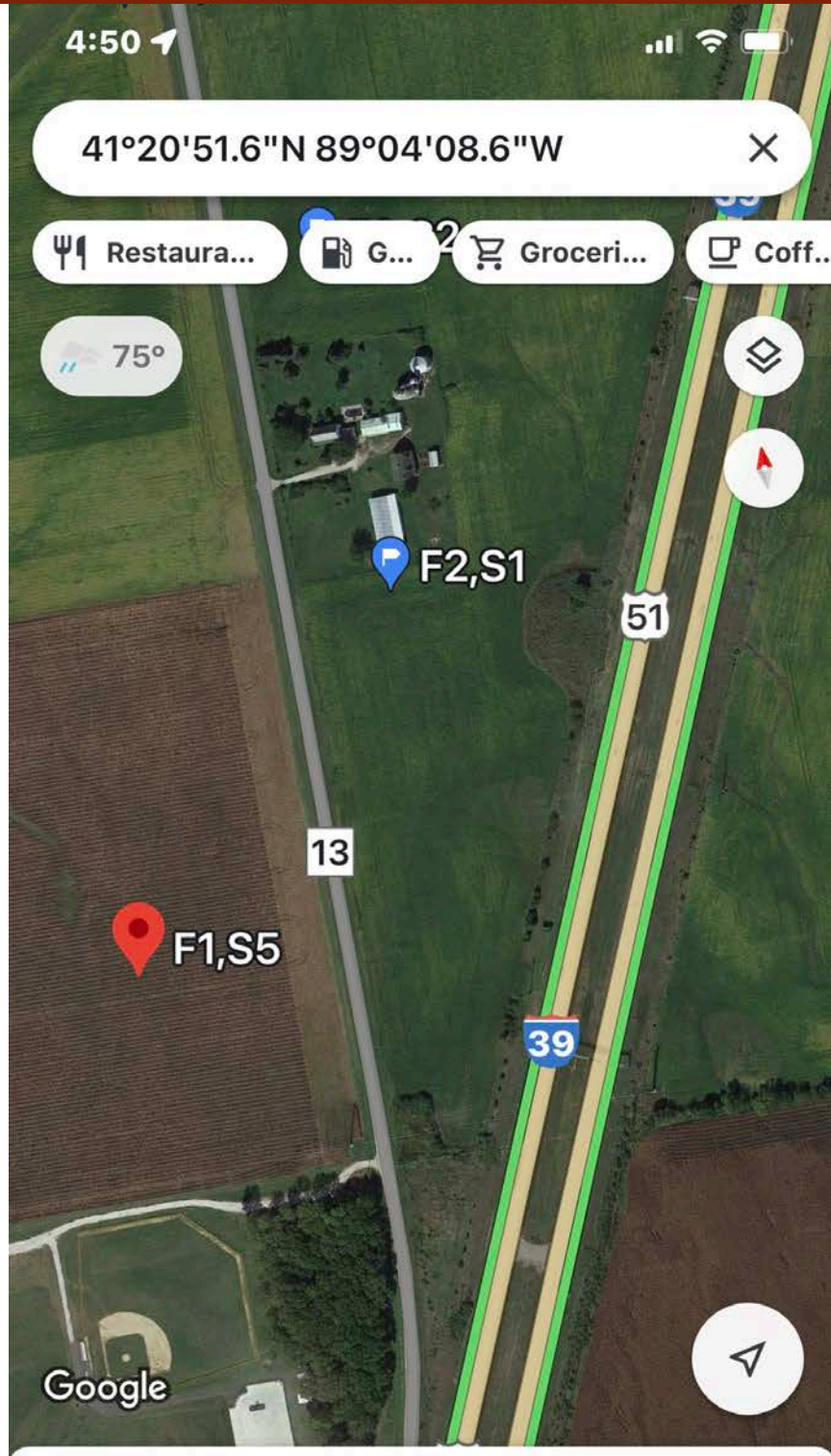

F1,S5

41.347669, -89.069053

🚗 8 min

- [Directio...](#)
- [St...](#)
- [Sa...](#)
- [E](#)

SOIL REPORT - PARCEL 2

Knaff Farms LAND 1 of 2
2878 East 5th Road | La Salle, IL 61301



108 South Crystal Lane · PO Box 226
Fairbury, IL 61739
Ph: (815) 692-2626 · Fx: (815) 692-4483

Follow us!   @UnitedSoilsInc



Location: **Grainco Fs, Inc. Mendota**
Grower: **Mark Knaff**
Farm:
Field: **2**
Test Packages: **S1**

Workorder #: **N/A**
Lab Batch ID: **22-006109**
Alternate ID: **N/A**
Order Date: **2022-08-22**
Test Date: **2022-08-25**

Soil Nutrient Results

Sample	pH	pHb	P lbs/ac	K lbs/ac	OM % Color	Ca	Mg	CEC	Base Saturation			Micro Nutrients							
									Ca	Mg	K	H	S	Zn	B	Fe	Mn	Cu	
1	7.1	--	85.2	522.6	3.4	--	--	--	--	--	--	--	--	--	--	--	--	--	--
2	6.8	--	146.1	526.7	2.9	--	--	--	--	--	--	--	--	--	--	--	--	--	--
3	5.0	--	104.5	279.5	3.3	--	--	--	--	--	--	--	--	--	--	--	--	--	--
Average	6.3	--	112.0	442.9	3.2	--	--	--	--	--	--	--	--	--	--	--	--	--	--

SOIL REPORT - PARCEL 2

Knaff Farms LAND 1 of 2
2878 East 5th Road | La Salle, IL 61301

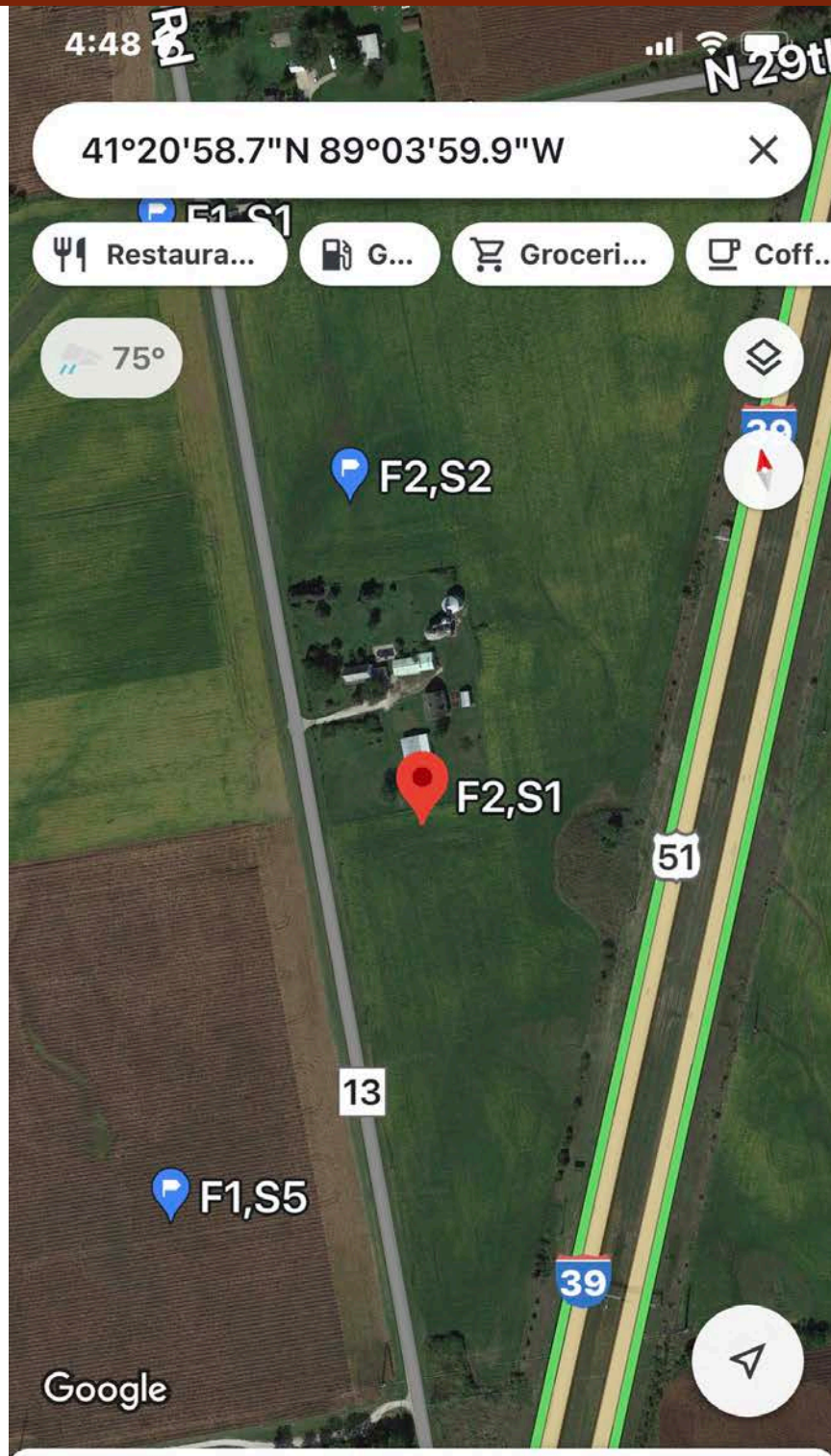

F2,S1

41.349647, -89.066632

🚗 7 min

- [Directio...](#)
- [St...](#)
- [Sa...](#)
- [E](#)

SOIL REPORT - PARCEL 2

Knaff Farms LAND 1 of 2
2878 East 5th Road | La Salle, IL 61301

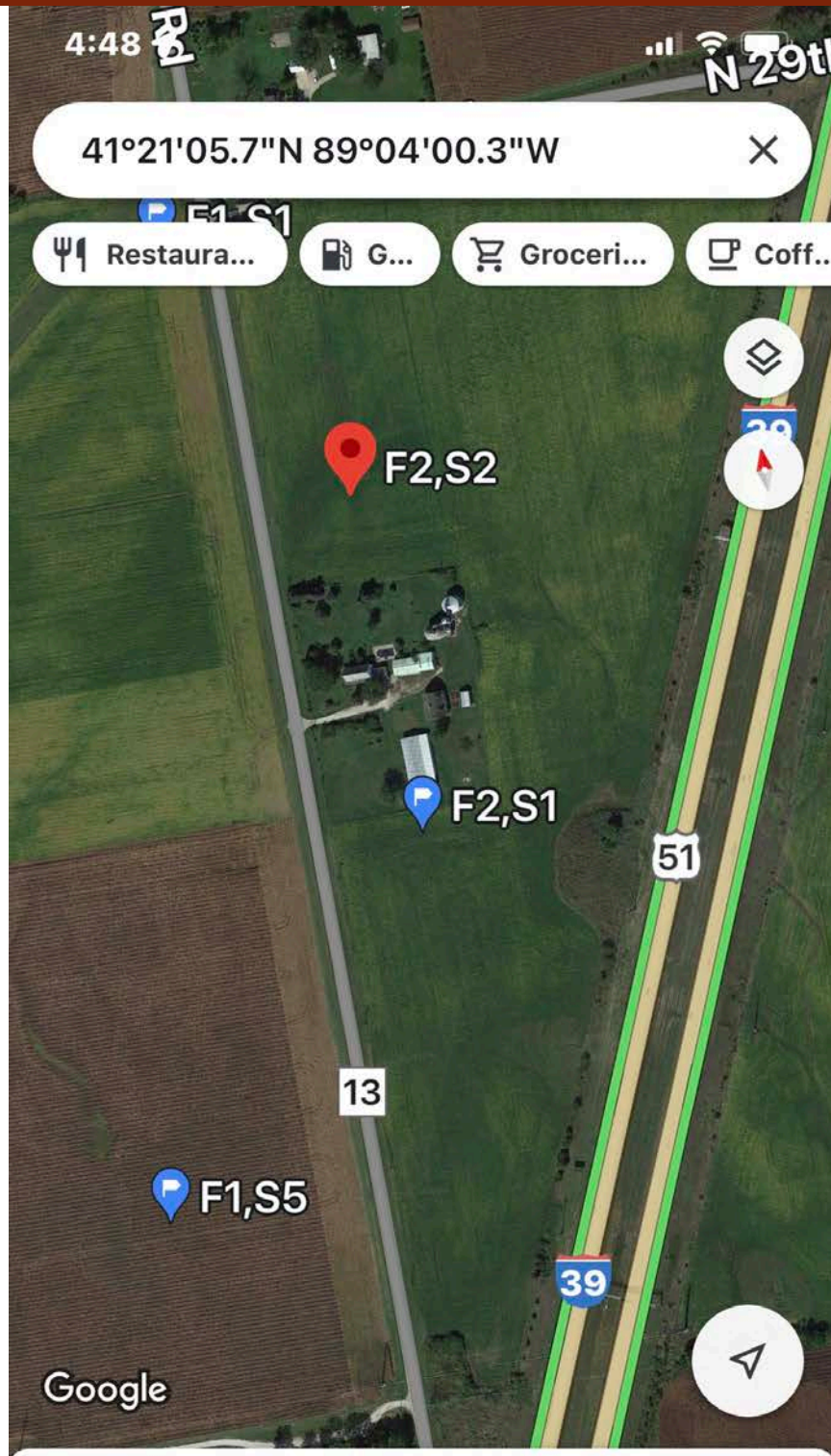

F2,S2

41.351591, -89.066746

🚗 7 min

- [Directio...](#)
- [St...](#)
- [Sa...](#)
- [E](#)

SOIL REPORT - PARCEL 2

Knaff Farms LAND 1 of 2
2878 East 5th Road | La Salle, IL 61301

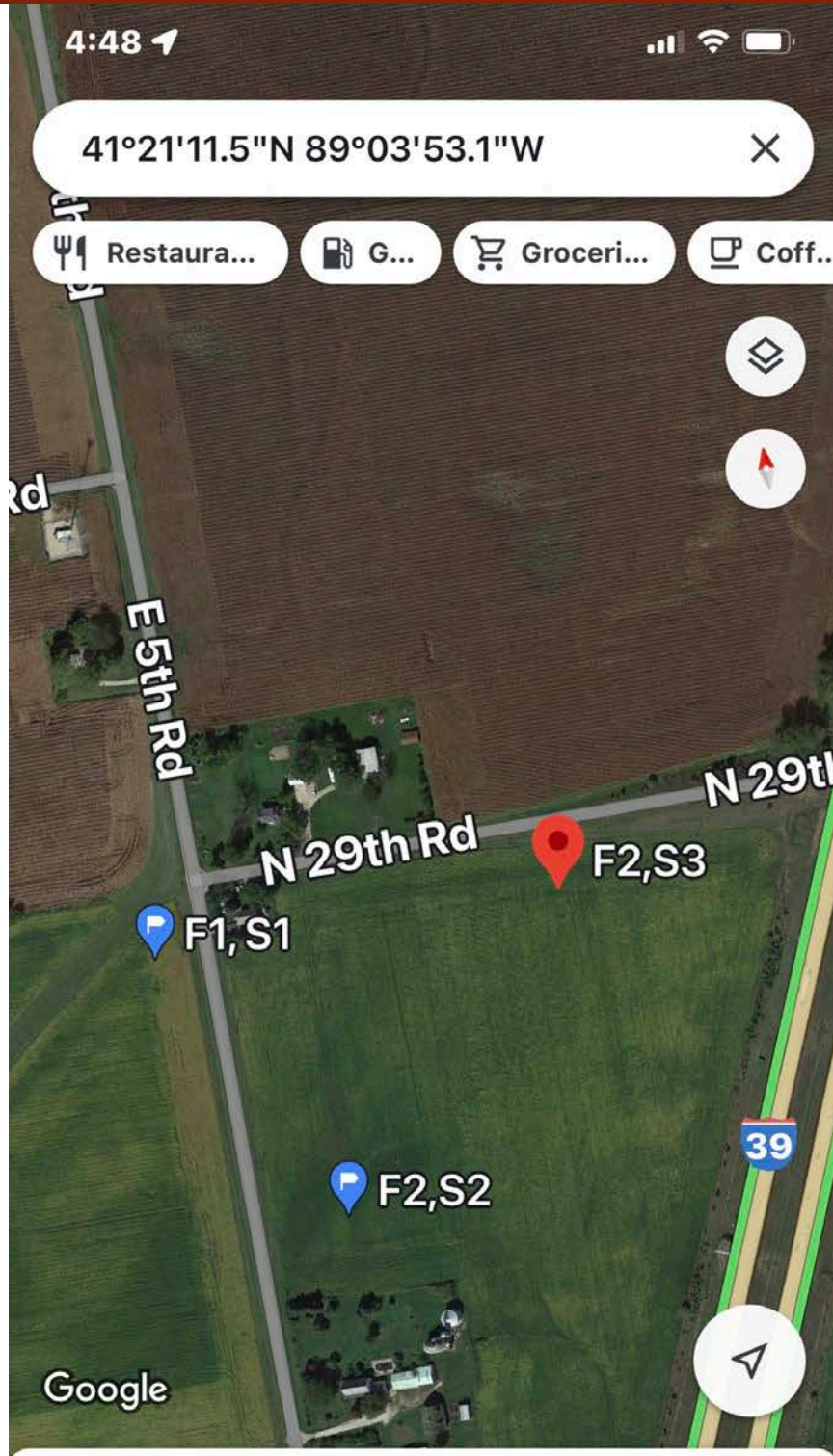

F2,S3

41.353205, -89.064744

🚗 7 min

- Directio...
- St...
- Sa...
- E

SOIL REPORT - PARCEL 3

Knaff Farms LAND 1 of 2
2878 East 5th Road | La Salle, IL 61301



108 South Crystal Lane · PO Box 226
Fairbury, IL 61739
Ph: (815) 692-2626 · Fx: (815) 692-4483

Follow us!   @UnitedSoilsInc



Location: **Grainco Fs, Inc. Mendota**
 Grower: **Mark Knaff**
 Farm: **3**
 Field: **3**
 Test Packages: **S1**

Workorder #: **N/A**
 Lab Batch ID: **22-006110**
 Alternate ID: **N/A**
 Order Date: **2022-08-22**
 Test Date: **2022-08-25**

Soil Nutrient Results

Sample	pH	pHb	P lbs/ac	K lbs/ac	OM % Color	Ca	Mg	CEC	Base Saturation			Micro Nutrients						
									Ca	Mg	K	S	Zn	B	Fe	Mn	Cu	
1	6.3	--	41.5	216.7	3.0	--	--	--	--	--	--	--	--	--	--	--	--	--
2	6.3	--	30.7	209.5	3.1	--	--	--	--	--	--	--	--	--	--	--	--	--
3	6.5	--	39.8	217.6	2.8	--	--	--	--	--	--	--	--	--	--	--	--	--
Average	6.4	--	37.3	214.6	3.0	--	--	--	--	--	--	--	--	--	--	--	--	--

SOIL REPORT - PARCEL 3

Knaff Farms LAND 1 of 2
2878 East 5th Road | La Salle, IL 61301

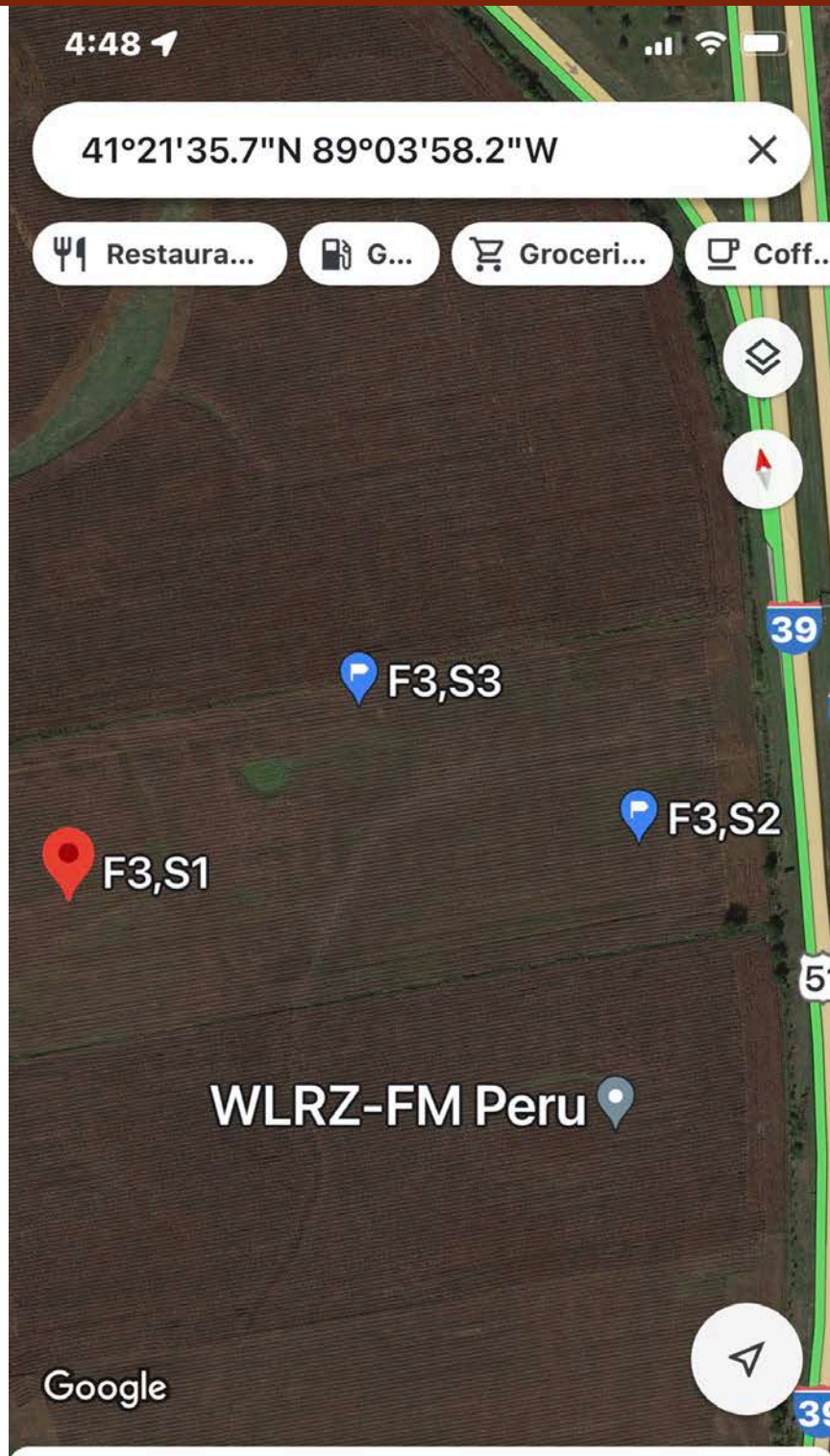

F3,S1

41.359903, -89.066163

🚗 8 min

- Directio...
- St...
- Sa...
- E

SOIL REPORT - PARCEL 3

Knaff Farms LAND 1 of 2
2878 East 5th Road | La Salle, IL 61301

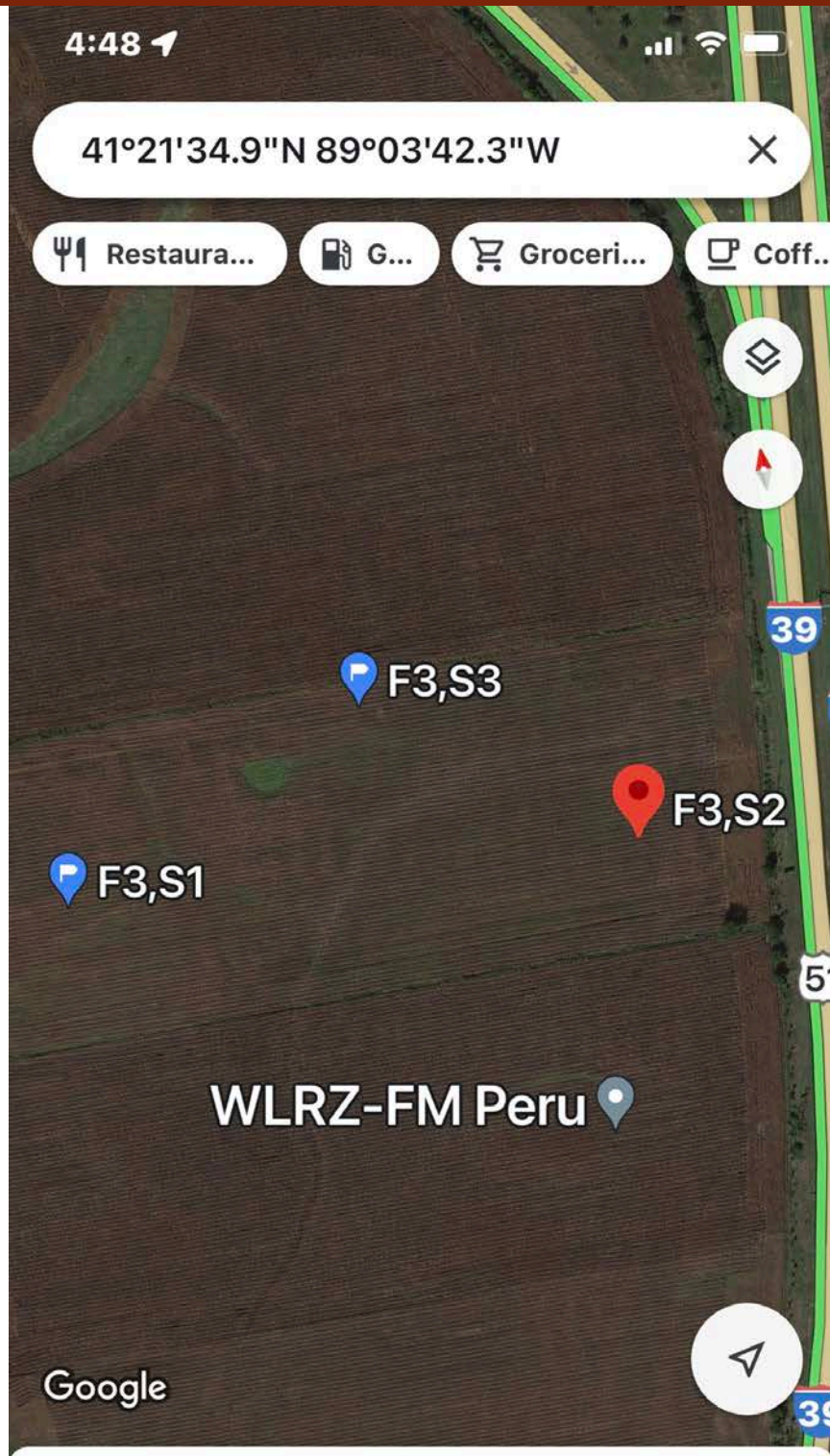

F3,S2

41.359698, -89.061756

🚗 7 min

- 📍 Directio...
- 📍 St...
- 📄 Sa...
- 🚩 E

SOIL REPORT - PARCEL 3

Knaff Farms LAND 1 of 2
2878 East 5th Road | La Salle, IL 61301



F3,S3

41.360760, -89.063699

🚗 7 min

- [Directio...](#)
- [St...](#)
- [Sa...](#)
- [E](#)

PARCEL 2 PROPERTY DISCLOSURE

Knaff Farms LAND 1 of 2
2878 East 5th Road | La Salle, IL 61301



Illinois REALTORS® RESIDENTIAL REAL PROPERTY DISCLOSURE REPORT (765 ILCS 77/35)

NOTICE: THE PURPOSE OF THIS REPORT IS TO PROVIDE PROSPECTIVE BUYERS WITH INFORMATION ABOUT MATERIAL DEFECTS IN THE RESIDENTIAL REAL PROPERTY BEFORE THE SIGNING OF A CONTRACT. THIS REPORT DOES NOT LIMIT THE PARTIES' RIGHT TO CONTRACT FOR THE SALE OF RESIDENTIAL REAL PROPERTY IN "AS IS" CONDITION. UNDER COMMON LAW, SELLERS WHO DISCLOSE MATERIAL DEFECTS MAY BE UNDER A CONTINUING OBLIGATION TO ADVISE THE PROSPECTIVE BUYERS ABOUT THE CONDITION OF THE RESIDENTIAL REAL PROPERTY EVEN AFTER THE REPORT IS DELIVERED TO THE PROSPECTIVE BUYER. COMPLETION OF THIS REPORT BY THE SELLER CREATES LEGAL OBLIGATIONS ON THE SELLER; THEREFORE SELLER MAY WISH TO CONSULT AN ATTORNEY PRIOR TO COMPLETION OF THIS REPORT.

Property Address: 2878 E 5TH RD,
City, State & Zip Code: LA SALLE, IL 61301
Seller's Name: KNAFF FARMS LLC

This Report is a disclosure of certain conditions of the residential real property listed above in compliance with the Residential Real Property Disclosure Act. This information is provided as of NOVEMBER 29, 2022. The disclosures herein shall not be deemed warranties of any kind by the seller or any person representing any party in this transaction.

In this form, "aware" means to have actual notice or actual knowledge without any specific investigation or inquiry. In this form, a "material defect" means a condition that would have a substantial adverse effect on the value of the residential real property or that would significantly impair the health or safety of future occupants of the residential real property unless the seller reasonably believes that the condition has been corrected.

The seller discloses the following information with the knowledge that even though the statements herein are not deemed to be warranties, prospective buyers may choose to rely on this information in deciding whether or not and on what terms to purchase the residential real property.

The seller represents that to the best of his or her actual knowledge, the following statements have been accurately noted as "yes" (correct), "no" (incorrect), or "not applicable" to the property being sold. If the seller indicates that the response to any statement, except number 1, is yes or not applicable, the seller shall provide an explanation in the additional information area of this form.

- | YES | NO | N/A | |
|-----|-------------------------------------|--------------------------|--|
| 1. | <input checked="" type="checkbox"/> | <input type="checkbox"/> | Seller has occupied the property within the last 12 months.
(If "no," please identify capacity or explain relationship to property.) |
| 2. | <input checked="" type="checkbox"/> | <input type="checkbox"/> | I currently have flood hazard insurance on the property. |
| 3. | <input checked="" type="checkbox"/> | <input type="checkbox"/> | I am aware of flooding or recurring leakage problems in the crawl space or basement. <i>(SUMMER PUMP)</i> |
| 4. | <input checked="" type="checkbox"/> | <input type="checkbox"/> | I am aware that the property is located in a floodplain. |
| 5. | <input checked="" type="checkbox"/> | <input type="checkbox"/> | I am aware of material defects in the basement or foundation (including cracks and bulges). |
| 6. | <input checked="" type="checkbox"/> | <input type="checkbox"/> | I am aware of leaks or material defects in the roof, ceilings, or chimney. |
| 7. | <input checked="" type="checkbox"/> | <input type="checkbox"/> | I am aware of material defects in the walls, windows, doors, or floors. |
| 8. | <input checked="" type="checkbox"/> | <input type="checkbox"/> | I am aware of material defects in the electrical system. |
| 9. | <input checked="" type="checkbox"/> | <input type="checkbox"/> | I am aware of material defects in the plumbing system (includes such things as water heater, sump pump, water treatment system, sprinkler system, and swimming pool). |
| 10. | <input checked="" type="checkbox"/> | <input type="checkbox"/> | I am aware of material defects in the well or well equipment. |
| 11. | <input checked="" type="checkbox"/> | <input type="checkbox"/> | I am aware of unsafe conditions in the drinking water. |
| 12. | <input checked="" type="checkbox"/> | <input type="checkbox"/> | I am aware of material defects in the heating, air conditioning, or ventilating systems. |
| 13. | <input checked="" type="checkbox"/> | <input type="checkbox"/> | I am aware of material defects in the fireplace or wood burning stove. |
| 14. | <input checked="" type="checkbox"/> | <input type="checkbox"/> | I am aware of material defects in the septic, sanitary sewer, or other disposal system. |
| 15. | <input checked="" type="checkbox"/> | <input type="checkbox"/> | I am aware of unsafe concentrations of radon on the premises. |
| 16. | <input checked="" type="checkbox"/> | <input type="checkbox"/> | I am aware of unsafe concentrations of or unsafe conditions relating to asbestos on the premises. |
| 17. | <input checked="" type="checkbox"/> | <input type="checkbox"/> | I am aware of unsafe concentrations of or unsafe conditions relating to lead paint, lead water pipes, lead plumbing pipes or lead in the soil on the premises. |
| 18. | <input checked="" type="checkbox"/> | <input type="checkbox"/> | I am aware of mine subsidence, underground pits, settlement, sliding, upheaval, or other earth stability defects on the premises. |
| 19. | <input checked="" type="checkbox"/> | <input type="checkbox"/> | I am aware of current infestations of termites or other wood boring insects. |
| 20. | <input checked="" type="checkbox"/> | <input type="checkbox"/> | I am aware of a structural defect caused by previous infestations of termites or other wood boring insects. |
| 21. | <input checked="" type="checkbox"/> | <input type="checkbox"/> | I am aware of underground fuel storage tanks on the property. |
| 22. | <input checked="" type="checkbox"/> | <input type="checkbox"/> | I am aware of boundary or lot line disputes. |
| 23. | <input checked="" type="checkbox"/> | <input type="checkbox"/> | I have received notice of violation of local, state or federal laws or regulations relating to this property, which violation has not been corrected. |
| 24. | <input checked="" type="checkbox"/> | <input type="checkbox"/> | I am aware that this property has been used for the manufacture of methamphetamine as defined in Section 10 of the Methamphetamine Control and Community Protection Act. |

PARCEL 2 PROPERTY DISCLOSURE

Knaff Farms LAND 1 of 2
2878 East 5th Road | La Salle, IL 61301

Note: These disclosures are not intended to cover the common elements of a condominium, but only the actual residential real property including limited common elements allocated to the exclusive use thereof that form an integral part of the condominium unit.

Note: These disclosures are intended to reflect the current condition of the premises and do not include previous problems, if any, that the seller reasonably believes have been corrected.

If any of the above are marked "not applicable" or "yes", please explain here or use additional pages, if necessary:

THE ROOF HAS LEAKS AROUND CHIMNEY AND EAST WALL WHERE
PORCH ROOF MEETS WALL.

Check here if additional pages used: _____

Seller certifies that seller has prepared this report and certifies that the information provided is based on the actual notice or actual knowledge of the seller without any specific investigation or inquiry on the part of the seller. The seller hereby authorizes any person representing any principal in this transaction to provide a copy of this report, and to disclose any information in the report, to any person in connection with any actual or anticipated sale of the property.

THE SELLER ACKNOWLEDGES THAT THE SELLER IS REQUIRED TO PROVIDE THIS DISCLOSURE REPORT TO THE PROSPECTIVE BUYER BEFORE THE SIGNING OF THE CONTRACT AND HAS A CONTINUING OBLIGATION, PURSUANT TO SECTION 30 OF THE RESIDENTIAL REAL PROPERTY DISCLOSURE ACT, TO SUPPLEMENT THIS DISCLOSURE PRIOR TO CLOSING.

Seller: MARK KNAFF JMK LLC MANAGER Date: 11/29/2022

Seller: _____ Date: _____

THE PROSPECTIVE BUYER IS AWARE THAT THE PARTIES MAY CHOOSE TO NEGOTIATE AN AGREEMENT FOR THE SALE OF THE PROPERTY SUBJECT TO ANY OR ALL MATERIAL DEFECTS DISCLOSED IN THIS REPORT ("AS IS"). THIS DISCLOSURE IS NOT A SUBSTITUTE FOR ANY INSPECTIONS OR WARRANTIES THAT THE PROSPECTIVE BUYER OR SELLER MAY WISH TO OBTAIN OR NEGOTIATE. THE FACT THAT THE SELLER IS NOT AWARE OF A PARTICULAR CONDITION OR PROBLEM IS NO GUARANTEE THAT IT DOES NOT EXIST. THE PROSPECTIVE BUYER IS AWARE THAT THE PROSPECTIVE BUYER MAY REQUEST AN INSPECTION OF THE PREMISES PERFORMED BY A QUALIFIED PROFESSIONAL.

Prospective Buyer: _____ Date: _____ Time: _____

Prospective Buyer: _____ Date: _____ Time: _____

A COPY OF SECTIONS 5 THROUGH 65 OF ARTICLE 2 OF THE RESIDENTIAL REAL PROPERTY DISCLOSURE ACT IS AFFIXED HERETO AND SHOULD BE REVIEWED BY PROSPECTIVE BUYER.

RESIDENTIAL REAL PROPERTY DISCLOSURE ACT

ARTICLE 2: DISCLOSURES

765 ILCS 77/5 et seq.

Section 5. Definitions: As used in this Act, unless the context otherwise requires the following terms have the meaning given in this section:

“Residential real property” means real property improved with not less than one nor more than four residential dwelling units: units in residential cooperatives; or, condominium units including the limited common elements allocated to the exclusive use thereof that form an integral part of the condominium unit. The term includes a manufactured home as defined in subdivision (53) of Section 9-102 of the Uniform Commercial Code that is real property as defined in the Conveyance and Encumbrance of Manufactured Homes as Real Property and Severance Act.

“Seller” means every person or entity who:

- (1) is a beneficiary of an Illinois land trust; or
- (2) has an interest, legal or equitable, in residential property as:
 - i. an owner;
 - ii. a beneficiary of a trust;
 - iii. a beneficiary pursuant to testate disposition, intestate succession, or a transfer on death instrument; or
 - iv. a contract purchaser or lessee of a ground lease.

“Seller” does not include a party to a transfer that is exempt under Section 15.

“Prospective buyer” means any person or entity negotiating or offering to become an owner or lessee of a ground lease of residential real property by means of a transfer for value to which this Act applies.

“Contract” means a written agreement by the seller and prospective buyer that would, subject to the satisfaction of any negotiated contingencies, require the prospective buyer to accept a transfer of the residential real property.

Section 10. Applicability. Except as provided in Section 15, this Act applies to any transfer by sale, exchange, installment land sale-contract, assignment of beneficial interest, lease with an option to purchase, ground lease or assignment of ground lease of residential real property.

Section 15. Seller Exemptions. A seller in any of the following transfers is exempt from this Act, regardless of whether a disclosure report is delivered:

- (1) Transfers pursuant to court order, including, but not limited to, transfers ordered by a probate court in administration of an estate, transfers between spouses resulting from a judgment of dissolution of marriage or legal separation, transfers pursuant to an order of possession, transfers by a trustee in bankruptcy, transfers by eminent domain and transfers resulting from a decree for specific performance.
- (2) Transfers from a mortgagor to a mortgagee by deed in lieu of foreclosure or consent judgment, transfer by judicial deed issued pursuant to a foreclosure sale to the successful bidder or the assignee of a certificate of sale, transfer by a collateral assignment of a beneficial interest of a land trust, or a transfer by a mortgagee or a successor in interest to the mortgagee’s secured position or a beneficiary under a deed in trust who has acquired the real property by deed in lieu of foreclosure, consent judgment or judicial deed issued pursuant to a foreclosure sale.
- (3) Transfers by a fiduciary in the course of the administration of a decedent’s estate, guardianship, conservatorship, or trust. As used in this paragraph, “trust” includes an Illinois land trust.
- (4) Transfers from one co-owner to one or more other co-owners.
- (5) Transfers from a decedent pursuant to testate disposition, intestate succession, or a transfer on death instrument.
- (6) Transfers made to a spouse, or to a person or persons in the lineal line of consanguinity of one or more of the sellers.
- (7) Transfers from an entity that has taken title to residential real property from a seller for the purpose of assisting in the relocation of the seller, so long as the entity makes available to all prospective buyers a copy of the disclosure report furnished to the entity by the seller.
- (8) Transfers to or from any governmental entity.
- (9) Transfers of newly constructed residential real property that has never been occupied. This does not include rehabilitation of existing residential real property.

Section 20. Disclosure Report Requirements. A seller of residential real property shall complete all items in the disclosure report described in Section 35. The seller shall deliver to the prospective buyer the written disclosure report required by this Act before the signing of a contract.

Section 25. Liability of seller.

(a) The seller is not liable for any error, inaccuracy, or omission of any information delivered pursuant to this Act if (i) the seller had no knowledge of the error, inaccuracy, or omission, (ii) the error, inaccuracy, or omission was based on a reasonable belief that a material defect or other matter not disclosed had been corrected, or (iii) the error, inaccuracy, or omission was based on information provided by a public agency or by a licensed engineer, land surveyor, structural pest control operator, or by a contractor about matters within the scope of the contractor’s occupation and the seller had no knowledge of the error, inaccuracy, or omission.

(b) The seller shall disclose material defects of which the seller has actual knowledge.

(c) The seller is not obligated by this Act to make any specific investigation or inquiry in an effort to complete the disclosure statement.

Section 30. Disclosure report supplement. If, prior to closing, any seller becomes aware of an error, inaccuracy, or omission in any prior disclosure report or supplement after delivery of that disclosure report or supplement to a prospective buyer, that seller shall supplement the prior disclosure report or supplement with a written supplemental disclosure, delivered by any method set forth in Section 50.

Section 35. Disclosure report form. . . . [omitted]

Section 40. Material defect.

(a) If a seller discloses a material defect in the Residential Real Property Disclosure Report, including a response to any statement that is answered “yes” except numbers 1 and 2, and, in violation of Section 20, it is delivered to the prospective buyer after all parties have signed a contract, the prospective buyer, within 5 business days after receipt of that report, may terminate the contract or other agreement with the return of all earnest money deposits or down payments paid by the prospective buyer in the transaction without any liability to or recourse by the seller.

(b) If a seller discloses a material defect in a supplement to this disclosure report, the prospective buyer shall not have a right to terminate unless:

(i) the material defect results from an error, inaccuracy, or omission of which the seller had actual knowledge at the time the prior disclosure was completed and signed by the seller; (ii) the material defect is not repairable prior to closing; or (iii) the material defect is repairable prior to closing, but within 5 business days after the delivery of the supplemental disclosure, the seller declines, or otherwise fails to agree in writing, to repair the material defect.

(c) The right to terminate the contract, however, shall no longer exist after the conveyance of the residential real property. For purposes of this Act the termination shall be deemed to be made when written notice of termination is delivered to at least one of the sellers by any method set forth

in Section 50, at the contact information provided by any seller or indicated in the contract or other agreement. Nothing in subsection (a) or (b) shall limit the remedies available under the contract or Section 55.

Section 45. Other Law. This Act is not intended to limit remedies or modify any obligation to disclose created by any other statute or that may exist in common law in order to avoid fraud, misrepresentation, or deceit in the transaction.

Section 50. Delivery of disclosure report. Delivery of the Residential Real Property Disclosure Report provided by this Act shall be by:

- (1) personal delivery or facsimile, email, or other electronic delivery to the prospective buyer at the contact information provided by the prospective buyer or indicated in the contract or other agreement;
- (2) depositing the report with the United States Postal Service, postage prepaid, first class mail, addressed to the prospective buyer at the address provided by the prospective buyer or indicated on the contract or other agreement; or
- (3) depositing the report with an alternative delivery service such as Federal Express or UPS, delivery charges prepaid, addressed to the prospective buyer at the address provided by the prospective buyer or indicated on the contract or other agreement.

For purposes of this Act, delivery to one prospective buyer is deemed delivery to all prospective buyers. Delivery to an authorized individual acting on behalf of a prospective buyer constitutes delivery to all prospective buyers. Delivery of the Report is effective upon receipt by the prospective buyer. Receipt may be acknowledged on the Report, in an agreement for the conveyance of the residential real property, or shown in any other verifiable manner.

Section 55. Violations and damages. If the seller fails or refuses to provide the disclosure report prior to the conveyance of the residential real property, the prospective buyer shall have the right to terminate the contract. A seller who knowingly violates or fails to perform any duty prescribed by any provision of this Act or who discloses any information on the Residential Real Property Disclosure Report that the seller knows to be false shall be liable in the amount of actual damages and court costs, and the court may award reasonable attorney's fees incurred by the prevailing party.

Section 60. Limitation of Action. No action for violation of this Act may be commenced later than one year from the earlier of the date of possession, date of occupancy or date of recording of an instrument of conveyance of the residential real property.

Section 65. Disclosure Report Form; Contents; Copy of Act. A copy of Sections 5 through 65 of Article 2 of this Act, excluding Section 35, must be printed on or as a part of the Residential Real Property Disclosure Report form.

Date provided to Buyer: 11/29/2022

Seller: *[Signature]* LLC MANAGER



ILLINOIS REALTORS®
DISCLOSURE OF INFORMATION AND ACKNOWLEDGEMENT
LEAD-BASED PAINT AND/OR LEAD-BASED PAINT HAZARDS



Lead Warning Statement

Every purchaser of any interest in residential real property on which a residential dwelling was built prior to 1978 is notified that such property may present exposure to lead from lead-based paint that may place young children at risk of developing lead poisoning. Lead poisoning in young children may produce permanent neurological damage, including learning disabilities, reduced intelligence quotient, behavioral problems, and impaired memory. Lead poisoning also poses a particular risk to pregnant women. The seller of any interest in residential real property is required to provide the buyer with any information on lead-based paint hazards from risk assessments or inspections in the seller's possession and notify the buyer of any known lead-based paint hazards. A risk assessment or inspection for possible lead-based paint hazards is recommended prior to purchase.

Property Address: 2878 E 5TH RD, LA SALLE, IL 61301

Seller's Disclosure (initial)

MS (a) Presence of lead-based paint and/or lead-based paint hazards (check one below):

Known lead-based paint and/or lead-based paint hazards are present in the housing (explain):

Seller has no knowledge of lead-based paint and/or lead-based paint hazards in the housing.

MS (b) Records and Reports available to the seller (check one below):

Seller has provided the purchaser with all available records and reports pertaining to lead-based paint and/or lead-based paint hazards in the housing (list documents below): _____

Seller has no reports or records pertaining to lead-based paint and/or lead-based paint hazards in the housing.

Purchaser's Acknowledgment (initial)

_____ (c) Purchaser has received copies of all information listed above.

_____ (d) Purchaser has received the pamphlet *Protect Your Family From Lead in Your Home*.

_____ (e) Purchaser has (check one below):

Received a 10-day opportunity (or mutually agreed upon period) to conduct a risk assessment or inspection of the presence of lead-based paint or lead-based paint hazards; or

Waived the opportunity to conduct a risk assessment or inspection for the presence of lead-based paint and/or lead-based paint hazards.

Agent's Acknowledgment (initial)

DS (f) Agent has informed the seller of the seller's obligations under 42 U.S.C. 4852d and is aware of his/her responsibility to ensure compliance.

Certification of Accuracy

The following parties have reviewed the information above and certify to the best of their knowledge, that the information they have provided is true and accurate.

Seller: KNAFF FARMS LLC MANAGER Date 11/29/2022 Purchaser _____ Date _____

Seller _____ Date _____ Purchaser _____ Date _____

Agent: DS Date NOV. 29, 2022 Agent _____ Date _____

(This disclosure form should be attached to the Contract to Purchase.)
FORM 420 (05/2021) COPYRIGHT ILLINOIS REALTORS®



ILLINOIS REALTORS®
DISCLOSURE OF INFORMATION ON RADON HAZARDS
(For Residential Real Property Sales or Purchases)



Radon Warning Statement

Every buyer of any interest in residential real property is notified that the property may present exposure to dangerous levels of indoor radon gas that may place the occupants at risk of developing radon-induced lung cancer. Radon, a Class-A human carcinogen, is the leading cause of lung cancer in non-smokers and the second leading cause overall. The seller of any interest in residential real property is required to provide the buyer with any information on radon test results of the dwelling showing elevated levels of radon in the seller's possession.

The Illinois Emergency Management Agency (IEMA) strongly recommends ALL homebuyers have an indoor radon test performed prior to purchase or taking occupancy, and mitigated if elevated levels are found. Elevated radon concentrations can easily be reduced by a qualified, licensed radon mitigator.

Seller's Disclosure (initial each of the following which applies)

- _____ (a) Elevated radon concentrations (above EPA or IEMA recommended Radon Action Level) are known to be present within the dwelling. (Explain).
- _____ (b) Seller has provided the purchaser with the most current records and reports pertaining to elevated radon concentrations within the dwelling.
- _____ (c) Seller either has no knowledge of elevated radon concentrations in the dwelling or prior elevated radon concentrations have been mitigated or remediated.
- MS (d) Seller has no records or reports pertaining to elevated radon concentrations within the dwelling.

Purchaser's Acknowledgment (initial each of the following which applies)

- _____ (e) Purchaser has received copies of all information listed above.
- _____ (f) Purchaser has received the IEMA approved Radon Disclosure Pamphlet.

Agent's Acknowledgement (initial IF APPLICABLE)

- D.S. (g) Agent has informed the seller of the seller's obligations under Illinois law.

Certification of Accuracy

The following parties have reviewed the information above and each party certifies, to the best of his or her knowledge, that the information he or she has provided is true and accurate.

KNAFF FARMS LLC
 Seller *[Signature]* MANAGER Date 11/29/22

Seller _____ Date _____

Purchaser _____ Date _____

Purchaser _____ Date _____

Agent *[Signature]* Date Nov, 29, 2022

Agent _____ Date _____

Property Address: 2878 E 5TH RD
LA SALLE, IL 61301

City, State, Zip Code: _____