

Pipe key

- .820/.930 .055 Wall Poly Tubing
- 2" Class 125 IPS SW PVC Pipe
- 3" Class 100 IPS SW PVC Pipe
- 4" Class 100 IPS SW PVC Pipe
- 5" Class 100 IPS SW PVC Pipe
- 6" Class 100 IPS SW PVC Pipe
- 8" Class 100 IPS SW PVC Pipe
- 10" Class 100 IPS SW PVC Pipe

Sprinkler / Valve key

- ◇ 2" Flush-out w/ 2" Air Vent
- 2" Ball Valve & Cam-loc Assembly
- Rainbird Micro-Quick w/ QN-17 (Green) Nozzle

BLOCK A

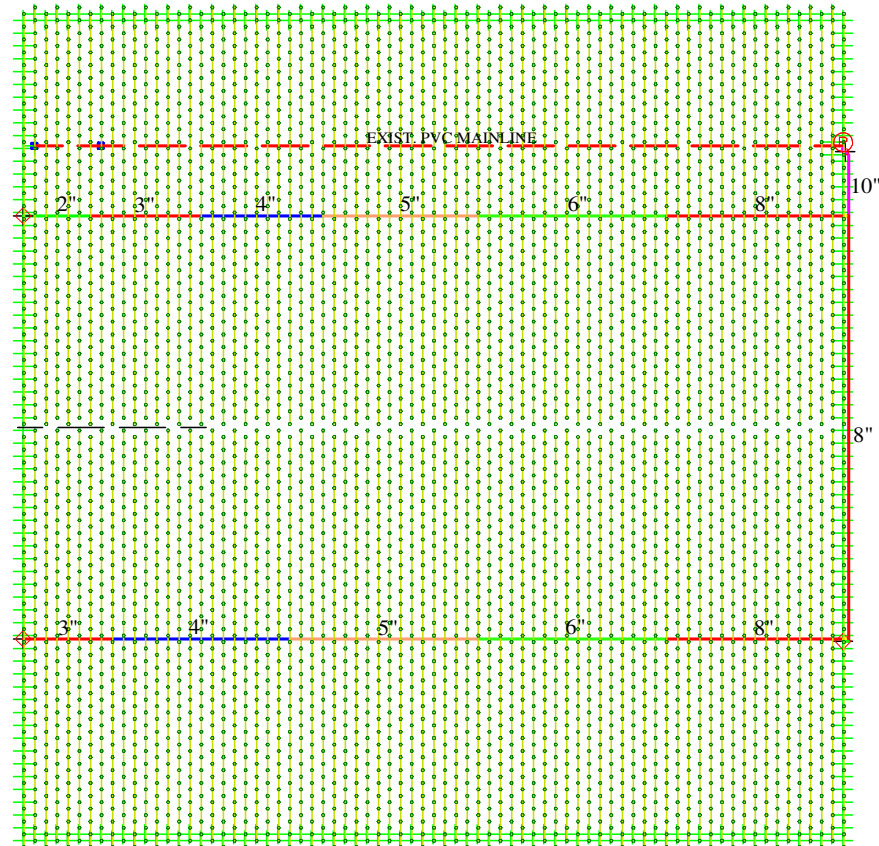

PUMP A
80 HP GEARHEAD PUMP
& 10" SPIN-CLEAN FILTER
(1436 GPM)

NOTES

- 1) 147 ACRES ALMONDS PLANTED 20' X 17.32' (20' DIAMOND) W/ HARVEST DIRECTION NORTH & SOUTH
- 2) MICRO SYETSM W/ 20MM (.820 I.D.) TUBING ON THE SURFACE & UNDERGROUND PVC MAINLINES & SUBMAINS
- 3) RAINBIRD MICRO-QUICK JET W/ QN-17 (GREEN) NOZZLE SPACED 1 PER TREE
AVERAGE OPERATING PRESSURE - 22 PSI
AVERAGE FLOW PER JET - 17.4 GPH
- 4) AVERAGE APPLICATION RATE: 17.4 GPH PER TREE, 36.5 GPM PER ACRE
TO MEET NET DAILY REQUIREMENT OF 60.9 GALLONS PER TREE IN 3.5 HRS. PER BLOCK
- 5) TOTAL JETS / FLOW:
BLOCK A - 4950 = 1436 GPM
BLOCK B - 3801 = 1102 GPM
BLOCK C - 3100 = 899 GPM
BLOCK D - 3144 = 912 GPM
BLOCK E - 3795 = 1101 GPM
TOTAL - 18,790 JETS = 5450 GPM

593 - 3/4" PVC FLEX RISERS
W/ 25 PSI HIGH-FLOW REGULATORS

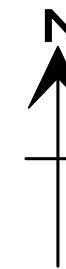

PUMP C
40 HP ELECTRIC PUMP
& 8" SPIN-CLEAN FILTER
(899 GPM)

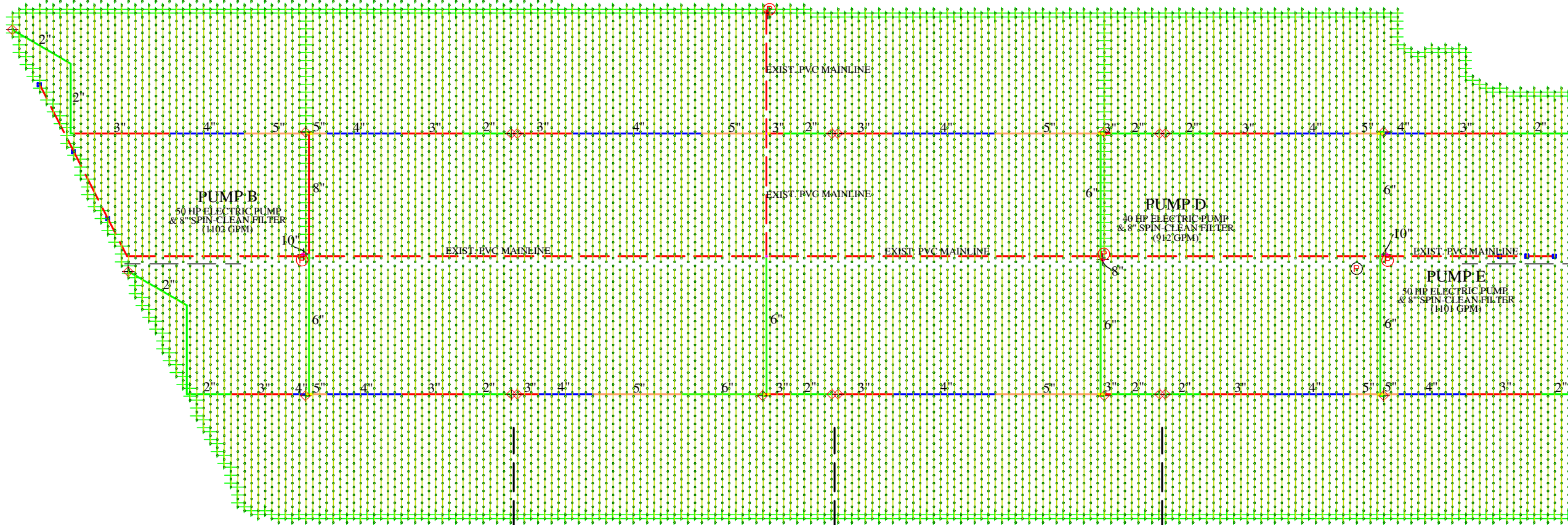

PUMP B
50 HP ELECTRIC PUMP
& 8" SPIN-CLEAN FILTER
(1402 GPM)

PUMP D
40 HP ELECTRIC PUMP
& 8" SPIN-CLEAN FILTER
(912 GPM)

PUMP E
50 HP ELECTRIC PUMP
& 8" SPIN-CLEAN FILTER
(1101 GPM)

BLOCK B

BLOCK C

BLOCK D

BLOCK E