

LINE	BEARING	DISTANCE
L1	N 29°52'52\"	E 34.04'
L2	N 06°12'59\"	E 39.48'
L3	N 07°43'11\"	W 63.22'
L4	N 15°39'34\"	W 87.13'
L5	N 22°51'30\"	W 358.80'
L6	N 06°55'29\"	W 87.96'
L7	N 28°49'22\"	E 53.16'
L8	N 45°27'18\"	E 208.89'
L9	N 46°16'12\"	E 35.54'
L10	N 46°14'22\"	E 43.98'

CURVE	ARC LENGTH	RADIUS	IDEALIA ANGLE	CHORD BEARING	CHORD LENGTH
C1	139.41'	486.22'	16°25'38\"	N 49°41'45\"	W 138.93'

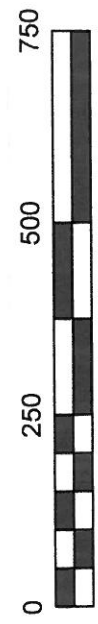
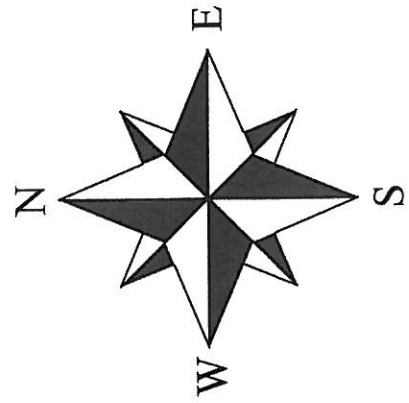

BASIS OF BEARING
 GRID NORTH
 NAD83 NORTH ZONE
 PER GPS OBSERVATION
 SCALE FACTOR GRID TO GROUND: 1.000034466
 CONVERGENCE ANGLE: -00° 27' 01\"
 DISTANCES SHOWN ARE GROUND DISTANCES

SURVEY IS SUBJECT TO ANY
 WRITTEN AND/OR UNWRITTEN
 EASEMENTS, RESTRICTIONS,
 AND/OR AGREEMENTS

- LEGEND**
- SET 1/2" REBAR W/ID CAP #1786
 - ◇ EXISTING 1/2" REBAR W/ID CAP #1786
 - EXISTING MONUMENT AS NOTED
 - - - CENTERLINE EXISTING ROAD
 - SUBJECT TRACT

LAND DESCRIPTION
 PART OF THE SOUTHWEST QUARTER OF THE NORTHEAST QUARTER (SW4 NE4) AND PART SOUTHEAST QUARTER OF THE NORTHWEST QUARTER (SE4 NW4) OF SECTION ELEVEN (11), TOWNSHIP NINETEEN (19) NORTH, RANGE SEVENTEEN (17) WEST OF THE FIFTH PRINCIPAL MERIDIAN, MARION COUNTY, ARKANSAS AND BEING MORE PARTICULARLY DESCRIBED AS FOLLOWS:
 COMMENCING AT A FIFTEEN INCH RED OAK TREE BLAZED ON FOUR SIDES MARKING THE NORTHEAST CORNER OF THE SW4 NE4 OF SAID SECTION 11, SAID POINT ALSO BEING THE POINT OF BEGINNING OF THE TRACT BEING DESCRIBED; SOUTH 01° 02' 22" EAST (BEARINGS BASED ON GRID NORTH NAD 83), (CROSSING AN EXISTING ONE-HALF INCH REBAR WITH ID CAP #1786 AT 750.32 FEET AND AT 1370.65 FEET) 1410.32 FEET (DISTANCES ARE GROUND DISTANCE) TO THE COMPUTED SOUTHEAST CORNER OF SAID SW4 NE4, THENCE ALONG THE SOUTH LINE OF SAID SW4 NE4 NORTH 86° 38' 39" WEST, (CROSSING A SET ONE-HALF INCH REBAR WITH ID CAP #1786 AT 174.39 FEET AND AT 160.68 FEET) 1238.08 FEET TO A POINT IN THE CENTERLINE OF STATE HIGHWAY #14, SAID POINT ALSO BEING ON THE ARC OF A CURVE CONCAVE TO THE NORTHEAST WITH A RADIUS OF 486.22 FEET AND A CHORD BEARING AND DISTANCE OF NORTH 49° 41' 45" WEST, 138.93 FEET; THENCE LEAVING SAID SOUTH LINE AND ALONG SAID CENTERLINE AND THE ARC OF SAID CURVE 139.41 FEET TO A POINT; THENCE CONTINUING ALONG SAID CENTERLINE NORTH 41° 28' 56" WEST, 566.20 FEET TO A POINT AT THE INTERSECTION WITH THE CENTERLINE OF MC #8106; THENCE LEAVING SAID CENTERLINE OF STATE HIGHWAY #14 AND ALONG SAID CENTERLINE OF MC #8106 THE FOLLOWING COURSES: NORTH 29° 52' 52" EAST 34.04 FEET, NORTH 06° 12' 59" EAST 39.48 FEET, NORTH 07° 43' 11" WEST 63.22 FEET, NORTH 15° 39' 34" WEST 87.13 FEET, NORTH 22° 51' 30" WEST 358.80 FEET, NORTH 06° 55' 29" WEST 87.96 FEET, NORTH 28° 49' 22" EAST 53.16 FEET, NORTH 45° 27' 18" EAST 208.89 FEET, NORTH 46° 16' 12" EAST 35.54 FEET, (CROSSING AN EXISTING ONE-HALF INCH REBAR WITH ID CAP #1786 AT 44.83 FEET) 246.28 FEET TO AN EXISTING ONE-HALF INCH REBAR WITH ID CAP #1786 MARKING THE NORTHWEST CORNER OF SAID SW4 NE4; THENCE SOUTH 88° 22' 17" EAST, 1366.08 FEET TO THE POINT OF BEGINNING, CONTAINING 52.64 ACRES MORE OR LESS AGGREGATE, SUBJECT TO THE RIGHT OF WAYS OF STATE HIGHWAY #14 AND MC #8106.

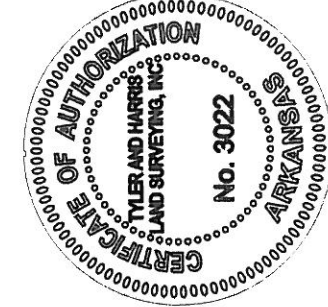
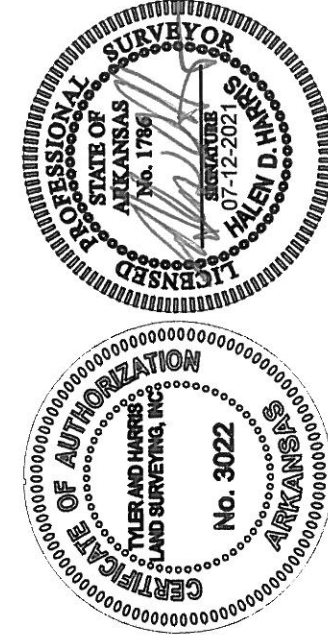

**TYLER AND HARRIS
 LAND SURVEYING, INC**
 712 NORTH HWY 65
 MARSHALL, AR 72650
 (870) 504-1099 (501) 733-1187
 atyler1099@gmail.com
 halendharris@gmail.com

SURVEYOR'S CERTIFICATION
 I, HALEN D. HARRIS, CERTIFY THE ABOVE PLATTED AND DESCRIBED PROPERTY WAS SURVEYED UNDER MY SUPERVISION, AND THE CORNERS WERE MONUMENTED AS SHOWN, TO THE BEST OF MY KNOWLEDGE AND ABILITY.

PLAT OF SURVEY
 PT. SW4 NE4 & PT. SE1/4 NW4 OF SECTION 11, T19N, R17W OF THE FIFTH PRINCIPAL MERIDIAN, MARION COUNTY, ARKANSAS.

STATE SURVEYOR'S FILE CODE NUMBER:
 500-19N-17W-0-11-400-45-1786

SURVEY FOR: Dodd Young Properties

ELECTRONIC FILE NUMBER:
 T19N/R17W/SEC11/21-233C

DATE: 07-10-2021
SCALE: 1"=250'
DRAWN BY: H. HARRIS
JOB NO: 21-233C
SHEET 1 OF 1