

Charleston, South Carolina
Office of Register Mesne Conveyance
Plat recorded this 30th day of March 1972 at
9:45 o'clock in Plat Book AA Page 74, and tracing cloth
copy filed in File 4 Drawer 3 Folder 29, Drawing
No. 13. Original plat (a white print) delivered
to Chas. County Planning Board

I, W. L. GAILLARD, a registered surveyor of the State of South
Carolina, do hereby certify that I have surveyed the property
shown hereon, that this plat shows the true dimensions of the
property, that all necessary markers have been installed, and
the precision is one: 3990

W. L. Gaillard

Arthur H. Buntin
Register Mesne Conveyance

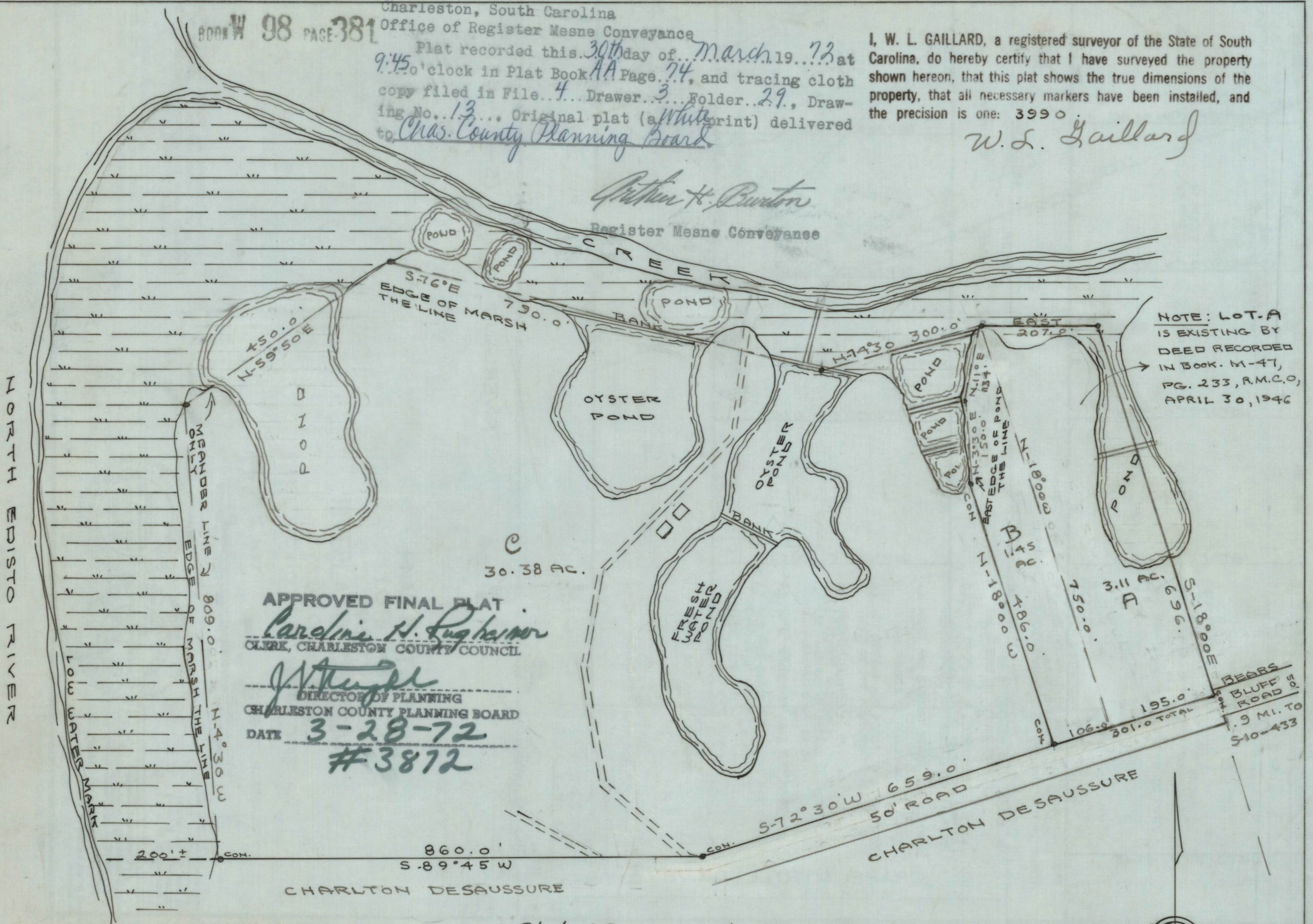

NOTE: LOT-A
IS EXISTING BY
DEED RECORDED
IN BOOK. M-47,
PG. 233, R.M.C.O.,
APRIL 30, 1946

APPROVED FINAL PLAT
Caroline H. Fugheiser
CLERK, CHARLESTON COUNTY COUNCIL
J. Stuyck
DIRECTOR OF PLANNING
CHARLESTON COUNTY PLANNING BOARD
DATE 3-28-72
#3872

Plat of Property situate
on Wadmataw Island, Charleston Co. S.C.
Lot-A owned by & Lot B about to be conveyed to -
Elsie M. Lunz
Lot-C owned by - Bears Bluff Laboratories
Surveyed January 17, 1972
By - W. L. Gaillard, L.S.# 453
Scale - 1 inch = 200 feet
Containing - 31.94 acres, total
highland, including ponds.

NOTE: LOT. B IS BEING
ADDED TO LOT A, AND IS
NOT BEING CREATED AS A
SEPARATE BUILDING LOT.

