

Cv-1
 Radius = 60.0'
 Delta = 70°44'56"
 Chord = S.13°09'58"W, 69.47'

Cv-2
 Radius = 60.0'
 Delta = 66°09'07"
 Chord = N.52°49'12"W, 65.49'

Cv-3
 Radius = 25.0'
 Delta = 70°43'57"
 Chord = N.80°48'44"W, 28.94'

WRACC, Approved, as noted 11/30/2019

SURVEY PLAT

of
LOTS 113 & 114,
WAGGENER RANCH, UNIT 3,
COMAL COUNTY, TEXAS

NOVEMBER 19, 2019

WAGGENER RANCH SUBDIVISION, UNIT THREE, IS RECORDED IN DOCUMENT NO. 200706022367, OFFICIAL PUBLIC RECORDS OF COMAL COUNTY, TEXAS

RESTRICTIVE COVENANTS ARE RECORDED IN DOCUMENT NUMBER 200906014890, 201106039303, 201206037852, 201306007462, 201606007485, 201706034228, 201806025185, OFFICIAL PUBLIC RECORDS OF COMAL COUNTY, TEXAS

PEDERNALES ELECTRIC COOP. EASEMENT RECORDED IN DOCUMENT NO. 200106003674, OFFICIAL PUBLIC RECORDS OF COMAL COUNTY, TEXAS

PEDERNALES ELECTRIC COOP. EASEMENT RECORDED

25' Exotic Game Wandering Easement From All Property Lines

I HEREBY CERTIFY THAT THIS SURVEY IS TRUE AND CORRECT TO THE BEST OF MY KNOWLEDGE AND IS BASED ON A SURVEY DONE ON THE GROUND UNDER MY DIRECTION AND SUPERVISION ON THE 19TH DAY OF NOVEMBER, 2019

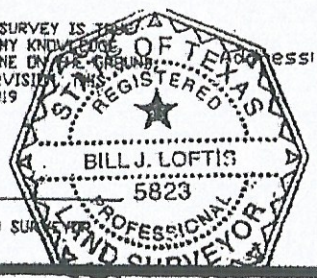

Bill J. Loftis

BILL J. LOFTIS
 REGISTERED PROFESSIONAL LAND SURVEYOR
 LICENSE NUMBER 5823

Address: Lot 113
 1017 Camanche Ridge
 Lot 114
 1023 Camanche Ridge
 New Braunfels, Texas 78132

| | | |
|--|---|--------------------|
| | Comal Hills Surveying | CHK. BY B. Loftis. |
| | 3200 Puter Creek Road Spring Branch, Texas 78070 | 191119-1 |
| | (830) 228-5571 chs@gvtc.com | Date 11/19/2019 |
| | | GF# |