

Soils Map

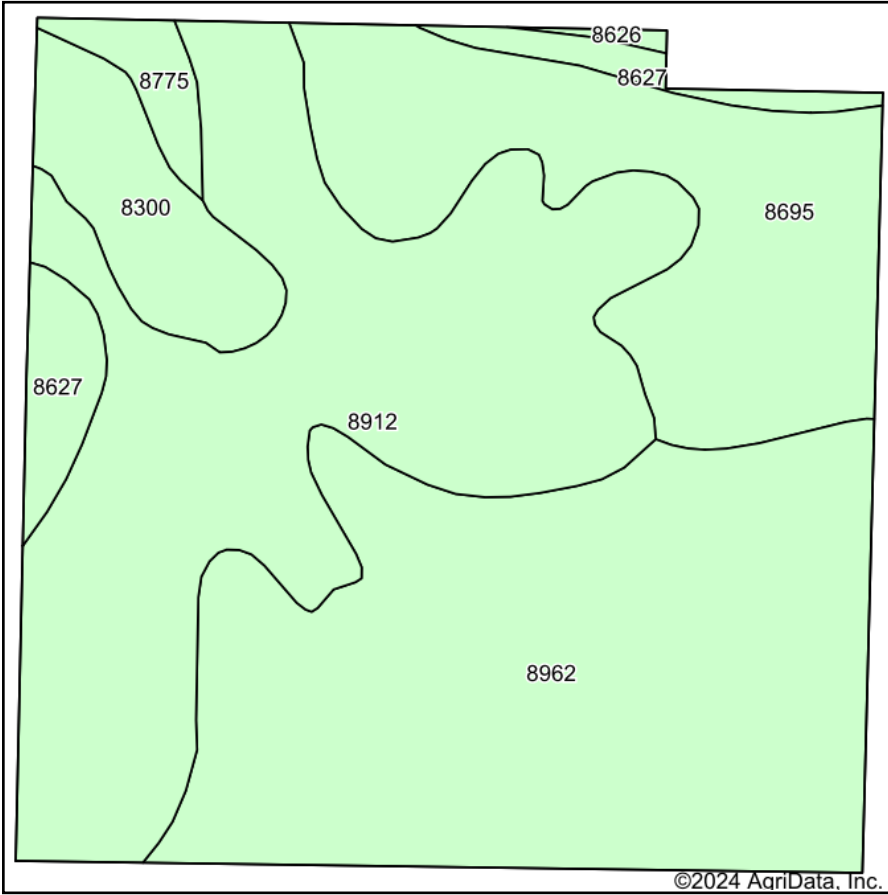

Soils data provided by USDA and NRCS.

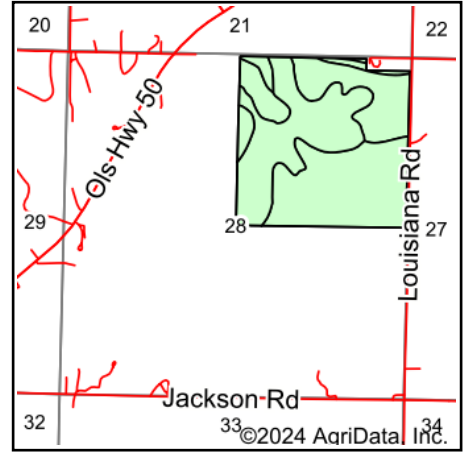

State: **Kansas**
 County: **Franklin**
 Location: **28-17S-19E**
 Township: **Lincoln**
 Acres: **155**
 Date: **3/1/2024**



Maps Provided By:



Area Symbol: KS059, Soil Area Version: 23

Code	Soil Description	Acres	Percent of field	Non-Irr Class *c	Range Production (lbs/acre/yr)	*n NCCPI Soybeans
8962	Woodson silt loam, 1 to 3 percent slopes	57.57	37.1%	IIs	4425	49
8912	Summit silty clay loam, 3 to 7 percent slopes	52.78	34.1%	IIIe	5153	58
8695	Dennis-Bates complex, 3 to 7 percent slopes	27.92	18.0%	IIIe	5500	59
8300	Verdigris silt loam, channeled, 0 to 2 percent slopes, frequently flooded	8.42	5.4%	Vw	7668	39
8627	Bates-Collinsville complex, 3 to 15 percent slopes	5.50	3.5%	VIe	4136	36
8775	Kenoma silt loam, 1 to 3 percent slopes	2.48	1.6%	IIIe	3888	59
8626	Bates-Collinsville complex, 3 to 7 percent slopes	0.33	0.2%	IVe	4257	38
Weighted Average				2.85	5023.5	*n 53

*n: The aggregation method is "Weighted Average using all components"

*c: Using Capabilities Class Dominant Condition Aggregation Method