

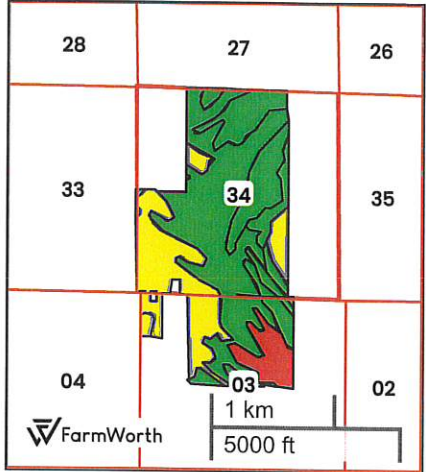

UNDEFINED FARM (567.81 AC TOTAL, 0 AC TILLABLE)

# TOTAL SOILS

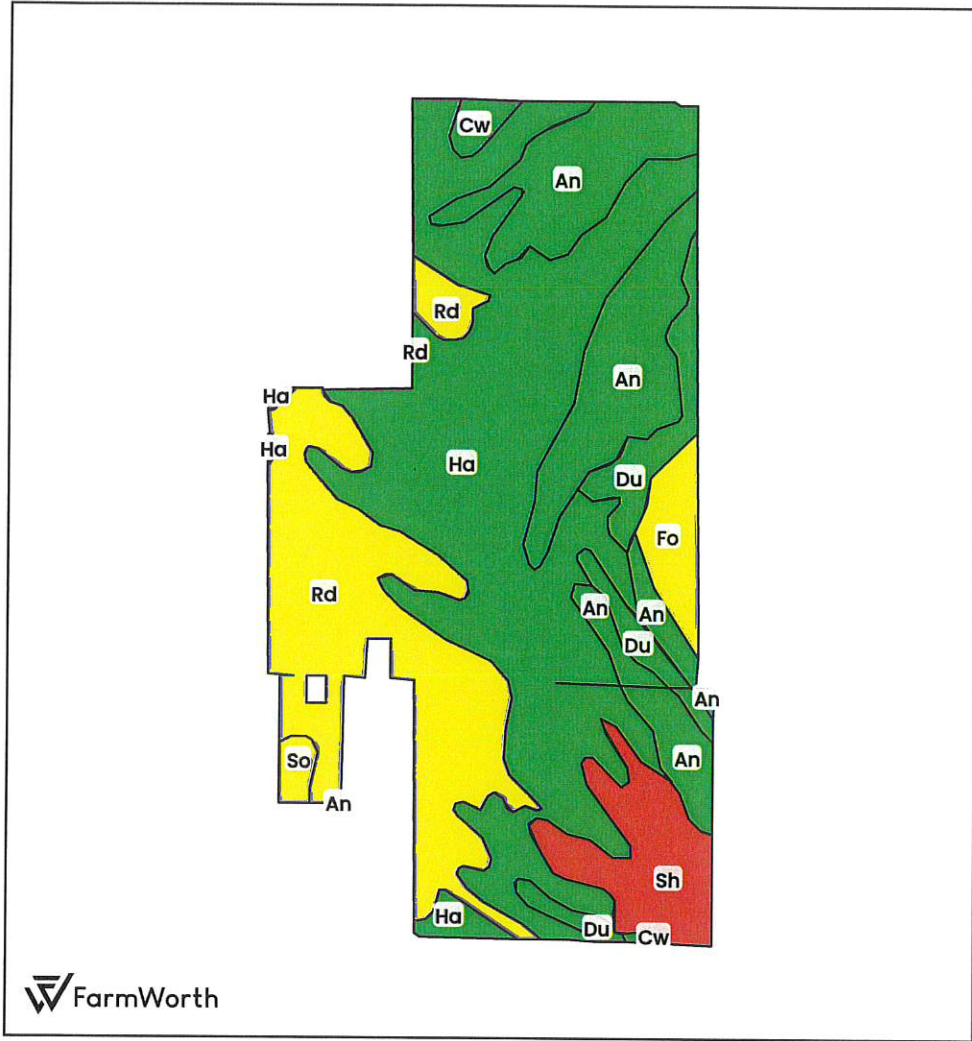

County: **Mississippi County, AR**  
 Location: **34-15N-11E**  
 Township: **Chickasawba**  
 Acres: **567.81**  
 Date: **05/03/2024**



Field borders obtained from Farm Service Agency as of 2008

FarmWorth, LLC makes no representations or warranties, express or implied, as to the accuracy of any information, data, numerical values, boundaries, or any other information generated through the use of FarmWorth.com. User is solely responsible for independently investigating and determining all information provided through FarmWorth.com prior to use and waives any and all claims against FarmWorth, LLC for any inaccuracies or inconsistencies in the information and/or data.



Code	Description	Acres	% of field	Overall NCCPI	Soil Class (Irr)	Soil Class (Non-Irr)	Drainage Class
Ha	Hayti fine sandy loam	241.99	42.62 %	74	-	3	Poorly drained
Rd	Routon-Dundee-Crevasse complex	122.26	21.53 %	65	-	3	Poorly drained
An	Amagon sandy loam	108.90	19.18 %	73	-	3	Poorly drained
Sh	Sharkey silty clay, 0 to 1 percent slopes, protected	37.74	6.65 %	29	-	4	Poorly drained
Du	Dundee silt loam, 0 to 1 percent slopes	30.20	5.32 %	82	-	2	Somewhat poorly drained
Fo	Forestdale silty clay loam	16.62	2.93 %	66	-	3	Poorly drained
Cw	Crowley silt loam	5.78	1.02 %	74	-	3	Somewhat poorly drained
So	Steele loamy sand	4.31	0.76 %	61	-	3	Moderately well drained
<b>Average:</b>				<b>69.0</b>			

Soils data provided by USDA and NRCS.