

Soils Map

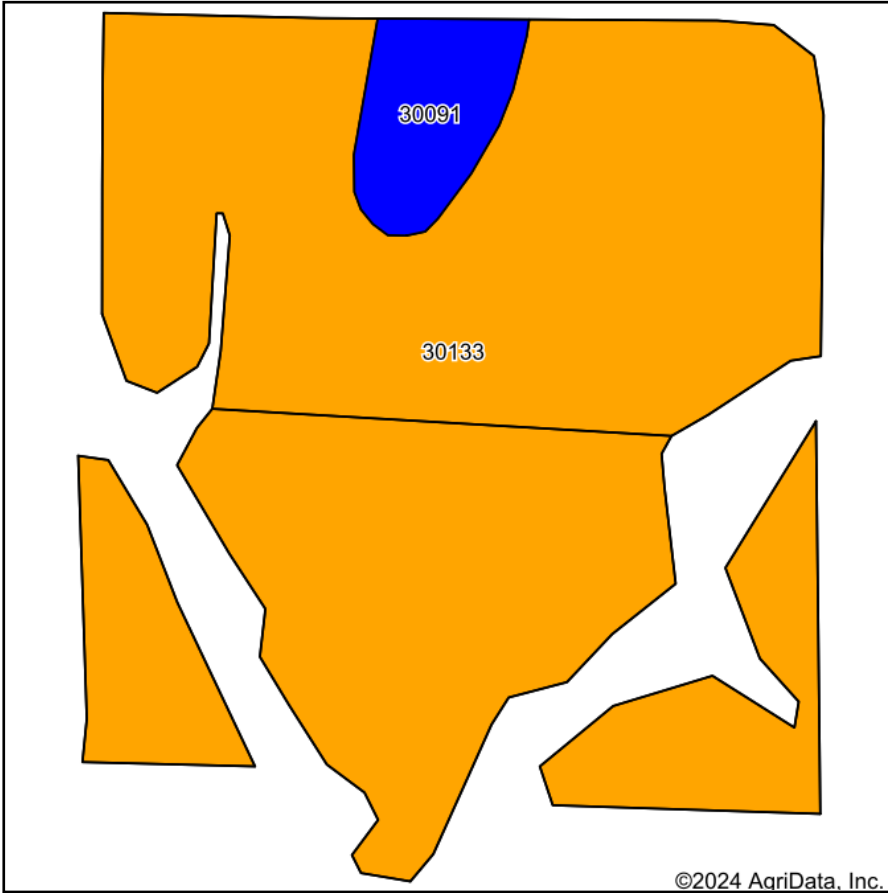

Soils data provided by USDA and NRCS.

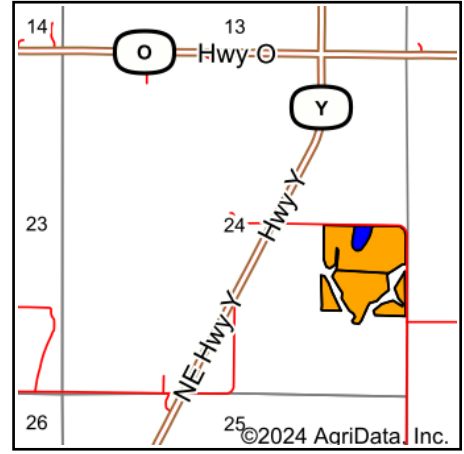

State: **Missouri**
 County: **Grundy**
 Location: **24-62N-24W**
 Township: **Lincoln**
 Acres: **34.81**
 Date: **6/11/2024**



Maps Provided By:



© AgriData, Inc. 2023

www.AgriDataInc.com



Area Symbol: MO079, Soil Area Version: 27

Code	Soil Description	Acres	Percent of field	Non-Irr Class Legend	Non-Irr Class *c	*n NCCPI Overall	*n NCCPI Corn	*n NCCPI Small Grains	*n NCCPI Soybeans	
30133	Lamoni clay loam, 5 to 9 percent slopes, eroded	32.86	94.4%		IIIe	59	59	53	47	
30091	Grundy silty clay loam, 2 to 5 percent slopes, moderately eroded	1.95	5.6%		Ile	74	74	61	65	
Weighted Average						2.94	*n 59.8	*n 59.8	*n 53.4	*n 48

*n: The aggregation method is "Weighted Average using all components"

*c: Using Capabilities Class Dominant Condition Aggregation Method