

# Soils Map

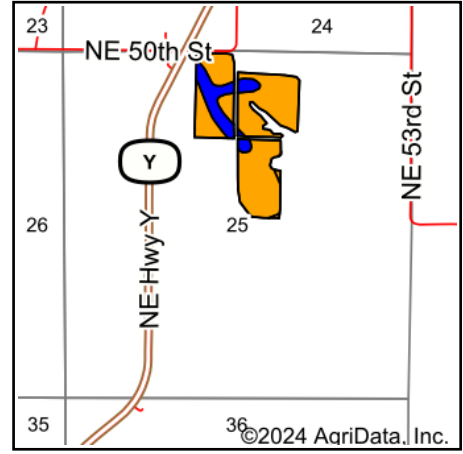

State: **Missouri**  
 County: **Grundy**  
 Location: **25-62N-24W**  
 Township: **Lincoln**  
 Acres: **52**  
 Date: **6/11/2024**

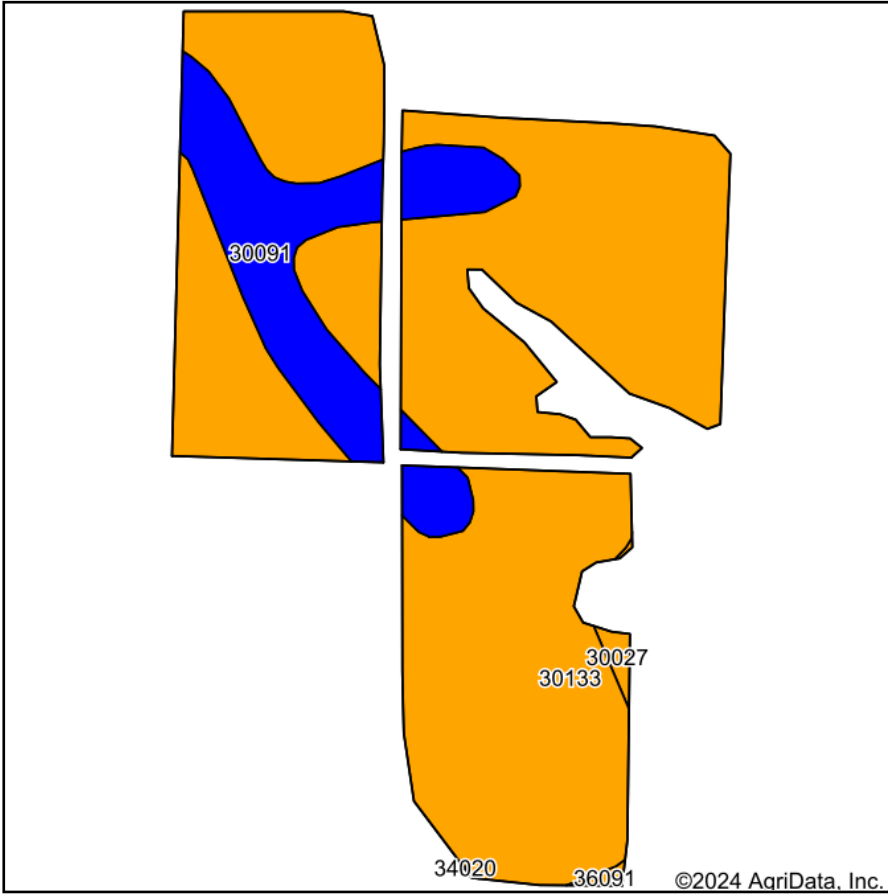

Maps Provided By:



Soils data provided by USDA and NRCS.

Area Symbol: MO079, Soil Area Version: 27

Code	Soil Description	Acres	Percent of field	Non-Irr Class Legend	Non-Irr Class *c	Common bermudagrass Tons	Orchardgrass red clover Tons	Tall fescue Tons	Warm season grasses Tons	*n NCCPI Overall	*n NCCPI Corn	*n NCCPI Small Grains	*n NCCPI Soybeans
30133	Lamoni clay loam, 5 to 9 percent slopes, eroded	43.21	83.1%		IIle					59	59	53	47
30091	Grundy silty clay loam, 2 to 5 percent slopes, moderately eroded	8.40	16.2%		Ile					74	74	61	65
30027	Armstrong clay loam, 5 to 9 percent slopes, moderately eroded	0.27	0.5%		IIle					60	60	54	41
36091	Vesser silt loam, 1 to 3 percent slopes, occasionally flooded	0.12	0.2%		IIIw	8	7	8	10	80	78	69	79
<b>Weighted Average</b>					<b>2.84</b>					<b>*n 61.5</b>	<b>*n 61.5</b>	<b>*n 54.3</b>	<b>*n 50</b>

\*n: The aggregation method is "Weighted Average using all components"

\*c: Using Capabilities Class Dominant Condition Aggregation Method

Soils data provided by USDA and NRCS.