

# Soils Map

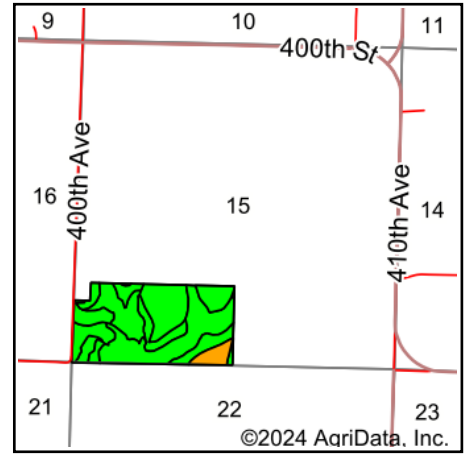

State: **Minnesota**  
 County: **Cottonwood**  
 Location: **15-105N-37W**  
 Township: **Springfield**  
 Acres: **78.15**  
 Date: **6/24/2024**

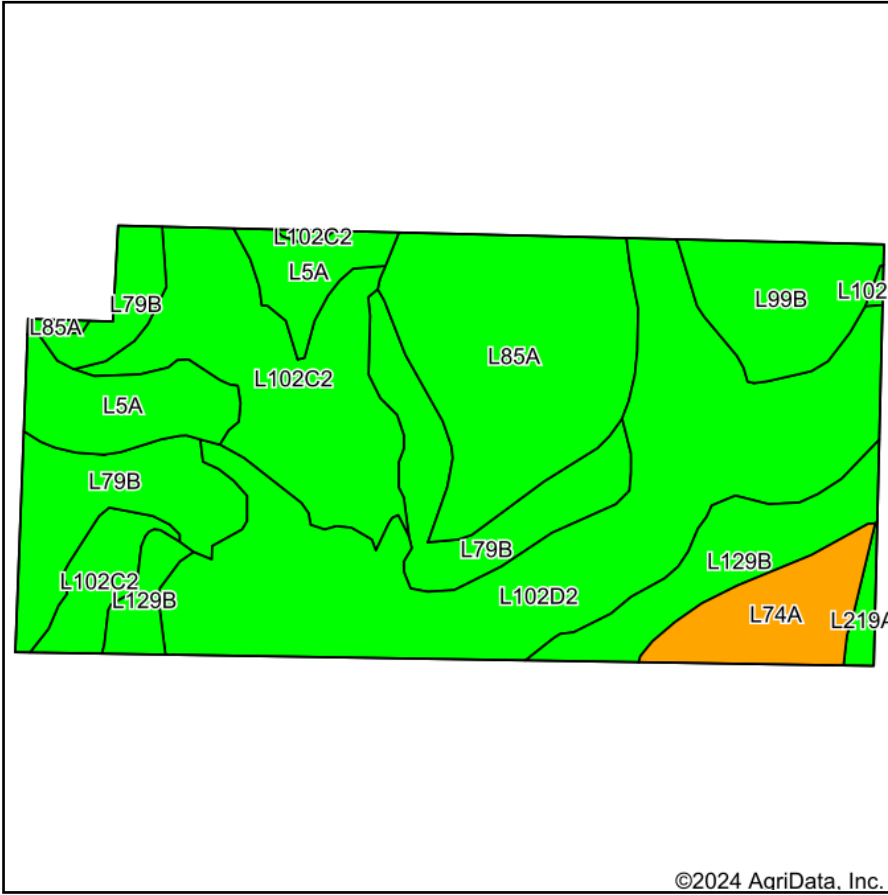

Maps Provided By:



©2024 AgriData, Inc.

Soils data provided by USDA and NRCS.

© AgriData, Inc. 2023

www.AgriDataInc.com

Area Symbol: MN033, Soil Area Version: 24

Code	Soil Description	Acres	Percent of field	PI Legend	Non-Irr Class *c	Productivity Index	*n NCCPI Overall
L102D2	Omsrud-Storden complex, 10 to 16 percent slopes, moderately eroded	22.21	28.4%		IVe	76	68
L85A	Nicollet clay loam, 1 to 3 percent slopes	12.28	15.7%		Iw	99	81
L102C2	Clarion-Storden complex, 6 to 10 percent slopes, moderately eroded	12.06	15.4%		IIIe	87	71
L79B	Clarion loam, 2 to 6 percent slopes	11.47	14.7%		Ile	95	83
L129B	Terril loam, 2 to 6 percent slopes	5.65	7.2%		Ile	99	88
L5A	Delft, overwash-Delft complex, 1 to 4 percent slopes	5.62	7.2%		IIw	96	87
L99B	Clarion-Swanlake complex, 2 to 6 percent slopes	4.51	5.8%		Ile	92	82
L74A	Estherville sandy loam, 0 to 2 percent slopes	3.81	4.9%		IIIs	44	52
L219A	Coland clay loam, 0 to 2 percent slopes, occasionally flooded	0.54	0.7%		IIw	83	83
<b>Weighted Average</b>					<b>2.61</b>	<b>86.6</b>	<b>*n 75.7</b>

\*n: The aggregation method is "Weighted Average using all components"

\*c: Using Capabilities Class Dominant Condition Aggregation Method

Soils data provided by USDA and NRCS.