

T-76-77-N

LINCOLN 'E' PLAT

(Landowners)

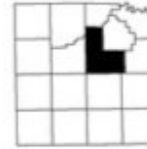

R-22-23-W

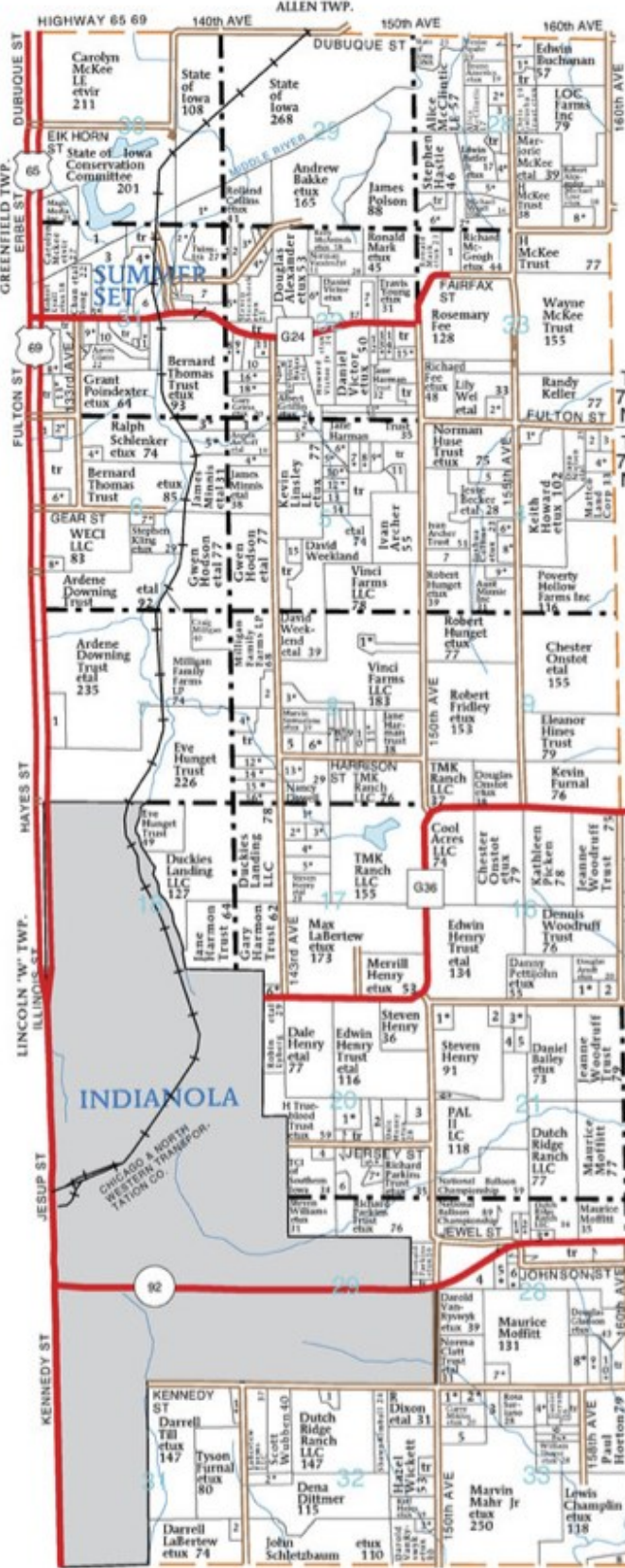

LINCOLN 'E' TOWNSHIP

SECTION 4

1. Barker, Jay etux 9
2. Hudnutt, Tony 6
3. White, Teresa 6
4. Keller, Susanna etvir 11
5. Bogart, Jerald 11
6. Marshall, Keith etux 5
7. Heston, Jean 13
8. Wieland, David etux 10
9. Watson, Joel etux 7

SECTION 5

1. Robbins, David 10
2. Kauzlarich, Cody etux 7
3. Kinter, Jeffery etux 7
4. Baker, Eric etux 7
5. Benson, Frederick etux 5
6. Steingrabe, Robert etux 5
7. Hamner, Michael etux 5
8. Logan, Lori etvir 5
9. Culbertson, Randy etux 5
10. Duff, Patrick etal 5
11. Polson, Karen 7
12. McDonough, Gary etux 5
13. Licht, Christopher 5
14. Case, Margaret 5
15. Tiefenthaler, Gerald 6

SECTION 6

1. Clear Channel Outdoor 9
2. Selgrade, Thomas etux 5
3. Robbins, David etux 10
4. Bowlin, Thomas etux 5
5. Aschoff, Angela etal 15
6. Garland, Doris etal 15

SECTION 7

1. Massman, Donald etal 6
8. Brown, Cassandra etvir 5

SECTION 8

1. Schnurbusch, Linda 18
1. Blake Trust, William etal 14
2. Hoff, Stephen 10
3. Gunderson, Timothy etal 14
4. Stueve, Nathan etal 12
5. Martin, David 9
6. Meyers LE, Lee etal 10
7. Hall, John 5
8. Loving, Michael etux 5
9. Adams, Rebecca 5
10. Hall Property LLC 10
11. Kappelman, Eber etux 8
12. Mumford, Donald etux 10
13. Walker, Gary etux 9
14. Becker, Brian etal 10
15. Brodie, Adam etux 10
16. Githens, Stephen etux 10

SECTION 13

1. Goodhue, Nolte etal 10

SECTION 14

1. Duncan, Michael etal 16

SECTION 15

1. Woodruff, Jeanne 9
2. Carlberg, Kevin 5
3. Dowell, Diane 12
4. Hickman, Richard etux 5

SECTION 16

1. Collins, Brian etux 9
2. Keeble, William 9

SECTION 17

1. Kuhn, Rodney etal 14
2. Andersen, Kirk etux 6
3. Piffer, Corey etux 8
4. Martindale Jr, John etux 13
5. Robbins, Randall etux 14
6. Linnemeyer, Brian etux 5

SECTION 18E

1. Keller, Peter etux 5

SECTION 19E

1. Walker, Lowell etux 11

SECTION 20

1. Claerhout, James etux 14
2. Schuster, Randy 9
3. Davey, Gordon 10
4. Jones, Gregory 5
5. Brewer, Eric etux 6
6. Kelly Drive Park Inc 5
7. Perry, Larry etux 5

SECTION 21

1. Henry Trust, Edwin etux 8
2. Overton, DeAnna 12
3. Jensen, Terrence etux 10
4. Price, Jerry 5
5. Lepley, Shiela 8
6. Green, Kelly etux 5

SECTION 22

1. Porter, Bruce etux 14
2. Vesey, Michael etux 15
3. Manning, Dan etux 10
4. Russell, Mike etux 10
5. McLaren, Bruce etux 10
6. Goheen, Julia etvir 9
7. Baumberger Trust, William etux 21

SUBJECT PROPERTY

OTTER TWP.

BELMONT TWP.