

# SKETCH/AREA TABLE ADDENDUM

Case No 11/24/21

File No RP001450000040A

<b>SUBJECT</b>	Property Address 28 FIFE LN			
	City SALMON	County LEMHI	State ID	Zip 83467
	Borrower COOPER, JEFF			
	Lender/Client 28 FIFE LN, SALMON	L/C Address 14		
	Appraiser Name TUNKS	Apr Address LEMHI		

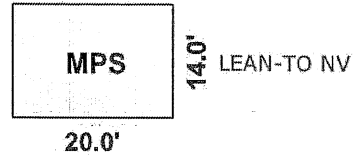
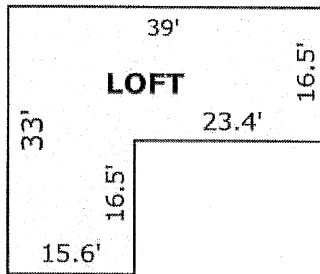

**P#21-116**  
ADDITION UNDER CONST



**P#21-116**  
DETACHED GARAGE  
UNDER CONST

Scale: 1" = 12'

### AREA CALCULATIONS SUMMARY

Code	Description	Net Size	Net Totals
GLA1	First Floor	1287.00	
	Loft Floor	900.57	2187.57
P/P	Cov Porch	312.00	
	Cov Porch	112.00	424.00
OTH	MPS	280.00	280.00

### LIVING AREA BREAKDOWN

Breakdown		Subtotals
<b>First Floor</b>		
33.0 x	39.0	1287.00
<b>Loft Floor</b>		
39.0 x	16.5	643.50
16.5 x	15.6	257.07

Net LIVABLE Area	(rounded)	2188	3 Items	(rounded)	2188
------------------	-----------	------	---------	-----------	------

IMPROVEMENTS SKETCH

AREA CALCULATIONS