

# Soils Map

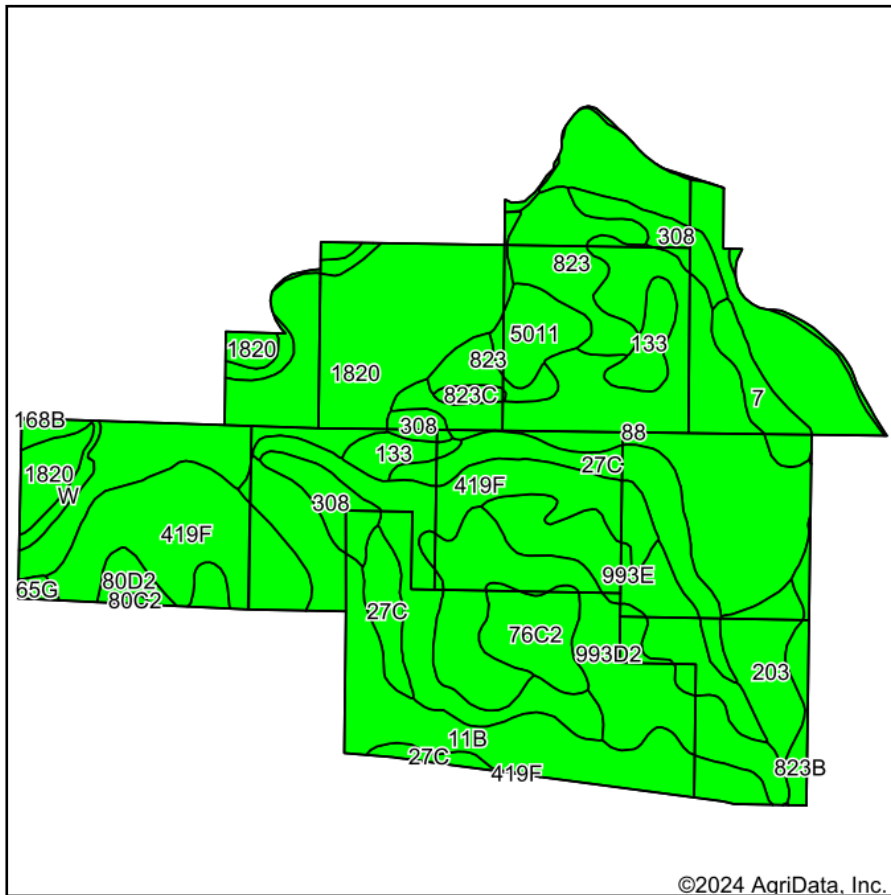

©2024 AgriData, Inc.

Soils data provided by USDA and NRCS.

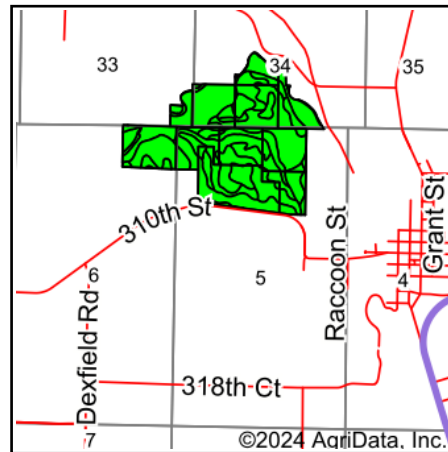

©2024 AgriData, Inc.

State: **Iowa**  
 County: **Dallas**  
 Location: **5-78N-29W**  
 Township: **Union**  
 Acres: **393.05**  
 Date: **9/30/2024**



Maps Provided By:



© AgriData, Inc. 2023

www.AgriDataInc.com



Area Symbol: IA049, Soil Area Version: 30

| Code  | Soil Description   | Acres | Percent of field | CSR2 Legend | Non-Irr Class *c | *i Corn Bu | *j Soybeans Bu | CSR2** | CSR | *n NCCPI Overall |
|-------|--|-------|------------------|-------------|------------------|------------|----------------|--------|-----|------------------|
| 1820  | Dockery-Quiver silt loams, 0 to 2 percent slopes, occasionally flooded                       | 84.99 | 21.6%            |             | IIw              |            |                | 87     |     | 93               |
| 419F  | Vanmeter silt loam, 14 to 30 percent slopes  | 55.80 | 14.2%            |             | VIIe             | 88.0       | 25.5           | 5      | 7   | 22               |
| 88    | Nevin silty clay loam, 0 to 2 percent slopes, rarely flooded                                 | 53.45 | 13.6%            |             | Iw               | 227.2      | 65.9           | 95     | 90  | 98               |
| 993D2 | Gara-Armstrong complex, 9 to 14 percent slopes, moderately eroded                            | 35.26 | 9.0%             |             | IVe              | 123.2      | 35.7           | 23     | 20  | 67               |
| 11B   | Colo, occasionally flooded-Ely silty clay loams, dissected till plain, 2 to 5 percent slopes | 34.76 | 8.8%             |             | IIw              | 204.8      | 59.4           | 80     | 68  | 87               |
| 27C   | Terril loam, 5 to 9 percent slopes   | 20.79 | 5.3%             |             | IIIe             | 208.0      | 60.3           | 85     | 67  | 91               |
| 993E  | Gara-Armstrong complex, 14 to 18 percent slopes  | 18.49 | 4.7%             |             | VIe              | 96.0       | 27.8           | 18     | 12  | 70               |
| 823   | Ridgeport sandy loam, 0 to 2 percent slopes  | 17.12 | 4.4%             |             | IIIs             | 80.0       | 23.2           | 56     | 38  | 56               |
| 308   | Wadena loam, 0 to 2 percent slopes   | 12.87 | 3.3%             |             | IIs              | 80.0       | 23.2           | 56     | 73  | 61               |
| 203   | Cylinder loam, 0 to 2 percent slopes   | 9.91  | 2.5%             |             | IIs              | 80.0       | 23.2           | 58     | 80  | 72               |
| 76C2  | Ladoga silty clay loam, dissected till plain, 5 to 9 percent slopes, eroded                  | 9.36  | 2.4%             |             | IIIe             | 192.0      | 55.7           | 75     | 62  | 76               |
| 133   | Colo silty clay loam, deep loess, 0 to 2 percent slopes, occasionally flooded                | 8.19  | 2.1%             |             | IIw              | 204.8      | 59.4           | 78     | 81  | 76               |
| 5011  | Anthroportic Udorthents, reclaimed sand and gravel pits, 0 to 9 percent slopes               | 7.27  | 1.8%             |             | IIIs             |            |                | 5      |     | 85               |
| 7     | Wiota silt loam, 1 to 3 percent slopes   | 6.21  | 1.6%             |             | I                | 233.6      | 67.7           | 95     | 90  | 97               |
| W     | Water  | 6.15  | 1.6%             |             |                  | 0.0        | 0.0            | 0      | 0   |                  |
| 80D2  | Clinton silty clay loam, 9 to 14 percent slopes, eroded                                      | 4.43  | 1.1%             |             | IIIe             | 158.4      | 45.9           | 46     | 47  | 72               |

Soils data provided by USDA and NRCS.



| Code                    | Soil Description                                       | Acres | Percent of field | CSR2 Legend | Non-Irr Class *c | *i Corn Bu | *i Soybeans Bu | CSR2**      | CSR         | *n NCCPI Overall |                |
|-------------------------|--|-------|------------------|-------------|------------------|------------|----------------|-------------|-------------|------------------|----------------|
| 823B                    | Ridgeport sandy loam, 2 to 5 percent slopes            | 4.12  | 1.0%             |             | IIIe             | 80.0       | 23.2           | 51          | 35          | 55               |                |
| 419G                    | Vanmeter silt loam, 30 to 60 percent slopes            | 1.43  | 0.4%             |             | VIIe             | 88.0       | 25.5           | 5           | 5           | 11               |                |
| 823C                    | Ridgeport sandy loam, 5 to 9 percent slopes            | 1.30  | 0.3%             |             | IIIe             | 80.0       | 23.2           | 46          | 15          | 55               |                |
| 65G                     | Lindley silt loam, 18 to 40 percent slopes             | 0.89  | 0.2%             |             | VIIe             | 96.0       | 27.8           | 5           | 6           | 19               |                |
| 80C2                    | Clinton silty clay loam, 5 to 9 percent slopes, eroded | 0.26  | 0.1%             |             | IIIe             | 187.2      | 54.3           | 69          | 57          | 74               |                |
| <b>Weighted Average</b> |  |       |                  |             |                  | <b>*-</b>  | <b>112.3</b>   | <b>32.6</b> | <b>58.9</b> | <b>*-</b>        | <b>*n 72.8</b> |

\*\*IA has updated the CSR values for each county to CSR2.

\*- CSR weighted average cannot be calculated on the current soils data, use prior data version for csr values.\*i Yield data provided by the ISPAID Database version 8.1.1 developed by IA State University.

\*n: The aggregation method is "Weighted Average using all components"

\*c: Using Capabilities Class Dominant Condition Aggregation Method

\*- Non Irr Class weighted average cannot be calculated on the current soils data due to missing data.