

WV Flood Map

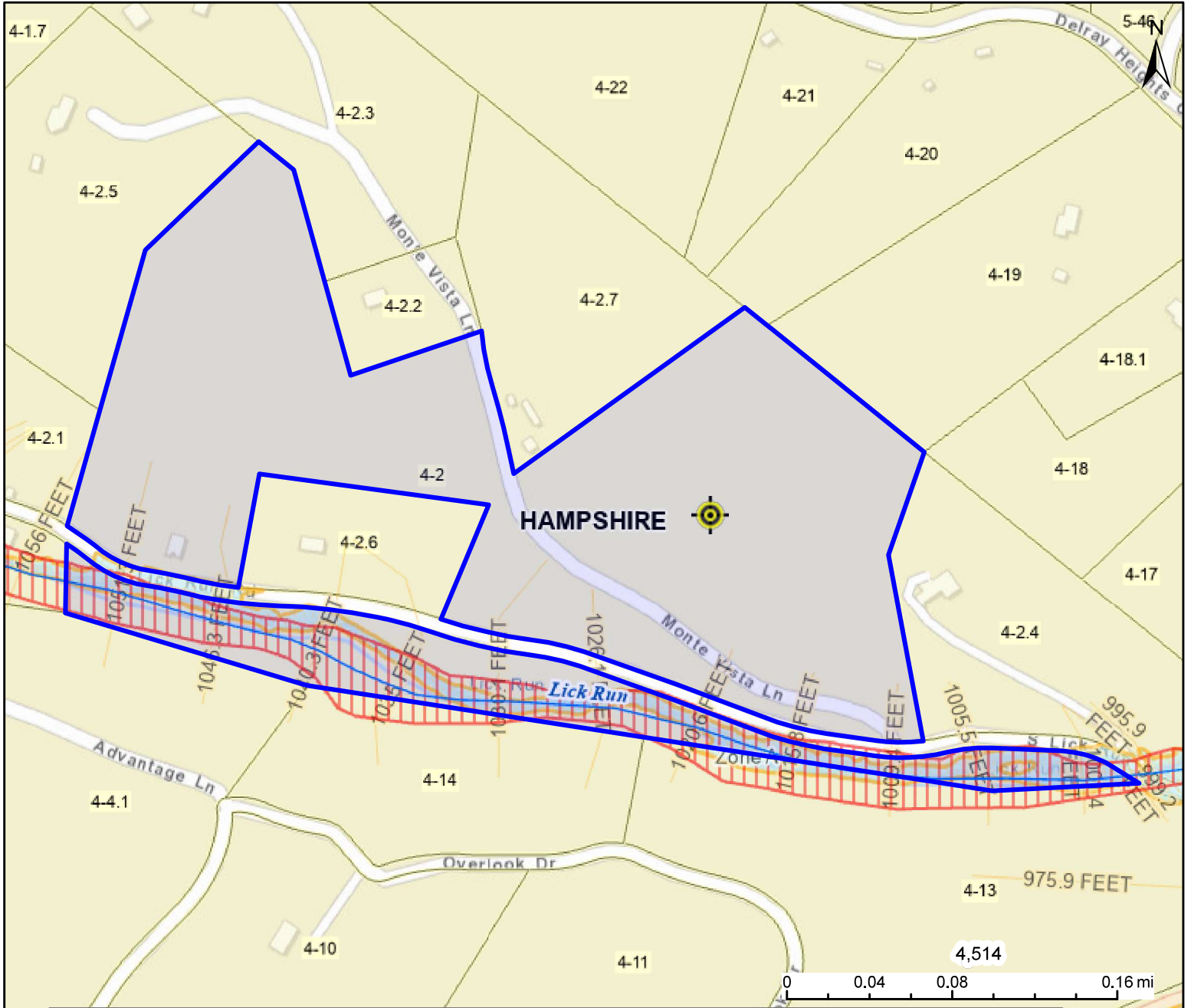

This map is not the official regulatory FIRM or DFIRM. Its purpose is to assist with determining potential flood risk for the selected location.

Flood Info Location Map created on 10/3/2024	
User Notes	
Flood Hazard Area	Location is NOT WITHIN any identified flood hazard area. Unmapped flood hazard areas may be present.
Flood Zone	Out of Flood Zone
Stream	
Watershed (HUC8)	<n/a>
Flood Height	Flood Height 6a N/A
Water Depth	
Elevation	1083.3 ft (Source: FEMA 2016-17) (NAVD88)
Community & ID	<n/a>
FEMA Map & Date	54027C0430C; Effective Date: 11/7/2002
Location (lat, long)	(39.189676, -78.617368) (WGS84)
Parcel ID	14-09-0004-0002-0000
E-911 Address	490 S LICK RUN RD, Delray, WV, 26714

H I G H R I S K		1-Percent-Annual-Chance Flood Hazard Area With Base Flood Elevation (BFE)
		Regulatory Floodway in AE Zone
		1-Percent-Annual-Chance Flood Hazard Area Without BFE (may have Advisory Flood Heights)
		1-Percent-Annual-Chance High Risk Advisory

Download the Full Legend for all flood tool symbols
https://www.mapwv.gov/flood/map/docs/wv_flood_tool_legend.pdf

Disclaimer:
 The online map is for use in administering the National Flood Insurance Program. It does not necessarily identify all areas subject to flooding, particularly from local drainage sources of small size. Refer to the official Flood Insurance Study (FIS) for detailed flood elevation data in flood profiles and data tables. WV Flood Tool (<https://www.mapwv.gov/flood>) is supported by FEMA, WV NFIP Office, and WV GIS Technical Center.