

FORM NO. GWS-32 11/90

# PUMP INSTALLATION AND TEST REPORT

For Office Use only

STATE OF COLORADO, OFFICE OF THE STATE ENGINEER

RECEIVED

NOV 9 1993

WATER STATE

1. WELL PERMIT NUMBER 165195

2. OWNER NAME(S) F. H. MERELLI  
Mailing Address 305 Madison  
City, St. Zip Denver, CO, 80206  
Phone ( 303 ) 322-7634

3. WELL LOCATION AS DRILLED: NE 1/4 NW 1/4, Sec. 36 Twp. 6 S Range 71 W  
DISTANCES FROM SEC. LINES:  
1180 ft. from North Sec. line. and 1950 ft. from West Sec. line.  
(north or south) (east or west)  
SUBDIVISION: \_\_\_\_\_ LOT \_\_\_\_\_ BLOCK \_\_\_\_\_ FILING(UNIT) \_\_\_\_\_  
STREET ADDRESS AT WELL LOCATION: 26271 Richmond Hill Rd. Conifer, CO. 80433

4. PUMP DATA: Type Submersible Installation Completed 11-03-92  
Pump Manufacturer Fairbanks Morse Pump Model No. B10025  
Design GPM 5 at RPM 3450, HP 1, Volts 230, Full Load Amps 8  
Pump Intake Depth 450 Feet, Drop/Column Pipe Size 1 Inches, Kind C-80  
ADDITIONAL INFORMATION FOR PUMPS GREATER THAN 50 GPM:  
TURBINE DRIVER TYPE:  Electric  Engine  Other \_\_\_\_\_  
Design Head \_\_\_\_\_ feet, Number of Stages \_\_\_\_\_, Shaft size \_\_\_\_\_ inches.

5. OTHER EQUIPMENT:  
Airline Installed  Yes  No, Orifice Depth ft. \_\_\_\_\_, Monitor Tube Installed  Yes  No, Depth ft. \_\_\_\_\_  
Flow Meter Mfg. \_\_\_\_\_ Meter Serial No. \_\_\_\_\_  
Meter Readout  Gallons,  Thousand Gallons;  Acre feet,  Beginning Reading \_\_\_\_\_

6. TEST DATA:  Check box if Test data is submitted on Supplemental Form.  
Date 11-03-92  
Total Well Depth 463' Time 2 hrs.  
Static Level 110' Rate (GPM) 6  
Date Measured 11-03-92 Pumping Lvl. 450'

7. DISINFECTION: Type H.T.H. Amt. Used 2 oz.

8. Water Quality analysis available.  Yes  No

9. Remarks \_\_\_\_\_  
\_\_\_\_\_  
\_\_\_\_\_  
\_\_\_\_\_

10. I have read the statements made herein and know the contents thereof, and that they are true to my knowledge. [Pursuant to Section 24-4-104 (13)(a) C.R.S., the making of false statements herein constitutes perjury in the second degree and is punishable as a class 1 misdemeanor.]

CONTRACTOR CRESSLER PUMP SERVICE Phone (303) 838-5677 Lic. No. 798  
Mailing Address P.O. BOX 1040 CONIFER, CO. 80433

Name/Title (Please type or print) RONALD CRESSLER, OWNER Signature Ronald Cressler Date 11-09-92

FORM NO. GWS-31 11/90

WELL CONSTRUCTION AND TEST REPORT STATE OF COLORADO, OFFICE OF THE STATE ENGINEER

For Office Use only

84

OCT 13 '92

WATER RESOURCES STATE ENGINEER COLO.

1. WELL PERMIT NUMBER 165195

2. OWNER NAME(S) F. H. MERELLI Mailing Address 305 Madison City, St. Zip Denver, Colorado 80206 Phone (303) 322-7634

3. WELL LOCATION AS DRILLED: NE 1/4 NW 1/4, Sec. 36 Twp. 6 S, Range 71 W DISTANCES FROM SEC. LINES: 1180 ft. from North Sec. line. and 1950 ft. from West Sec. line. OR (north or south) (east or west) SUBDIVISION: LOT BLOCK FILING(UNIT) STREET ADDRESS AT WELL LOCATION: 26271 Richmond Hill Road, Conifer, Colorado 80433

4. GROUND SURFACE ELEVATION unknown ft. DRILLING METHOD Air Percussion DATE COMPLETED October 6, 1992 TOTAL DEPTH 463 ft. DEPTH COMPLETED 463 ft.

5. GEOLOGIC LOG: Table with columns: Depth, Description of Material (Type, Size, Color, Water Location)

6. HOLE DIAM. (in.) From (ft) To (ft) Table with rows: 8-1/2 (0 to 33 1/2), 6 (33 1/2 to 463)

7. PLAIN CASING Table with columns: OD (in), Kind, Wall Size, From(ft), To(ft) Rows: 6-5/8 Steel (0.238, +1 to 33 1/2), 4-1/2 PVC (0.214, 9 to 343), 4-1/2 PVC (0.214, 443 to 463)

8. FILTER PACK: Material Size Interval

9. PACKER PLACEMENT: Type rubber shale trap Depth 143 feet

10. GROUTING RECORD: Table with columns: Material, Amount, Density, Interval, Placement Row: neat cement, 14.8, 0 - 33 1/2, Halliburton

11. DISINFECTION: Type H.T.H. Pellets & Powder Amt. Used 2 cups of each-well bailed-solution left in the well

12. WELL TEST DATA: TESTING METHOD Blown by air. Static Level 110 ft. Date/Time measured 10/6/92 10:00 A.M., Production Rate 6.67 gpm. Pumping level 463 ft. Date/Time measured 10/5/92 4:00 P.M., Test length (hrs.) 2 Hours

13. I have read the statements made herein and know the contents thereof, and that they are true to my knowledge. CONTRACTOR Ernie's Mountain Drilling, Inc. Phone (303) 526-0290 Lic. No. 1078 Mailing Address P.O. Box 357, Evergreen, Colorado 80439

Name/Title (Please type or print) Gary E. Bryning, President Signature Date 10/7/92

## INSTRUCTIONS FOR WELL CONSTRUCTION AND TEST REPORT

The report must be typed or printed in **BLACK INK**. All changes on the form must be initialed and dated. Attach additional sheets if more space is required. Each additional sheet must be identified at the top by the well owner's name, the permit number, form name/number and a sequential page number. Report depths in feet below ground surface.

This form may be reproduced by photocopy methods, or by computer generation with prior approval by the State Engineer.

The original and one copy of this form must be submitted to the State Engineer's Office within 60 days after completing the well or 7 days after the permit expiration date, whichever is earlier. Another copy of the form must be provided to the well owner.

1. Complete the **Well Permit Number** in full.
2. Fill in **Name and Mailing Address of Well Owner** where correspondence should be sent.
3. Complete the blocks for the **actual** location of the well where drilled. If the owner has more than one well serving this property, provide the identification (**Owner's Designation**) for this well. **DO NOT USE THE OWNER SUPPLIED LOCATION** unless a survey has been provided. For wells located in subdivisions the lot, block and subdivision information must also be provided.
4. Report the ground surface elevation in feet above sea level if available. This value may be obtained from a topographic map. Describe the drilling method used to construct the well and the date completed. Indicate the total depth drilled and the actual completed depth of the well.
5. Fully describe the materials encountered in drilling. Do not use formation names unless they are in conjunction with a description of materials.  
Examples of descriptive terms include:
  - Grain size**--Boulders, gravel, sand, silt, clay.
  - Hardness**--Loose, soft, tight, hard, very hard.
  - Color**--All materials. Most critical in sedimentary rock.
  - Depth** when water is encountered (if it can be determined).
6. Provide the diameters of the drilled bore hole.
7. The outside diameter, kind, wall thickness and interval of casing lengths must be indicated.
8. Indicate the type and size of filter (gravel) pack and the interval where placed.
9. Indicate the type and setting depth for any packers installed.
10. The density of the grout slurry must be reported and may be indicated as pounds per gallon, gallons of water per sack, total gallons of water and number of sacks used, etc. Specify the grout placement method, i.e. tremie pipe or positive displacement. The percentage of additives mixed with the grout should be reported under remarks.
11. Record the type and the amount of disinfection used, how placed and the length of time left in the hole.
12. Report well test data as required by Rule 10.7. Spaces are provided to report all measurements made during the test. The report should show that the test complied with the provisions of the rules. If a test was not performed explain when it will be done. If available, report clock time when measurements were taken.
13. Fill in **Company Name and Address of Contractor** who constructed the well. The report must be signed by the licensed contractor responsible for the construction of the well.

OFFICE OF THE STATE ENGINEER  
COLORADO DIVISION OF WATER RESOURCES

818 Centennial Bldg., 1313 Sherman St., Denver, Colorado 80203  
(303) 868-3581

LIC

WELL PERMIT NUMBER 165195  
DIV. 1 CNTY. 30 WD 8 DES. BASIN MD

APPLICANT

F H MERELLI  
305 MADISON  
DENVER, CO 80206

322-7634

Lot: Block: Filing: Subdiv:

APPROVED WELL LOCATION

COUNTY JEFFERSON  
NE 1/4 NW 1/4 Section 36  
Twp 6 S, Range 71 W 6th P.M.

DISTANCES FROM SECTION LINES

1180 Ft. from North Section Line  
1950 Ft. from West Section Line

PERMIT TO CONSTRUCT A WELL

ISSUANCE OF THIS PERMIT DOES NOT CONFER A WATER RIGHT

CONDITIONS OF APPROVAL

- 1) This well shall be used in such a way as to cause no material injury to existing water rights. The issuance of the permit does not assure the applicant that no injury will occur to another vested water right or preclude another owner of a vested water right from seeking relief in a civil court action.
- 2) The construction of this well shall be in compliance with the Water Well Construction and Pump Installation Rules 2 CCR 402-2, unless approval of a variance has been granted by the State Board of Examiners of Water Well Construction and Pump Installation Contractors in accordance with Rule 17.
- 3) Approved pursuant to CRS 37-92-602(3)(b)(II)(A) as the only well on a tract of land of 40 acres described as the S 1/2 of the NE 1/4 of the NW 1/4 and the N 1/2 of the SE 1/4 of the NW 1/4 of Sec. 36, Twp. 6 S., Rng. 71 W. of the 6th P.M., Jefferson County.
- 4) The use of ground water from this well is limited to fire protection, ordinary household purposes inside 1 single family dwelling, the irrigation of not more than 2,500 square feet of home gardens and lawns, and the watering of domestic animals.
- 5) The maximum pumping rate shall not exceed 15 GPM.
- 6) The return flow from the use of the well must be through an individual waste water disposal system of the non-evaporative type where the water is returned to the same stream system in which the well is located.
- 7) This well shall be constructed not more than 200 feet from the location specified on this permit.

*M.M. 7-15-92*

APPROVED:  
MAM

*Hal D. Simpson*

State Engineer (Acting)

*M.A. Malley*

By

Receipt No. 0340632

DATE ISSUED JUL 16 1992

EXPIRATION DATE JUL 16 1994

COLORADO DIVISION OF WATER RESOURCES  
818 Centennial Bldg., 1313 Sherman St., Denver, Colorado 80203

X  
500.

PERMIT APPLICATION FORM

RECEIVED

JUN 25 '92

Application must be complete where applicable. Type or print in **BLACK INK**. No overstrikes or erasures unless initialed.

- (X) A PERMIT TO USE GROUND WATER
- (X) A PERMIT TO CONSTRUCT A WELL
- FOR: (X) A PERMIT TO INSTALL A PUMP

( ) REPLACEMENT FOR NO. \_\_\_\_\_  
 ( ) OTHER \_\_\_\_\_  
 WATER COURT CASE NO. \_\_\_\_\_

WATER RESOURCES  
STATE ENGINEER  
COLO.

165195

(1) **APPLICANT** - mailing address

NAME F. H. WERELLI  
 STREET 305 MADISON  
 CITY DENVER CO. 80206  
(State) (Zip)  
 TELEPHONE NO. 322-7634

FOR OFFICE USE ONLY: DO NOT WRITE IN THIS COLUMN

Receipt No. 340632  
 Basin \_\_\_\_\_ Dist. \_\_\_\_\_

CONDITIONS OF APPROVAL

This well shall be used in such a way as to cause no material injury to existing water rights. The issuance of the permit does not assure the applicant that no injury will occur to another vested water right or preclude another owner of a vested water right from seeking relief in a civil court action.

(2) **LOCATION OF PROPOSED WELL**

County JEFFERSON  
NE 1/4 of the NW 1/4, Section 36  
 Twp. 6 S, Rng. 71 W, 60TH P.M.  
(N,S) (E,W)

(3) **WATER USE AND WELL DATA**

Proposed maximum pumping rate (gpm) 15  
 Average annual amount of ground water to be appropriated (acre-feet): 2  
 Number of <sup>FT<sup>2</sup></sup> acres to be irrigated: 2500 FT<sup>2</sup>  
 Proposed total depth (feet): 600  
 Aquifer ground water is to be obtained from:  
FRACTURED GRANITE  
 Owner's well designation 1A

**GROUND WATER TO BE USED FOR:**

- ( ) HOUSEHOLD USE ONLY - no irrigation (0)
- (X) DOMESTIC (1) ( ) INDUSTRIAL (5)
- ( ) LIVESTOCK (2) ( ) IRRIGATION (6)
- ( ) COMMERCIAL (4) ( ) MUNICIPAL (8)
- ( ) OTHER (9) \_\_\_\_\_

DETAIL THE USE ON BACK IN (11)

(4) **DRILLER** A LICENSED DRILLER WILL BE USED

Name \_\_\_\_\_  
 Street \_\_\_\_\_  
 City \_\_\_\_\_  
(State) (Zip)  
 Telephone No. \_\_\_\_\_ Lic. No. \_\_\_\_\_

**APPLICATION APPROVED**

PERMIT NUMBER \_\_\_\_\_  
 DATE ISSUED \_\_\_\_\_  
 EXPIRATION DATE \_\_\_\_\_  
 \_\_\_\_\_  
(STATE ENGINEER)  
 BY \_\_\_\_\_  
 I.D. 1 COUNTY 30 18

(5) **THE LOCATION OF THE PROPOSED WELL** and the area on which the water will be used must be indicated on the diagram below. Use the CENTER SECTION (1 section, 640 acres) for the well location.

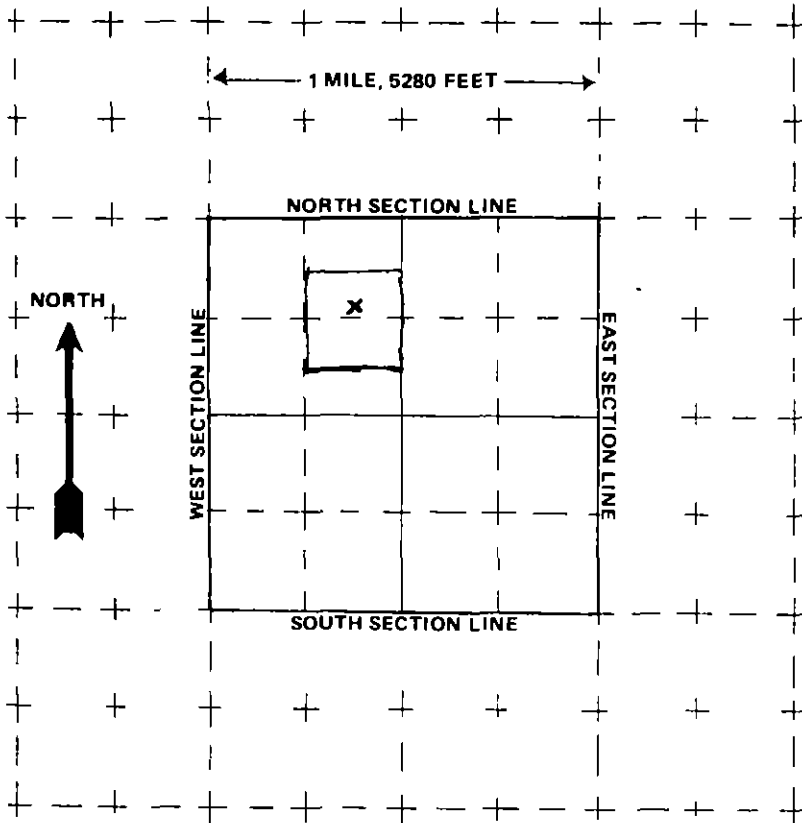

The scale of the diagram is 2 inches = 1 mile  
Each small square represents 40 acres.

**WATER EQUIVALENTS TABLE (Rounded Figures)**

An acre-foot covers 1 acre of land 1 foot deep  
1 cubic foot per second (cfs) . . . 449 gallons per minute (gpm)  
A family of 5 will require approximately 1 acre-foot of water per year.  
1 acre-foot . . . 43,560 cubic feet . . . 325,900 gallons.  
1,000 gpm pumped continuously for one day produces 4.42 acre-feet.

(6) **THE WELL MUST BE LOCATED BELOW** by distances from section lines.

1180 ft. from NORTH sec. line  
(north or south)

1950 ft. from WEST sec. line  
(east or west)

LOT \_\_\_\_\_ BLOCK \_\_\_\_\_ FILING # \_\_\_\_\_

SUBDIVISION NONE

(7) **TRACT ON WHICH WELL WILL BE LOCATED** Owner: F.H. MERELLI

No. of acres 40 Will this be

the only well on this tract? YES

(8) **PROPOSED CASING PROGRAM**

Plain Casing

8 in. from 0 ft. to 30 ft.

4 in. from 0 ft. to 550 ft.

Perforated casing

4 in. from 550 ft. to 600 ft.

\_\_\_\_\_ in. from \_\_\_\_\_ ft. to \_\_\_\_\_ ft.

(9) **FOR REPLACEMENT WELLS** give distance and direction from old well and plans for plugging it:

\_\_\_\_\_  
\_\_\_\_\_  
\_\_\_\_\_

(10) **LAND ON WHICH GROUND WATER WILL BE USED:**

Owner(s): F.H. MERELLI No. of acres: 40

Legal description: S/2, NE/4 NW/4 AND N/2, SE/4 NW/4, SEC 36, T6S, R71W

(11) **DETAILED DESCRIPTION** of the use of ground water: Household use and domestic wells must indicate type of disposal system to be used.

ONE HOUSE, VERY SMALL ROCK GARDEN — SEPTIC SYSTEM

(12) **OTHER WATER RIGHTS** used on this land, including wells. Give Registration and Water Court Case Numbers.

Type or right	Used for (purpose)	Description of land on which used
<u>NONE</u>		

(13) **THE APPLICANT(S) STATE(S) THAT THE INFORMATION SET FORTH HEREON IS TRUE TO THE BEST OF HIS KNOWLEDGE.**

SIGNATURE OF APPLICANT(S)

F.H. MERELLI