

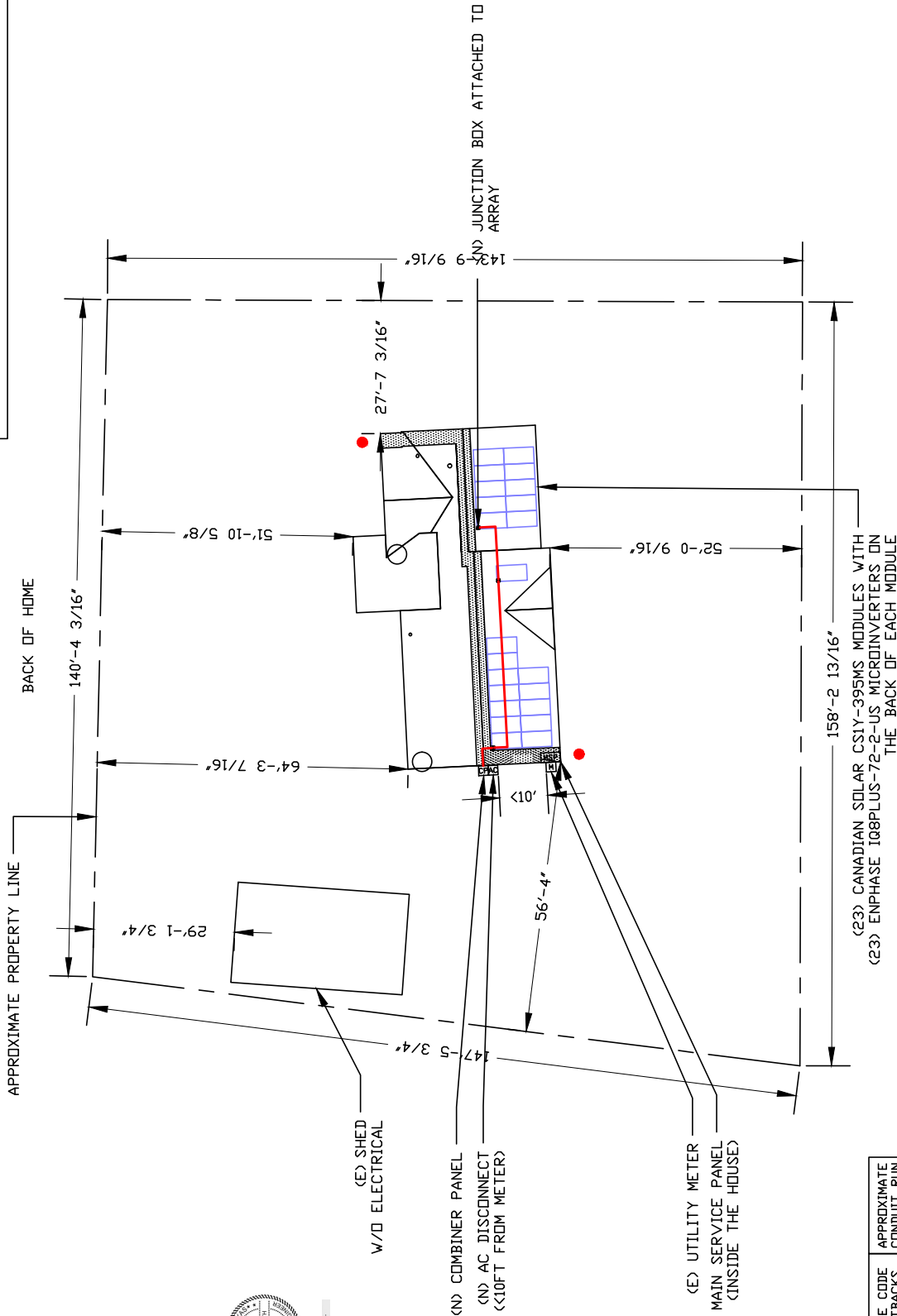

SYSTEM SIZE:
DC: 9.085 Kw
AC: 8.288 Kw



VISIBLE LOCKABLE LABELED DISCONNECT
LOCATED WITHIN 10FT OF UTILITY METER.



ROOF ACCESS POINT	FIRE CODE SETBACKS	APPROXIMATE CONDUIT RUN

(23) CANADIAN SOLAR CSIY-395MS MODULES WITH
(23) ENPHASE 108PLUS-72-2-US MICROINVERTERS ON
THE BACK OF EACH MODULE

FRONT OF HOME
2168 FM RD 1566 W,
CELESTE, TX 75423

⊙ SITE PLAN
SCALE: 3/64" = 1'-0"

Lumio
LUMIO HX INC
SOLAR PANEL
SYSTEMS IN TEXAS
2000 E LAMAR BLVD
SUITE 300
ARLINGTON, TX 76006
1 (888) 515-6199

LOCATION

KAYLENE BASHAM
RESIDENCE
2168 FM 1566 W,
CELESTE, TX 75423
GPS: 33.290976, -96.141323
METER #: 145785266
ESID: 10443720001650707

DRAWN BY	LEP - J
DRAWING DATE	8/5/2022
REVISIONS	
CHANGES	
DATE	

STATE OF TEXAS
RAYMOND J. GARGALAC
ELECTRICAL ENGINEER
LICENSE NO. 10887
EXPIRES 08/31/2024

STATE OF TEXAS
RAYMOND J. GARGALAC
ELECTRICAL ENGINEER
LICENSE NO. 10887
EXPIRES 08/31/2024

MASTER ELECTRICIAN SIGNATURE
Raymond J. Gargalac
8/5/2022

SHEET NUMBER
B001

SITE PLAN
B001