

CALLED 31.12 ACRES
TERRY HAGINS
VOLUME 503, PAGE 548
OFFICIAL RECORDS

CALLED 67.20 ACRES
WILLIAM EARL REES, ET AL
VOLUME 503, PAGE 553
OFFICIAL RECORDS

I.&G.N. R.R. Co. SURVEY No. 3,
ABSTRACT No. 292

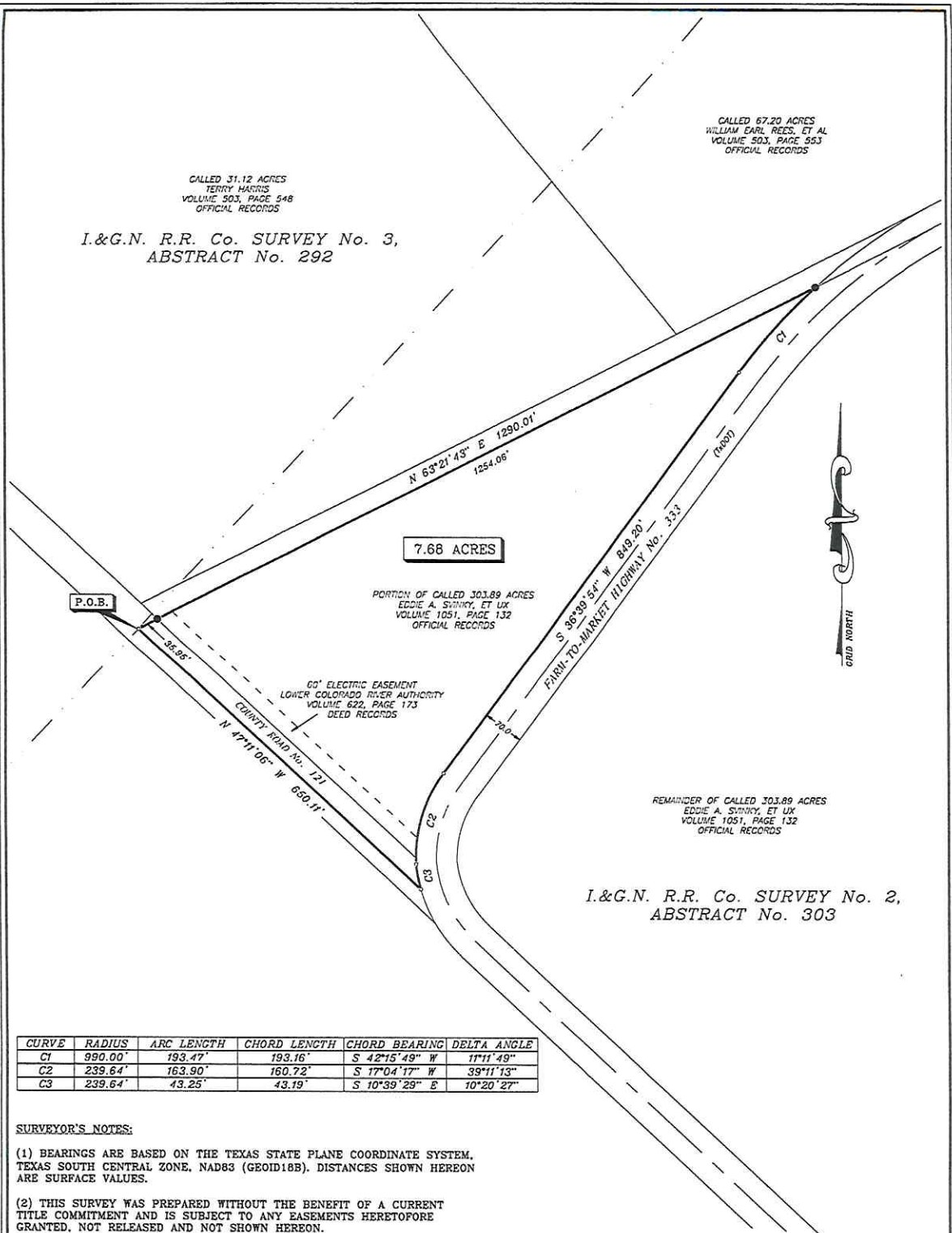

7.66 ACRES

PORTION OF CALLED 303.89 ACRES
EDDIE A. SIMPKY, ET UX
VOLUME 1051, PAGE 132
OFFICIAL RECORDS

60' ELECTRIC EASEMENT
LOWER COLORADO RIVER AUTHORITY
VOLUME 622, PAGE 173
DEED RECORDS

REMAINDER OF CALLED 303.89 ACRES
EDDIE A. SIMPKY, ET UX
VOLUME 1051, PAGE 132
OFFICIAL RECORDS

I.&G.N. R.R. Co. SURVEY No. 2,
ABSTRACT No. 303

CURVE	RADIUS	ARC LENGTH	CHORD LENGTH	CHORD BEARING	DELTA ANGLE
C1	990.00'	193.47'	193.16'	S 42°15'49" W	11°11'49"
C2	239.64'	163.90'	160.72'	S 77°04'17" W	39°11'13"
C3	239.64'	43.25'	43.19'	S 10°39'29" E	10°20'27"

SURVEYOR'S NOTES:

- BEARINGS ARE BASED ON THE TEXAS STATE PLANE COORDINATE SYSTEM, TEXAS SOUTH CENTRAL ZONE, NAD83 (GEOID18B). DISTANCES SHOWN HEREON ARE SURFACE VALUES.
- THIS SURVEY WAS PREPARED WITHOUT THE BENEFIT OF A CURRENT TITLE COMMITMENT AND IS SUBJECT TO ANY EASEMENTS HERETOPRE GRANTED, NOT RELEASED AND NOT SHOWN HEREON.
- ALL SET IRON RODS ARE MARKED WITH A PLASTIC CAP STAMPED "RPLS No. 6247" UNLESS OTHERWISE NOTED.
- LEGAL DESCRIPTION TO ACCOMPANY THIS PLAT.

ARBUCKLE SURVEYING, LLC
2004 N. WHARTON ST.
EL CAMPO, TEXAS 77437
PHONE: (979) 543-7974
FIRM REGISTRATION No. 10193819

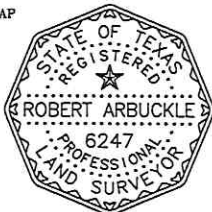

DATE:
MARCH 27, 2024
FILENAME:
230306-7.68AC.DWG

THE STATE OF TEXAS
COUNTY OF WHARTON

I, ROBERT D. ARBUCKLE, A REGISTERED PROFESSIONAL SURVEYOR IN THE STATE OF TEXAS, DO HEREBY CERTIFY THAT THIS PLAT WAS PREPARED FROM AN ACTUAL SURVEY MADE ON THE GROUND UNDER MY DIRECTION AND SUPERVISION, AND THAT THIS PLAT IS A TRUE AND CORRECT REPRESENTATION OF THE SAME AS I LOCATED ITS COMPONENT PARTS ON THE GROUND THE 8TH DAY OF NOVEMBER, 2023.

Robert D. Arbuckle
ROBERT D. ARBUCKLE
REGISTERED PROFESSIONAL LAND SURVEYOR
LICENSE No. 6247

LEGEND

- SET 5/8" IRON ROD
- FOUND 5/8" IRON ROD
- POINT FOR CORNER

