

# Soils Map

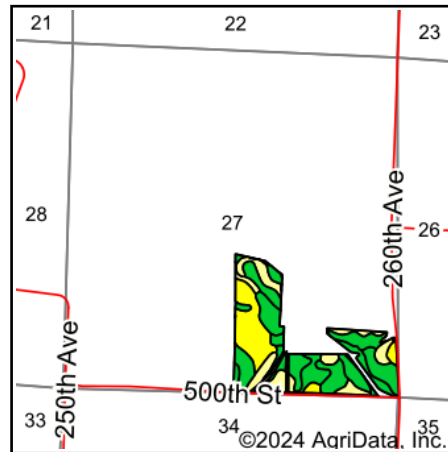

State: **Iowa**  
 County: **Clay**  
 Location: **27-94N-36W**  
 Township: **Herdland**  
 Acres: **66.43**  
 Date: **10/9/2024**

**MIDWEST LAND** & REAL ESTATE, INC  
 MANAGEMENT  
 712-262-3110

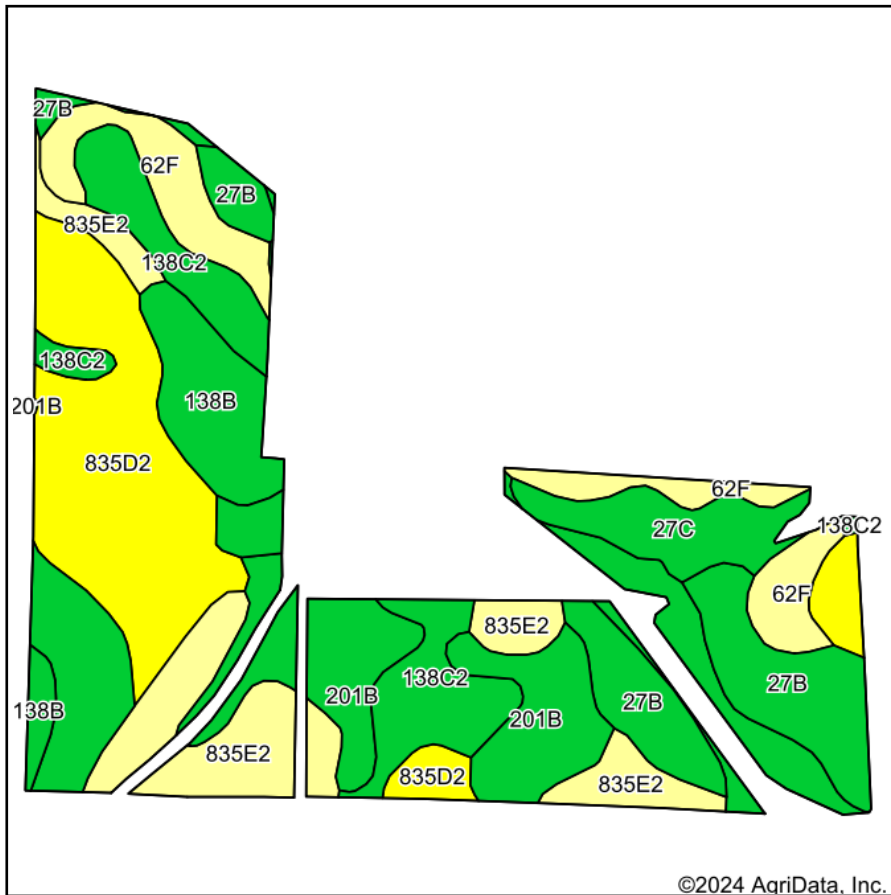







Maps Provided By:  
  
 CUSTOMIZED ONLINE MAPPING  
 © AgriData, Inc. 2023 www.AgriDataInc.com



Soils data provided by USDA and NRCS.

©2024 AgriData, Inc.

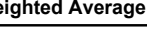
Area Symbol: IA041, Soil Area Version: 33

Code	Soil Description	Acres	Percent of field	CSR2 Legend	Non-Irr Class *c	CSR2**	CSR
835D2	Omsrud-Storden complex, 10 to 16 percent slopes, moderately eroded	13.60	20.5%		IVe	53	46
201B	Coland-Terril complex, 2 to 5 percent slopes	11.21	16.9%		IIw	81	51
138C2	Clarion loam, 6 to 10 percent slopes, moderately eroded	11.10	16.7%		IIIe	83	59
835E2	Omsrud-Storden complex, 10 to 22 percent slopes, moderately eroded	8.70	13.1%		IVe	36	36
27B	Terril loam, 2 to 6 percent slopes	8.11	12.2%		IIe	87	75
62F	Belview loam, 16 to 30 percent slopes	5.94	8.9%		VIe	17	11
138B	Clarion loam, 2 to 6 percent slopes	4.49	6.8%		IIe	89	74
27C	Terril loam, 5 to 9 percent slopes	3.28	4.9%		IIIe	86	61
<b>Weighted Average</b>					<b>3.25</b>	<b>65.5</b>	<b>50.8</b>

\*\*IA has updated the CSR values for each county to CSR2.

\*c: Using Capabilities Class Dominant Condition Aggregation Method

Soils data provided by USDA and NRCS.