

15± ACRES
SCOTT COUNTY, MS
\$89,000



SMALLTOWN
HUNTING PROPERTIES
& REAL ESTATESM

OFFICE (769) 760-0005

THE SCOTT 15

PROPERTY PROFILE

LOCATION:

- Morton-Marathon Road
Pulaski, MS 39152
- Scott County
- 7± Miles S of Morton
- 39.6± Miles E of Jackson

COORDINATES:

- 32.273214, -89.600010

PROPERTY USE:

- Farming
- Livestock
- Home Site

PROPERTY INFORMATION:

- 15± Acres
- County Road Frontage
- Flat Terrain
- Open Hay Fields
- Large Oak Trees
- Barn
- Three Small Ponds
- Cross Fencing
- Electricity Available

TAX INFORMATION:

2023 - Estimated \$200.00

- Parcel- Part of 1-024-17-000-00-00603



DENNIS WEST | MANAGING BROKER
C: 601-248-4396 | dennis@smalltownproperties.com

JIMMY GENTRY | LAND SPECIALIST
C: 601-421-8500 | jimmy@smalltownproperties.com

2121 5th St., Ste 206 - Meridian, MS 39301 | O: 769-760-0005 | smalltownproperties.com Information is believed to be accurate but not guaranteed.

WELCOME TO THE SCOTT 15

OFFERING THE PERFECT BLEND OF BEAUTY AND DIVERSITY IN THE CHARMING COMMUNITY OF PULASKI, MISSISSIPPI, IS A 15± ACRE TRACT OF LAND. Located approximately 40 minutes from the Jackson Metro area, this Scott County property features lush pastureland with cross-fencing, ideal for livestock or agricultural pursuits. Scattered large oaks provide shade and character, while three small ponds enhance the picturesque setting and offer a convenient water source. The property includes catch pens, a small shed, and a rustic barn, adding a touch of timeless charm. With frontage on Morton-Marathon Road, this property offers the perfect spot to build your dream home, start a mini-farm, or create a tranquil retreat.

If you are in the market to own a piece of rural Mississippi,
call **Jimmy Gentry** or **Dennis West** today!



DENNIS WEST | MANAGING BROKER
C: 601-248-4396 | dennis@smalltownproperties.com

JIMMY GENTRY | LAND SPECIALIST
C: 601-421-8500 | jimmy@smalltownproperties.com

2121 5th St., Ste 206 - Meridian, MS 39301 | O: 769-760-0005 | smalltownproperties.com Information is believed to be accurate but not guaranteed.

15± ACRES

SCOTT COUNTY, MISSISSIPPI



DENNIS WEST | MANAGING BROKER
C: 601-248-4396 | dennis@smalltownproperties.com

JIMMY GENTRY | LAND SPECIALIST
C: 601-421-8500 | jimmy@smalltownproperties.com

2121 5th St., Ste 206 - Meridian, MS 39301 | O: 769-760-0005 | smalltownproperties.com Information is believed to be accurate but not guaranteed.

15± ACRES

SCOTT COUNTY, MISSISSIPPI



DENNIS WEST | MANAGING BROKER
C: 601-248-4396 | dennis@smalltownproperties.com

JIMMY GENTRY | LAND SPECIALIST
C: 601-421-8500 | jimmy@smalltownproperties.com

2121 5th St., Ste 206 - Meridian, MS 39301 | O: 769-760-0005 | smalltownproperties.com *Information is believed to be accurate but not guaranteed.*

15± ACRES

SCOTT COUNTY, MISSISSIPPI

land id. LINK

TOPOGRAPHY MAP

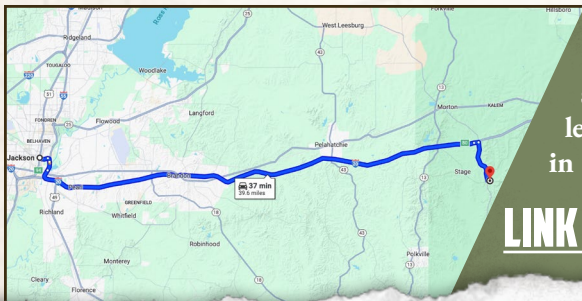
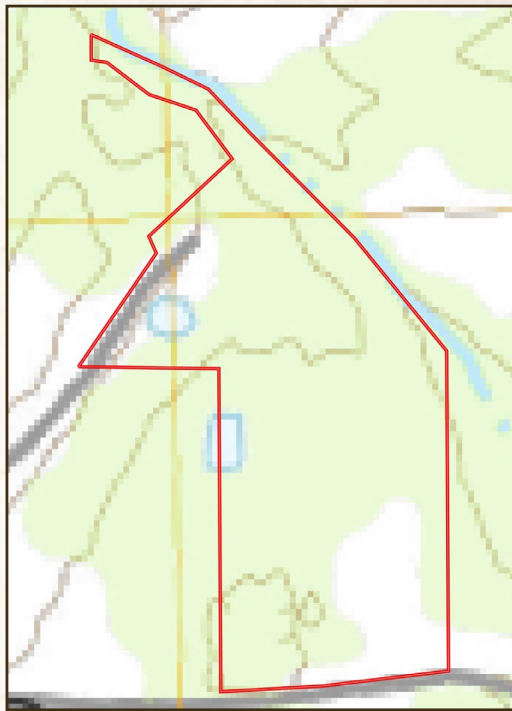

Directions from Morton, MS: Travel south on Hwy 481 to Pulaski. Turn left onto Morton-Marathon Road and in 800feet, the property will be on left.

[LINK TO GOOGLE MAP DIRECTIONS](#)



DENNIS WEST | MANAGING BROKER
C: 601-248-4396 | dennis@smalltownproperties.com

JIMMY GENTRY | LAND SPECIALIST
C: 601-421-8500 | jimmy@smalltownproperties.com

2121 5th St., Ste 206 - Meridian, MS 39301 | O: 769-760-0005 | smalltownproperties.com *Information is believed to be accurate but not guaranteed.*