

# Soils Map

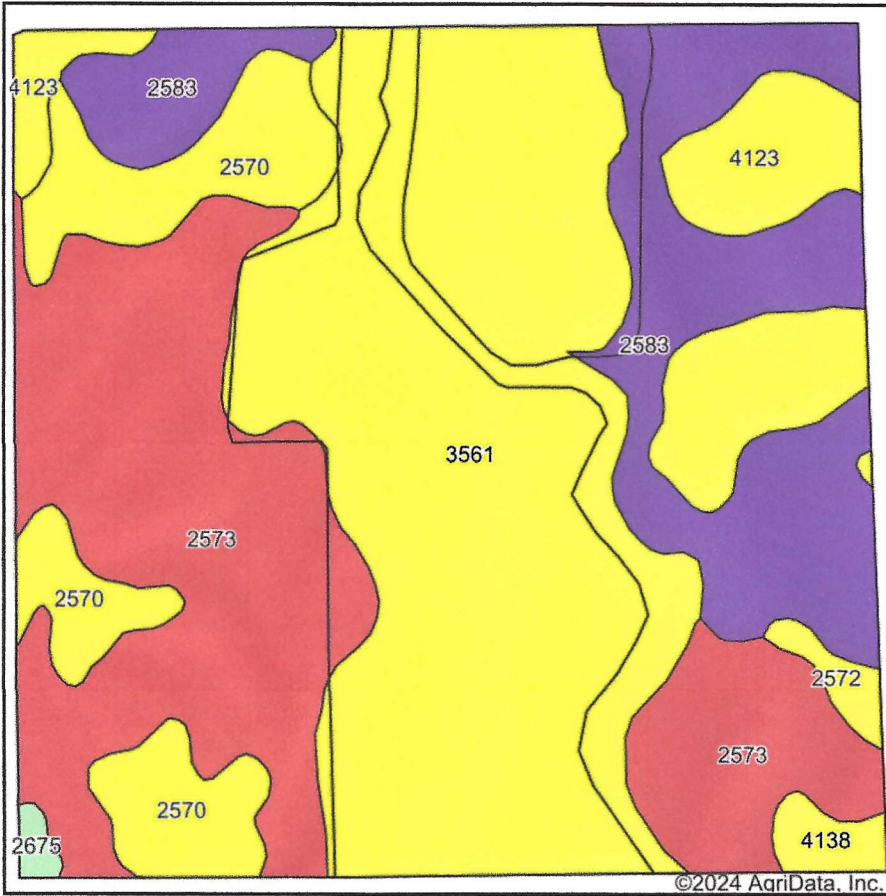

Soils data provided by USDA and NRCS.

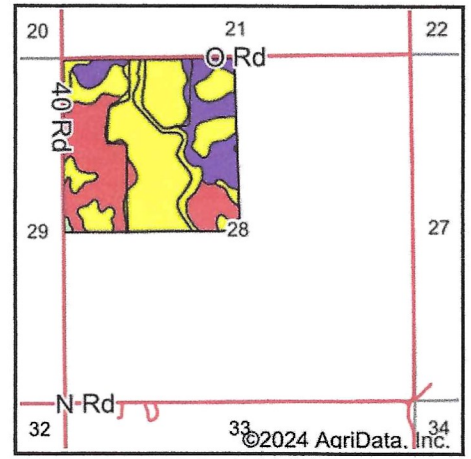

State: **Nebraska**  
 County: **Franklin**  
 Location: **28-3N-13W**  
 Township: **Grant**  
 Acres: **160.21**  
 Date: **10/29/2024**

**United Country** | **AgTeam**  
**Real Estate** | **Land Brokers**

Maps Provided By:

**surety**  
 CUSTOMIZED ONLINE MAPPING  
 © AgriData, Inc. 2023 www.AgriDataInc.com



©2024 AgriData, Inc.

Area Symbol: NE061, Soil Area Version: 21

Code	Soil Description	Acres	Percent of field	SRPG Legend	Non-Irr Class *c	Irr Class *c	Range Production (lbs/acre/yr)	SRPG	*n NCCPI Overall	*n NCCPI Corn	*n NCCPI Small Grains	*n NCCPI Soybeans
3561	Hobbs silt loam, occasionally flooded	60.98	38.0%		IIw	IIw	4235	67	80	65	60	80
2573	Nuckolls and Meadin soils, 11 to 30 percent slopes	42.58	26.6%		VIe		2655	28	43	35	35	38
2583	Nuckolls-Hobbs complex, 11 to 30 percent slopes	25.45	15.9%		VIe		3165	59	67	48	52	67
2570	Nuckolls and Holdrege silt loams, 3 to 6 percent slopes	14.80	9.2%		IIIe	IIIe	3000	70	76	53	61	76
4123	Holdrege and Uly soils, 3 to 7 percent slopes, eroded	13.10	8.2%		IIIe	IIIe	2980	68	66	45	49	66
4138	Holdrege silt loam, 7 to 11 percent slopes	1.55	1.0%		IVe	IVe	3551	67	76	57	60	76
2572	Nuckolls and Holdrege soils, 3 to 11 percent slopes, eroded	1.21	0.8%		IVe	IIIe	3000	66	67	50	55	67
2675	Holdrege silt loam, 3 to 7 percent slopes, plains and breaks	0.54	0.3%		IIIe	IIIe	3000		75	50	58	75
<b>Weighted Average</b>									<b>*n 66.4</b>	<b>*n 51.3</b>	<b>*n 51.2</b>	<b>*n 65.1</b>

\*n: The aggregation method is "Weighted Average using all components"

\*c: Using Capabilities Class Dominant Condition Aggregation Method

\*-: Irr Class weighted average cannot be calculated on the current soils data due to missing data.

Soils data provided by USDA and NRCS.