

Soils Map

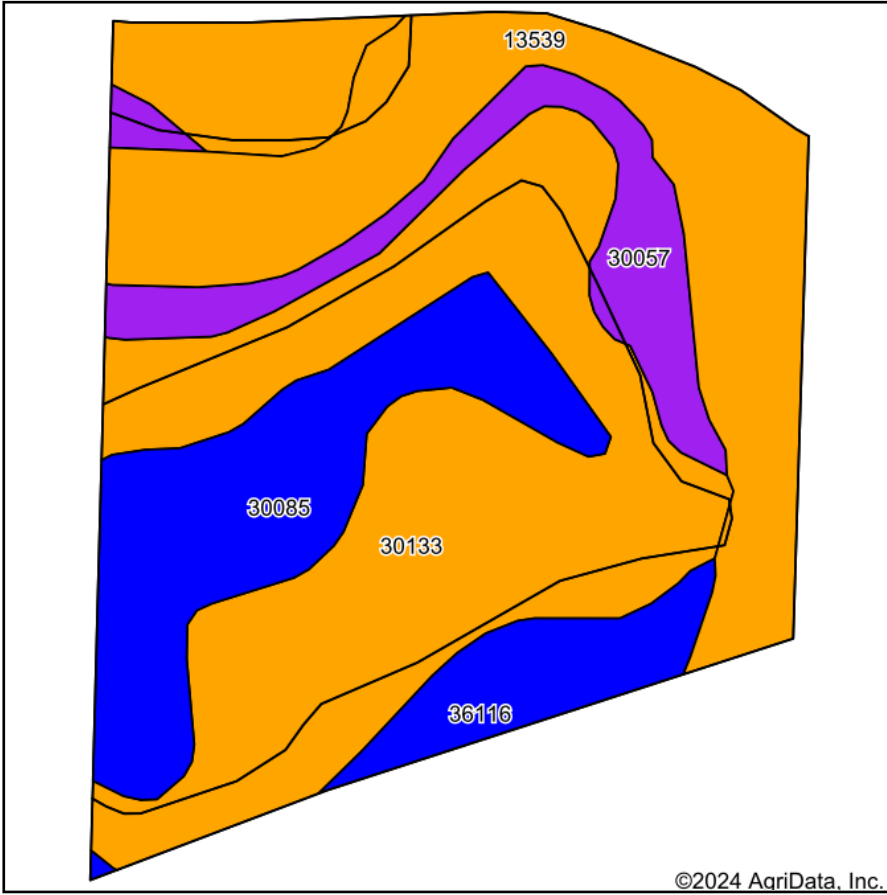

Soils data provided by USDA and NRCS.

©2024 AgriData, Inc.

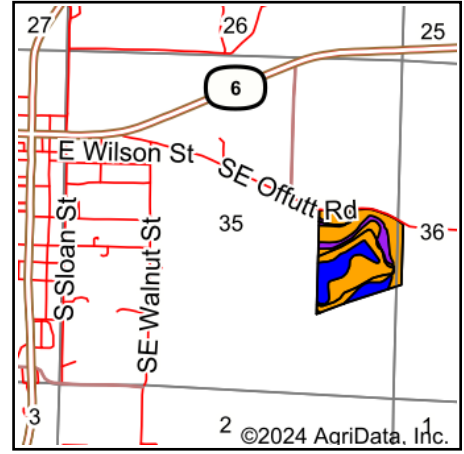

State: **Missouri**
 County: **DeKalb**
 Location: **35-59N-31W**
 Township: **Camden**
 Acres: **42.46**
 Date: **12/16/2024**

United Country
 Property Solutions, LLC

Maps Provided By:

 CUSTOMIZED ONLINE MAPPING
 © AgriData, Inc. 2023 www.AgriDataInc.com



Area Symbol: MO063, Soil Area Version: 26

Code	Soil Description	Acres	Percent of field	Non-Irr Class Legend	Non-Irr Class *c	Common bermudagrass Tons	Orchardgrass red clover Tons	Tall fescue Tons	Warm season grasses Tons	*n NCCPI Overall	*n NCCPI Corn	*n NCCPI Soybeans
30133	Lamoni clay loam, 5 to 9 percent slopes, eroded	18.51	43.6%		Ille					59	59	47
13539	Kennebec silt loam, 0 to 2 percent slopes, frequently flooded	10.38	24.4%		Illw	7	9	8	10	63	63	56
30085	Grundy silt loam, 2 to 5 percent slopes	7.07	16.7%		Ile					74	74	64
30057	Gara loam, 14 to 18 percent slopes	3.96	9.3%		Vle					66	66	52
36116	Zook silty clay loam, heavy till, 0 to 2 percent slopes, occasionally flooded	2.54	6.0%		Ilw					74	74	67
Weighted Average					3.05	1.7	2.2	2	2.4	*n 64	*n 64	*n 53.7

*n: The aggregation method is "Weighted Average using all components"

*c: Using Capabilities Class Dominant Condition Aggregation Method

Soils data provided by USDA and NRCS.