

# Aerial Map

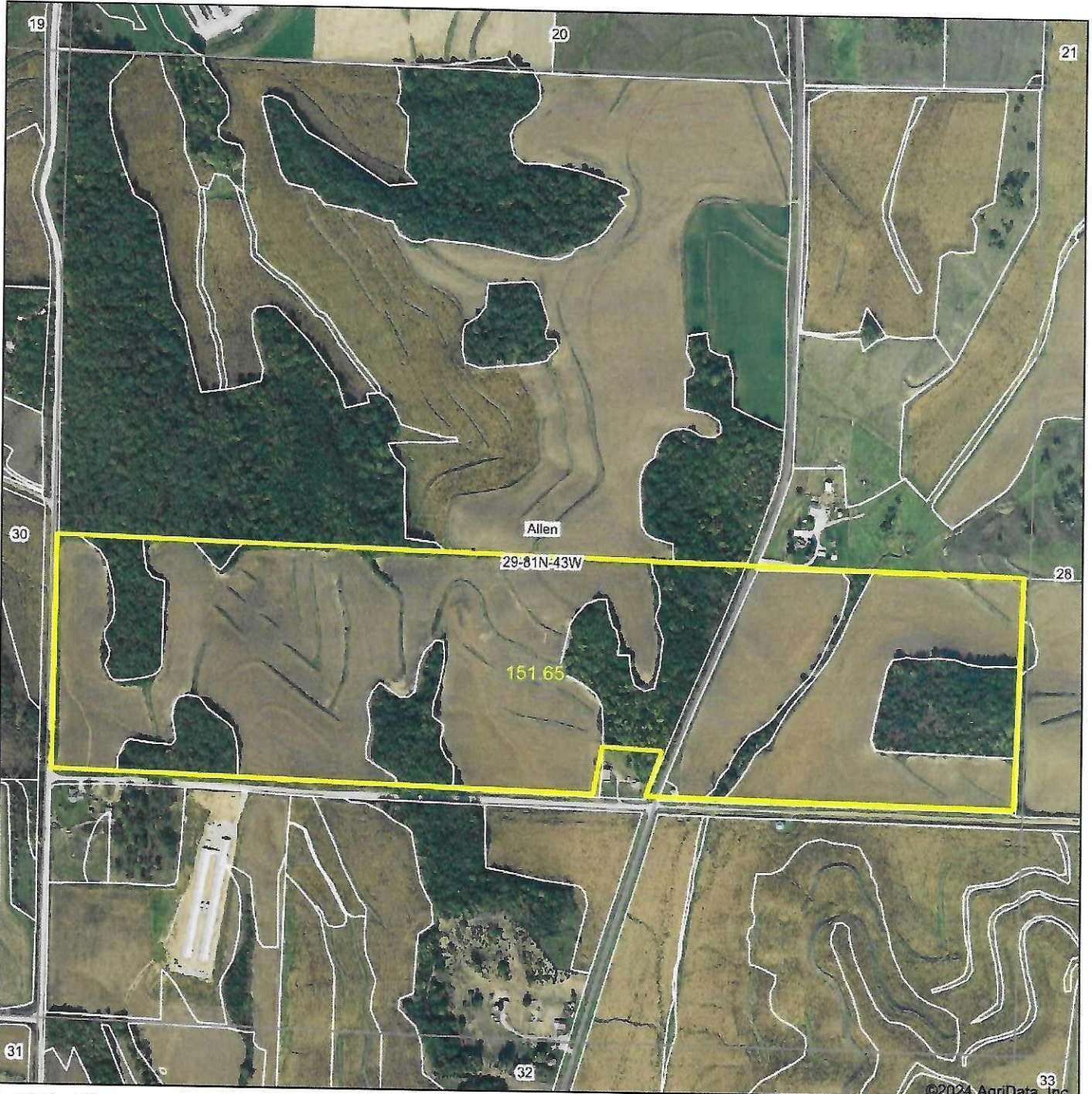

# McCall

AUCTIONS &  
REAL ESTATE

Maps Provided By:



© AgriData, Inc. 2023

www.AgriDataInc.com

Boundary Center: 41° 47' 46.63, -95° 52' 35.64

**29-81N-43W**  
**Harrison County**  
**Iowa**

0ft 838ft 1677ft



10/3/2024

Field borders provided by Farm Service Agency as of 5/21/2008.



# Soils Map

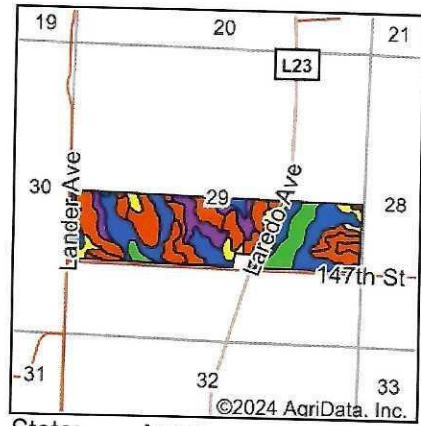
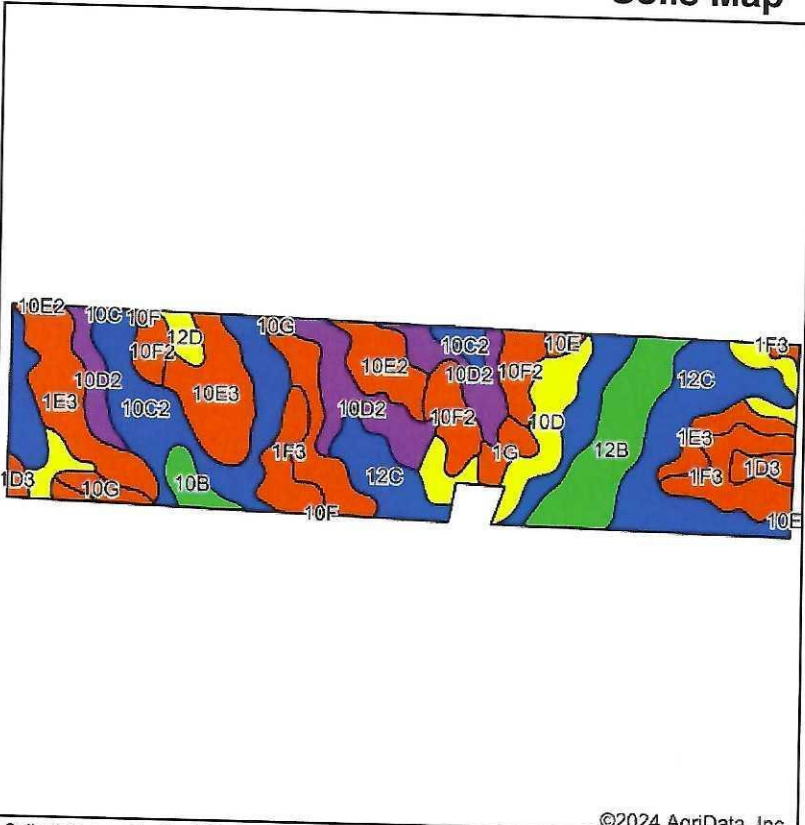

State: **Iowa**  
 County: **Harrison**  
 Location: **29-81N-43W**  
 Township: **Allen**  
 Acres: **151.65**  
 Date: **10/3/2024**

**McCall**

AUCTIONS & REAL ESTATE

Maps Provided By:









Soils data provided by USDA and NRCS.

©2024 AgriData, Inc.

Area Symbol: IA085, Soil Area Version: 32

Code	Soil Description	Acres	Percent of field	CSR2 Legend	Non-Irr Class *c	Irr Class *c	*j Corn Bu	*j Soybeans Bu	CSR2**	*n NCCPI Corn	*n NCCPI Soybeans
12C	Napier silt loam, 5 to 9 percent slopes	29.96	19.7%		IIIe		214.4	62.2	89	86	87
1E3	Ida silt loam, 14 to 20 percent slopes, severely eroded	18.94	12.5%		IVe		97.6	28.3	18	57	54
10C2	Monona silt loam, 5 to 9 percent slopes, eroded	16.92	11.2%		IIIe		211.2	61.2	86	81	76
10D2	Monona silt loam, 9 to 14 percent slopes, eroded	15.40	10.2%		IIIe		164.8	47.8	60	76	70
12B	Napier silt loam, 2 to 5 percent slopes	11.61	7.7%		IIe		230.4	66.8	93	87	89
1F3	Ida silt loam, 20 to 30 percent slopes, severely eroded	10.78	7.1%		VIe		88.0	25.5	8	17	10
10F2	Monona silt loam, 20 to 30 percent slopes, eroded	9.26	6.1%		VIe		115.2	33.4	24	24	15
10E3	Monona silt loam, 14 to 20 percent slopes, severely eroded	8.63	5.7%		IVe		142.4	41.3	38	67	56
10D	Monona silt loam, 9 to 14 percent slopes	8.10	5.3%		IIIe		177.6	51.5	63	82	81
10E2	Monona silt loam, 14 to 20 percent slopes, eroded	5.76	3.8%		IVe		153.6	44.5	45	71	63
12D	Napier silt loam, 9 to 14 percent slopes	5.67	3.7%		IIIe		177.6	51.5	62	78	79

Soils data provided by USDA and NRCS.

Code	Soil Description	Acres	Percent of field	CSR2 Legend	Non-Irr Class *c	Irr Class *c	*i Corn Bu	*i Soybeans Bu	CSR2**	*n NCCPI Corn	*n NCCPI Soybeans
1D3	Ida silt loam, 9 to 14 percent slopes, severely eroded	2.45	1.6%		IIIe		126.4	36.7	32	60	58
10B	Monona silt loam, 2 to 5 percent slopes	2.30	1.5%		Ile	IIIe	232.0	67.3	95	88	88
1G	Ida silt loam, 30 to 40 percent slopes	2.28	1.5%		VIIe		88.0	25.5	6	17	11
10G	Monona silt loam, 30 to 40 percent slopes	2.07	1.4%		VIIe		120.0	34.8	9	24	17
10E	Monona silt loam, 14 to 20 percent slopes	0.78	0.5%		IVe		158.4	45.9	48	77	74
10F	Monona silt loam, 20 to 30 percent slopes	0.42	0.3%		VIe		120.0	34.8	26	24	17
10C	Monona silt loam, 5 to 9 percent slopes	0.32	0.2%		IIIe		216.0	62.6	89	86	87
<b>Weighted Average</b>					<b>3.65</b>	<b>*-</b>	<b>166</b>	<b>48.1</b>	<b>56.9</b>	<b>*n 67.5</b>	<b>*n 64.1</b>

\*\*IA has updated the CSR values for each county to CSR2.

\*i Yield data provided by the ISPAID Database version 8.1.1 developed by IA State University.

\*n: The aggregation method is "Weighted Average using all components"

\*c: Using Capabilities Class Dominant Condition Aggregation Method

\*- Irr Class weighted average cannot be calculated on the current soils data due to missing data.



# Aerial Map



# McCall

AUCTIONS &  
REAL ESTATE

Maps Provided By:

 **surety**  
CUSTOMIZED ONLINE MAPPING

© AgriData, Inc. 2023 [www.AgriDataInc.com](http://www.AgriDataInc.com)

Boundary Center: 41° 47' 46.58, -95° 52' 35.5

**29-81N-43W**  
**Harrison County**  
**Iowa**

0ft 838ft 1677ft



8/22/2024

Field borders provided by Farm Service Agency as of 5/21/2008.



# Soils Map

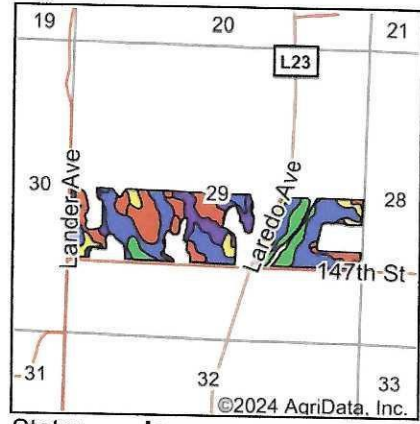
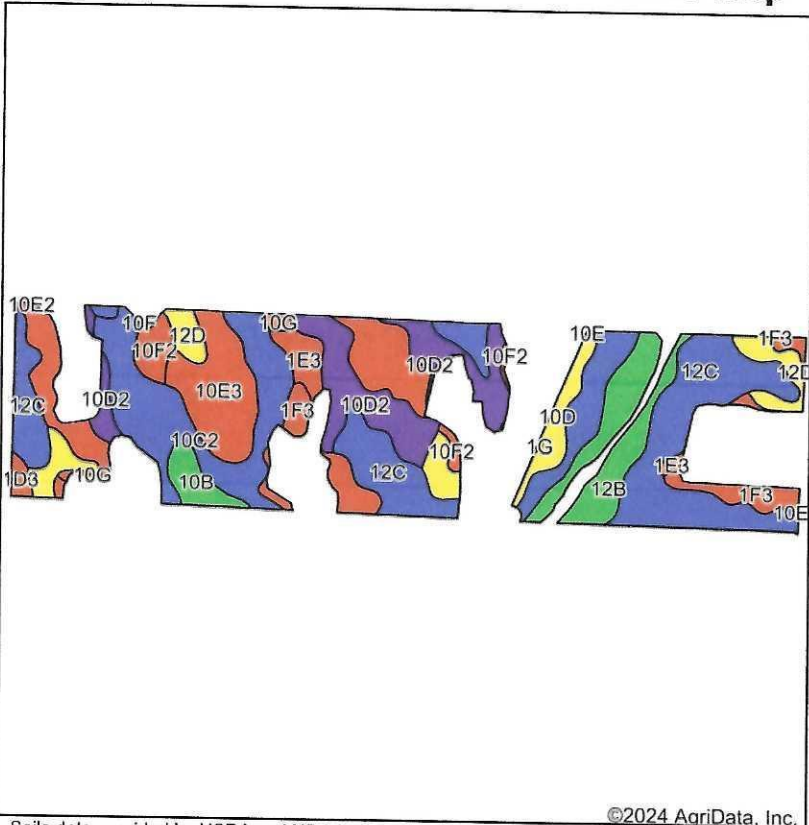

State: **Iowa**  
 County: **Harrison**  
 Location: **29-81N-43W**  
 Township: **Allen**  
 Acres: **113.22**  
 Date: **8/22/2024**

**McCall**

AUCTIONS &  
REAL ESTATE

Maps Provided By:

**surety**  
CUSTOMIZED ONLINE MAPPING

© AgriData, Inc. 2023

www.AgridataInc.com

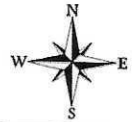





Soils data provided by USDA and NRCS.

©2024 AgriData, Inc.

Area Symbol: IA085, Soil Area Version: 32

Code	Soil Description	Acres	Percent of field	CSR2 Legend	Non-Irr Class *c	Irr Class *c	*j Corn Bu	*i Soybeans Bu	CSR2**	*n NCCPI Corn	*n NCCPI Soybeans
12C	Napier silt loam, 5 to 9 percent slopes	30.09	26.7%		IIIe		214.4	62.2	89	86	87
10C2	Monona silt loam, 5 to 9 percent slopes, eroded	16.47	14.5%		IIIe		211.2	61.2	86	81	76
10D2	Monona silt loam, 9 to 14 percent slopes, eroded	12.62	11.1%		IIIe		164.8	47.8	60	76	70
12B	Napier silt loam, 2 to 5 percent slopes	9.54	8.4%		Ile		230.4	66.8	93	87	89
1E3	Ida silt loam, 14 to 20 percent slopes, severely eroded	9.42	8.3%		IVe		97.6	28.3	18	57	54
10E3	Monona silt loam, 14 to 20 percent slopes, severely eroded	8.62	7.6%		IVe		142.4	41.3	38	67	56
12D	Napier silt loam, 9 to 14 percent slopes	5.64	5.0%		IIIe		177.6	51.5	62	78	79
10E2	Monona silt loam, 14 to 20 percent slopes, eroded	5.31	4.7%		IVe		153.6	44.5	45	71	63
10D	Monona silt loam, 9 to 14 percent slopes	4.67	4.1%		IIIe		177.6	51.5	63	82	81
1F3	Ida silt loam, 20 to 30 percent slopes, severely eroded	3.96	3.5%		VIe		88.0	25.5	8	17	10
10F2	Monona silt loam, 20 to 30 percent slopes, eroded	2.77	2.4%		VIe		115.2	33.4	24	24	15
10B	Monona silt loam, 2 to 5 percent slopes	2.39	2.1%		Ile	IIIe	232.0	67.3	95	88	88

Soils data provided by USDA and NRCS.

Code	Soil Description	Acres	Percent of field	CSR2 Legend	Non-Irr Class *c	Irr Class *c	*i Corn Bu	*i Soybeans Bu	CSR2**	*n NCCPI Corn	*n NCCPI Soybeans
1D3	Ida silt loam, 9 to 14 percent slopes, severely eroded	0.71	0.6%		IIIe		126.4	36.7	32	60	58
10G	Monona silt loam, 30 to 40 percent slopes	0.64	0.6%		VIIe		120.0	34.8	9	24	17
10C	Monona silt loam, 5 to 9 percent slopes	0.30	0.3%		IIIe		216.0	62.6	89	86	87
1G	Ida silt loam, 30 to 40 percent slopes	0.07	0.1%		VIIe		88.0	25.5	6	17	11
<b>Weighted Average</b>					<b>3.30</b>	<b>*-</b>	<b>180.7</b>	<b>52.4</b>	<b>66.2</b>	<b>*n 74.7</b>	<b>*n 71.7</b>

\*\*IA has updated the CSR values for each county to CSR2.

\*j Yield data provided by the ISPAID Database version 8.1.1 developed by IA State University.

\*n: The aggregation method is "Weighted Average using all components"

\*c: Using Capabilities Class Dominant Condition Aggregation Method

\*- Irr Class weighted average cannot be calculated on the current soils data due to missing data.



# Aerial Map



©2024 AgriData, Inc.

Boundary Center: 41° 47' 46.6, -95° 52' 34.75

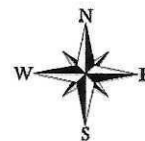
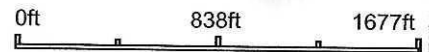

# McCall

AUCTIONS &  
REAL ESTATE

Maps Provided By



© AgriData, Inc. 2023 www.AgriDataInc.com

**29-81N-43W**  
**Harrison County**  
**Iowa**

8/22/2024

Field borders provided by Farm Service Agency as of 5/21/2008.



# Soils Map

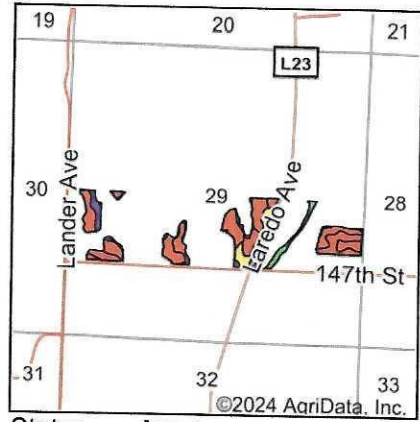
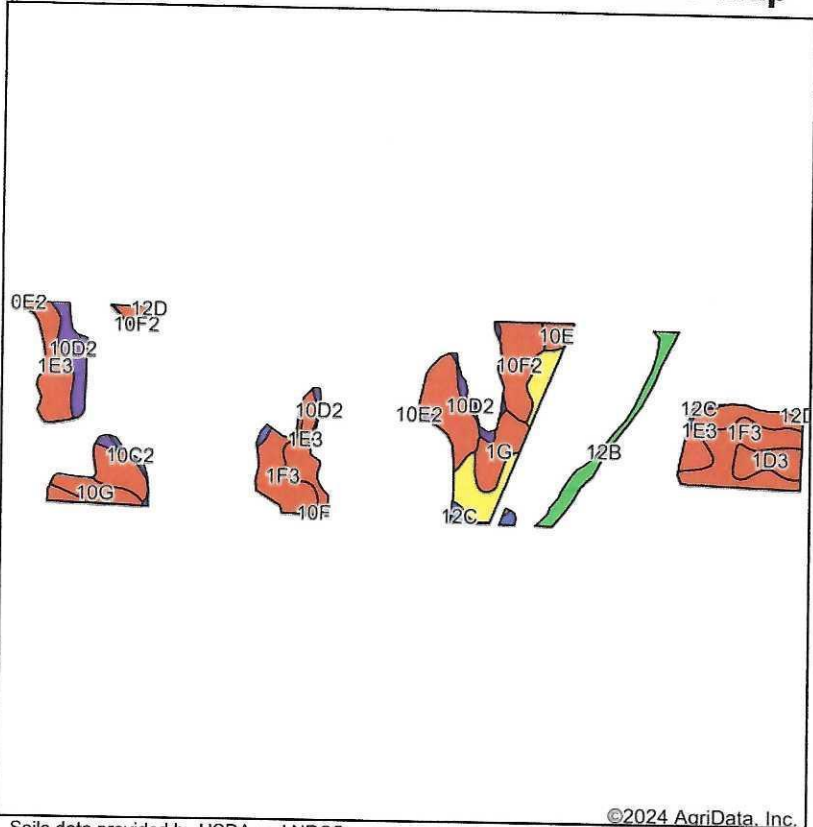

State: **Iowa**  
 County: **Harrison**  
 Location: **29-81N-43W**  
 Township: **Allen**  
 Acres: **39.34**  
 Date: **8/22/2024**

**McCall**

AUCTIONS &  
 REAL ESTATE

Maps Provided By



Soils data provided by USDA and NRCS.

©2024 AgriData, Inc.



Area Symbol: IA085, Soil Area Version: 32

Code	Soil Description	Acres	Percent of field	CSR2 Legend	Non-Irr Class *c	*i Com Bu	*i Soybeans Bu	CSR2**	*n NCCPI Corn	*n NCCPI Soybeans
1E3	Ida silt loam, 14 to 20 percent slopes, severely eroded	9.66	24.7%		IVe	97.6	28.3	18	57	54
1F3	Ida silt loam, 20 to 30 percent slopes, severely eroded	6.98	17.7%		VIe	88.0	25.5	8	17	10
10F2	Monona silt loam, 20 to 30 percent slopes, eroded	6.51	16.5%		VIe	115.2	33.4	24	24	15
10D	Monona silt loam, 9 to 14 percent slopes	3.25	8.3%		IIIe	177.6	51.5	63	82	81
10D2	Monona silt loam, 9 to 14 percent slopes, eroded	2.70	6.9%		IIIe	164.8	47.8	60	76	70
12B	Napier silt loam, 2 to 5 percent slopes	2.20	5.6%		Ile	230.4	66.8	93	87	89
1G	Ida silt loam, 30 to 40 percent slopes	2.17	5.5%		VIIe	88.0	25.5	6	17	11
1D3	Ida silt loam, 9 to 14 percent slopes, severely eroded	1.75	4.4%		IIIe	126.4	36.7	32	60	58
10G	Monona silt loam, 30 to 40 percent slopes	1.47	3.7%		VIIe	120.0	34.8	9	24	17
10E	Monona silt loam, 14 to 20 percent slopes	0.63	1.6%		IVe	158.4	45.9	48	77	74
12C	Napier silt loam, 5 to 9 percent slopes	0.63	1.6%		IIIe	214.4	62.2	89	86	87
10C2	Monona silt loam, 5 to 9 percent slopes, eroded	0.46	1.2%		IIIe	211.2	61.2	86	81	76
10F	Monona silt loam, 20 to 30 percent slopes	0.43	1.1%		VIe	120.0	34.8	26	24	17

Soils data provided by USDA and NRCS.





Code	Soil Description	Acres	Percent of field	CSR2 Legend	Non-Irr Class *c	*i Corn Bu	*i Soybeans Bu	CSR2**	*n NCCPI Corn	*n NCCPI Soybeans
10E2	Monona silt loam, 14 to 20 percent slopes, eroded	0.41	1.0%		Ive	153.6	44.5	45	71	63
12D	Napier silt loam, 9 to 14 percent slopes	0.09	0.2%		IIle	177.6	51.5	62	78	79
<b>Weighted Average</b>						<b>4.65</b>	<b>124.2</b>	<b>36</b>	<b>*n 47.1</b>	<b>*n 42.3</b>

\*\*IA has updated the CSR values for each county to CSR2.

\*i Yield data provided by the ISPAID Database version 8.1.1 developed by IA State University.

\*n: The aggregation method is "Weighted Average using all components"

\*c: Using Capabilities Class Dominant Condition Aggregation Method