

0000-01-004-008-0-013-00, OK, Pontotoc County

APN: 0000-01-004-008-0-013-00 CLIP: 4643212207

	Beds	Full Baths	Half Baths	Sale Price	Sale Date
	N/A	N/A	N/A	\$210,000	10/02/2023
	Bldg Sq Ft	Lot Sq Ft	Yr Built	Type	
	N/A	1,306,800	N/A	AGR-NEC	

OWNER INFORMATION			
Owner Name	Burris Melvin	Tax Billing City & State	Stonewall, OK
Owner Name 2		Tax Billing Zip	74871
Tax Billing Address	22825 County Road 3630	Tax Billing Zip+4	

COMMUNITY INSIGHTS			
Median Home Value	\$208,636	School District	ALLEN
Median Home Value Rating	3 / 10	Family Friendly Score	63 / 100
Total Crime Risk Score (for the neighborhood, relative to the nation)	46 / 100	Walkable Score	13 / 100
Total Incidents (1 yr)	16	Q1 Home Price Forecast	\$212,981
Standardized Test Rank	28 / 100	Last 2 Yr Home Appreciation	14%

LOCATION INFORMATION			
School District Name	Allen Rural	Zoning	
Subdivision		Historic Preservation Zoning Code	
Township		Historic Preservation District	
Census Tract		Township Range Sect	4N-8E-1
Carrier Route		Within 250 Feet of Multiple Flood Zone	No

TAX INFORMATION			
Tax Parcel	0000-01-004-008-0-013-00	Tax Appraisal Area	
Exemption(s)		Lot Number	1
% Improved		Block ID	
Tax Area			
Legal Description	N 1/2 LOT 1 & NE NW NE SEC. 1-4-8 ALLEN TWP.		

ASSESSMENT & TAX			
Assessment Year	2024	2023	2022
Taxable Assessment - Total	\$660	\$660	\$660
Taxable Assessment- Land	\$660	\$660	\$660
Taxable Assessment - Improved			
YOY Assessed Change (\$)	\$0	\$0	
YOY Assessed Change (%)	0%	0%	
Total Assessment	\$5,500	\$5,500	\$5,500
Land Assessment	\$5,500	\$5,500	\$5,500
Improved Assessment			
Exempt Building Value			
Exempt Land Value			
Exempt Total Value			

Tax Year	Total Tax	Change (\$)	Change (%)
2021	\$44		
2022	\$60	\$16	36.36%
2023	\$62	\$2	3.33%

CHARACTERISTICS			
Land Use - County	Rural Ag	Basement Sq Feet	
Land Use - State		Interior Wall	
Land Use - Universal	Agricultural (NEC)	Cooling Type	
Lot Acres	30	Heat Type	
Lot Area	1,306,800	Quality	
Lot Frontage		Exterior	
Lot Depth		Total Rooms	

# of Buildings		Bedrooms	
Total Units		Total Baths	
Building Type		MLS Total Baths	
Foundation		Full Baths	
Building Sq Ft		Half Baths	
Ground Floor Area		Fireplaces	
Main Area		Floor Cover	
2nd Floor Area		Pool	
Parking Type		Porch	
Garage Type		Porch Type	
Garage Capacity		Porch 1 Area	
Garage Sq Ft		Patio/Deck 1 Area	
Roof Type		Patio Type	
Roof Material		Year Built	
Roof Shape		Effective Year Built	
Stories		Water	
Condition		Sewer	
Basement Type		Style	

SELL SCORE			
Rating		Value As Of	2024-12-08 04:40:53
Sell Score			

ESTIMATED VALUE			
RealAVM™		Confidence Score	
RealAVM™ Range		Forecast Standard Deviation	
Value As Of			

(1) RealAVM™ is a CoreLogic® derived value and should not be used in lieu of an appraisal.

(2) The Confidence Score is a measure of the extent to which sales data, property information, and comparable sales support the property valuation analysis process. The confidence score range is 50 - 100. Clear and consistent quality and quantity of data drive higher confidence scores while lower confidence scores indicate diversity in data, lower quality and quantity of data, and/or limited similarity of the subject property to comparable sales.

(3) The FSD denotes confidence in an AVM estimate and uses a consistent scale and meaning to generate a standardized confidence metric. The FSD is a statistic that measures the likely range or dispersion an AVM estimate will fall within, based on the consistency of the information available to the AVM at the time of estimation. The FSD can be used to create confidence that the true value has a statistical degree of certainty.

LISTING INFORMATION			
MLS Listing Number		Closing Date	
MLS Status		Closing Price	
MLS Status Change Date		Listing Agent Name	
MLS Listing Date		Listing Broker Name	
MLS Current List Price		Selling Agent Name	
MLS Orig. List Price		Selling Broker Name	
Pending Date			

MLS Listing #

MLS Status

MLS Listing Date

MLS Listing Price

MLS Orig Listing Price

MLS Close Date

MLS Listing Close Price

MLS Listing Expiration Date

MLS Listing Cancellation Date

LAST MARKET SALE & SALES HISTORY			
Recording Date	10/02/2023	Seller	Hignite Tim & Bonnie
Closing Date	10/02/2023	Document Number	3737-114
Sale Price	\$210,000	Deed Type	Warranty Deed
Owner Name	Burris Melvin	Price Per Square Feet	
Owner Name 2		Cash Down	

Recording Date	10/02/2023	11/04/2021	02/25/2021	
Closing Date	10/02/2023	11/04/2021	02/24/2021	08/31/2000
Sale Price	\$210,000	\$130,000		\$44,000
Nominal			Y	
Buyer Name	Burris Melvin	Hignite Tim & Bonnie	Merriman Harold B	Merriman Harold & Peggy
Seller Name	Hignite Tim & Bonnie	Denson Kent & Cari	Merriman H & P L/Tr	Mooney Shellie S
Document Number	3737-114	3557-6	3478-117	1574-322

MORTGAGE HISTORY

Mortgage Date	10/02/2023
Mortgage Amount	\$120,000
Mortgage Lender	Citizens Bk/Ada
Mortgage Code	Conventional

FORECLOSURE HISTORY

Document Type	
Default Date	
Foreclosure Filing Date	
Recording Date	
Document Number	
Book Number	
Page Number	
Default Amount	
Final Judgment Amount	
Original Doc Date	
Original Document Number	
Original Book Page	
Lien Type	

PROPERTY MAP

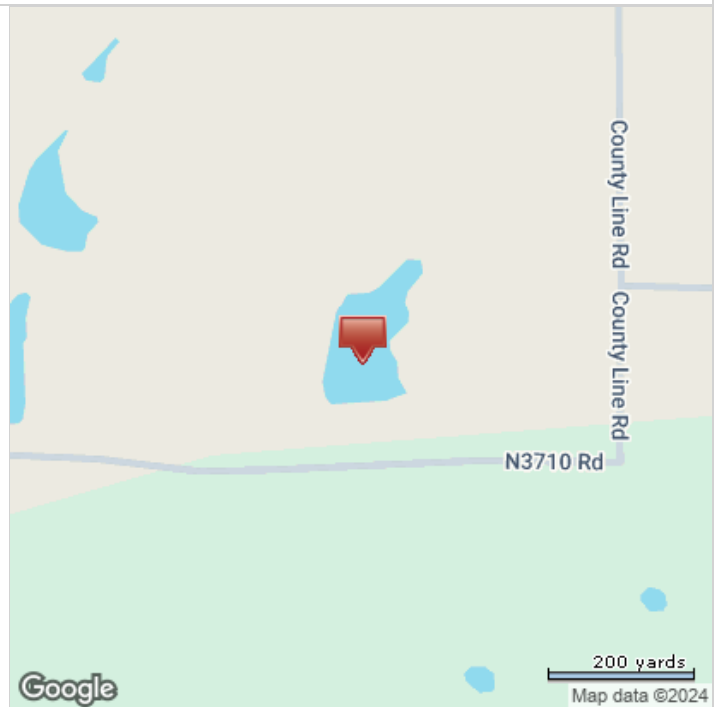

*Lot Dimensions are Estimated