



FARM & RANCH

**UNRESTRICTED
10-ACRE TRACT**

TBD Old Authon Rd. – Weatherford, TX



**STEPHEN
REICH GROUP**
WILLIAMS TREW REAL ESTATE

Williamstrew 

A DIVISION OF EBBY HALLIDAY REAL ESTATE, INC.

LISTED BY STEPHEN REICH GROUP OF WILLIAMS TREW REAL ESTATE

PROPERTY SUMMARY

DESCRIPTION

This gorgeous unrestricted 10-acre tract is located just minutes north of Weatherford, Texas, offering a rare opportunity to own a beautiful piece of land. The property features an ag exemption, providing tax benefits for agricultural use, along with an abundance of mature hardwoods, creating a serene and private setting. A seasonal creek runs through the land, adding natural beauty and tranquility to the landscape. The seller has gone to the effort of installing an all-weather creek crossing, ensuring easy access to the back of the property where multiple picturesque building sites await. Whether you're looking to build your dream home, a weekend getaway, or just enjoy the quiet, peaceful surroundings, this property offers endless possibilities. Unrestricted 10-acre tracts like this are becoming increasingly hard to find in the area, so don't miss out on this incredible opportunity to own a piece of prime real estate. Schedule a showing today and explore the potential this land has to offer!

LOCATION

CITY	Weatherford
County	Parker
Schools	Garner ISD
Driving Directions	On Old Authon Rd between Sandy Lane and Candle Lane. See agent for a pin.

OFFER SUMMARY

List Price	\$352,730
Lot Size	10.078 acres
Utilities	Electricity Available

HIGHLIGHTS

AG EXEMPT & UNRESTRICTED

GARNER ISD

SEASONAL CREEK

INCREASINGLY HARD TO FIND TRACT

ALL WEATHER CREEK CROSSING

MULTIPLE BUILDING SITES

LISTING PRESENTED BY:



STEPHEN REICH
817-597-8884

stephen.reich@williamstrew.com



WilliamsTrew 
A DIVISION OF EBBY HALLIDAY REAL ESTATE, INC.

PROPERTY WEBSITE LINK:
stephenreichgroup.com/20801286



PROPERTY PHOTOS



PROPERTY PHOTOS

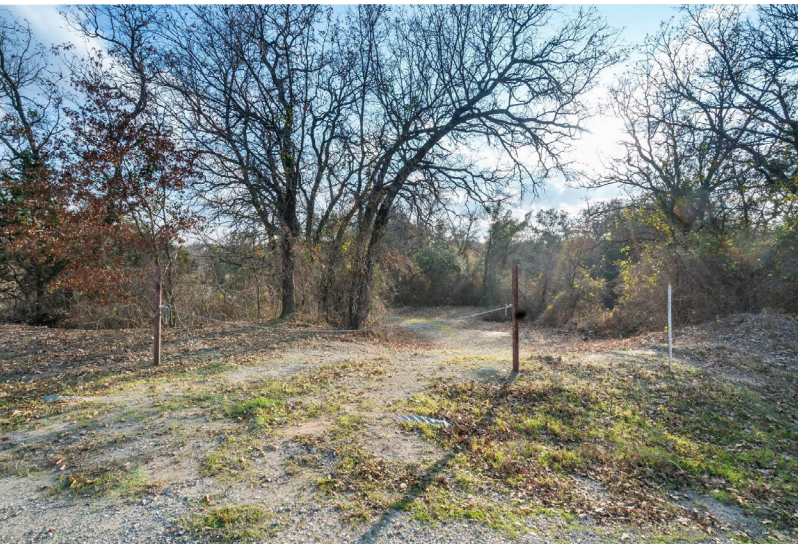

AERIAL MAP



CONTOUR LINES & FLOODPLAIN

