

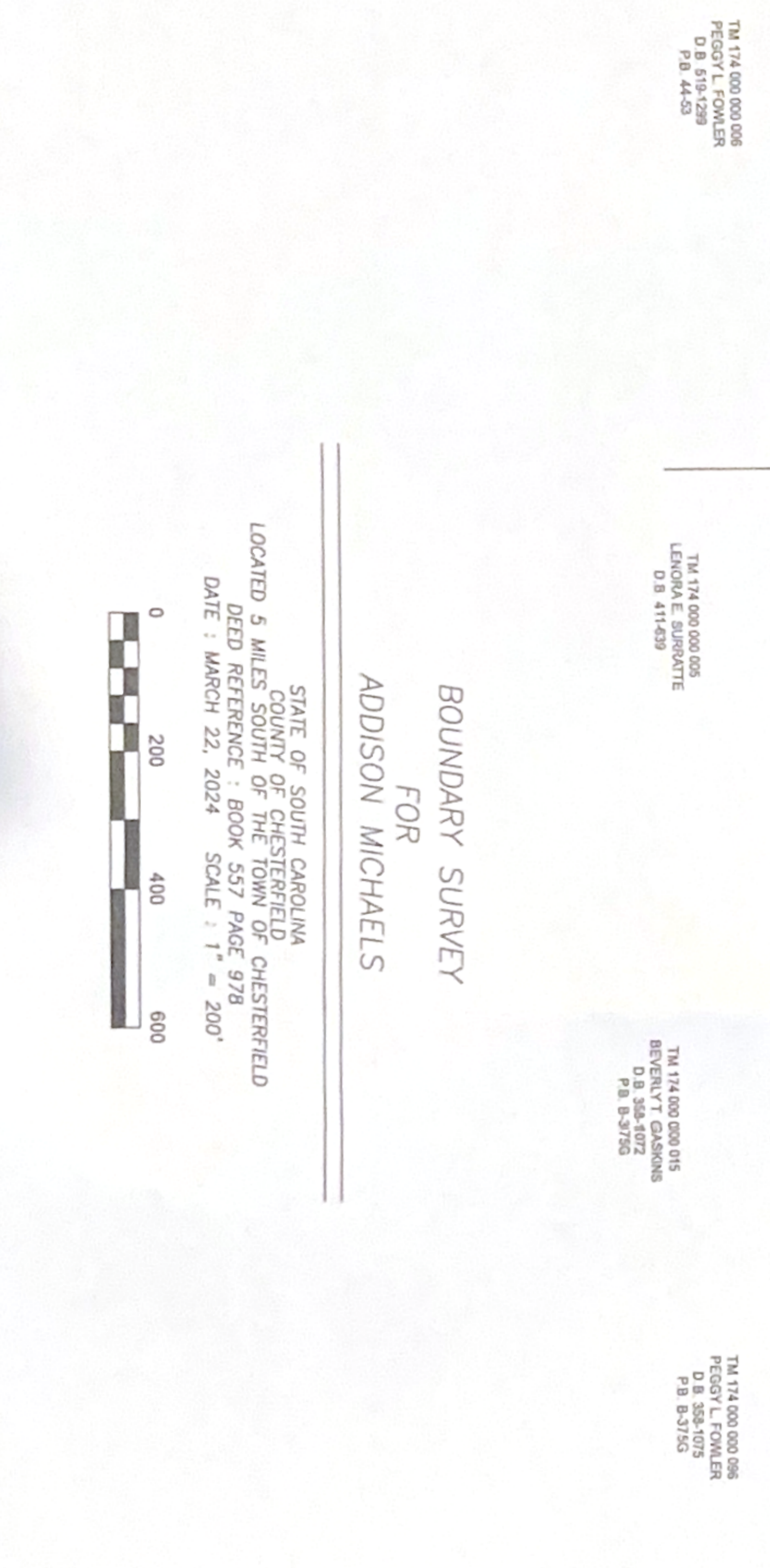

SURVEYED BY:  
J CLIFTON KEITH P.L.S. NO. 12841  
421 MAC KEITH ROAD  
RUBY, S.C. 29741  
PHONE: (843) 634-6041



STATE OF SOUTH CAROLINA  
COUNTY OF CHESTERFIELD  
LOCATED 5 MILES SOUTH OF THE TOWN OF CHESTERFIELD  
DEED REFERENCE : BOOK 557 PAGE 97B  
DATE : MARCH 22, 2024 SCALE : 1" = 200'

BOUNDARY SURVEY  
FOR  
ADDISON MICHAELS



LINE	BEARING	DISTANCE
L1	N 16°05'26" W	37.47
L2	N 57°30'39" W	46.07
L3	N 13°07'23" E	25.10
L4	N 62°16'44" E	59.09
L5	N 05°53'04" E	26.93
L6	N 38°33'38" W	49.54
L7	S 84°36'37" W	33.63
L8	N 39°20'01" W	41.46
L9	N 08°58'19" E	33.39
L10	N 83°39'46" E	22.33
L11	N 35°52'28" E	44.83
L12	N 14°09'49" E	37.42
L13	S 87°51'52" E	40.36
L14	S 65°14'24" E	36.33
L15	N 40°17'25" E	31.76
L16	N 65°49'12" E	60.52
L17	S 89°01'21" E	24.56
L18	N 46°48'37" E	59.34
L19	N 45°50'25" E	57.58
L20	N 63°21'09" E	102.46
L21	N 63°36'51" E	113.59
L22	N 89°24'57" E	76.00
L23	N 89°24'57" E	76.00
L24	N 56°52'25" E	12.99
L25	N 89°18'37" E	37.48
L26	N 87°25'09" E	74.64
L27	N 76°52'58" E	28.47
L28	N 40°25'55" E	68.25
L29	N 15°07'21" W	15.07
L30	N 15°07'21" W	15.07
L31	N 29°51'29" W	22.63
L32	N 50°38'44" E	31.71
L33	N 13°45'27" E	11.51
L34	N 76°36'59" E	21.20
L35	S 82°17'08" W	64.39
L36	S 82°15'19" W	92.10
L37	S 84°34'36" W	50.93
L38	N 80°49'07" W	108.53
L39	N 64°14'33" W	122.62
L40	N 60°59'16" W	125.06
L41	S 24°40'53" W	15.00
L42	S 83°09'54" W	119.36
L43	S 72°36'15" W	87.57
L44	S 70°39'08" W	91.19
L45	S 66°41'18" W	116.84
L46	S 65°43'24" W	59.49
L47	S 62°36'10" W	47.25
L48	S 56°41'18" W	187.64
L49	S 52°29'29" W	67.34
L50	S 59°57'45" W	51.25
L51	S 59°57'45" W	51.25
L52	S 71°44'05" W	37.49
L53	S 77°40'56" W	60.90
L54	S 81°58'11" W	41.66
L55	S 56°34'41" W	33.90
L56	S 42°14'35" W	41.86
L57	S 45°51'08" W	63.90
L58	S 45°51'08" W	110.24
L59	S 47°16'25" W	70.68
L60	S 51°13'08" W	108.87
L61	S 52°13'18" W	69.59
L62	S 47°38'31" W	81.69
L63	S 47°38'31" W	81.69
L64	S 42°40'14" W	34.82
L65	S 61°03'33" W	37.50
L66	S 67°43'33" W	33.83
L67	S 67°43'33" W	33.83

2024-4724  
Filed for Record in  
CHESTERFIELD COUNTY, SC  
FAVE WILLIAMS, REGISTER OF DEEDS  
12/13/2024 11:12:00 AM  
PLAT #25.00  
BY FL Vol C Page 193 - 195

I HEREBY STATE THAT TO THE BEST OF MY KNOWLEDGE, INFORMATION, AND BELIEF, THE SURVEY SHOWN HEREON WAS MADE IN ACCORDANCE WITH THE REQUIREMENTS OF THE MINIMUM STANDARDS MANUAL FOR THE PRACTICE OF LAND SURVEYING IN SOUTH CAROLINA AND MEETS OR EXCEEDS THE REQUIREMENTS FOR A CLASS A SURVEY AS SPECIFIED THEREIN.

A True Copy Attest  
*Page W. Williams*  
REGISTER OF DEEDS  
CHESTERFIELD COUNTY, SC

