



# KSI LABORATORIES

202 S. DACEY DR., SHELBYVILLE, ILLINOIS 62565  
PHONE (217) 774-2421  
www.KSILab.com



Operator: Scott O'Neill  
Field: ERWIN 12  
Acres: 10.9

Field ID: 186250  
Date: 05/23/2023  
Submitted By: ASC (OGDEN)

Legend	
Base Map	
	Water
	Roads
	Timber
	Waterway
	Buildings

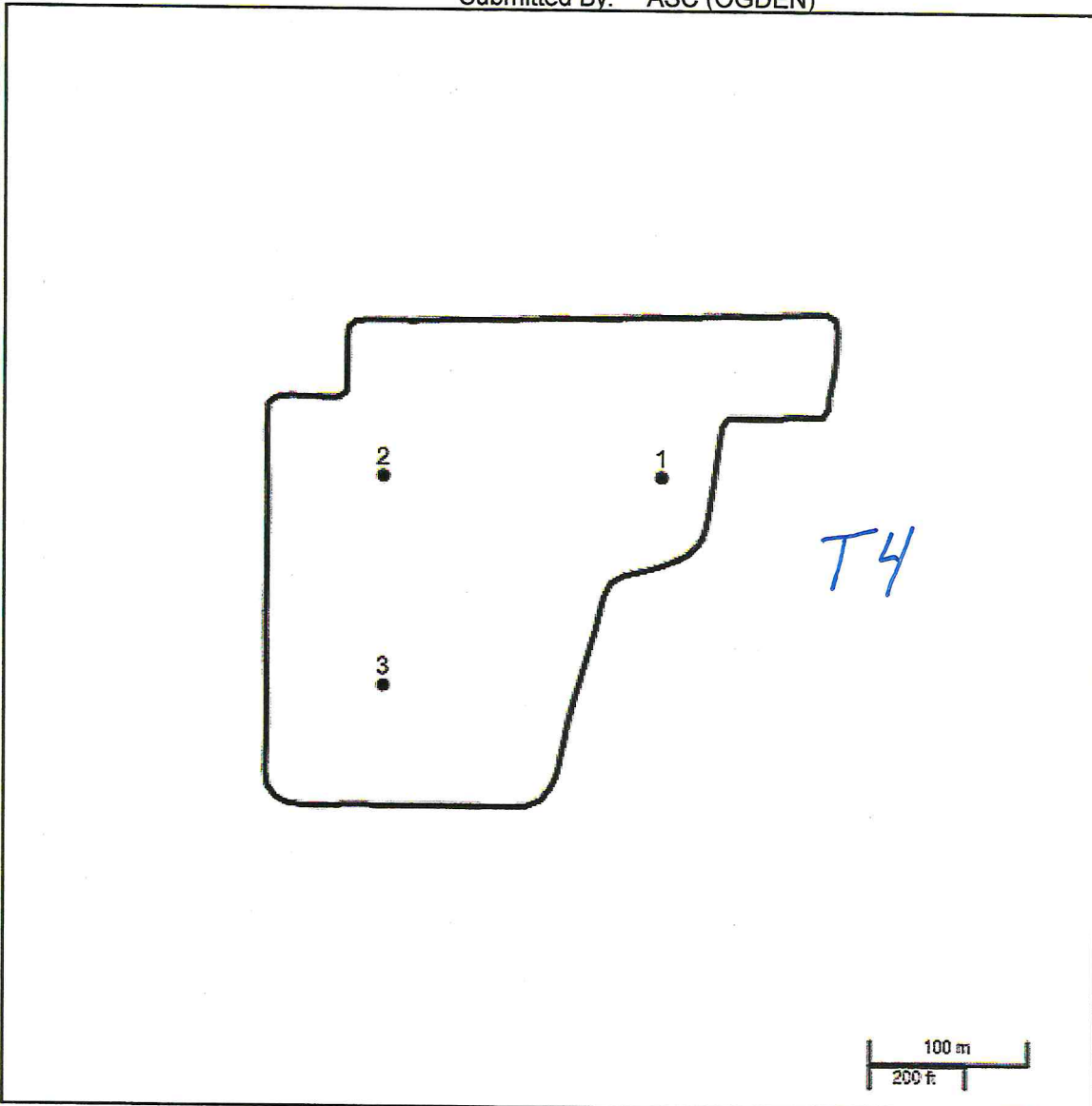

Latitude: 40.075502  
Longitude: -87.917677  
Grid Size: 440nsx330ew

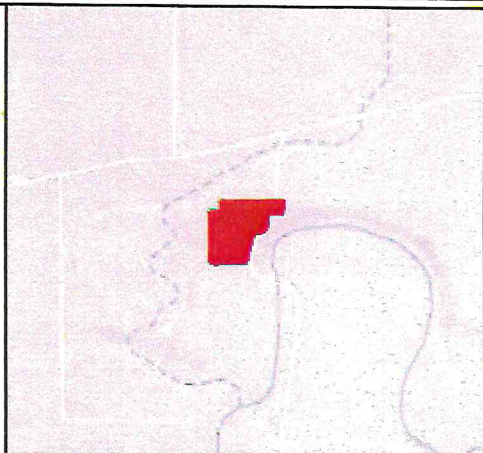



# KSI LABORATORIES

202 S. DACEY DR., SHELBYVILLE, ILLINOIS 62565  
PHONE (217) 774-2421  
www.KSILab.com



Since 1983

Operator: Scott O'Neill  
Field: ERWIN 12  
Acres: 10.9

Field ID: 186250  
Date: 05/23/2023  
Submitted By: ASC (OGDEN)

Legend	
	Below 5.9 Avg: Acres: 0.0
	5.9 - 6.1 Avg: Acres: 0.0
	6.2 - 6.5 Avg: 6.4 Acres: 10.9
	6.6 and Above Avg: Acres: 0.0

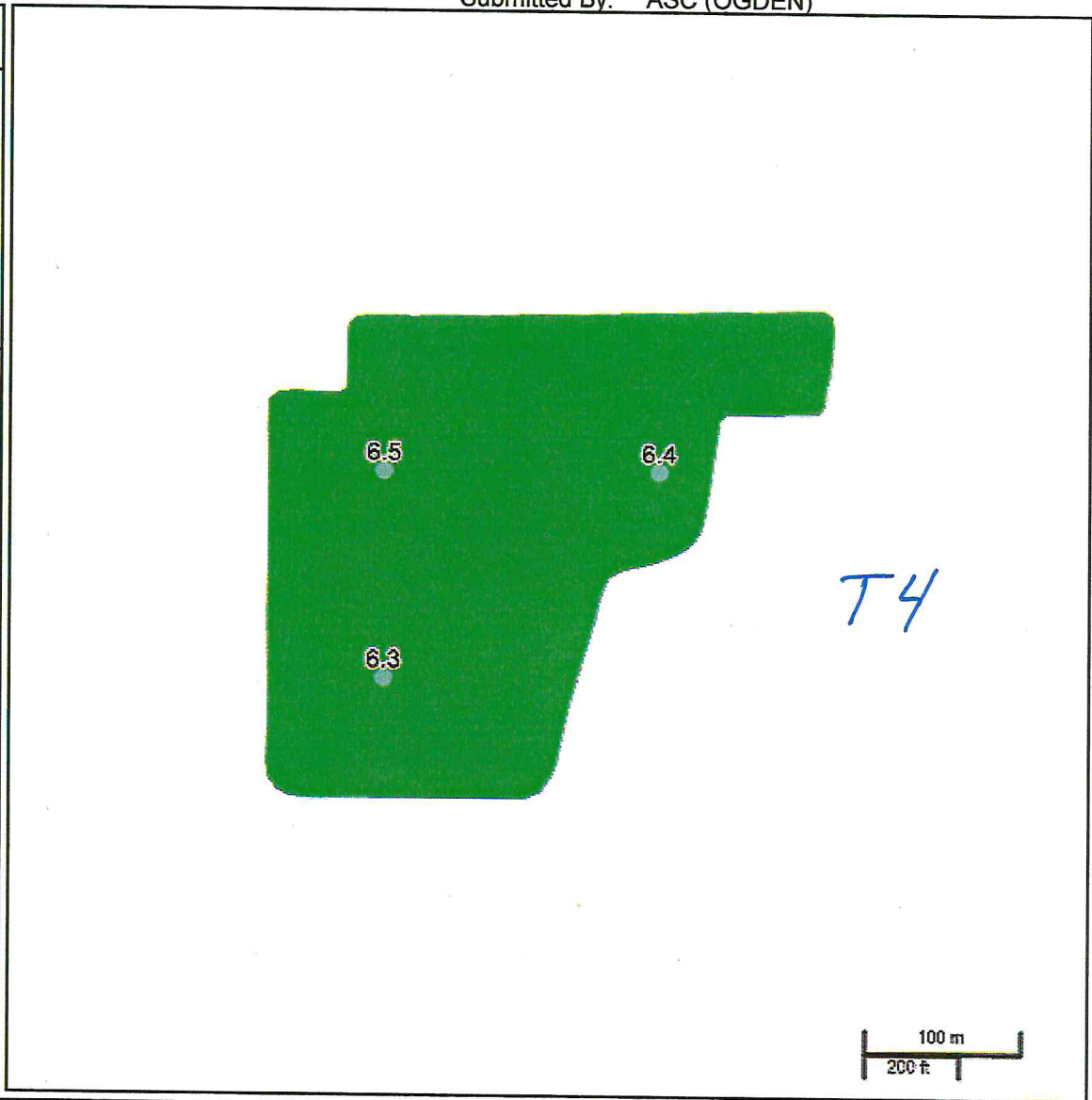

Latitude: 40.075502  
Longitude: -87.917677  
Grid Size: 440nsx330ew

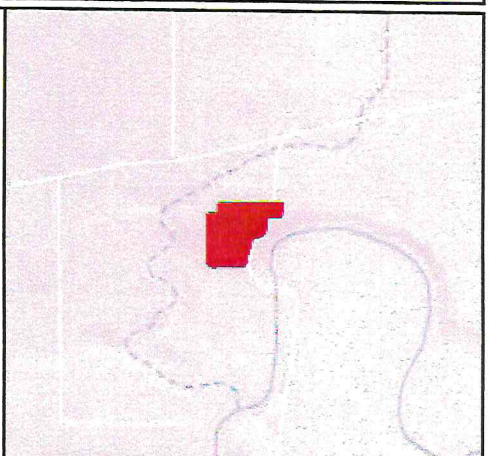
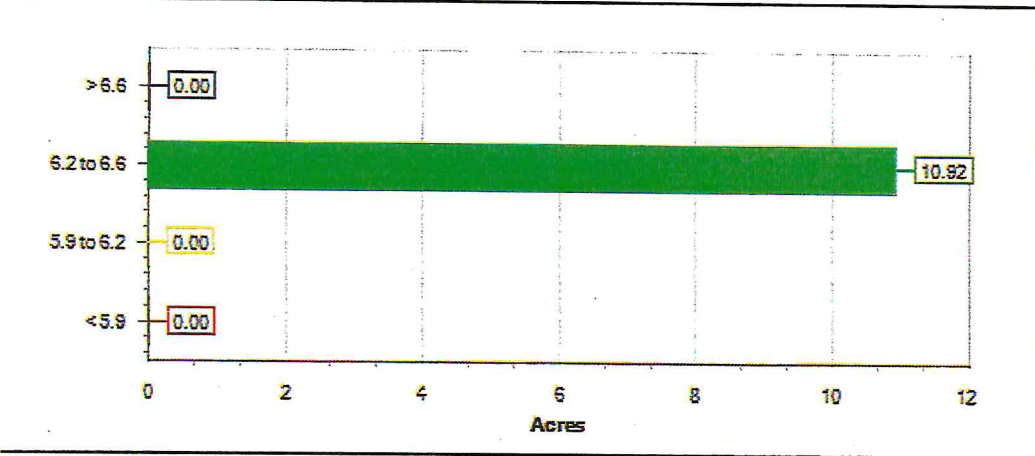



# KSI LABORATORIES

202 S. DACEY DR., SHELBYVILLE, ILLINOIS 62565  
PHONE (217) 774-2421  
www.KSILab.com



Since 1983

Operator: Scott O'Neill  
Field: ERWIN 12  
Acres: 10.9

Field ID: 186250  
Date: 05/23/2023  
Submitted By: ASC (OGDEN)

### Legend

- Under 40  
Avg: 29 Acres: 3.8
- 40 - 49  
Avg: 47 Acres: 4.9
- 50 - 65  
Avg: 51 Acres: 2.2
- Above 65  
Avg: Acres: 0.0

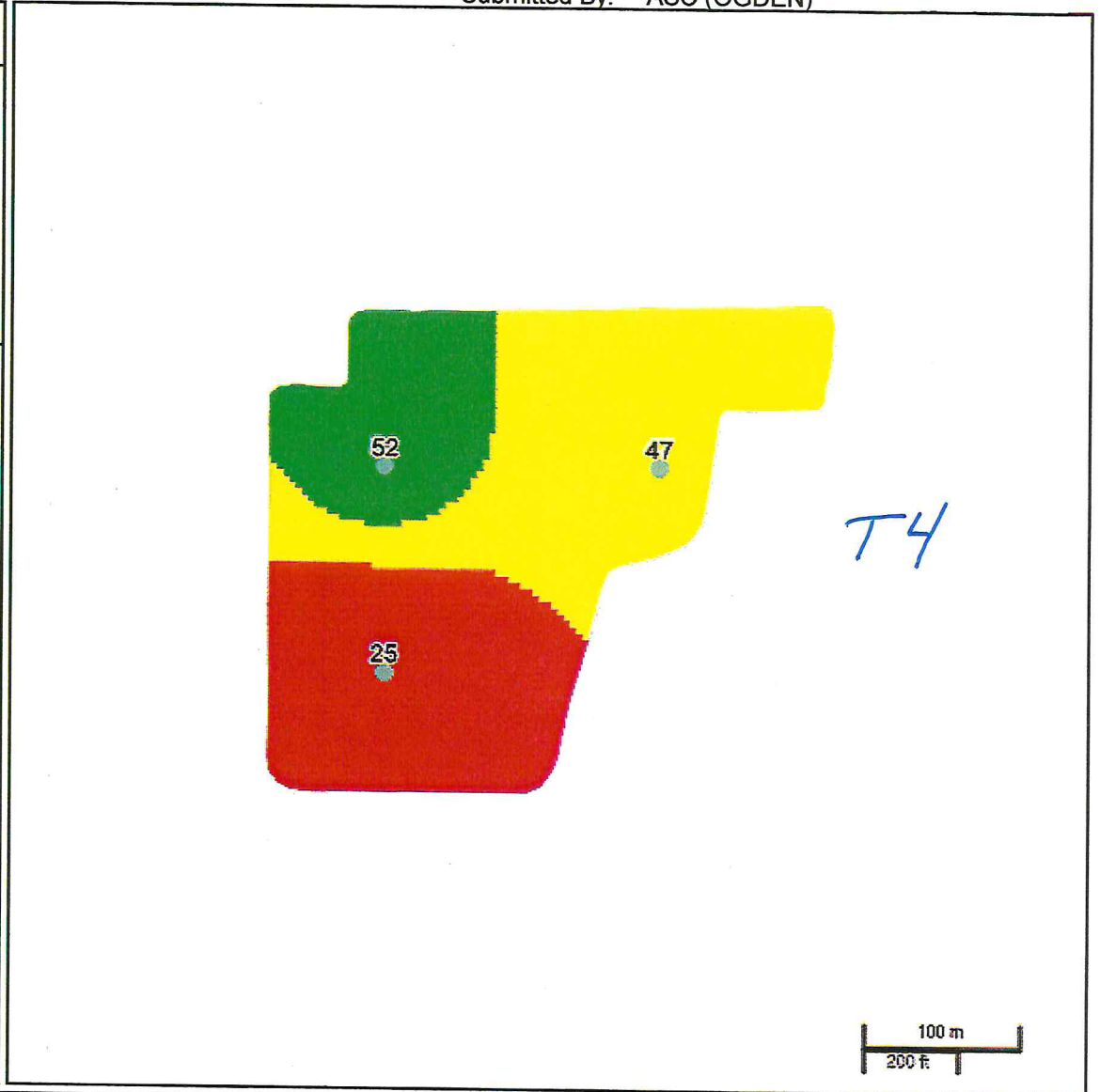

Latitude: 40.075502  
Longitude: -87.917677  
Grid Size: 440nsx330ew

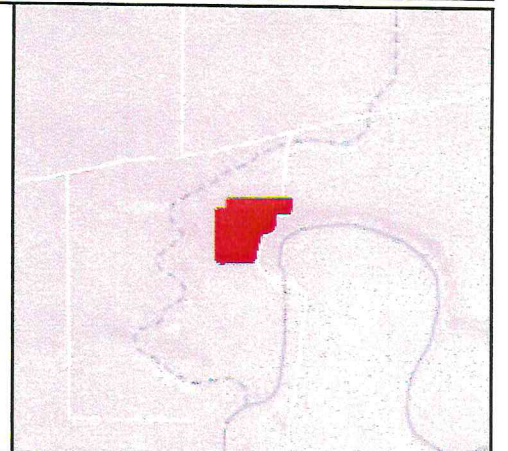
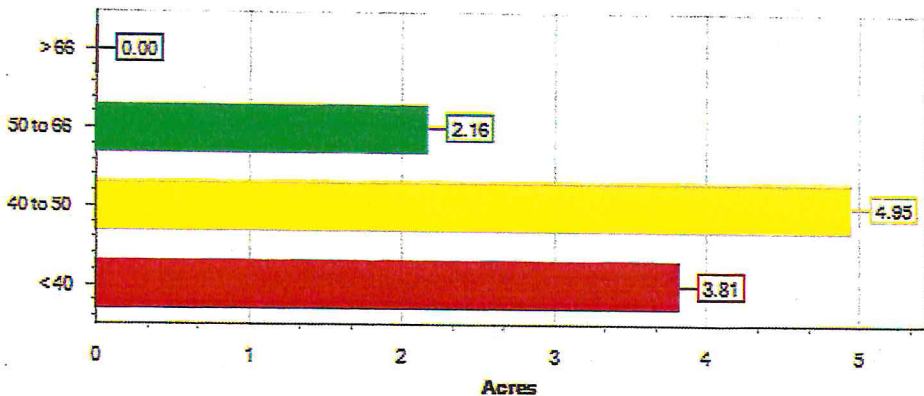





# KSI LABORATORIES

202 S. DACEY DR., SHELBYVILLE, ILLINOIS 62565  
PHONE (217) 774-2421  
www.KSILab.com



Since 1983

Operator: Scott O'Neill  
Field: ERWIN 12  
Acres: 10.9

Field ID: 186250  
Date: 05/23/2023  
Submitted By: ASC (OGDEN)

**Legend**

**K Map**

- Below 260  
Avg: 215 Acres: 5.5
- 260 - 319  
Avg: 263 Acres: 5.4
- 320 - 399  
Avg: Acres: 0.0
- 400 and Above  
Avg: Acres: 0.0

---

**Latitude:** 40.075502  
**Longitude:** -87.917677  
**Grid Size:** 440nsx330ew

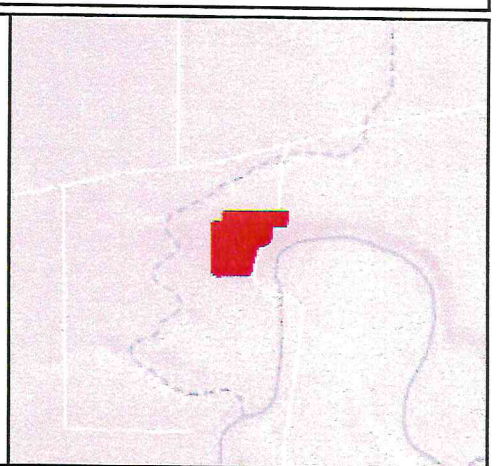
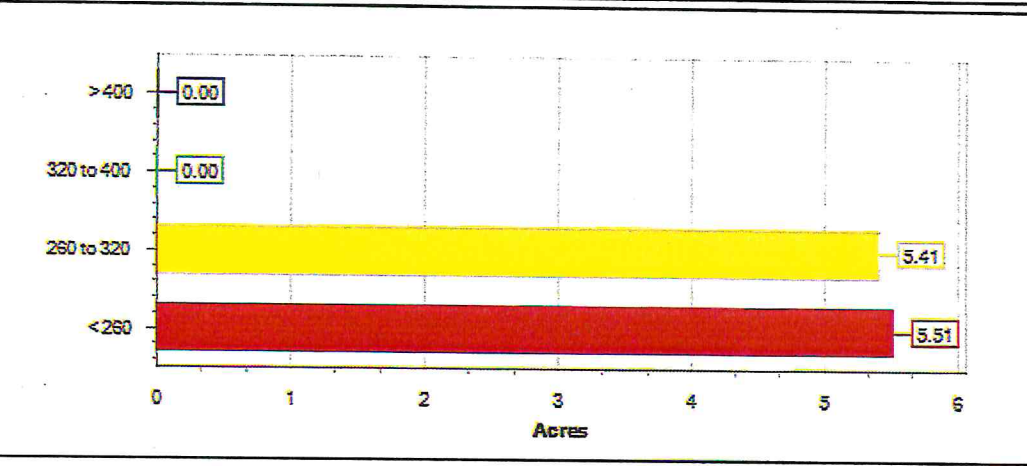
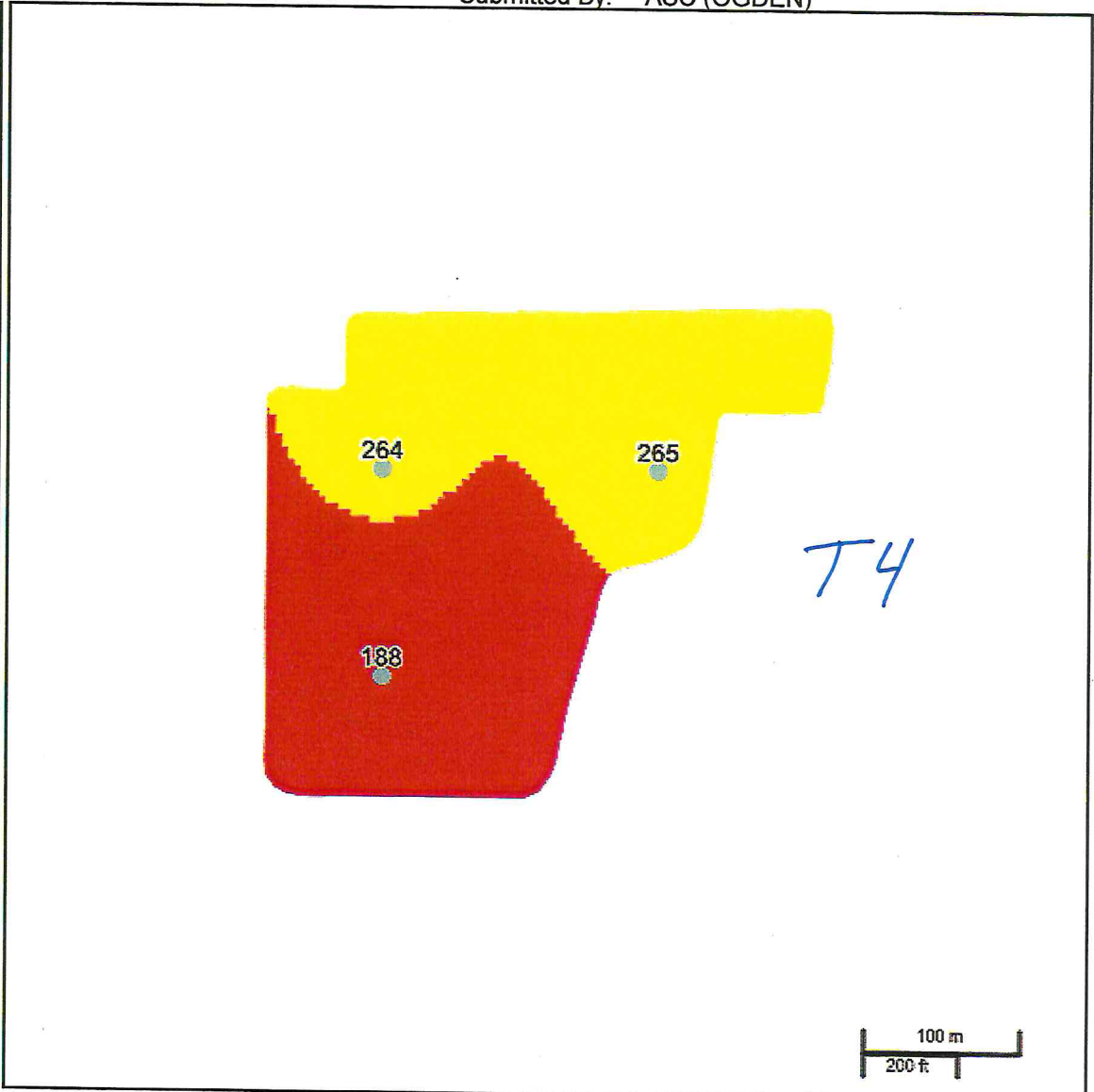





# KSI LABORATORIES

202 S. DACEY DR., SHELBYVILLE, ILLINOIS 62565

PHONE (217) 774-2421

www.KSILab.com

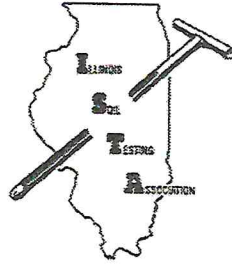

OPERATOR: SCOTT ONEILL  
 FIELD: ERWIN 12  
 ACRES: 10.9

LAB#: 90867-69 (8177)  
 DATE: 05/18/2023  
 SUBMITTED BY: ASC OGDEN

T4

## SOIL TEST RESULTS

SAMPLE#	SOIL pH	BUFFER pH	PHOSPHORUS lbs/A	POTASSIUM lbs/A	CALCIUM lbs/A	MAGNESIUM lbs/A	ORGANIC MATTER %	CATION EXCHANGE CAPACITY	BASE SATURATION			
									%Ca	%Mg	%K	%H
1	6.4	7.0	47	265	3066	322	2.2	10.6	72.4	12.7	3.3	11.7
2	6.5	7.0	52	264	3617	363	2.5	12.1	74.8	12.6	2.8	9.8
3	6.3	7.0	25	188	3186	352	2.3	11.2	71.2	13.1	2.2	13.5
AVERAGE	6.4	7.0	41	239	3290	346	2.3	11.3	72.8	12.8	2.8	11.7
PH AVE.	6.4	EXTRACTED SAMPLES:										
P1 AVE.	41	EXTRACTED SAMPLES:										
K AVE.	239	EXTRACTED SAMPLES:										
MICRO NUTRIENT TEST RESULTS												
SAMPLE	S Lbs/a	Zn Lbs/a	Fe Lbs/a	Mn Lbs/a	Cu Lbs/a	B Lbs/a	Na Lbs/a	SALT mmhos	NO3 PPM	NH4 PPM		
1	29	9.9	113	163	3.2	1.1	27	-	-	-		
2	22	7.6	99	96	3.8	1.0	26	-	-	-		
3	19	7.6	104	146	3.1	0.9	29	-	-	-		
Average	23	8.4	105	135	3.4	1.0	27	-	-	-		