



UNDEFINED FARM (30.00 AC TOTAL, 0 AC TILLABLE)

AERIAL MAP



Center: 34.190062, -91.919882

21-6S-8W

Victoria Township
Jefferson County, AR



FarmWorth, LLC makes no representations or warranties, express or implied, as to the accuracy of any information, data, numerical values, boundaries, or any other information generated through the use of FarmWorth.com. User is solely responsible for independently investigating and determining all information provided through FarmWorth.com prior to use and waives any and all claims against FarmWorth, LLC for any inaccuracies or inconsistencies in the information and/or data.



UNDEFINED FARM (30.00 AC TOTAL, 0 AC TILLABLE)

TOTAL SOILS

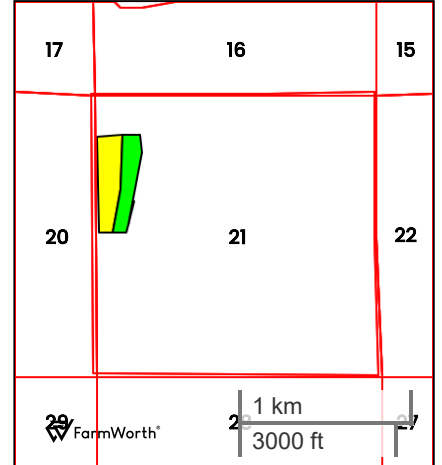

County: **Jefferson County, AR**
 Location: **21-6S-8W**
 Township: **Victoria**
 Acres: **30.00**
 Date: **01/05/2025**



Field borders obtained from Farm Service Agency as of 2008

FarmWorth, LLC makes no representations or warranties, express or implied, as to the accuracy of any information, data, numerical values, boundaries, or any other information generated through the use of FarmWorth.com. User is solely responsible for independently investigating and determining all information provided through FarmWorth.com prior to use and waives any and all claims against FarmWorth, LLC for any inaccuracies or inconsistencies in the information and/or data.

Code	Description	Acres	% of field	Overall NCCPI	Soil Class (Irr)	Soil Class (Non-Irr)	Drainage Class
30	Portland clay, 0 to 1 percent slopes	17.02	56.73 %	56	-	3	Somewhat poorly drained
49	Wabbaseka-Latanier complex, undulating	12.99	43.30 %	74	-	3	Moderately well drained
Average:				63.8			

Soils data provided by USDA and NRCS.



UNDEFINED FARM (30.00 AC TOTAL, 0 AC TILLABLE)

FLOOD HAZARDS



FarmWorth, LLC makes no representations or warranties, express or implied, as to the accuracy of any information, data, numerical values, boundaries, or any other information generated through the use of FarmWorth.com. User is solely responsible for independently investigating and determining all information provided through FarmWorth.com prior to use and waives any and all claims against FarmWorth, LLC for any inaccuracies or inconsistencies in the information and/or data.

Significant Flood Hazards

- Regulatory Floodway (Zones AE, AO, AH, VE, AR)
- Without Base Flood Elevation (BFE), with BFE or Depth (Zones A, V, A99)









UNDEFINED FARM (30.00 AC TOTAL, 0 AC TILLABLE)

ENERGY MAP



FarmWorth, LLC makes no representations or warranties, express or implied, as to the accuracy of any information, data, numerical values, boundaries, or any other information generated through the use of FarmWorth.com. User is solely responsible for independently investigating and determining all information provided through FarmWorth.com prior to use and waives any and all claims against FarmWorth, LLC for any inaccuracies or inconsistencies in the information and/or data.

-  Transmission Lines
-  Substations
-  Wind Turbine
-  Wind Farm
-  Solar
-  Oil and Gas(Active)
-  Oil and Gas(Abandoned)



UNDEFINED FARM (30.00 AC TOTAL, 0 AC TILLABLE)

PLAT MAP

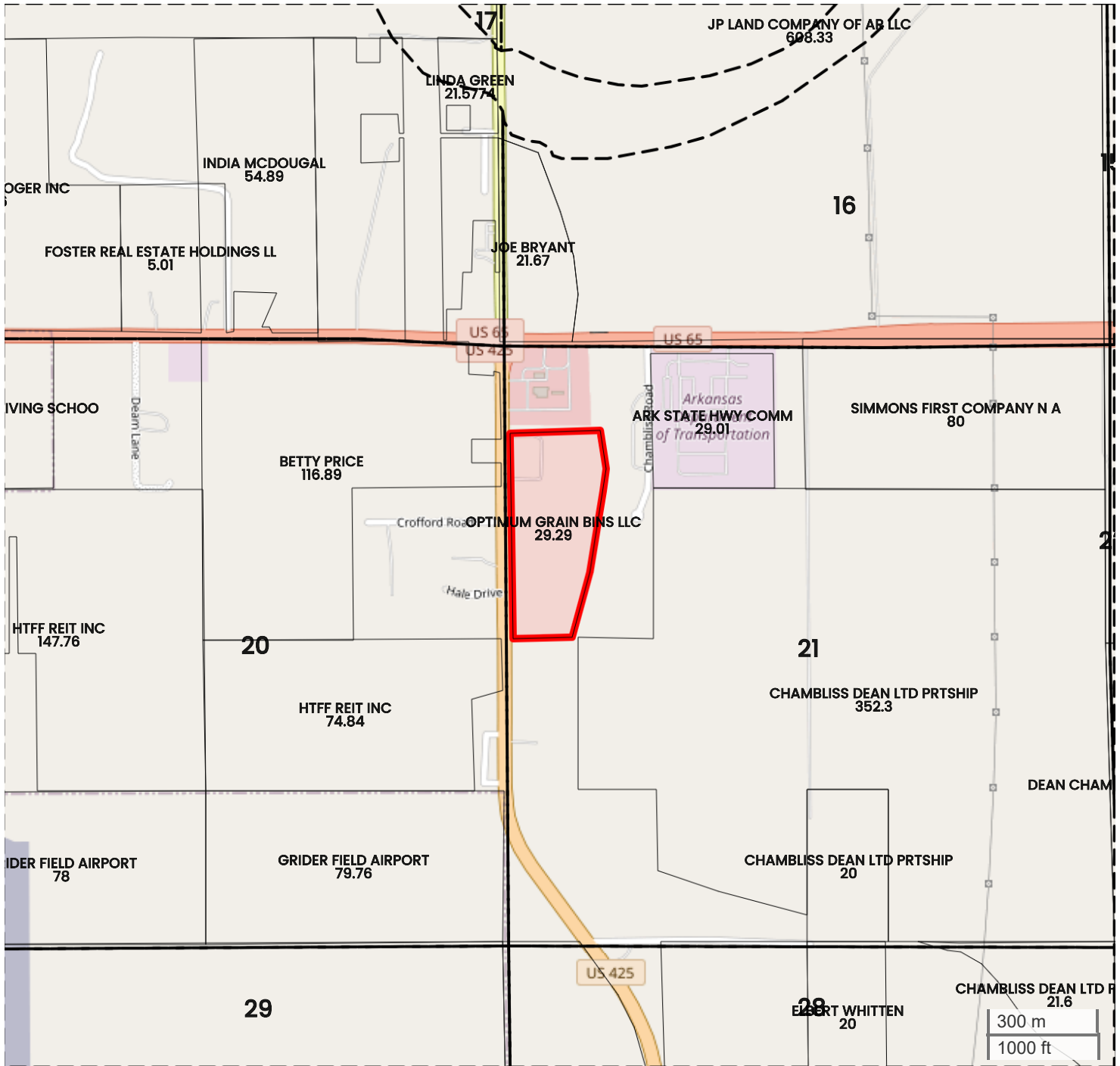

Center: 34.190043, -91.919861

21-6S-8W

Victoria Township Jefferson County, AR



FarmWorth, LLC makes no representations or warranties, express or implied, as to the accuracy of any information, data, numerical values, boundaries, or any other information generated through the use of FarmWorth.com. User is solely responsible for independently investigating and determining all information provided through FarmWorth.com prior to use and waives any and all claims against FarmWorth, LLC for any inaccuracies or inconsistencies in the information and/or data.



UNDEFINED FARM (30.00 AC TOTAL, 0 AC TILLABLE)

PROXIMITY MAP



FarmWorth, LLC makes no representations or warranties, express or implied, as to the accuracy of any information, data, numerical values, boundaries, or any other information generated through the use of FarmWorth.com. User is solely responsible for independently investigating and determining all information provided through FarmWorth.com prior to use and waives any and all claims against FarmWorth, LLC for any inaccuracies or inconsistencies in the information and/or data.



UNDEFINED FARM (30.00 AC TOTAL, 0 AC TILLABLE)

REGIONAL MAP

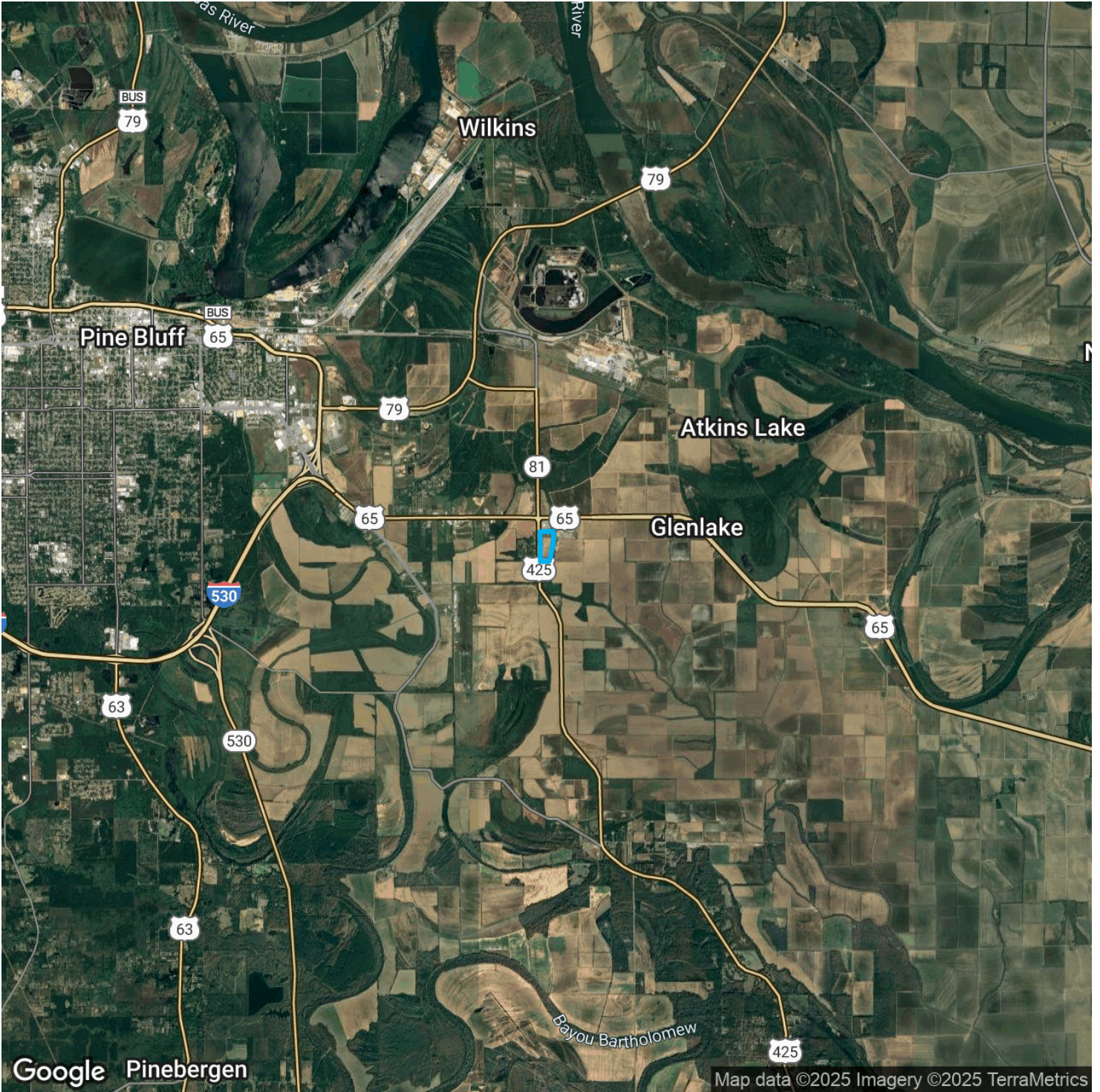

Google Pinebergen

Map data ©2025 Imagery ©2025 TerraMetrics



FarmWorth, LLC makes no representations or warranties, express or implied, as to the accuracy of any information, data, numerical values, boundaries, or any other information generated through the use of FarmWorth.com. User is solely responsible for independently investigating and determining all information provided through FarmWorth.com prior to use and waives any and all claims against FarmWorth, LLC for any inaccuracies or inconsistencies in the information and/or data.



UNDEFINED FARM (30.00 AC TOTAL, 0 AC TILLABLE)

FARMLAND INSIGHTS

Farmland Statistics for Jefferson County, AR for 2023

	Attribute	Year	Value
AR Average	Farmland Value (\$/ac)	2023	\$3,460
	Cash Rent (\$/ac)	2023	\$119
	Farmland Returns (%)	2023	6.85%
Jefferson County Average	Price (\$/ac)	2023	\$4,102
	Cash Rent (\$/ac)	2023	\$159/ac
	National Productivity Index (NCCPI3 All Crops)	2023	NaN

RMA Statistics for Jefferson County, AR for 2022

Top Crops	Year	Expected Yield (bu/ac)	APA Trend Adjustment (bu/year)
Wheat	2022	48.7	0.38
Cotton	2022	0	0
Corn	2022	179.2	1.65

Crop yields for top crops from 1972 onwards

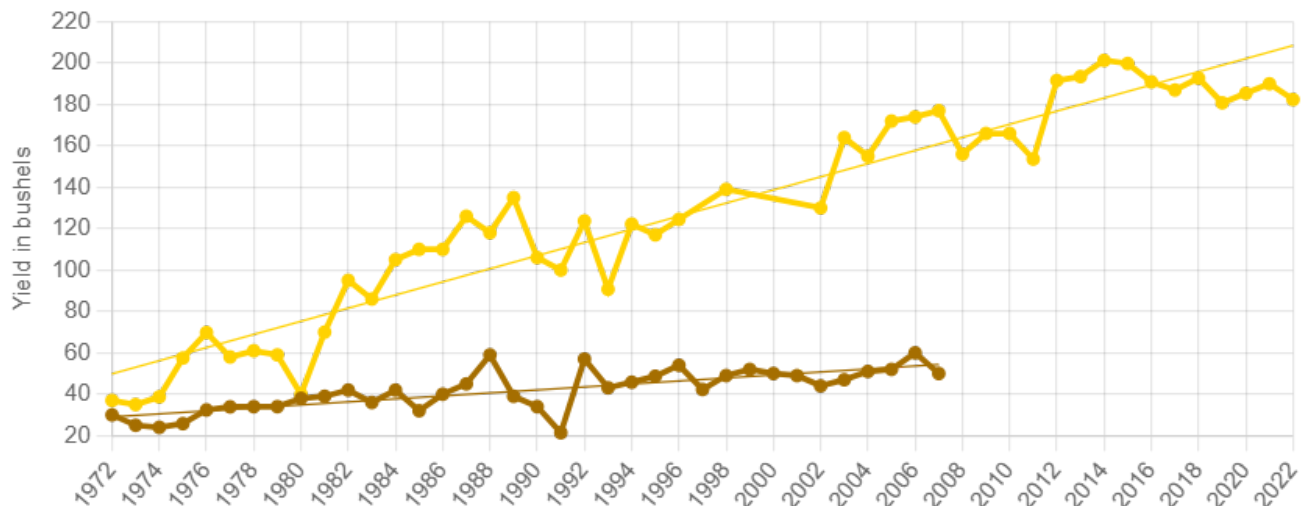

FarmWorth, LLC makes no representations or warranties, express or implied, as to the accuracy of any information, data, numerical values, boundaries, or any other information generated through the use of FarmWorth.com. User is solely responsible for independently investigating and determining all information provided through FarmWorth.com prior to use and waives any and all claims against FarmWorth, LLC for any inaccuracies or inconsistencies in the information and/or data.