

Soils Map

Boundary Lines Are Approximate

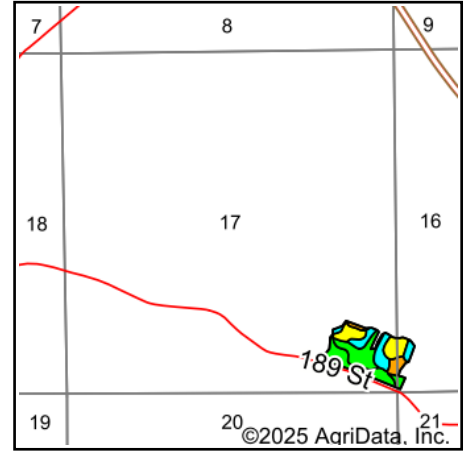
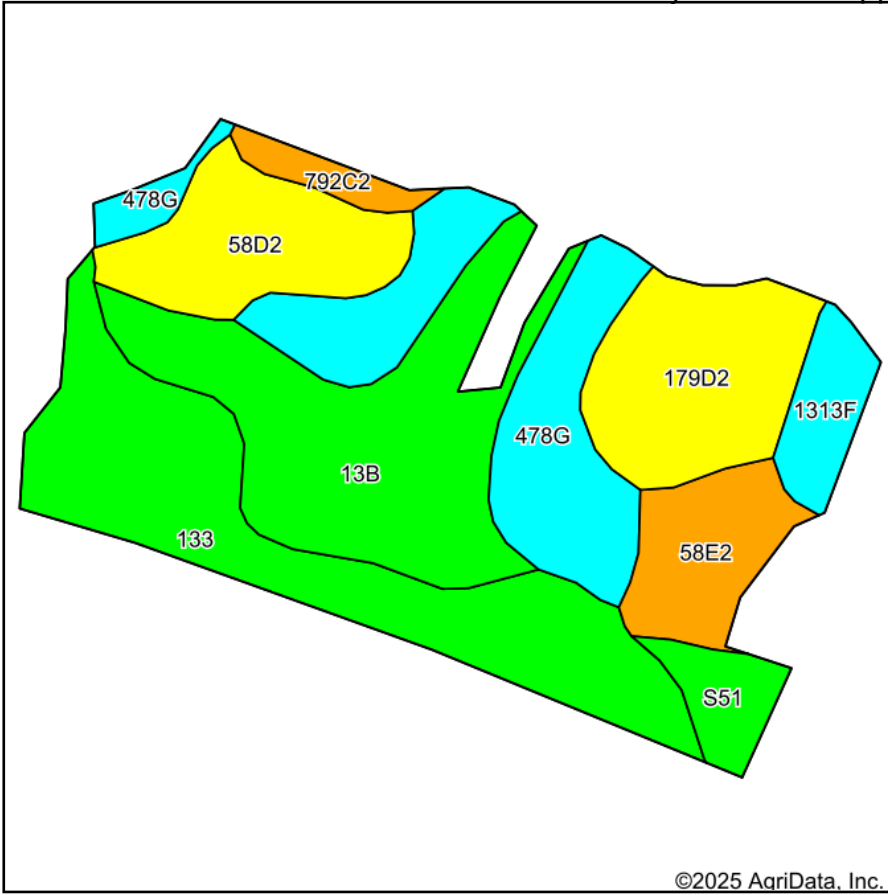

State: **Iowa**
 County: **Monroe**
 Location: **17-72N-17W**
 Township: **Troy**
 Acres: **19.23**
 Date: **1/29/2025**

Hawkeye Farm Mgmt & Real Estate

 22 N Main, Albia IA Phone: 641-932-7796
 Email: hawkeye@uciowa.com
 On the web: www.uciowa.com
www.iowawhitetailfarms.com

Maps Provided By:

 CUSTOMIZED ONLINE MAPPING
 © AgriData, Inc. 2023 www.AgriDataInc.com



Soils data provided by USDA and NRCS.

Area Symbol: IA135, Soil Area Version: 32

Code	Soil Description	Acres	Percent of field	CSR2 Legend	Non-Irr Class *c	CSR2**	CSR	*n NCCPI Corn	*n NCCPI Soybeans		
133	Colo silty clay loam, heavy till, 0 to 2 percent slopes, occasionally flooded	4.43	23.1%			Ilw	78	85	94	86	
13B	Olmitz-Colo-Vesser complex, 2 to 5 percent slopes	4.19	21.8%			Ilw	82	60	70	71	
478G	Munterville-Rock outcrop complex, 14 to 40 percent slopes	3.41	17.7%			Vlle	5	5	13	6	
179D2	Gara loam, 9 to 14 percent slopes, moderately eroded	2.25	11.7%			IVe	43	43	70	53	
58D2	Douds loam, heavy loess, 9 to 14 percent slopes, moderately eroded	1.91	9.9%			IVe	44	28	81	63	
58E2	Douds loam, heavy loess, 14 to 18 percent slopes, moderately eroded	1.32	6.9%			Vle	34	18	76	57	
1313F	Munterville silt loam, 18 to 25 percent slopes	0.73	3.8%			Vlle	11	5	49	33	
S51	Vesser silt loam, 0 to 2 percent slopes, occasionally flooded	0.62	3.2%			Ilw	75		75	94	
792C2	Armstrong loam, 5 to 9 percent slopes, moderately eroded	0.37	1.9%			Ille	31	27	65	47	
Weighted Average							3.80	51.9	*-	*n 66.2	*n 57.9

**IA has updated the CSR values for each county to CSR2.

*- CSR weighted average cannot be calculated on the current soils data, use prior data version for csr values.

*n: The aggregation method is "Weighted Average using all components"

*c: Using Capabilities Class Dominant Condition Aggregation Method