

# Soils Map

\*Boundary Lines Are Approximate - Map Includes Parts of 189th Street and 2 Railroads\*

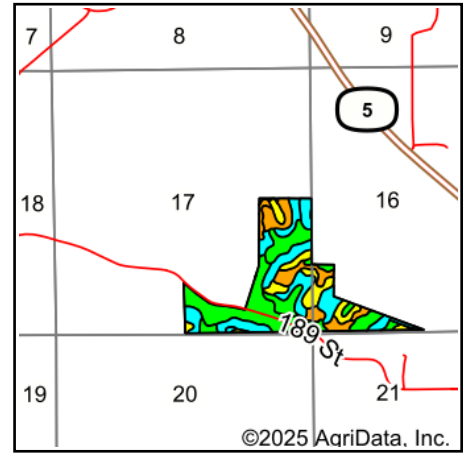
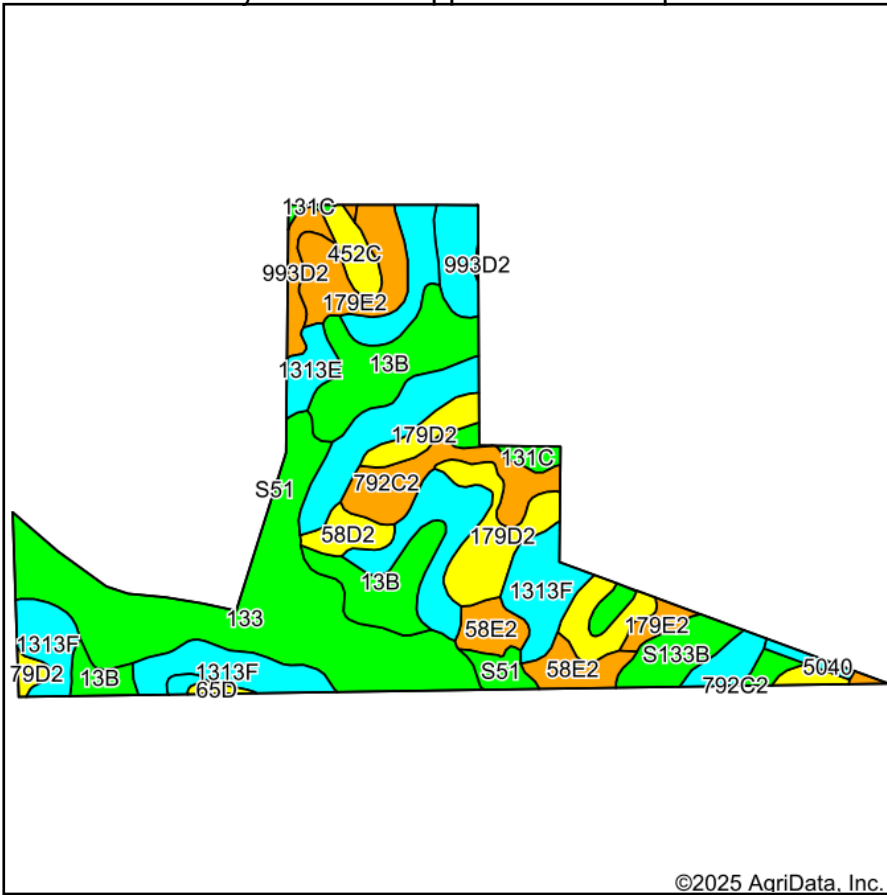

State: **Iowa**  
 County: **Monroe**  
 Location: **17-72N-17W**  
 Township: **Troy**  
 Acres: **113.98**  
 Date: **1/29/2025**

**Hawkeye Farm Mgmt & Real Estate**

**United Country Real Estate**  
 22 N Main, Albia IA Phone: 641-932-7796  
 Email: hawkeye@uciowa.com  
 On the web: www.uciowa.com; www.iowawhitealfarms.com

Maps Provided By:  
**surety**  
 CUSTOMIZED ONLINE MAPPING  
 © AgriData, Inc. 2023 www.AgriDataInc.com



Soils data provided by USDA and NRCS.

Area Symbol: IA135, Soil Area Version: 32

Code	Soil Description	Acres	Percent of field	CSR2 Legend	Non-Irr Class *c	CSR2**	CSR	*n NCCPI Corn	*n NCCPI Soybeans
133	Colo silty clay loam, heavy till, 0 to 2 percent slopes, occasionally flooded	25.07	22.0%		Ilw	78	85	94	86
1313F	Munterville silt loam, 18 to 25 percent slopes	16.73	14.7%		Vlle	11	5	49	33
478G	Munterville-Rock outcrop complex, 14 to 40 percent slopes	14.03	12.3%		Vlle	5	5	13	6
13B	Olmitz-Colo-Vesser complex, 2 to 5 percent slopes	13.83	12.1%		Ilw	82	60	70	71
179D2	Gara loam, 9 to 14 percent slopes, moderately eroded	11.14	9.8%		IVe	43	43	70	53
179E2	Gara loam, 14 to 18 percent slopes, moderately eroded	6.60	5.8%		Vle	35	33	68	51
792C2	Armstrong loam, 5 to 9 percent slopes, moderately eroded	5.41	4.7%		Ille	31	27	65	47
58E2	Douds loam, heavy loess, 14 to 18 percent slopes, moderately eroded	4.36	3.8%		Vle	34	18	76	57
S133B	Colo silty clay loam, heavy till, 2 to 5 percent slopes, rarely flooded	3.31	2.9%		Ilw	80		95	83
131C	Pershing silt loam, 5 to 9 percent slopes	3.05	2.7%		Ille	65	49	72	58
1313E	Munterville silt loam, 14 to 18 percent slopes	2.01	1.8%		Vlle	25	10	53	43
993D2	Gara-Armstrong loams, 9 to 14 percent slopes, moderately eroded	1.95	1.7%		IVe	35	20	66	48
58D2	Douds loam, heavy loess, 9 to 14 percent slopes, moderately eroded	1.91	1.7%		IVe	44	28	81	63
452C	Lineville silt loam, 5 to 9 percent slopes	1.86	1.6%		Ille	48	35	75	59

Soils data provided by USDA and NRCS.



Code	Soil Description	Acres	Percent of field	CSR2 Legend	Non-Irr Class *c	CSR2**	CSR	*n NCCPI Corn	*n NCCPI Soybeans
S51	Vesser silt loam, 0 to 2 percent slopes, occasionally flooded	1.36	1.2%		Ilw	75		75	94
5040	Anthropotic Udorthents, 2 to 9 percent slopes	0.63	0.6%		Vls	5	5	79	66
65D	Lindley loam, 9 to 14 percent slopes	0.37	0.3%		IVe	43	40	74	63
65G	Lindley loam, 18 to 40 percent slopes	0.36	0.3%		Vlle	6	5	21	11
<b>Weighted Average</b>						<b>4.22</b>	<b>46</b>	<b>*n 65.7</b>	<b>*n 54.9</b>

\*\*IA has updated the CSR values for each county to CSR2.

\*- CSR weighted average cannot be calculated on the current soils data, use prior data version for csr values.

\*n: The aggregation method is "Weighted Average using all components"

\*c: Using Capabilities Class Dominant Condition Aggregation Method