

Soils Map

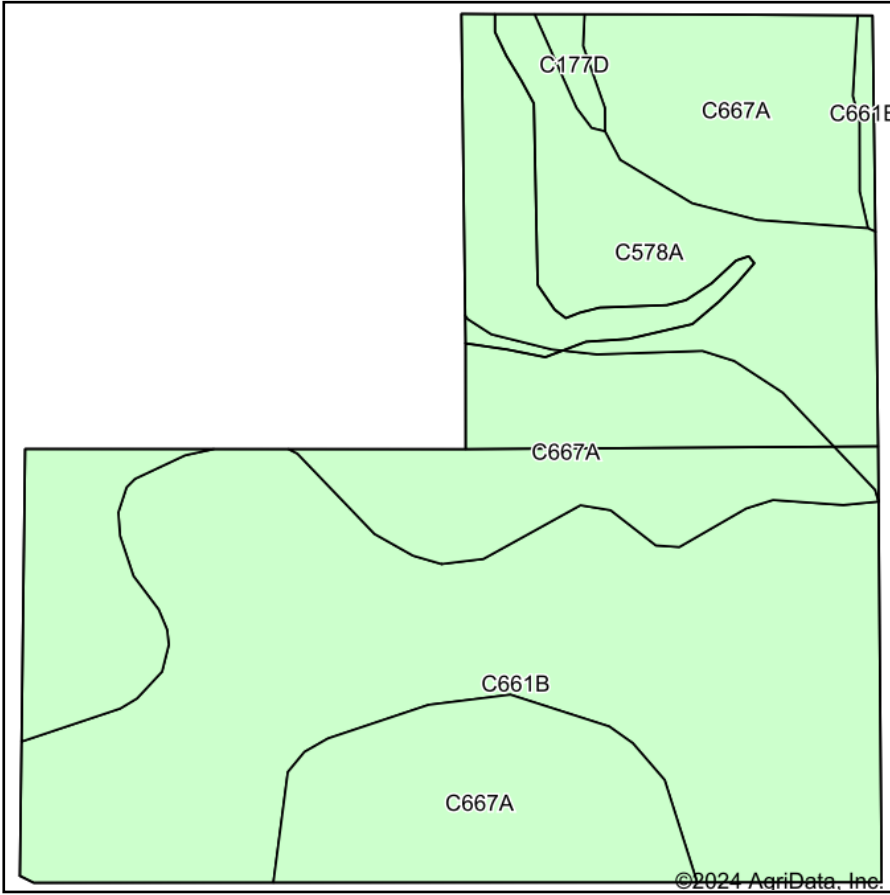

Soils data provided by USDA and NRCS.

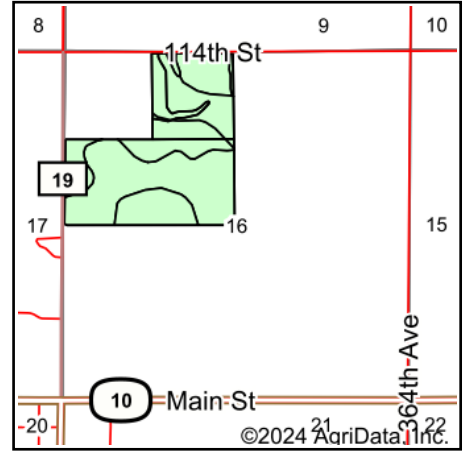

State: **South Dakota**
 County: **McPherson**
 Location: **16-126N-67W**
 Township: **Central McPherson**
 Acres: **112.93**
 Date: **12/4/2024**

ADVANTAGE
Land Co.

Maps Provided By:

 © AgriData, Inc. 2023 www.AgriDataInc.com



Area Symbol: SD089, Soil Area Version: 25

Code	Soil Description	Acres	Percent of field	Non-Irr Class *c	Productivity Index
C661B	Niobell-Noonan loams, 3 to 6 percent slopes	48.37	42.8%	IIIe	60
C667A	Williams-Niobell loams, 0 to 3 percent slopes	45.11	39.9%	IIc	81
C578A	Ranslo-Harriet loams, 0 to 2 percent slopes, occasionally flooded	18.69	16.6%	VIIs	29
C177D	Williams-Zahl-Bowbells loams, 3 to 15 percent slopes	0.76	0.7%	IIIe	61
Weighted Average				3.10	63.3

*c: Using Capabilities Class Dominant Condition Aggregation Method