

# Soils Map

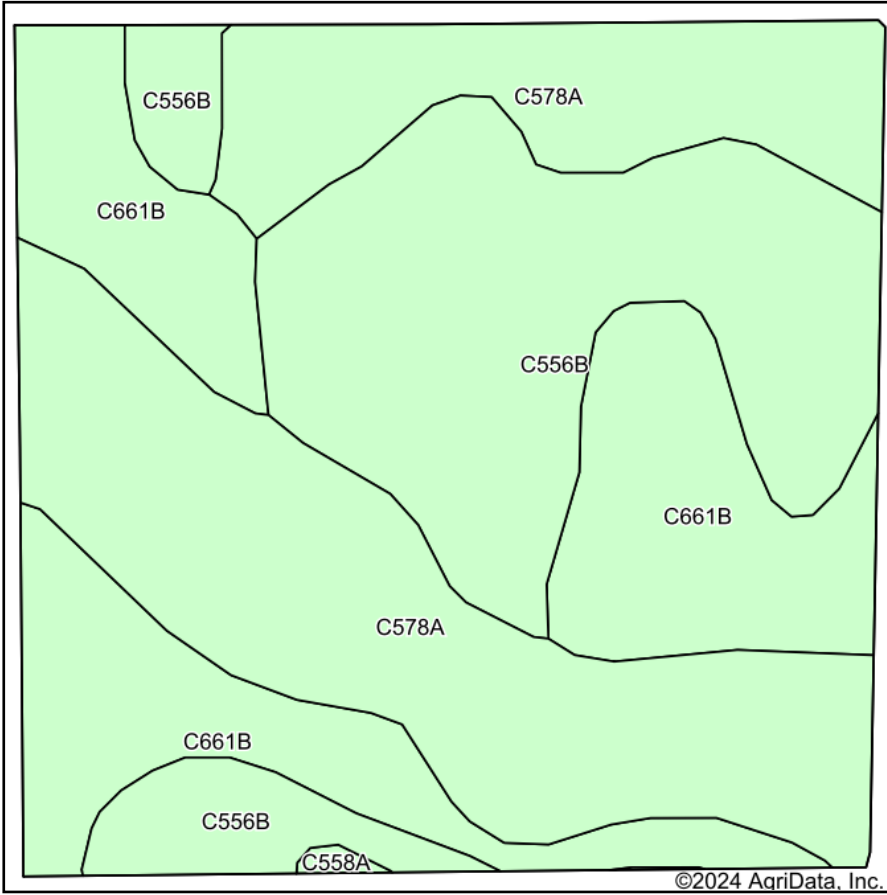

Soils data provided by USDA and NRCS.

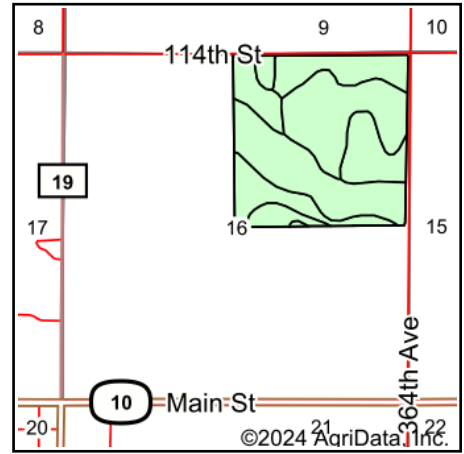

State: **South Dakota**  
 County: **McPherson**  
 Location: **16-126N-67W**  
 Township: **Central McPherson**  
 Acres: **154.9**  
 Date: **12/4/2024**

**ADVANTAGE**  
*Land Co.*

Maps Provided By:



Area Symbol: SD089, Soil Area Version: 25

Code	Soil Description	Acres	Percent of field	Non-Irr Class *c	Productivity Index
C578A	Ranslo-Harriet loams, 0 to 2 percent slopes, occasionally flooded	60.49	39.1%	VI <sub>s</sub>	29
C556B	Noonan-Miranda loams, 0 to 6 percent slopes	49.45	31.9%	IV <sub>s</sub>	42
C661B	Niobell-Noonan loams, 3 to 6 percent slopes	44.58	28.8%	III <sub>le</sub>	60
C558A	Miranda-Heil complex, 0 to 3 percent slopes	0.38	0.2%	VI <sub>s</sub>	31
<b>Weighted Average</b>				<b>4.50</b>	<b>42.1</b>

\*c: Using Capabilities Class Dominant Condition Aggregation Method