

TURNER SURVEYING CO., L.L.C.  
 P.O. BOX 832 724 S. MAIN  
 QUITMAN, TX 75783  
 903-763-2949 FAX 903-763-2019

**J. M. CANDLER SURVEY  
 A-102  
 WOOD COUNTY, TEXAS**

WOOD COUNTY  
 ROAD No. 387B  
 (30')

POINT OF  
 BEGINNING



CALLLED 0.482 ACRES  
 ROBERT L. TUNE  
 TO  
 ANITA CASTELLANOS  
 1884/312 10-04-02

ENCROACHMENT  
 SEE INSET

CALLLED 478 ACRES  
 PAUL H. MCKNIGHT, TRUSTEE  
 TO  
 W. B. CLIFTON  
 530/252 07-15-84

CALLLED 50 ACRES  
 L. A. WOODS & CORDA WOODS  
 TO  
 W. B. CLIFTON  
 572/497 11-30-65

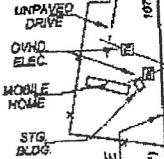

**20.961 ACRES**

CALLLED 1.693 ACRES TRACT TWO  
 RICH RUSSO & TIFFANY RUSSO  
 TO  
 JOHNNY WHITAKER & CINDY WHITAKER  
 2072/585 04-06-05

(11.55 AC.)

(9.41 AC.)

CALLLED 74.50 ACRES TO  
 W. B. CLIFTON  
 MICHAEL SPRING PEACHY  
 1186/910 04-10-82

SET 1/2" IRON ROD  
 AT FENCE INT.

SET 1/2" IRON ROD  
 22" PINE (NOT MARKED)  
 BR'S 3 89'43" W 17' 8"  
 18" BLK (NOT MARKED)  
 BR'S N 33'18" W 10.8'

SET 1/2" IRON ROD  
 AT X-THE FND INT.

(CRSD WEST 454.24 = 1272.18')

S 89°41'52"W

1268.10'

**D. WATKINS SURVEY  
 A-628  
 WOOD COUNTY, TEXAS**

CALLLED 304.20 ACRES  
 JERRY D. FULTS & BETTY ANN FULTS  
 TO  
 WILLIAM S. MARSH  
 712/735 12-19-75

NOTE  
 SEE "FIELD NOTES 20.961 ACRES" W6067-47.DAT OF EVEN  
 DATE HEREWITH FOR A WRITTEN DESCRIPTION OF THE  
 ABOVE TRACT.

CAO FILE: W6067-47.ZAK DISK3

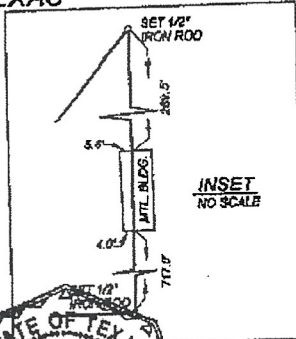

INSET  
 NO SCALE

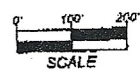

SCALE

We, Turner Surveying Co., L.L.C., do hereby certify that this plat was prepared from an actual survey made on the ground under our supervision during the month of September, 2003.

There are no discrepancies, apparent conflicts, shortages in area, visible boundary line conflicts, encroachments, or overlapping of improvements, no visible easements or rights-of-way, except as shown hereon.

The improvements on this tract do not lie within the limits of a "Special Flood Hazard Area" as defined by FLOOD HAZARD BOUNDARY MAP, COMMUNITY PANEL No. 48 (ISS. 0009 A, effective date May 31, 1977).

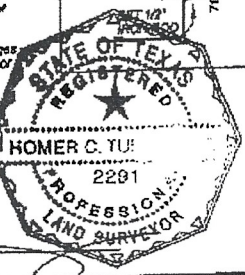

**PLAT SHOWING SURVEY OF  
 MIKE PEACHY TRACT**

TURNER SURVEYING CO., L.L.C.  
 QUITMAN, TEXAS

DATE: 09-29-05 SCALE: AS NOTED W6067-47.DAT

Homer C. Turner, Jr. R.P.L.S. No. 2291

**TURNER SURVEYING COMPANY, LLC**

P. O. BOX 632  
QUITMAN, TEXAS 75783  
TELE 903 763 2949 FAX 903 763 2019

FIELD NOTES 20.961 ACRES  
J. M. CANDLER SURVEY A-102  
D. WATKINS SURVEY A-628  
WOOD COUNTY, TEXAS  
(PEACHY W6057-47.DAT)

BEING all of that certain lot, tract, or parcel of land situated in the J. M. Candler Survey, Abstract No. 102, and the D. Watkins Survey, Abstract No. 628, all in Wood County, Texas and being all of a called 21.59 acre tract described in a Deed from W. B. Clifton to Michael Peachy and wife Connie Sue Peachy dated October 10, 2000 as shown of record in Volume 1766, Page 510, Real Property Records, Wood County, Texas, said 21.59 acre tract being a part of a called 50 acre tract described in a Deed from L. A. Woods and wife Corda Woods to W. B. Clifton dated November 30, 1966 as shown of record in Volume 572, Page 497, Deed Records, Wood County, Texas, said lot, tract, or parcel of land being more particularly described by metes bounds as follows:

BEGINNING at a 1/2 inch iron rod set at a fence intersection at the Northeast corner of said 21.59 acre tract and said 50 acre tract and in the West line of Wood County Road No. 3878, said POINT OF BEGINNING also being the most easterly Northeast corner of a called 15 acre tract described as "Tract No. 2" in a Deed from Francis Riggs Tedder and husband Joe Tedder to Debbie L. Tedder and husband Gene C. Tedder dated August 7, 1997 as shown of record in Volume 1568, Page 762, Real Property Records, Wood County, Texas;

THENCE S 00° 10' 00" E along the East line of 50 acre tract and the West line of said County Road and generally along a fence, leaving said County Road and continuing along the East line of said 50 acre tract and the West line of a called 5.000 acre tract described in a Deed from W. B. Clifton to Robert L. Tune as shown of record in Volume 1156, Page 403, Real Property Records, Wood County, Texas, at feet 939.03 feet passing through the Southwest corner of said 5.000 acre tract and the Northeast corner of a called 1.893 acre tract described as "Tract Two" in a Deed from Rich Russo and Tiffany Russo to Johnny Whitaker and Cindy Whitaker dated April 6, 2005 as shown of record in Volume 2072, Page 565, Real Property Records, Wood County, Texas, continuing along the West line of said 1.893 acre tract, in all, a distance of 1079.31 feet to a 1/2 inch iron rod set at a fence intersection at the Southwest corner of said 1.893 acre tract and in a South line of said Candler Survey and the North line of said Watkins Survey, said corner also being the most northerly Northwest corner of a called 304.20 acre tract described in a Deed from Jerry D. Fults and Betty Ann Fults to William S. Marsh dated December 19, 1975 as shown of record in Volume 712, Page 735, Deed Records, Wood County, Texas;

THENCE S 00° 10' 00" E continuing along the East line of said 50 acre tract and the most northerly West line of said 304.2 acre tract, a distance of 374.51 feet to a 1/2 inch iron rod set for the Southeast corner of said 21.59 acre tract and said 50 acre tract and an Ell corner of said 304.2 acre tract, a 22 inch pine tree (not marked) bears S 89° 42' W a distance of 17.6 feet, an 18 inch elm tree (not marked) bears N 33° 18' W a distance of 10.8 feet,

THENCE S 89° 41' 52" W along the South line of said 50 acre tract and the most westerly North line of said 304.2 acre tract and generally along a fence, a distance of 1256.10 feet to a 1/2 inch iron rod set at a fence intersection and for the Southwest corner of said 21.59 acre tract and the Southeast corner of said 15 acre tract;

TURNER SURVEYING COMPANY, LLC

P. O. BOX 632  
QUITMAN, TEXAS 75783  
TELE 903 763 2949 FAX 903 763 2019

Page 2 of 2

FIELD NOTES 20.961 ACRES  
J. M. CANDLER SURVEY A-102  
D. WATKINS SURVEY A-628  
WOOD COUNTY, TEXAS  
(PEACHY W6057-47.DAT)

THENCE N 40°36' 08" E along the Southeast line of said 15 acre tract and generally along a fence, a distance of 1923.54 feet to the POINT OF BEGINNING and containing 20.961 acres of land, of which 9.41 acres lie within said Watkins Survey and 11.55 acres lie within said Candler Survey.

WE TURNER SURVEYING COMPANY, LLC DO HEREBY CERTIFY THAT THESE FIELD NOTES WERE PREPARED FROM AN ACTUAL SURVEY MADE ON THE GROUND UNDER OUR SUPERVISION DURING THE MONTH OF SEPTEMBER, 2005.

  
HOMER C. TURNER, JR. RPLS  
September 29, 2005

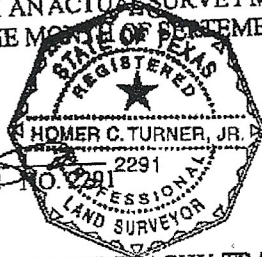

See "PLAT SHOWING SURVEY OF MIKE PEACHY TRACT" W6057-47.DAT of even date herewith.

Note: The bearings as shown hereon are referenced to the East line of said above mentioned 21.59 acre tract.

peachy1/pw16