

Soils Map

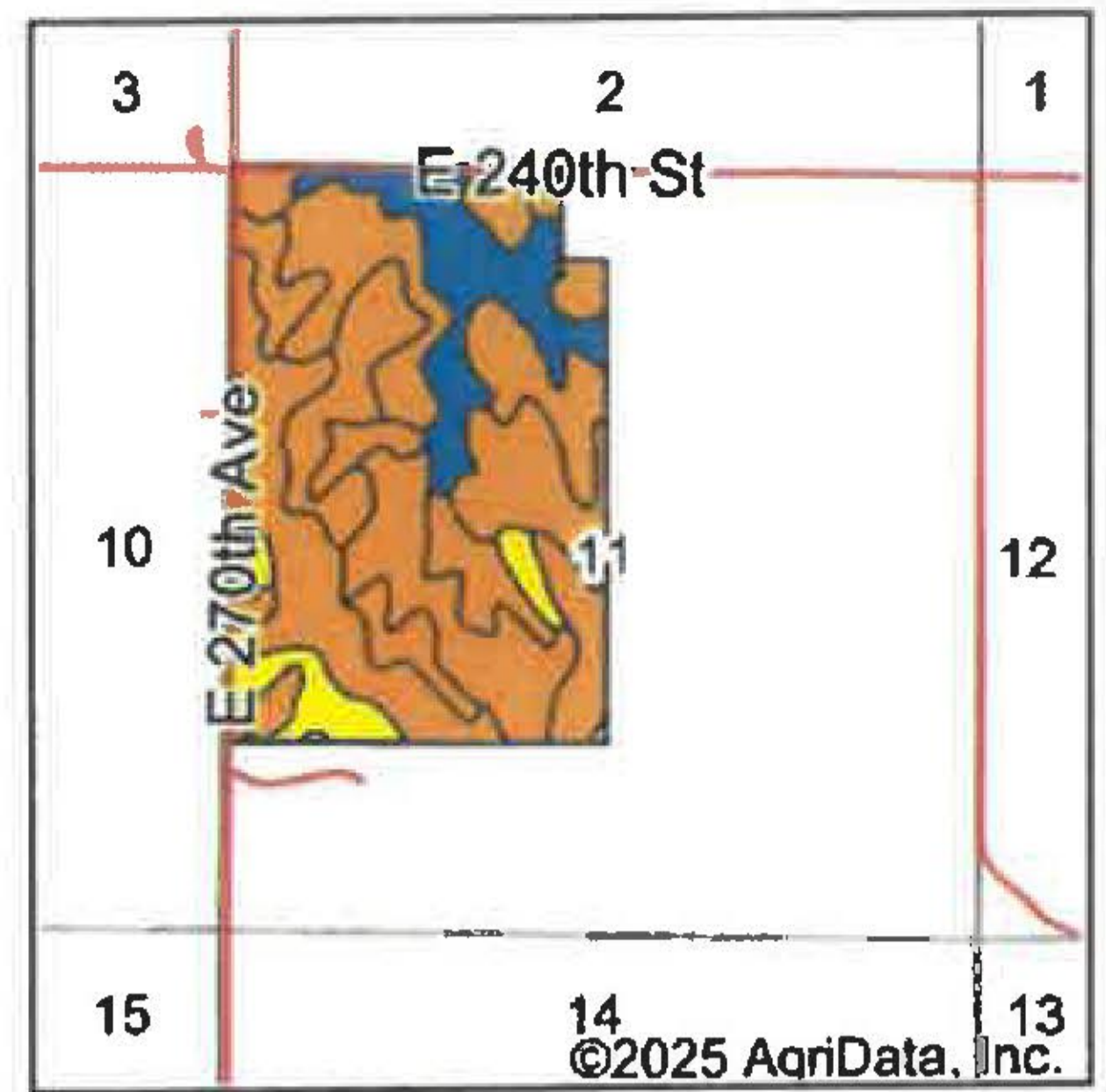

State: **Missouri**
 County: **Harrison**
 Location: **11-64N-27W**
 Township: **Grant**
 Acres: **238.21**
 Date: **2/10/2025**

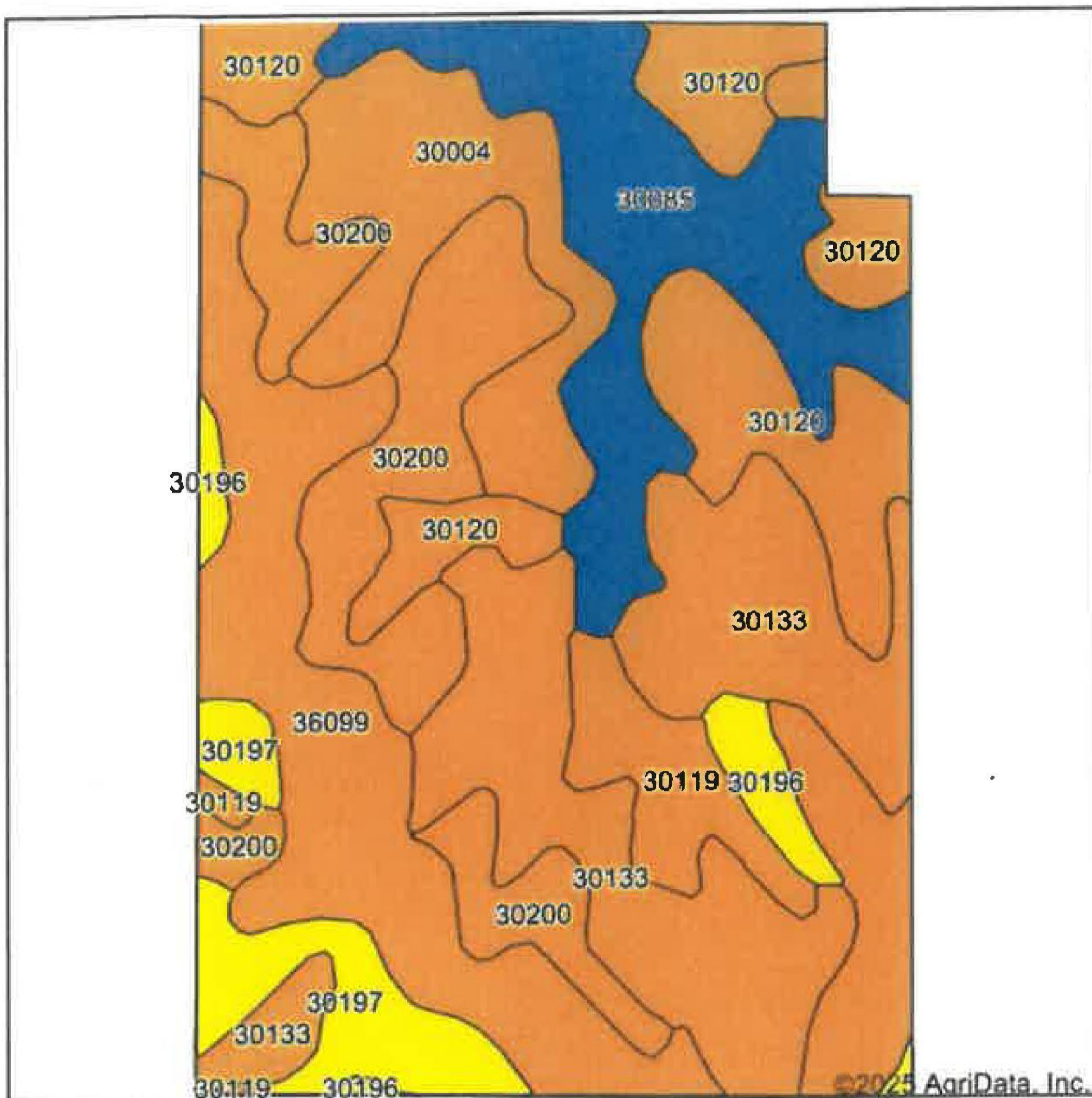

Maps Provided By:



© AgriData, Inc. 2023

www.AgriDataInc.com



Soils data provided by USDA and NRCS.

Area Symbol: MO081, Soil Area Version: 28

Code	Soil Description	Acres	Percent of field	Non-Irr Class Legend	Non-Irr Class *C	Alfalfa hay Tons	Caucasian bluestem Tons	Common bermudagrass Tons	Orchardgrass red clover Tons	Tall fescue Tons	Warm season grasses Tons
30133	Lamoni clay loam, 5 to 9 percent slopes, eroded	48.07	20.1%		Ille						
36099	Zook-Colo silty clay loams, 1 to 3 percent slopes, frequently flooded	44.95	18.9%		Illw			8	7	8	9
30200	Shelby loam, 9 to 14 percent slopes	33.68	14.1%		Ille						
30120	Lagonda silty clay loam, 5 to 9 percent slopes, eroded	31.15	13.1%		Ille	5	8	7	8	7	8
30085	Grundy silt loam, 2 to 5 percent slopes	31.11	13.1%		Ile						
30004	Adair clay loam, heavy till, 5 to 9 percent slopes, moderately eroded	22.04	9.3%		Ille						
30197	Shelby loam, 14 to 18 percent slopes	12.55	5.3%		Ive						
30119	Lagonda silty clay loam, 2 to 5 percent slopes, eroded	9.58	4.0%		Ille						