

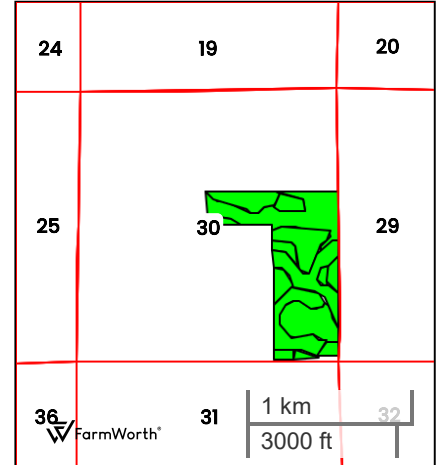

JETTIE - TRACTS 5-6 (118.71 AC TOTAL, 117.40 AC TILLABLE)

TILLABLE SOILS

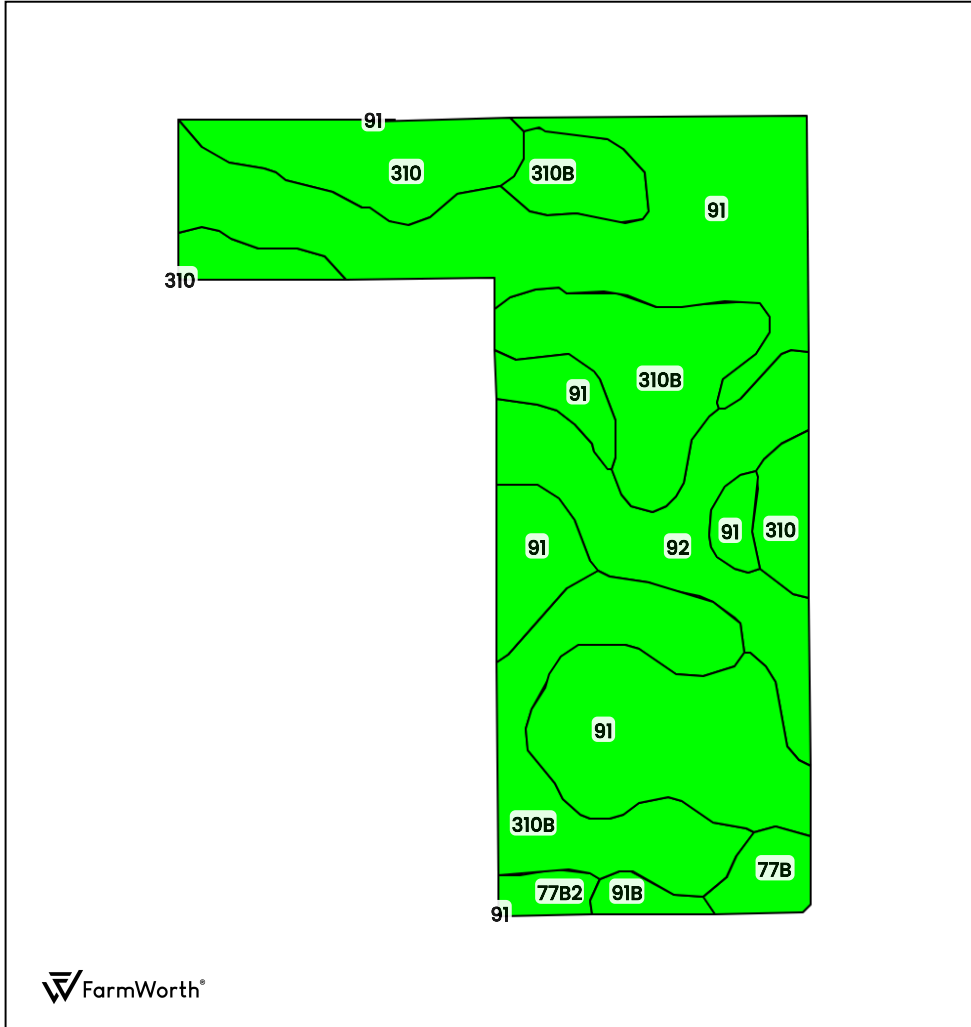

County: **Osceola County, IA**
 Location: **30-98N-41W**
 Township: **Goewey**
 Acres: **117.40**
 Date: **02/14/2025**



Field borders obtained from Farm Service Agency as of 2008

FarmWorth, LLC makes no representations or warranties, express or implied, as to the accuracy of any information, data, numerical values, boundaries, or any other information generated through the use of FarmWorth.com. User is solely responsible for independently investigating and determining all information provided through FarmWorth.com prior to use and waives any and all claims against FarmWorth, LLC for any inaccuracies or inconsistencies in the information and/or data.

Code	Description	Acres	% of field	IA CSR2	Drainage Class
91	Primghar silty clay loam, 0 to 2 percent slopes	52.01	44.30 %	100	Somewhat poorly drained
310B	Galva silty clay loam, 2 to 5 percent slopes	30.27	25.78 %	95	Well drained
92	Marcus silty clay loam, 0 to 2 percent slopes	17.54	14.94 %	94	Poorly drained
310	Galva silty clay loam, 0 to 2 percent slopes	11.89	10.13 %	100	Well drained
77B	Sac silty clay loam, loam substratum, 2 to 5 percent slopes	2.71	2.31 %	95	Moderately well drained
77B2	Sac silty clay loam, loam substratum, 2 to 5 percent slopes, eroded	1.60	1.36 %	92	Moderately well drained
91B	Primghar silty clay loam, 2 to 5 percent slopes	1.39	1.18 %	95	Somewhat poorly drained
				Average:	97.5

IA has updated the CSR values for each county to CSR2.
 Soils data provided by USDA and NRCS.