

# Soils Map

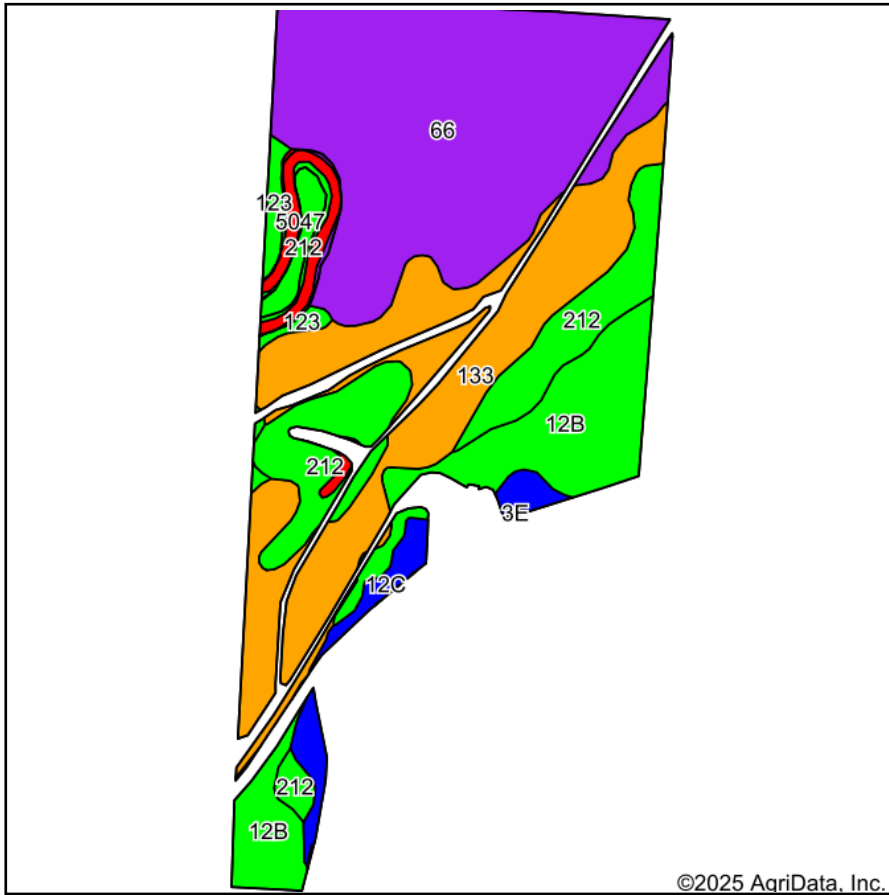

Soils data provided by USDA and NRCS.

©2025 AgriData, Inc.

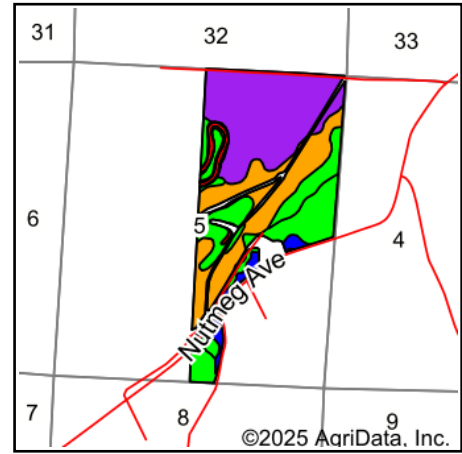

State: **Iowa**  
 County: **Monona**  
 Location: **5-84N-44W**  
 Township: **Kennebec**  
 Acres: **224.58**  
 Date: **2/21/2025**



Maps Provided By:  
**surety**  
 CUSTOMIZED ONLINE MAPPING  
 © AgriData, Inc. 2023 [www.AgriDataInc.com](http://www.AgriDataInc.com)



Area Symbol: IA133, Soil Area Version: 36

Code	Soil Description	Acres	Percent of field	CSR2 Legend	Non-Irr Class *c	CSR2**	CSR	*n NCCPI Overall	*n NCCPI Corn	*n NCCPI Small Grains	*n NCCPI Soybeans	
66	Luton silty clay, 0 to 2 percent slopes, rarely flooded	86.29	38.4%		Illw	57	40	50	41	29	50	
133	Colo silty clay loam, deep loess, 0 to 2 percent slopes, occasionally flooded	57.21	25.5%		Ilw	78	80	81	75	36	80	
212	Kennebec silt loam, 0 to 2 percent slopes, occasionally flooded	32.46	14.5%		lw	91	86	95	95	68	93	
12B	Napier silt loam, 2 to 5 percent slopes	31.45	14.0%		Ile	93	77	89	87	78	89	
12C	Napier silt loam, 5 to 9 percent slopes	8.19	3.6%		Ille	89	62	87	86	78	87	
5047	Aquents, ponded, occasionally flooded	4.99	2.2%		Vllw	5	0					
123	Grantcenter silty clay loam, 0 to 2 percent slopes, rarely flooded	3.85	1.7%		I	100	83	89	89	61	88	
3E	Castana silt loam, 14 to 20 percent slopes	0.14	0.1%		Ive	38	32	63	62	58	62	
<b>Weighted Average</b>						<b>2.37</b>	<b>73</b>	<b>62.7</b>	<b>*n 70.8</b>	<b>*n 65.5</b>	<b>*n 45</b>	<b>*n 70.2</b>

\*\*IA has updated the CSR values for each county to CSR2.

\*n: The aggregation method is "Weighted Average using all components"

\*c: Using Capabilities Class Dominant Condition Aggregation Method

Soils data provided by USDA and NRCS.