

FRANCISCO RUIZ SURVEY,
 ABSTRACT NO. 54
 MILAM COUNTY, TEXAS

Gray & Gray Real Estate Co.
 to
 Charles & Randall Lazrine
 137.736 Acres
 Aug. 27, 1992
 663/012

N19°00'00"W
 96.27'

N42°12'35"W
 327.99'

S70°07'04"E
 538.42'

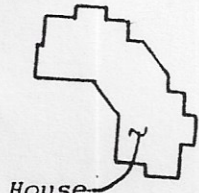

House
 5.000
 ACRES

N79°04'08"W
 276.78'

N19°00'00"W
 2327.47'

S19°00'00"E
 2596.50'
 (DEED BEARING)

N54°05'05"W
 86.99'

Existing 40' wide
 access easement
 663/012

SCALE: 1"=100'

Mark Smothers
 112.69 Acres
 Dec. 27, 1991
 651/700

LEGEND:
 ○ Iron pin set

Gabriel Berg &
 Geoffrey Berg
 192.315 Acres
 664/122

REVIEWED & ACCEPTED
 this 6 day of Oct
 1995

I, W. L. Ferguson, Registered Professional Land Surveyor No. 2547 in the State of Texas, do hereby certify that the field notes attached hereto represent a survey made this date on the ground of the property legally described herein and shown hereon this plat and is correct to the best of my knowledge; that there are no discrepancies, conflicts, shortage of area or boundary lines, encroachments or overlapping of improvements; that said property has access to and from a dedicated roadway, except as shown.

Given under my hand and seal this 20th day of August, 1995.

W. L. Ferguson, RPIS

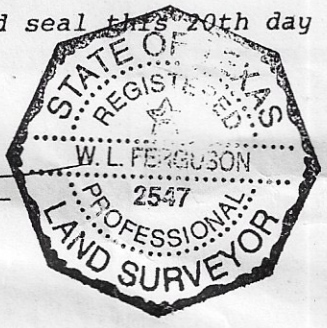

ENGINEERING SURVEYING
TRIAD
 PRODUCT SERVICE
 ENGINEERING, INC.
 231 EAST CAMERON • P. O. BOX 1489 • ROCKDALE, TX. 76567

5.000 ACRES
 MILAM COUNTY, TEXAS

DRAWN BY LEM APPROVED BY WLF

PROJECT NO.	SCALE	DATE	SHEET
S94-29	1"=100'	8/20/95	1 OF 1