

REFERENCE:

Plat Book	Page	Date
E	175	10/13/1934
P	118	1/5/1972

Deed Book	Page	Date
X100	358	1/11/1973
L404	173	4/29/2002
0646	477	6/16/2017

LEGEND:

- ipf-----iron pin found
- ips-----iron pin set
- cm-----concrete marker
- RIM-----concrete right-of way marker
- rb-----reinforcing bar

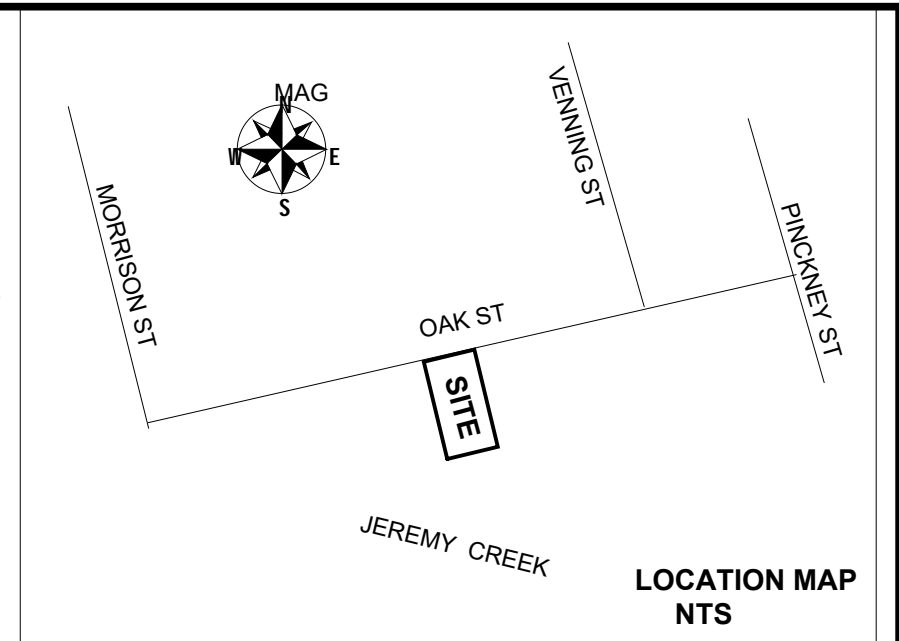

GENERAL SURVEY AND PLAT OF PROPERTY

Property of: **REBECCA BRYANT PHILLIPS**

LOCATED IN THE TOWN OF McCLELLANVILLE, CHARLESTON COUNTY, SC
TMS # 764-14-00-106

SCALE: 1" = 50 DATE: JULY 29, 2017



I hereby state that to the best of my knowledge, information, and belief, the survey shown hereon was made in accordance with the requirements of the minimum standards manual for the practice of land surveying in South Carolina and meets or exceeds the requirements for class A survey as specified therein.

JAMES O. MCCLELLAN III
PE & LS # 2476
McClellanville, SC 29458
PO Box 97
Tel # 843-887-3725
Fax # 843-887-3041