

Soils Map

Boundary Lines Are Approximate

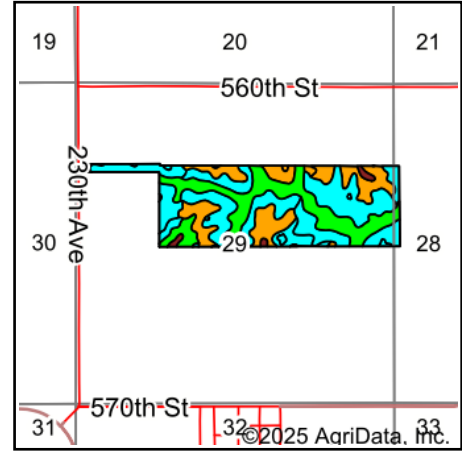
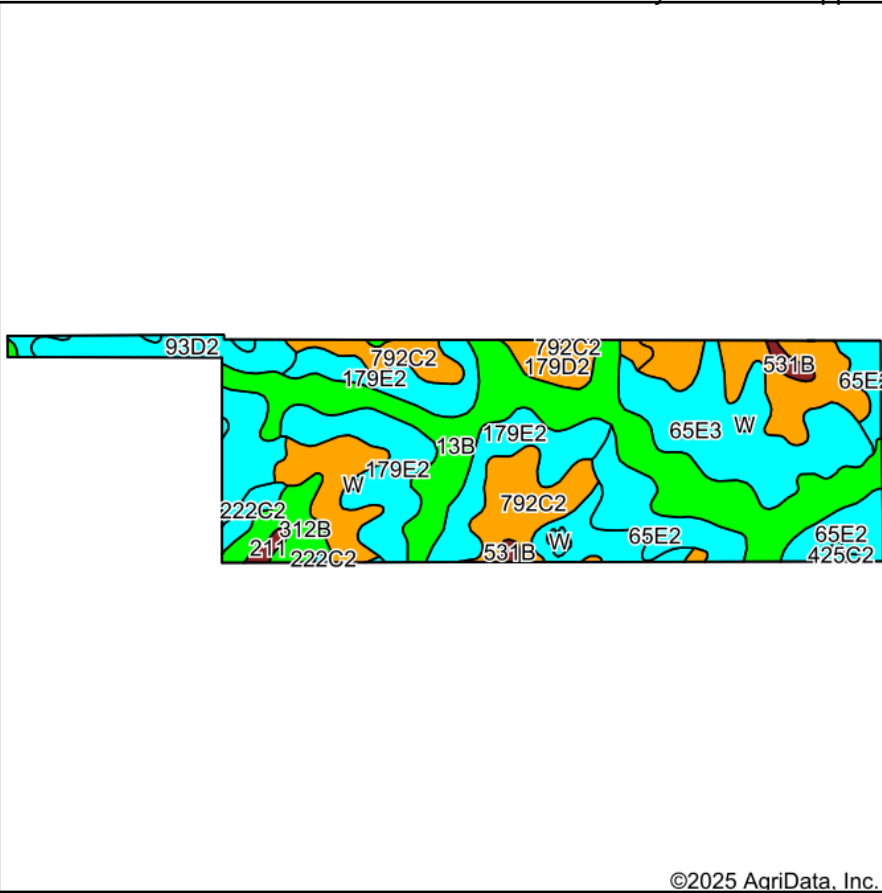

State: **Iowa**
 County: **Appanoose**
 Location: **29-68N-17W**
 Township: **Caldwell**
 Acres: **124.61**
 Date: **2/21/2025**

Hawkeye Farm Mgmt & Real Estate



22 N Main, Alta IA Phone: 641-932-7796
 Email: hawkeye@uciowa.com
 On the web: www.uciowa.com
www.iowawhitehallfarms.com

Maps Provided By:



© AgriData, Inc. 2023

www.AgriDataInc.com



Soils data provided by USDA and NRCS.

Area Symbol: IA007, Soil Area Version: 31

Code	Soil Description	Acres	Percent of field	CSR2 Legend	Non-Irr Class *c	CSR2**	CSR	*n NCCPI Corn	*n NCCPI Soybeans	
13B	Olmitz-Vesser-Colo complex, 2 to 5 percent slopes	27.58	22.2%			Ilw	79	68	81	80
792C2	Armstrong loam, 5 to 9 percent slopes, moderately eroded	24.63	19.8%			Ille	31	26	65	47
179E2	Gara loam, 14 to 18 percent slopes, moderately eroded	20.48	16.4%			Vle	24	33	62	44
65E3	Lindley clay loam, 14 to 18 percent slopes, severely eroded	15.25	12.2%			Vlle	22	25	59	42
65E2	Lindley loam, 14 to 18 percent slopes, moderately eroded	11.71	9.4%			Vle	29	28	66	53
93D2	Adair-Shelby complex, 9 to 14 percent slopes, moderately eroded	9.36	7.5%			IVe	17	25	67	47
312B	Seymour silt loam, 2 to 5 percent slopes	4.08	3.3%			Ille	64	60	70	65
993D2	Armstrong-Gara loams, 9 to 14 percent slopes, moderately eroded complex	3.72	3.0%			IVe	22	20	66	47
179D2	Gara loam, 9 to 14 percent slopes, moderately eroded	3.14	2.5%			IVe	38	43	66	48
222C2	Clarinda silty clay loam, 5 to 9 percent slopes, moderately eroded	2.23	1.8%			IVw	28	25	54	42
531B	Kniffin silt loam, 2 to 5 percent slopes	1.03	0.8%			Ille	55	58	64	66
W	Water	0.55	0.4%				0	0		
211	Edina silt loam, 0 to 1 percent slopes	0.52	0.4%			Illw	59	60	70	64
425C2	Keswick loam, 5 to 9 percent slopes, moderately eroded	0.33	0.3%			Ille	27	24	58	44
Weighted Average						*	39.2	38.1	*n 67.3	*n 54.3

Soils data provided by USDA and NRCS.

Maps Provided By:



© AgriData, Inc. 2023

www.AgriDataInc.com

**IA has updated the CSR values for each county to CSR2.

*n: The aggregation method is "Weighted Average using all components"

*c: Using Capabilities Class Dominant Condition Aggregation Method

*- Non Irr Class weighted average cannot be calculated on the current soils data due to missing data.