

Soils Map

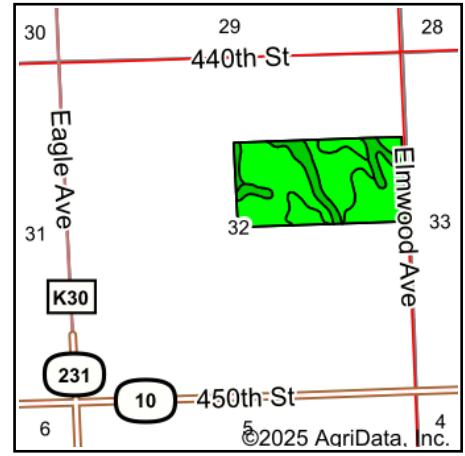

State: **Iowa**
 County: **Sioux**
 Location: **32-95N-46W**
 Township: **Center**
 Acres: **78.89**
 Date: **3/14/2025**

MIDWEST LAND & REAL ESTATE, INC
 712-262-3110 MANAGEMENT
 Maps Provided By: **surety**
 CUSTOMIZED ONLINE MAPPING
 © AgriData, Inc. 2023 www.AgriDataInc.com

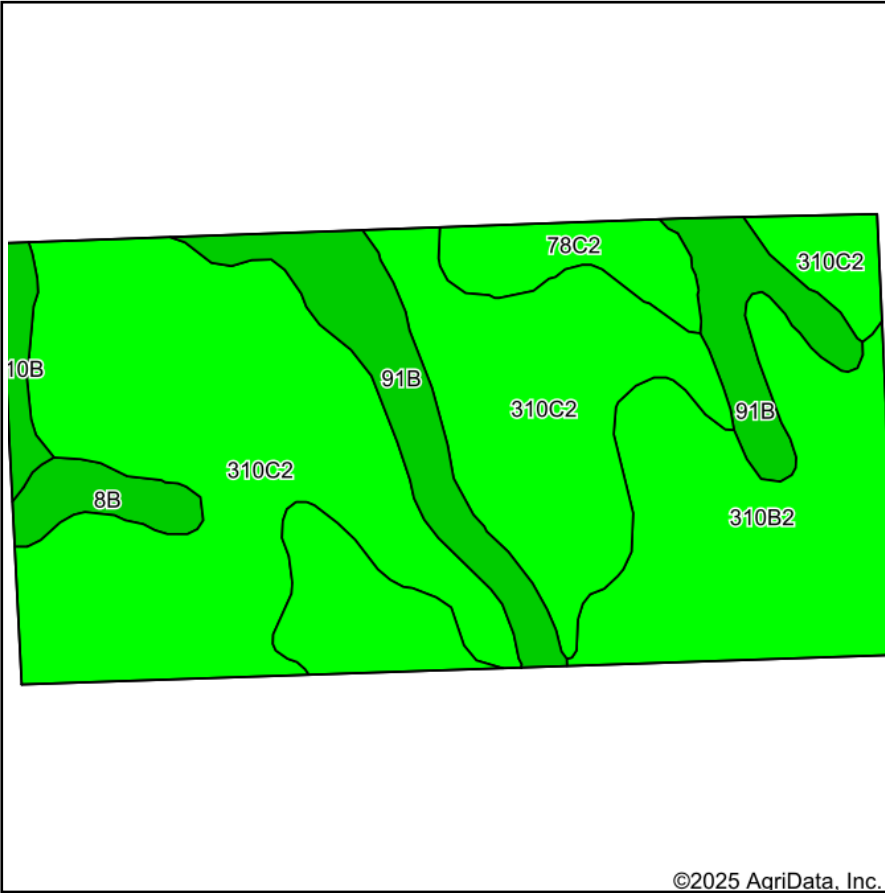

Soils data provided by USDA and NRCS.

©2025 AgriData, Inc.

Area Symbol: IA167, Soil Area Version: 34

Code	Soil Description	Acres	Percent of field	CSR2 Legend	Non-Irr Class *c	CSR2**	CSR	
310C2	Galva silty clay loam, 5 to 9 percent slopes, eroded	42.17	53.4%		IIIe	84	51	
310B2	Galva silty clay loam, 2 to 5 percent slopes, eroded	19.98	25.3%		Ile	90	65	
91B	Primghar silty clay loam, 2 to 5 percent slopes	9.85	12.5%		Ile	95	75	
78C2	Sac silty clay loam, 5 to 9 percent slopes, eroded	3.44	4.4%		IIIe	82	47	
8B	Judson silty clay loam, deep loess, 2 to 5 percent slopes	2.05	2.6%		Ile	92	69	
810B	Galva silty clay loam, terrace, 2 to 5 percent slopes	1.40	1.8%		Ile	95	65	
Weighted Average						2.58	87.2	58.1

**IA has updated the CSR values for each county to CSR2.

*c: Using Capabilities Class Dominant Condition Aggregation Method