

**Building Sketch (Page - 1)**

Borrower/Client Patricia Key	State TX
Property Address 401 Hubbard Lane	Zip Code 76462-1375
City Uninc. Parker Co.	County Parker
Lender Griffin Financial Mortgage, LLC	

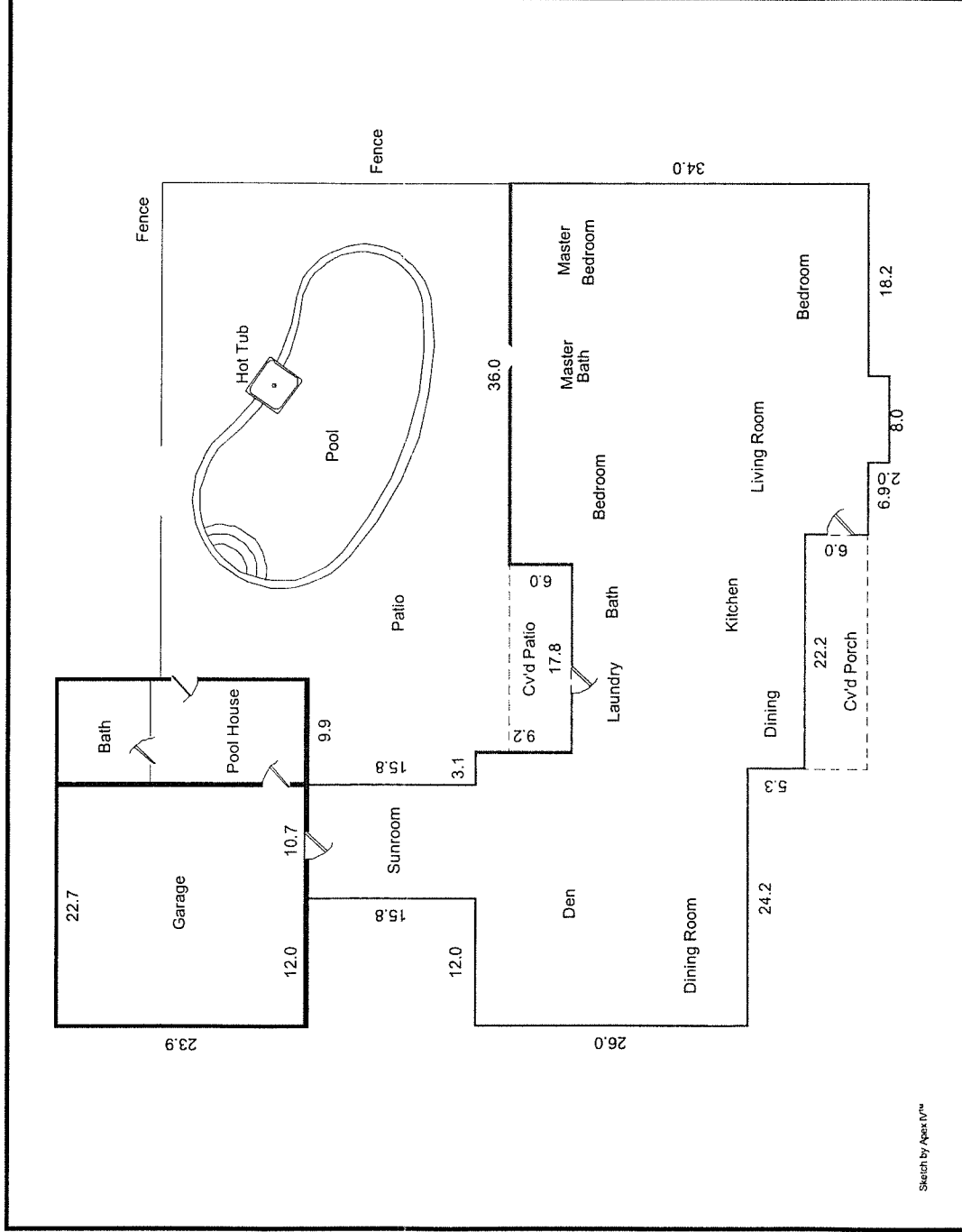

Sketch by Apex N<sup>o</sup>

Comments:

AREA CALCULATIONS SUMMARY			
Code	Description	Net Size	Net Totals
GLA1	First Floor	2459.8	2459.8
P/P	Cv'd Porch	133.2	240.0
GAR	Cv'd Patio	106.8	
	Garage	542.9	780.1
	Pool Rm/Bath	237.2	
<b>Net LIVABLE Area</b>		<b>(Rounded)</b>	<b>2460</b>

LIVING AREA BREAKDOWN		
First Floor	Breakdown	Subtotals
0.5 x	2.0 x	16.0
	0.0 x	0.2
	33.1 x	1124.8
	22.0 x	489.5
	2.9 x	17.5
	1.5 x	13.8
	24.3 x	628.5
	0.1 x	1.9
	10.7 x	167.6
<b>9 Items</b>	<b>(Rounded)</b>	<b>2460</b>