

ACCESS EASEMENT:
EXCEEDED LUMP 2.184
BOOK 217 OF PLATS.
PAGE 106.

PETERSEN RIDGE ESTATES

EASEMENTS

EASEMENTS ARE HEREBY DEDICATED TO PUBLIC USE, THE LOCATION AND WIDTH OF WHICH IS SHOWN IN EXHIBIT A AND ON THE ACCOMPANYING PLAN; AND SAID EASEMENTS MAY BE EMPLOYED IN CONNECTION AS A COORDINATE BUILDING WITH THE LAND FOR THE PURPOSE OF INSTALLING, REPAIRING, RECONSTRUCTING, EXPANDING AND MAINTAINING PUBLIC UTILITIES AND OR HEREINAFTER BUILT, GENERALLY UTILIZED BY THE PUBLIC.

DEDICATION

THE HEREBY DESCRIBED PORTION OF THE SUBDIVISION OF PETERSEN RIDGE ESTATES, S.W. 1/4 SEC. 13, T.20N., R.24W. OF THE 14TH P.M., GEOLOG COUNTY, WISCONSIN, AS APPEARS ON THIS PLAN IS WITH THE FREE CONSENT AND IN ACCORDANCE WITH THE TERMS OF THE UNDERLYING AGREEMENT, THE UNDERLYING OWNERS DO HEREBY RELEASE AND WAIVE ALL RIGHTS UNDER AND OUT OF TITLE OF THE FORESAID EASEMENTAL LAND OF THE STATE OF WISCONSIN.

NO PUBLIC WATER SUPPLY.
NO PUBLIC SEWER SYSTEM.
NO GASOR GAS DISTRIBUTION.
NO TRAILER MAINTENANCE.

STREETS SHOWN ON THIS PLAN AND NOT HERETOFORE DEDICATED TO PUBLIC USE ARE HEREBY DEDICATED TO PUBLIC USE.

LEGAL DESCRIPTION

THE 1/4 AC. OF THE 1/4 SEC. 13, T.20N., R.24W. OF THE 14TH P.M., GEOLOG COUNTY, WISCONSIN.

THE FOREGOING INSTRUMENT WAS ACKNOWLEDGED BEFORE ME AS NOTARY PUBLIC AND I HAVE BEEN DULY SEEN AND VERIFIED THE SIGNATURES OF THE PARTIES AND THE INSTRUMENT IS A TRUE AND CORRECT COPY OF THE ORIGINAL AS THE SAME APPEARS TO ME.

LEGEND

BASED ON DEEDS AND PETER RIDGE ESTATE RECORDS.
OWNER ARE IN A REBAR WITH PLATTING CAP NO. 2079.

CERTIFICATE OF SURVEYOR

I, JAMES DUNN, OF GEOLOG COUNTY, WIS., DO HEREBY CERTIFY THAT IN THE EXERCISE OF DUTY I HAVE SURVEYED THE ABOVE DESCRIBED PLAT AND THAT THE ATTACHED ILLUSTRATION IS A TRUE AND CORRECT ILLUSTRATION OF SAID SURVEY TO THE BEST OF MY KNOWLEDGE AND BELIEF.

James Dunn
JAMES DUNN
SURVEYOR
1470 1/2 N. W. 2079

SPECIAL TO GEOLOG CO. BOARD OF COMMISSIONERS

THE PLATTING OF THE FOREGOING SUBDIVISION OF PETERSEN RIDGE ESTATES, S.W. 1/4 SEC. 13, T.20N., R.24W. OF THE 14TH P.M., GEOLOG COUNTY, WISCONSIN, IS APPROVED BY THE BOARD OF COUNTY COMMISSIONERS OF GEOLOG COUNTY, WISCONSIN, ON THIS 15th DAY OF July, 1982.

Donald Collins *Paul H. Howard*
COUNTY CLERK COMMISSIONER
John A. Melme *Walter E. Anderson*
COMMISSIONER COMMISSIONER

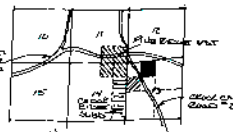

SEARCHED	INDEXED
SERIALIZED	FILED
JUL 15 1982	
GEOLOG COUNTY, WISCONSIN	

1001
Dunn
EARS ET.
UNRECORDED
156-9009