

Soils Map

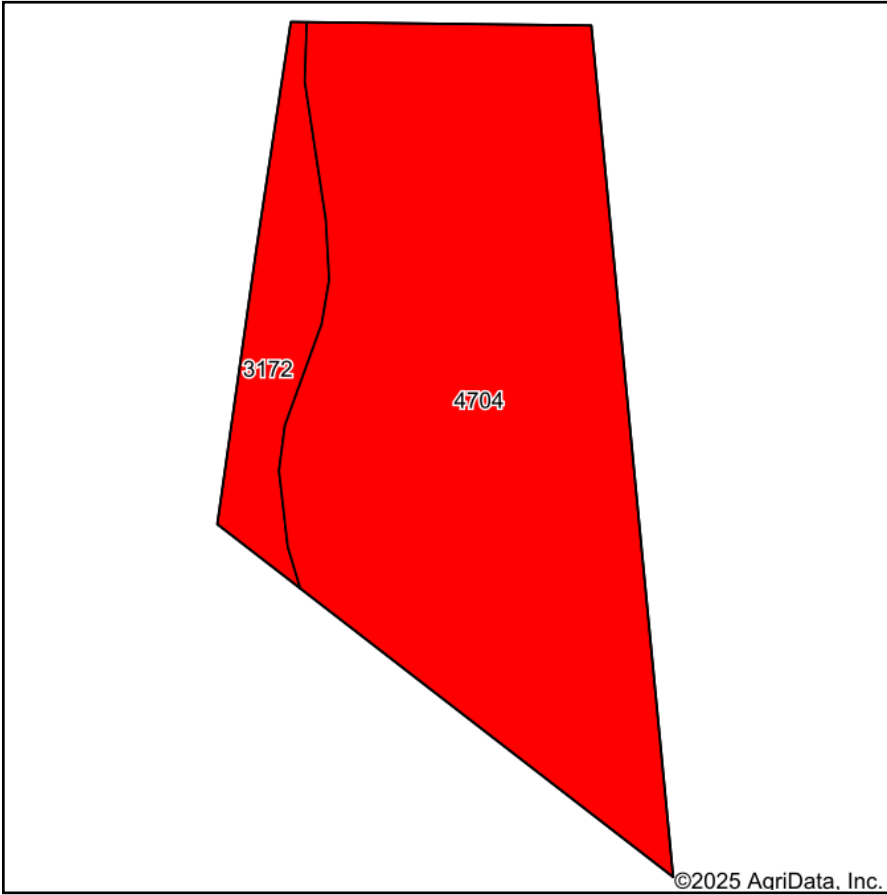

Soils data provided by USDA and NRCS.

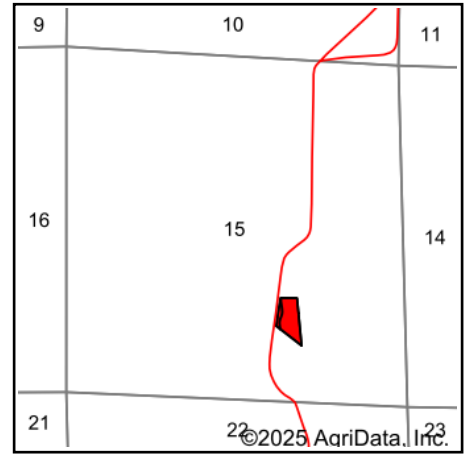

State: **Nebraska**
 County: **Cherry**
 Location: **15-34N-26W**
 Township: **Valentine**
 Acres: **4.35**
 Date: **3/19/2025**



Maps Provided By:



© AgriData, Inc. 2023

www.AgriDataInc.com



Area Symbol: NE031, Soil Area Version: 30

Code	Soil Description	Acres	Percent of field	SRPG Legend	Non-Irr Class *c	Irr Class *c	Range Production (lbs/acre/yr)	SRPG	*n NCCPI Overall	*n NCCPI Corn	*n NCCPI Small Grains	*n NCCPI Soybeans
4704	McKelvie-Fishberry-Rock outcrop complex, 11 to 60 percent slopes	3.85	88.5%		VIIe		1571	2	4	4	4	3
3172	Holt-Longpine fine sandy loams, 3 to 6 percent slopes	0.50	11.5%		IIIe	IIIe	2225	17	28	21	28	22
Weighted Average					6.54	*-	1646.2	3.7	*n 6.8	*n 6	*n 6.8	*n 5.2

*n: The aggregation method is "Weighted Average using all components"

*c: Using Capabilities Class Dominant Condition Aggregation Method

*- Irr Class weighted average cannot be calculated on the current soils data due to missing data.